

MIDGET, SPF (5AG) FUSE HOLDER

- Designed for SPF (Solar Protection Fuse)
- Optional cover will protect and insulate fuse
- Flame resistant

SPECIFICATIONS

Base & Cover: Nylon 46, UL Rated 94V-0

UL Rated: 30 Amps @ 500 VAC

Clips: .030 (.76) Brass, Matte Tin Plate

UL Operating Temp. Range: -58°F to +292°F (-50°C to



3576 (THM)

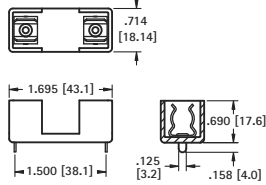

Optional Cover **Cat. No. 3576C**
fits Cat. No. 3576 & 3574

Mounting Detail

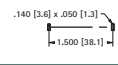

Mounting Detail

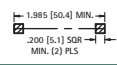

3574 (SMT)

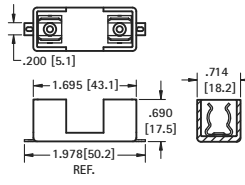

CAT. NO. 3576 - Holder

CAT. NO. 3576C - Cover only

CAT. NO. 3574 - Holder

CAT. NO. 3576C - Cover only

3AG FUSE BLOCKS

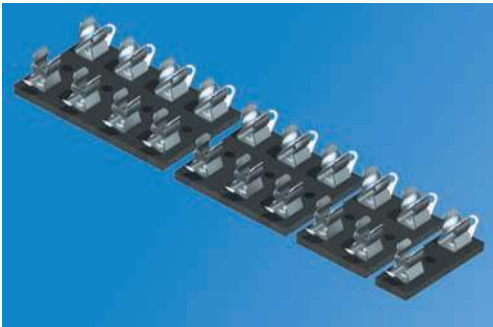

- Available with fiberglass or phenolic base
- Fuse clips riveted to base for rugged applications

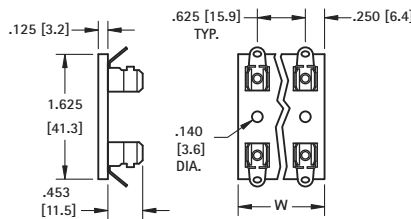

SPECIFICATIONS

Phenolic Base: XP, Black UL Rated 94-HB

Fiberglass Base: GPO-3 UL Rated 94 V-0

Clips: .020 (.51) Brass - Nickel Plated

Rated: 15 Amps @ 500 VAC

Operating Temp. Range: -58°F to +292°F (-50°C to +145°C)

BLACK PHENOLIC	FIBER-GLASS	HOLDS NO. OF FUSES	W
CAT. NO.	CAT. NO.		
3536*	3540*	1	.500 (12.7)
3537*	3541*	2	1.125 (28.6)
3538*	3542*	3	1.750 (44.5)
3539*	3543*	4	2.375 (60.3)

FUSE COVERS



Can be used with clips
3512, 3512P, 3517
and 3518

MATERIAL: ABS, UL Rated 94V-0

CAT. NO.	FUSE SIZE
3517C	5mm x 20mm

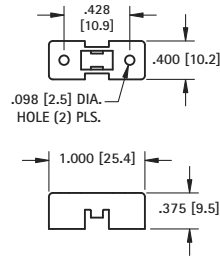

- Made from flame retardant material
- Protects fuse from shorting and minor bumps

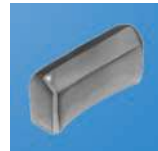
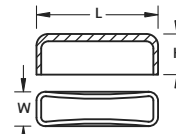

Can be used with
clips or fuse holders

MATERIAL: PVC, UL Listed 94V-0

CAT. NO.	FUSE SIZE	L	W	H
3527C	5mm x 20mm	.945 (24.0)	.314 (8.0)	.512 (13.0)
3521C	2AG	.787 (20.0)	.295 (7.5)	.452 (11.5)
4245C	3AG	1.319 (33.5)	.472 (12.0)	.591 (15.0)

SUBMINIATURE FUSE HOLDERS

- Reliable spring tension assures low contact resistance
- Fuse holders allow for quick changing of subminiature fuses
- Ideal for high density circuit board applications

SPECIFICATIONS

Base: Thermoplastic, UL Rated 94V-0

Pins: Brass, Tin Plate

Springs: Beryllium Copper, Gold Plate

Current Rating: 5 Amps @ 250V AC



.335 (8.5) x .158 (4.0) FUSE

For Littelfuse 392/395 Type TE5®
Bussmann: PC Series
or equivalent



.335 (8.5) DIA. FUSE

For Littelfuse 370 Type TR5®
Bussmann: BK-EFF Series
or equivalent

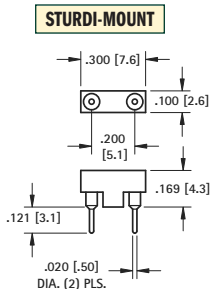

CAT. NO. 3552*

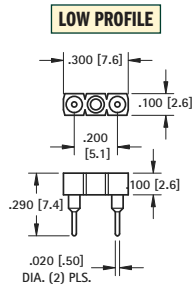

CAT. NO. 3553*

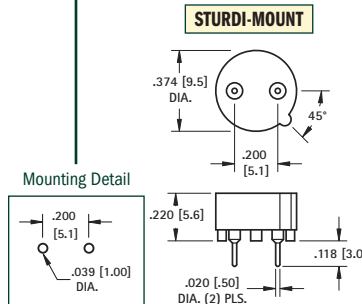

CAT. NO. 3556*

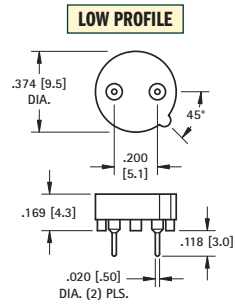

CAT. NO. 3554*

*3AG Fuse Blocks & Subminiature Fuse Holders are not UL recognized