

Housing - HC-B 6-TFL-H-O1STM32S - 1460030

Please be informed that the data shown in this PDF Document is generated from our Online Catalog. Please find the complete data in the user's documentation. Our General Terms of Use for Downloads are valid (<http://download.phoenixcontact.com>)

HEAVYCON B6 sleeve housing, for single locking latch, height: 72 mm, with 1 x M32 thread, lateral cable outlet



Key commercial data

| | |
|--------------------------------------|-----------|
| Packing unit | 1 1 |
| Weight per Piece (excluding packing) | 142.0 GRM |
| Custom tariff number | 85389099 |
| Country of origin | Germany |

Technical data

Dimensions

| | |
|--------|-------|
| Height | 72 mm |
| Width | 43 mm |
| Length | 60 mm |

Ambient conditions

| | |
|---------------------------------|-------------------|
| Schutzart Gehäuse (IP) | IP65 |
| Ambient temperature (operation) | -40 °C ... 125 °C |

General

| | |
|--------------------|---|
| Note | For contact inserts HC-B6, BB10, DD24, M Tall housings for extra large wiring space |
| Design | B6 |
| Housing type | Sleeve housings |
| Locking type | for single locking latch |
| No. of cable exits | 1 |
| Cable exit | Lateral |
| Screw connection | None |

Housing - HC-B 6-TFL-H-O1STM32S - 1460030

Technical data

General

| | |
|------------------------------|---------------------|
| Type of the screw connection | 1x M32 |
| Housing material | Aluminum die-cast |
| Housing surface material | Powder-coated, gray |

Classifications

eCl@ss

| | |
|------------|----------|
| eCl@ss 4.0 | 27140816 |
| eCl@ss 4.1 | 27140816 |
| eCl@ss 5.0 | 27143424 |
| eCl@ss 5.1 | 27143424 |
| eCl@ss 6.0 | 27143424 |
| eCl@ss 7.0 | 27440209 |
| eCl@ss 8.0 | 27440209 |

ETIM

| | |
|----------|----------|
| ETIM 3.0 | EC000437 |
| ETIM 4.0 | EC000437 |
| ETIM 5.0 | EC000437 |

UNSPSC

| | |
|---------------|----------|
| UNSPSC 6.01 | 31261502 |
| UNSPSC 7.0901 | 31261502 |
| UNSPSC 11 | 31261502 |
| UNSPSC 12.01 | 31261502 |
| UNSPSC 13.2 | 31261502 |

Drawings

Housing - HC-B 6-TFL-H-O1STM32S - 1460030

Dimensioned drawing

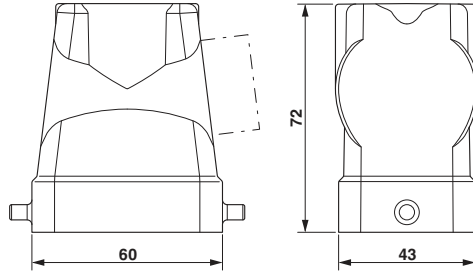

Dimensional drawing