

The reproduction, distribution and utilization of this document as well as the communication of its contents to others without express authorization is prohibited. Offenders will be held liable for the payment of damages. All rights reserved in the event of a patent, utility model or design.

Weitergabe sowie Vervielfaeligung dieses Dokuments, Verwertung und Mitteilung seines Inhalts sind verboten, soweit nicht ausdruendlich gestattet. Zuwiderhandlungen verpflichten zu Schadenersatz. Alle Rechte fuer den Fall der Patent-, Gebrauchsmuster- oder Geschmacksmusterreinertragung vorbehalten.

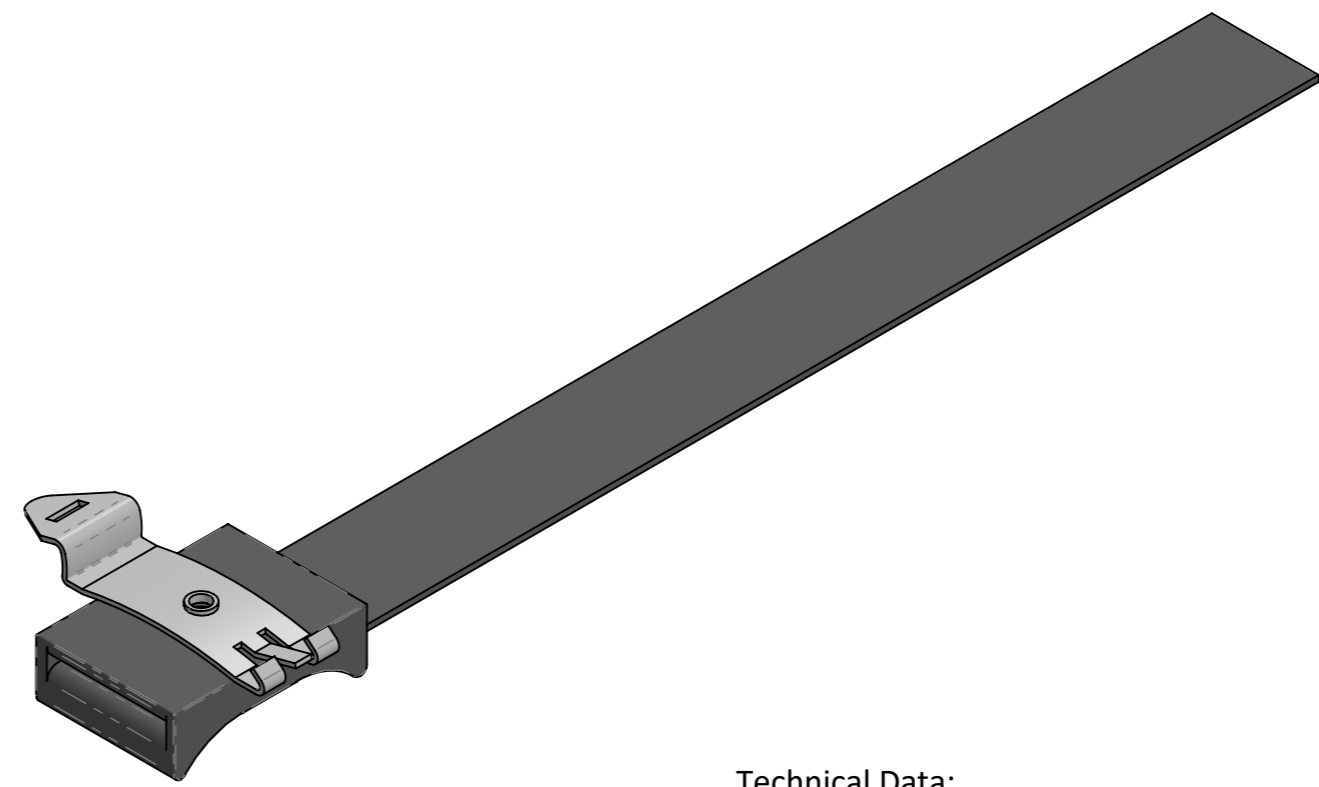
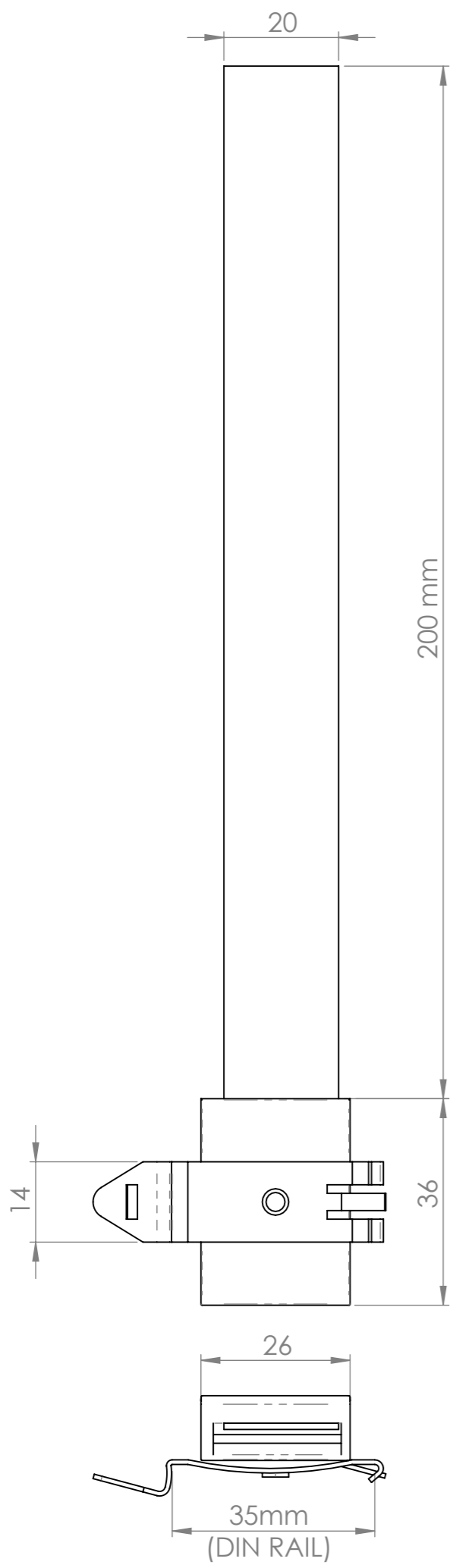

**Technical Data:**

**Base Material:** Polyamide, reinforced with glass fibre, Self-extinguishing according to UL94-V0

**Hook-and-Loop Material:** Polypropylen, Self-extinguishing according to UL94-V2

**Clip Material:** Nickle-Plated Spring Steel

|                                       |  |                                   |   |   |                    |                                   |
|---------------------------------------|--|-----------------------------------|---|---|--------------------|-----------------------------------|
| Surface<br>Oberflaeche                | Chamfers Kanten<br>DIN ISO 13715<br>Inside<br>Innenkanten<br>Outside<br>Aussenkanten |                                   | General Tolerances<br>Allg. Toleranzen<br>DIN ISO 2768 - mK<br>for welding parts<br>fuer Schweißteile<br>DIN EN ISO 13920 B | Surface Quality<br>Oberflaechen<br>according to<br>Rz in µm<br>DIN EN ISO 1302                        | Color<br>Farbe N/A | Weight<br>Masse (Gewicht) 14.51 g |
|                                       | No Scale / Kein Maßstab  | Date / Datum                      | Name  | Title / Benennung   |                    |                                   |
| Raw material<br>Rohteil               |  | Edit / Bea. 7/9/2020              | B. Halteman   | 45 Base and Hook & Loop for DIN Rail,<br>Clamping, Range 10-60mm,<br>w/ 200 x 20mm Hook and Loop Tape |                    |                                   |
| Selection / Selektion<br>093832R35S01 |  | <b>FATH Group</b><br>www.fath.net |   | Drawing, part# / Zeichnungs-, Teilnummer<br><b>093832R35S01</b>                                       |                    | Sheet/Blatt<br>1<br>tot./von<br>1 |
| CUSTOMER DRAWING / KUNDENZEICHNUNG    |  |                                   |   |   |                    | (NOT FOR QA / NICHT FUER QS)      |