

Switchcraft®

[Previous Page](#) | [Return to Index](#) | [Next Page](#)

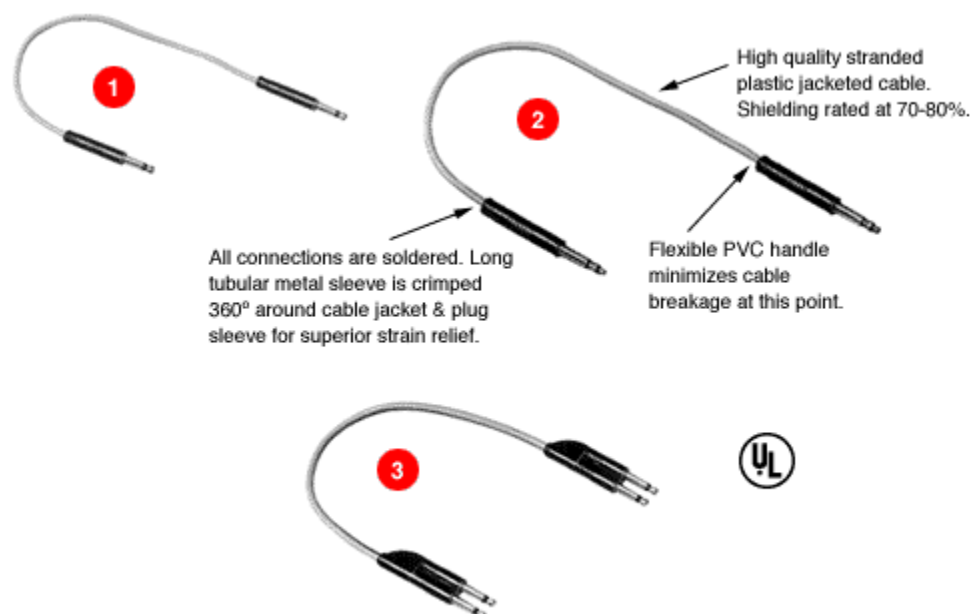

MINIATURE TT® MOLDED PATCH CORDS

- 1. Series TT100
- 2. Series TT120
- 3. Series TT140

[click here to download a schematic drawing](#)

(you will need to have Adobe Acrobat installed on your system to do this)



Available in a variety of types and lengths to meet requirements of communication, industrial and telephone applications. Patch cords designed to be used in "tini- telephone" jack panels. Constructed of high quality cadmium bronze conductors with thermoplastic insulating material. Braided shield offers 70- 80% coverage. All plugs are molded of flexible thermoplastic (in gray or colors) with non- slip finger grip areas. All cords (gray or colors) have a label identifying Switchcraft part number and length. Plug fingers are natural or nickel- plated copper alloy.

SERIES TT100 2- CONDUCTOR PATCH CORDS

Single- conductor shielded cable with 2- conductor phone plug molded at each end. Shield is grounded to sleeve of each plug; wiring is tip- to- tip. Plug fingers are brass; handles and cable are gray.

SERIES TT120 3- CONDUCTOR PATCH CORDS

2- conductor shielded cable with 3- conductor phone plug molded at each end. Shield is grounded to sleeve of each plug; wiring is tip- to- tip and ring- to- ring. Plug fingers are brass or nickel; handles and cable are gray or colored.

Part Numbers⁴		Length¹ feet(m)
Series TT100	Series TT120	
TT101*	TT121	0.5 (.152)
TT102*	TT122	1.0 (.305)
TT103*	TT123	1.5 (.457)
TT104	TT124	2.0 (.610)
TT105*	TT125*	2.5 (.762)
TT106*	TT126	3.0 (.914)

TT107	TT127	4.0 (1.219)
TT108	TT128	5.0 (1.524)
TT109*	TT129	6.0 (1.829)
TT110*	TT130*	7.0 (2.134)
TT111*	TT131*	8.0 (2.438)
TT112*	TT132*	9.0 (2.743)
TT113*	TT133*	10.0 (3.05)
TT114*	TT134*	11.0 (3.353)
TT115*	TT135*	12.0 (3.658)

*Special order only; contact Switchcraft for prices and delivery.

SERIES TT140 2-CONDUCTOR TWIN PATCH CORDS

2-conductor shielded cable and a pair of 2-conductor phone plug fingers molded at each end. Sleeve circuits are common and attached to shield. Wiring is tip-to-tip for each finger. Flexible handles permit self-alignment by compensation for any variation of jack mounting centers.

SERIES TT160 3-CONDUCTOR TWIN PATCH CORDS

Similar to Series TT140, except uses a 4-conductor shielded cable with a pair of 3-conductor phone plug fingers molded to each end. Circuits are wired tip-to-tip and ring-to-ring.

SPECIFICATIONS

Cable: Plastic jacket, cadmium bronze conductors, braided shield.

Jacket color: gray. Other colors available on special order.

Plugs: Tip Rod, Ring and Sleeve - Copper alloy.

Handle: Molded thermoplastic. Handle color: gray. Other colors available (on special order for TT100, TT140, TT160).

ORDERING

1. Order by part number
2. For special order items, contact Switchcraft with details.

		Length
--	--	---------------

Part Number Series TT120	Description^{2,3}	feet (m)¹
TT121N0	Nickel-plated plug fingers, black handles and cord.	0.5 (.152)
TT122N0		1.0 (.305)
TT123N0		1.5 (.457)
TT124N0		2.0 (.610)
TT125N0*		2.5 (.762)
TT126N0		3.0 (.914)
TT127N0		4.0 (1.219)
TT128N0		5.0 (1.524)
TT129N0		6.0 (1.829)

¹ Length of patch cord is measured from rear of molded plug handle to the rear of molded plug handle at opposite end.

² For brass fingers on plugs, substitute "B" for "N" in part number. Special order only.

³ "0" in part numbers denotes black handles and cord. Substitute the following for "0" to specify other colors: 2-Red 5-Green 4-Yellow 6-Blue

⁴ Special order only. Plug fingers are brass.

Part Numbers		Length feet (m)
Series TT140	Series TT160	
TT141*	TT161	0.5 (.152)
TT142*	TT162	1.0 (.305)
TT143*	TT163	1.5 (.457)
TT144*	TT164	2.0 (.610)
TT145*	TT165	2.5 (.762)
TT146*	TT166	3.0 (.914)
TT147*	TT167	4.0 (1.219)
TT148*	TT168	5.0 (1.524)
TT149*	TT169	6.0 (1.829)

TT150*	TT170*	7.0 (2.134)
TT151*	TT171*	8.0 (2.438)
TT152*	TT172*	9.0 (2.743)
TT153*	TT173*	10.0 (3.05)
TT154*	TT174*	11.0 (3.353)
TT155*	TT175*	12.0 (3.658)

*Special order only; contact Switchcraft for prices and delivery.

[Previous Page](#) | [Return to Index](#) | [Next Page](#)

To search a category please click on the corresponding icon:



| [Connectors](#) | [Jacks and Plugs](#) |
| [Patch Panels, Patch Kits & Jackfields](#) | [Cable Assemblies and Patch Cords](#) | [Switches](#) |

All products shown are covered by Switchcraft's limited lifetime warranty.

| [Switchcraft home](#) |
[About Us](#) | [Products](#) | [What's New](#) | [Search](#) | [Contact Us](#)