

REV.	DATE	DESCRIPTION
A	03/18/05	UPDATE DRAWING FORMAT

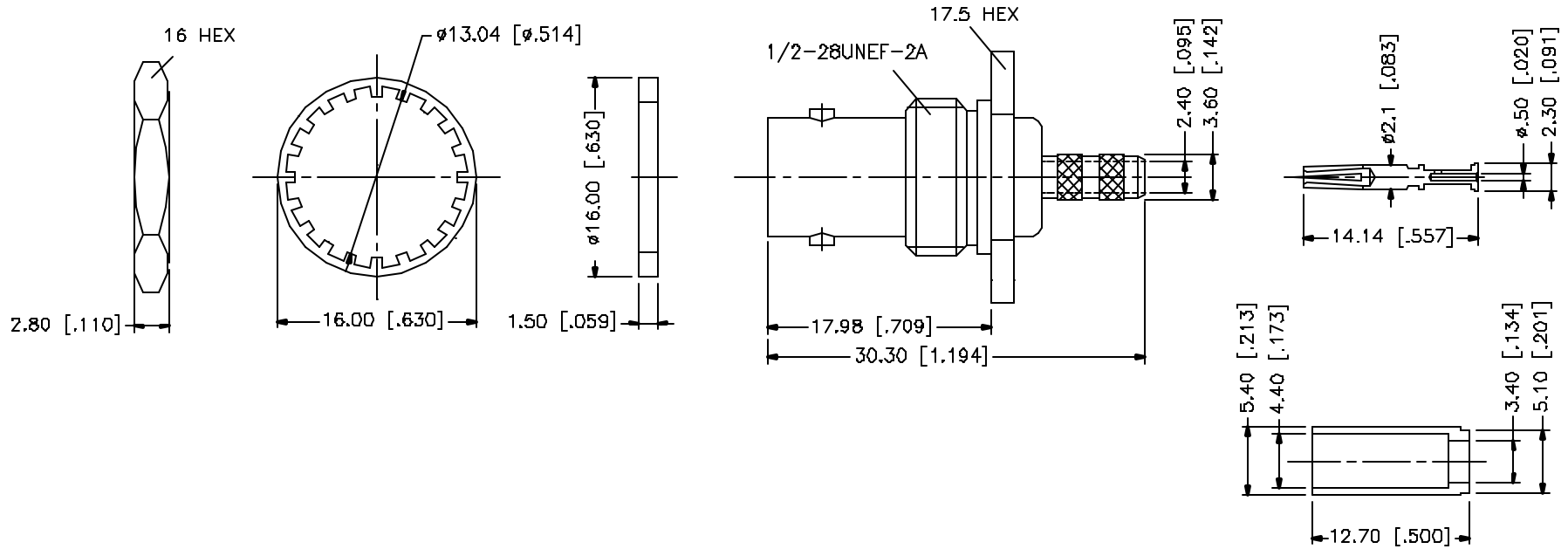
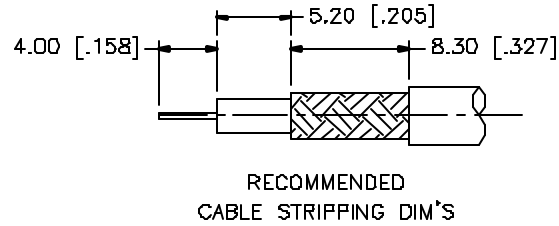
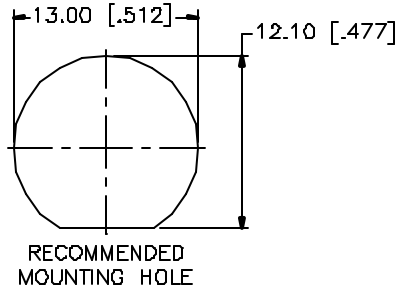

NOTES: FINISH (PLATING THICKNESS IN MICRO-INCHES)

1. NICKEL PL. 100 MIN. OVER COPPER PL. 50 MIN. OVER COPPER PL. 50 MIN.
2. GOLD PL. 30 MIN. OVER NICKEL PL. 50 MIN.
3. TEFLON MIL-P-19468.

				UNLESS OTHERWISE SPECIFIED DIMENSIONS ARE IN MILLIMETERS. DIMENSIONS IN [] ARE IN INCHES AND FOR CUSTOMER REFERENCE ONLY.	APPROVALS	DATE	Amphenol Connex
8					DRAWN	G.R.S.	
7	FERRULE	COPPER	NICKEL	1	CHECKED		
6	HEX NUT	BRASS	NICKEL	1	ISSUED		
5	LOCK WASHER	BRASS	NICKEL	1	SHEET	1 OF 1	PART DESCRIPTION BNC BULKHEAD CRIMP JACK (FOR AT&T 735A CABLE - 75ohm)
4	GASKET	SILICONE	RED	1			PART NO. 112969
3	CONTACT PIN	PHOS. BRONZE	GOLD	1			DWG. NO. 112969.DWG
2	INSULATOR	TEFLON	NATURAL	1			REV. A
1	BODY	BRASS	NICKEL	1			SIZE A
	DESCRIPTION	MATERIAL	FINISH	QTY			SCALE NA
					DO NOT SCALE DRAWING	CAD FILE C:/112/112969.DWG	