

Miniature Short Lever

Spade/Solder Type Terminal

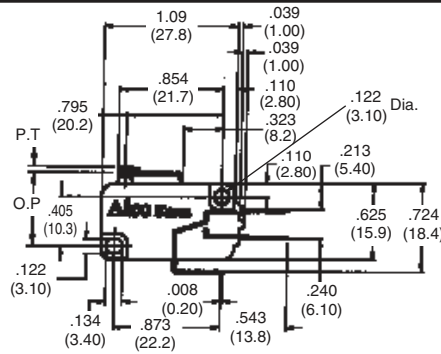

* Refer to Pages L2 for Product Specifications

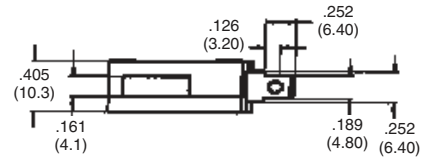

Product Facts

- n .187 [4.75] tab with solder hole
- n Use .187 [4.75] FASTON receptacles or solder wire directly to terminal
- n Short lever to increase operating position

| AMP | Switch Position | Operating Force | Releasing Force | Pre Travel (P.T.) | Operating Position | Over Travel | Movement Differential | Part Number |
|------|-----------------|-----------------|-------------------|--------------------------|--------------------------|-------------------|-----------------------|-------------|
| 16 | SPDT | 120g | 20g | 1.6 m/m [.063] | 14.8 ±0.4 [.606±.016] | 0.8 m/m [.031] | 0.4 m/m [.016] | 1478603-2 |
| | | 200g | 50g | | | | | 1478604-2 |
| | | 330g | 70g | | | | | 1478605-2 |
| | SPNC | 120g | 20g | 1.6 m/m [.063] | 14.8 ±0.4 [.606±.016] | 0.8 m/m [.031] | 0.4 m/m [.016] | 1478609-2 |
| | | 200g | 50g | | | | | 1478610-2 |
| | | 330g | 70g | | | | | 1478611-2 |
| SPNO | 120g | 20g | 1.6 m/m [.063] | 14.8 ±0.4 [.606±.016] | 0.8 m/m [.031] | 0.4 m/m [.016] | 1478615-2 | |
| | 200g | 50g | | | | | 1478616-2 | |
| | 330g | 70g | | | | | 1478617-2 | |
| 5 | SPDT | 120g | 20g | 1.6 m/m [.063] | 14.8 ±0.4 [.606±.016] | 0.8 m/m [.031] | 0.4 m/m [.016] | 1478667-2 |
| | SPNC | | | | | | | 1478668-2 |
| | SPNO | | | | | | | 1478669-2 |
| 0.1 | SPDT | 60g | 12g | 1.6 m/m [.063] | 14.8 ±0.4 [.606±.016] | 0.8 m/m [.031] | 0.4 m/m [.016] | 1478670-2 |
| | SPNC | | | | | | | 1478671-2 |
| | SPNO | | | | | | | 1478672-2 |

Spade Type Terminal

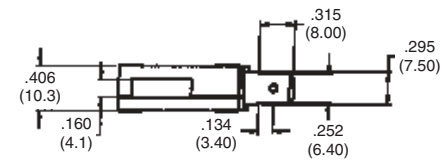
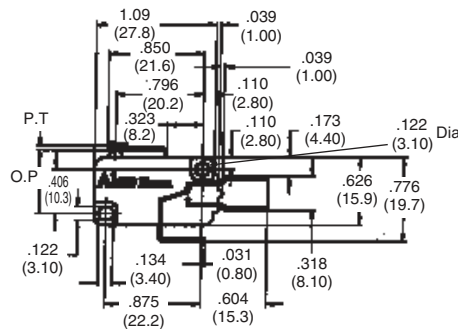
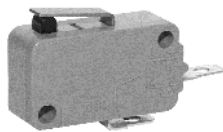

Product Facts

- n .250 [6.35] tab for use with .250 [6.35] FASTON receptacles
- n Short lever to increase operating positions

| AMP | Switch Position | Operating Force | Releasing Force | Pre Travel (P.T.) | Operating Position | Over Travel | Movement Differential | Part Number |
|------|-----------------|-----------------|-------------------|--------------------------|--------------------------|-------------------|-----------------------|-------------|
| 16 | SPDT | 120g | 20g | 1.6 m/m [.063] | 15.4 ±0.4 [.606±.016] | 0.8 m/m [.031] | 0.4 m/m [.016] | 1478606-2 |
| | | 200g | 50g | | | | | 1478607-2 |
| | | 330g | 70g | | | | | 1478608-2 |
| | SPNC | 120g | 20g | 1.6 m/m [.063] | 15.4 ±0.4 [.606±.016] | 0.8 m/m [.031] | 0.4 m/m [.016] | 1478612-2 |
| | | 200g | 50g | | | | | 1478613-2 |
| | | 330g | 70g | | | | | 1478614-2 |
| SPNO | 120g | 20g | 1.6 m/m [.063] | 15.4 ±0.4 [.606±.016] | 0.8 m/m [.031] | 0.4 m/m [.016] | 1478618-2 | |
| | 200g | 50g | | | | | 1478619-2 | |
| | 330g | 70g | | | | | 1478620-2 | |

Miniature Normal Lever

Spade/Solder Type Terminal

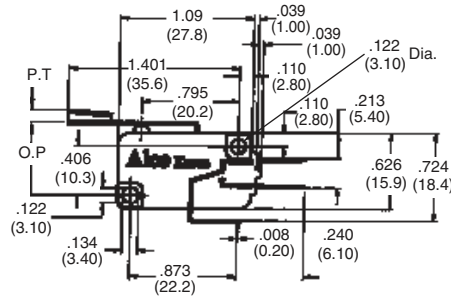
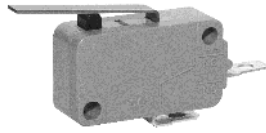

* Refer to Pages L2 for Product Specifications

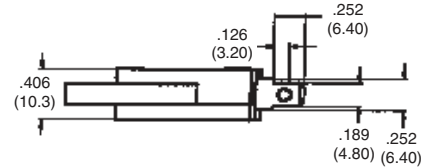

Product Facts

- n .187 [4.75] tab with solder hole
- n Use .187 [4.75] FASTON receptacles or solder wire directly to terminal
- n Lever to increase travel and operating position as well as reduce operating force

| AMP | Switch Position | Operating Force | Releasing Force | Pre Travel (P.T.) | Operating Position | Over Travel | Movement Differential | Part Number |
|------|-----------------|-----------------|-----------------|-------------------|--------------------|-------------|-----------------------|-------------|
| 16 | SPDT | 60g | 10g | 4.0 m/m | 15.4 ±1.4 | 1.3 m/m | 1.2 m/m | 1478603-3 |
| | | 120g | 20g | [.157] | [.606±.055] | [.051] | [.047] | 1478604-3 |
| | | 180g | 30g | | | | | 1478605-3 |
| | SPNC | 60g | 10g | 4.0 m/m | 15.4 ±1.4 | 1.3 m/m | 1.2 m/m | 1478609-3 |
| | | 120g | 20g | [.157] | [.606±.055] | [.051] | [.047] | 1478610-3 |
| | | 180g | 30g | | | | | 1478611-3 |
| SPNO | 60g | 10g | 4.0 m/m | 15.4 ±1.4 | 1.3 m/m | 1.2 m/m | 1478615-3 | |
| | 120g | 20g | [.157] | [.606±.055] | [.051] | [.047] | 1478616-3 | |
| | 180g | 30g | | | | | 1478617-3 | |
| 5 | SPDT | | | | | | | 1478667-3 |
| | SPNC | 60g | 10g | 4.0 m/m | 15.4 ±1.4 | 1.3 m/m | 1.2 m/m | 1478668-3 |
| | SPNO | | | [.157] | [.606±.055] | [.051] | [.047] | 1478669-3 |
| 0.1 | SPDT | | | | | | | 1478670-3 |
| | SPNC | 35g | 6g | 4.0 m/m | 15.4 ±1.4 | 1.3 m/m | 1.2 m/m | 1478671-3 |
| | SPNO | | | [.157] | [.606±.055] | [.051] | [.047] | 1478672-3 |

Spade Type Terminal

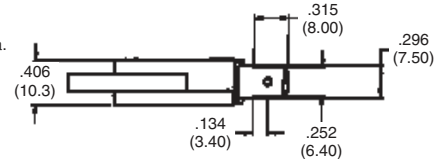
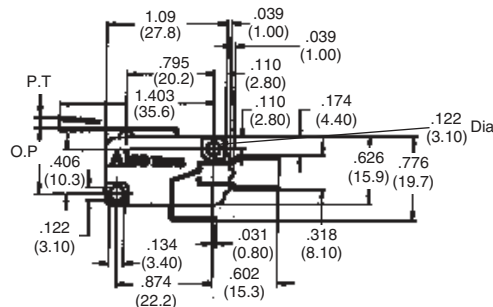
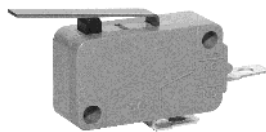

Product Facts

- n .250 [6.35] tab for use with .250 [6.35] FASTON receptacles
- n Lever to increase travel and operating position as well as reduce operating force

| AMP | Switch Position | Operating Force | Releasing Force | Pre Travel (P.T.) | Operating Position | Over Travel | Movement Differential | Part Number |
|------|-----------------|-----------------|-----------------|-------------------|--------------------|-------------|-----------------------|-------------|
| 16 | SPDT | 60g | 10g | 4.0 m/m | 15.4 ±1.4 | 1.3 m/m | 1.2 m/m | 1478606-3 |
| | | 120g | 20g | [.157] | [.606±.055] | [.051] | [.047] | 1478607-3 |
| | | 180g | 30g | | | | | 1478608-3 |
| | SPNC | 60g | 10g | 4.0 m/m | 15.4 ±1.4 | 1.3 m/m | 1.2 m/m | 1478612-3 |
| | | 120g | 20g | [.157] | [.606±.055] | [.051] | [.047] | 1478613-3 |
| | | 180g | 30g | | | | | 1478614-3 |
| SPNO | 60g | 10g | 4.0 m/m | 15.4 ±1.4 | 1.3 m/m | 1.2 m/m | 1478618-3 | |
| | 120g | 20g | [.157] | [.606±.055] | [.051] | [.047] | 1478619-3 | |
| | 180g | 30g | | | | | 1478620-3 | |