

APPROVED: _____
 DATE: _____ TITLE: _____

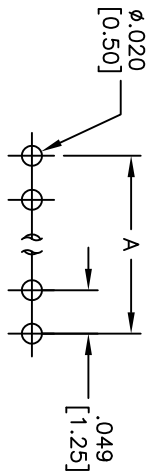
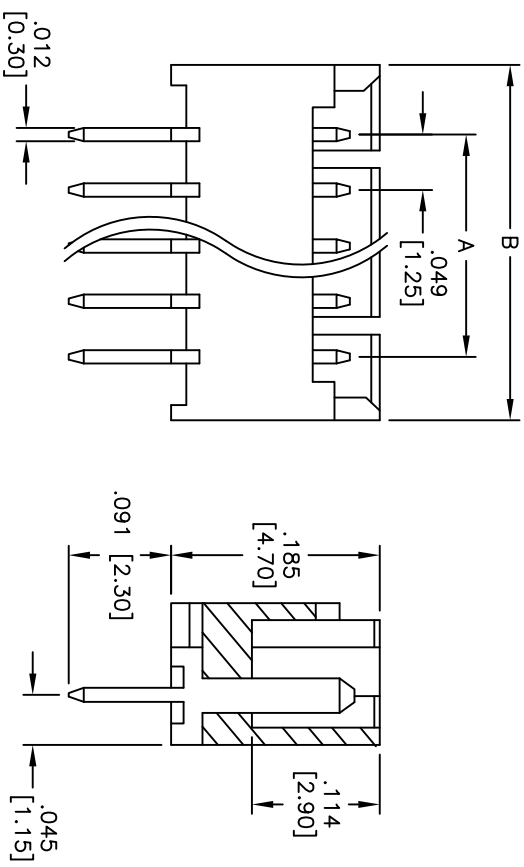
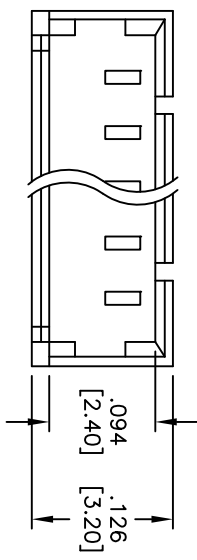

RECOMMENDED PCB LAYOUT

CIRCUITS	DIM A	DIM B
2	.049 [1.25]	.169 [4.30]
3	.098 [2.50]	.217 [5.50]
4	.148 [3.75]	.268 [6.80]
5	.197 [5.00]	.315 [8.00]
6	.246 [6.25]	.366 [9.30]
7	.295 [7.50]	.413 [10.50]
8	.344 [8.75]	.465 [11.80]
9	.394 [10.00]	.512 [13.00]
10	.443 [11.25]	.563 [14.30]
11	.492 [12.50]	.610 [15.50]
12	.541 [13.75]	.661 [16.80]
13	.591 [15.00]	.709 [18.00]
14	.640 [16.25]	.760 [19.30]
15	.689 [17.50]	.807 [20.50]

SPECIFICATIONS:

Material:
 Insulator: Hi-temp thermoplastic, rated UL 94V-0
 Insulator color: Natural
 Contacts: Phosphor Bronze

Plating:
 Tin over Copper underplate overall

Electrical:
 Operating voltage: 125 VAC, DC
 Current rating: 1A AC, DC
 Insulation resistance: 100 Mohms min
 Dielectric withstanding voltage: 250 VAC for 1 minute

Temperature Rating:
 Operating temperature: -40°C to +85°C
 Environmental:
 Lead free, RoHS compliant.



Rev	AWO #	Description	Date	Appr
-		RELEASED	01/17/07	
A		REDRAWN	1/29/10	

UNLESS OTHERWISE SPECIFIED ALL DIMENSIONS ARE INCHES [MM]	
INCHES	TOLERANCES: EXCEPT AS NOTED
.X ± .10	ØX ± .10
.XX ± .020	ØXX ± .015
.XXX ± .015	ØXXX ± .010
APPROVALS	DATE
DRAWN	BW
CHECKED	
APPROVED	

ADAM TECH
 909 Railway Avenue, Union, NJ 07083
 Phone: 908-687-5000 Fax: 908-687-5710

TITLE	.049 [1.25] SINGLE ROW HEADER, VERTICAL, STRAIGHT, DIP TYPE	
SIZE	PART NO.	REV.
X	125SH-A-XX-TS	A
REF: S0006T	SCALE: NTS	SHEET 1 OF 1