

CONFIGURAZIONE POLARIZZAZIONI
POLARIZATION CONFIGURATION

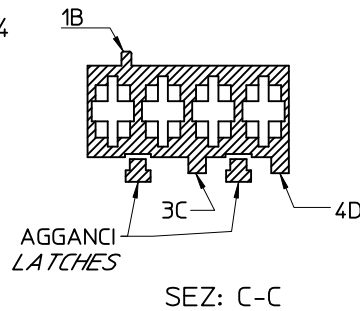

- NOTE:
- USATO CON TERMINALE 94518-0XXX E 94549-0XXX
 - SPECIFICA DI RIFERIMENTO PER IL CONNETTORE PS-94550-001
 - SPESSORE MINIMO PARETI CONNETTORE 0.40 mm.
- NOTE:
- USED WITH TERMINALS 94518-0XXX AND 94549-0XXX
 - REFER TO PS-94550-001 FOR CONNECTOR SPECIFICATION
 - MINIMUM CONNECTOR WALL THICKNESS 0.40 mm.

PACKAGING (SPQ): 1800 pcs in carton box
CONFEZIONE (SPQ): Box da 1800 Pz.

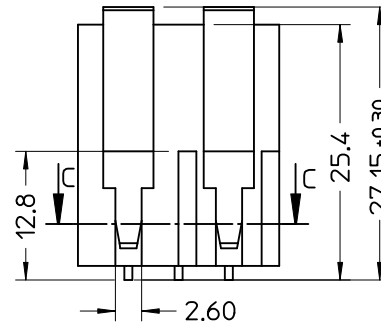
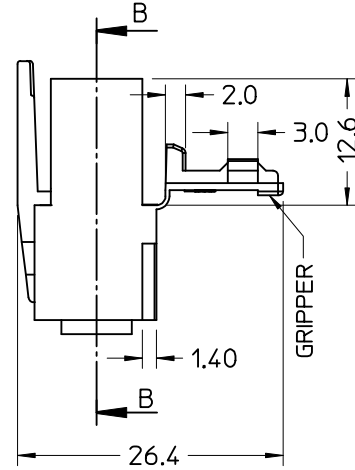
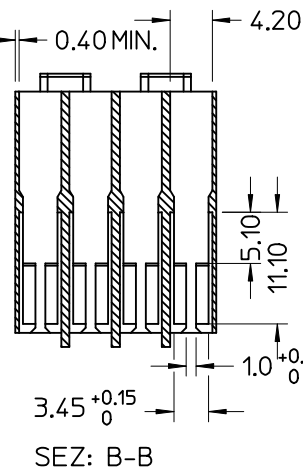
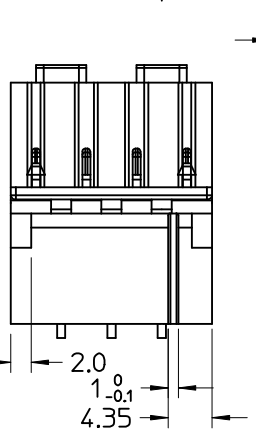

* AGENCY
RECOGNIZATIONS
CSA (file LR19980)
UL (file E-29179)

P/N	MATERIAL / COLOUR
94550-8004	NYLON 6.6 V2 NATURAL
*94550-9004	NYLON 6.6 V0 NATURAL GWT 550°C
94550-4004	NYLON 6.6 GWT 750°C sec.IEC 60335-1 TEST METHOD IEC 60695-2-11 NATURAL
94550-4084	NYLON 6.6 GWT 750°C sec.IEC 60335-1 TEST METHOD IEC 60695-2-11 BLACK
94550-3084	NYLON 6.6 BLACK NO-FLAME HOT WIRE IGNITION TEST

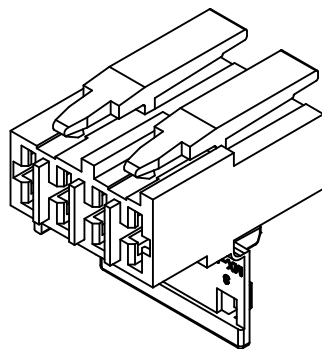
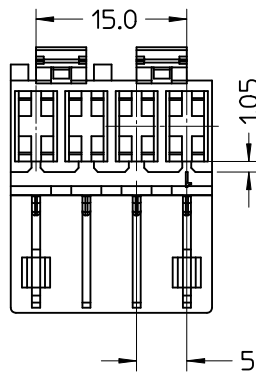

Std. Descr: "HSG W/SEC LOCK AND LATCH 4CKT _____ COLOUR"

EC NO: Z2011-0087 DRWNL: SANTISS 2010/11/12 CHKD: LSANTISS2013/10/29 APPR: FBISIELLO 2013/10/29	QUALITY SYMBOLS ▽ +0 ▽ -0	GENERAL TOLERANCES (UNLESS SPECIFIED)		SCALE: 2:1	DESIGN UNITS: METRIC	FIRST ANGLE PROJECTION	REVISE ON CAD ONLY															
		<table border="1"> <tr> <th></th> <th>mm</th> <th>INCH</th> </tr> <tr> <td>4 PLACES</td> <td>± ---</td> <td>± ---</td> </tr> <tr> <td>3 PLACES</td> <td>± ---</td> <td>± ---</td> </tr> <tr> <td>2 PLACES</td> <td>± 0.10</td> <td>± ---</td> </tr> <tr> <td>1 PLACE</td> <td>± 0.2</td> <td>± ---</td> </tr> </table>			mm	INCH	4 PLACES	± ---	± ---	3 PLACES	± ---	± ---	2 PLACES	± 0.10	± ---	1 PLACE	± 0.2	± ---	DIMENSION STYLE: MM ONLY		TITLE: HSG 4 CKT WITH SEC.LOCK AND EXTERNAL LATCH	
			mm	INCH																		
		4 PLACES	± ---	± ---																		
3 PLACES	± ---	± ---																				
2 PLACES	± 0.10	± ---																				
1 PLACE	± 0.2	± ---																				
DRAFT WHERE APPLICABLE		APPROVED BY: GZUIN DATE: 2002/06/27		MATERIAL NO.: SEE TABLE		DOCUMENT NO.: SD-94550-003																
MUST REMAIN WITHIN DIMENSIONS		THIS DRAWING CONTAINS INFORMATION THAT IS PROPRIETARY TO MOLEX INCORPORATED AND SHOULD NOT BE USED WITHOUT WRITTEN PERMISSION		SHEET NO.: 1 OF 1		A3																