

REVISIONS					
P	LTR	DESCRIPTION	DATE	DWN	APVD
D		REVISED PER ECO-07-008991	4/23/07	SS	GS
D1		REVISED PER ECO-09-020935	27AUG09	KK	AEG
E		REVISED PER ECO-17-009310	28JUN2017	RS	MZ
F		REVISED PER ECO-18-000439	18JAN2018	RS	MZ

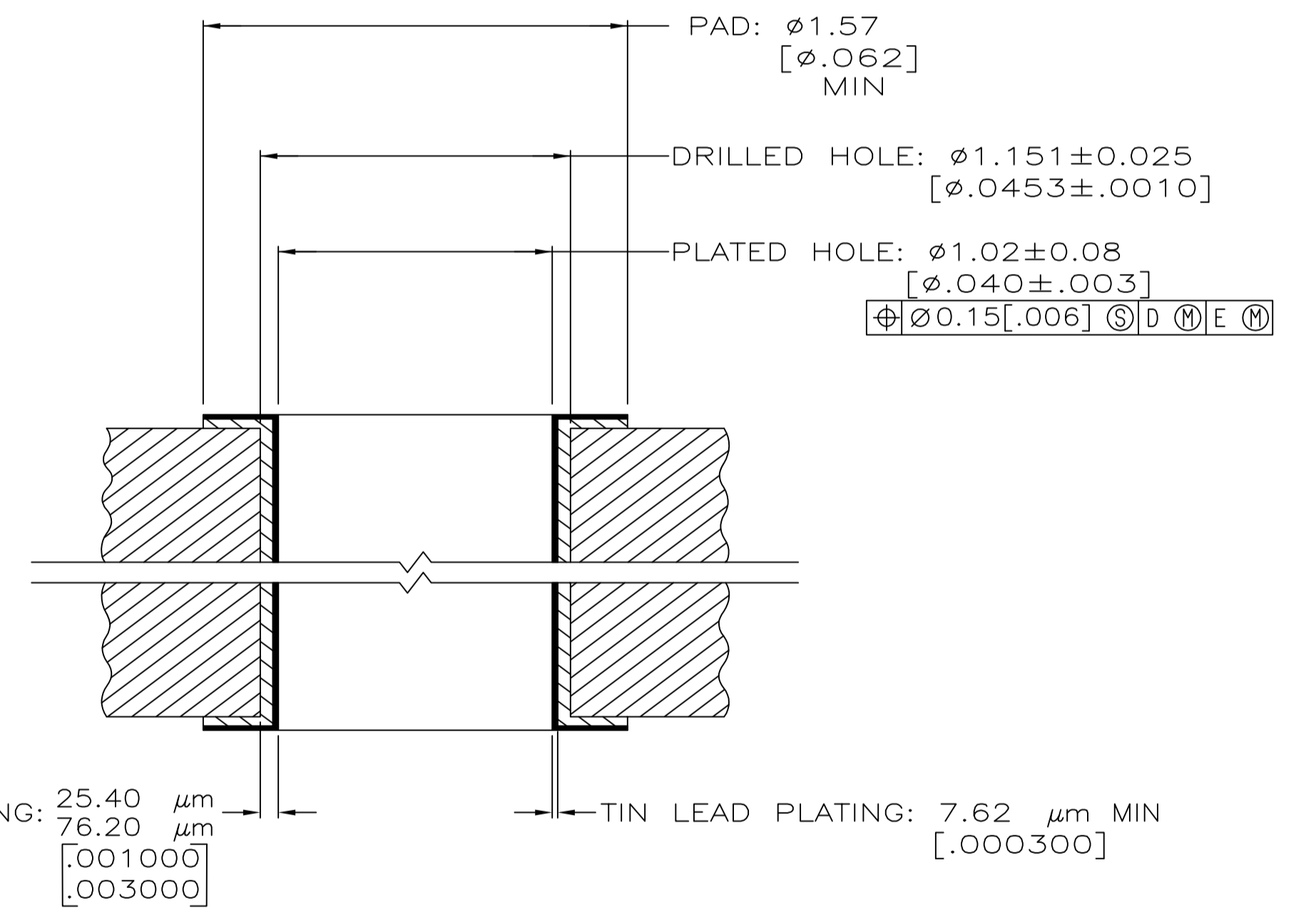

SECTION Z-Z
COPPER HARDNESS: (KNOOP) 150 MAX
SCALE 50:1
62 PLC

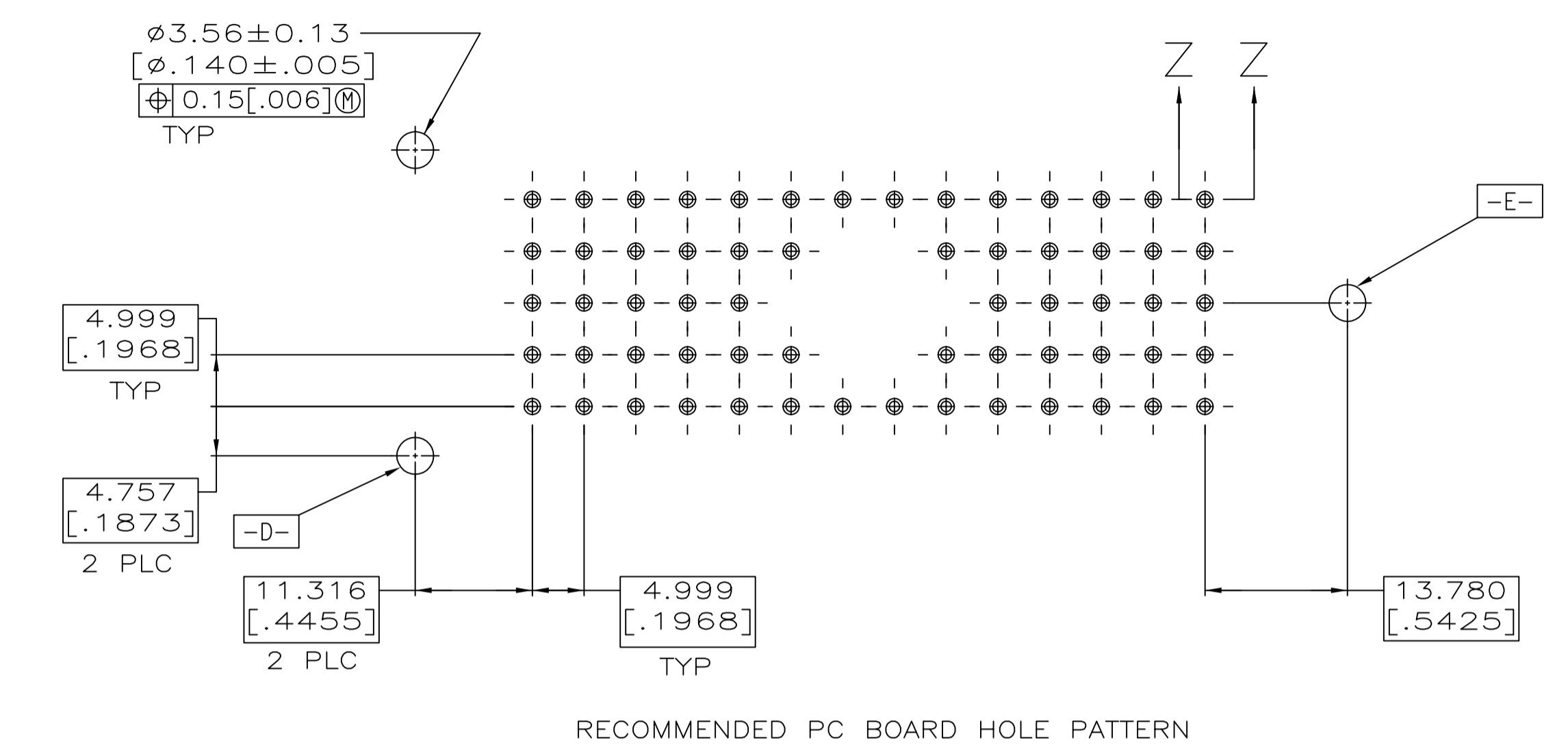
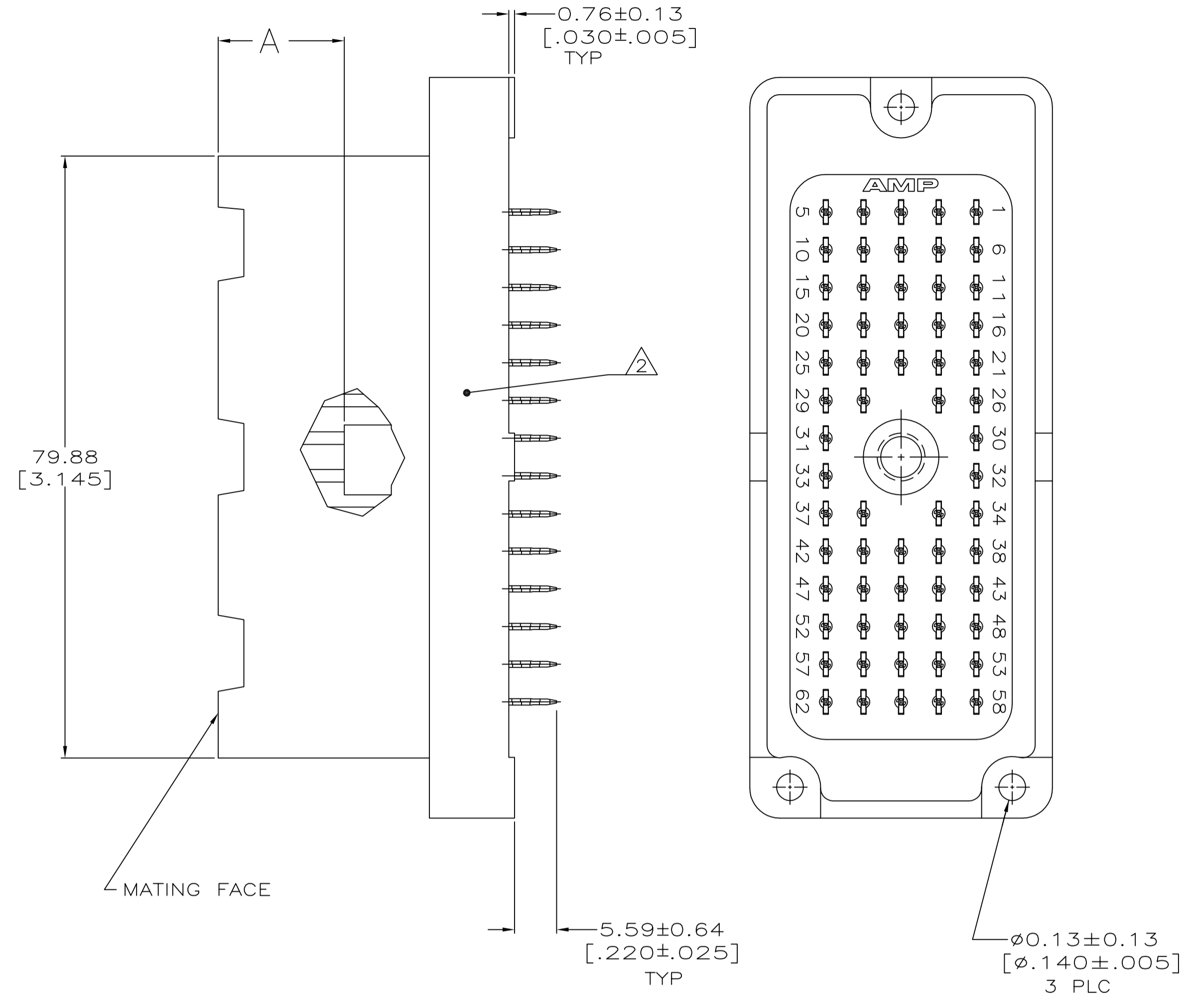
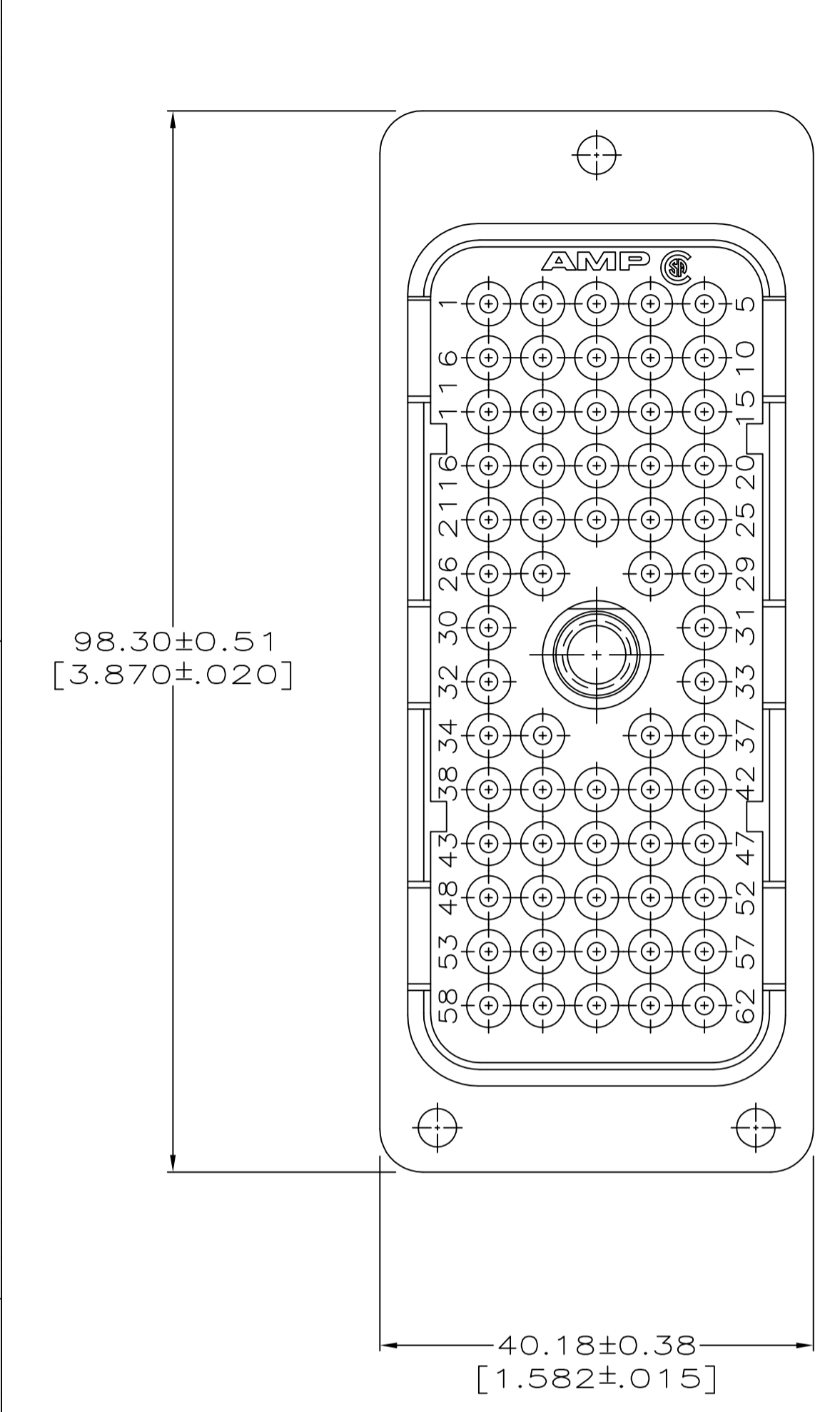
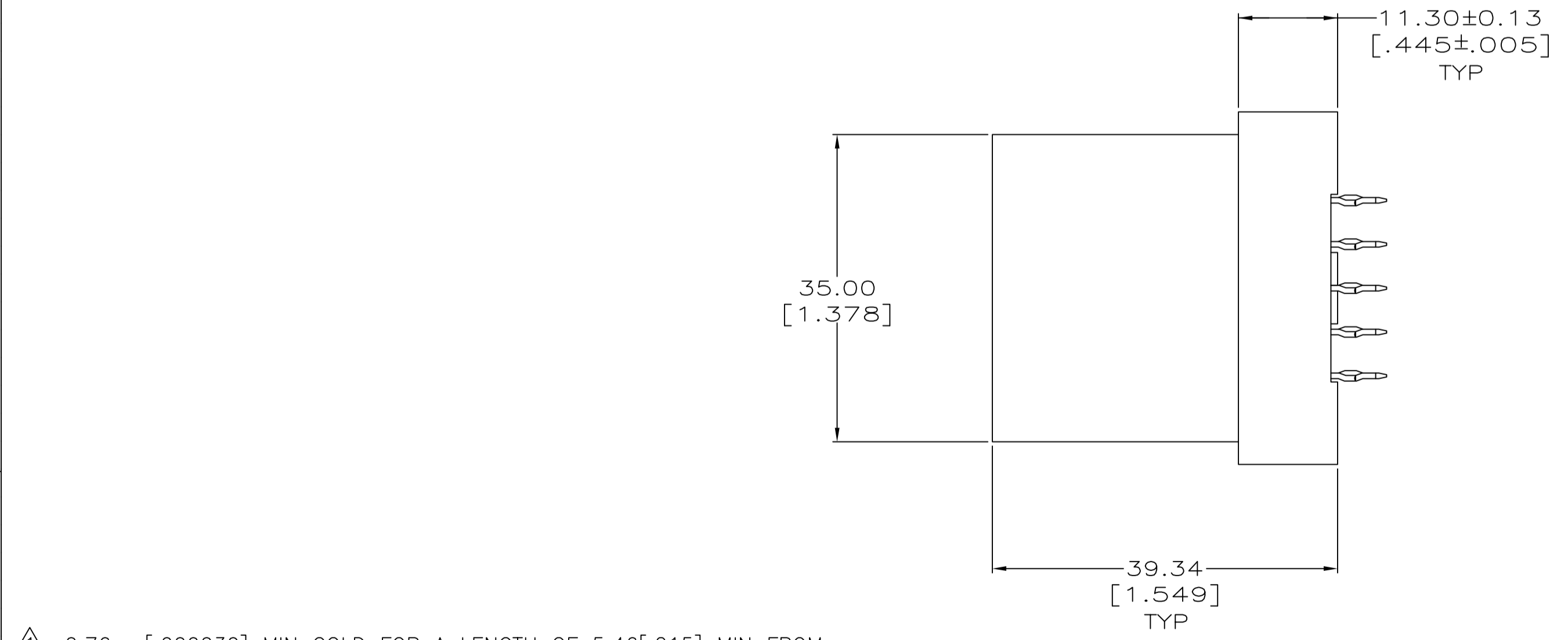

- 1 0.76μm[.000030] MIN GOLD FOR A LENGTH OF 5.46[.215] MIN FROM MATING END, 3.81μm[.000150] MIN TIN-LEAD ON OPPOSITE END FOR A LENGTH OF 5.08[.200] MIN, BOTH OVER 1.27μm[.000050] MIN NICKEL.
- 2 AMP PART NUMBER AND DATE CODE MARKED IN THIS AREA.
- 3 0.76μm[.000030] MIN GOLD FOR A LENGTH OF 7.62[.300] MIN FROM MATING END, 3.81μm[.000150] MIN TIN-LEAD ON OPPOSITE END FOR A LENGTH OF 5.08[.200] MIN, BOTH OVER 1.27μm[.000050] MIN NICKEL.
- 4 0.76μm[.000030] MIN GOLD FOR A LENGTH OF 7.62[.300] MIN FROM MATING END, 3.81μm[.000150] MIN TIN-LEAD ON OPPOSITE END FOR A LENGTH OF 5.08[.200] MIN, BOTH OVER 1.27μm[.000050] MIN NICKEL.
- 5 OBSOLETE PARTS: OBSOLETE CIS STREAMLINING PER D.RENAUD/D.SINISI

	6.60 [.260]	4	213788-3
OBSOLETE	6.60 [.260]	3	213788-2
SUPERSEDED BY 213788-2	17.53 [.690]	1	213788-1
A	CONTACT FINISH		PART NUMBER

DIMENSIONS:		TOLERANCES UNLESS OTHERWISE SPECIFIED:		DIN	
mm [INCHES]		0 PLC	± -	C. OBERMAN	1-5-94
		1 PLC	± -	R. STONE	1-7-94
		2 PLC	± 0.25 [010]		
		3 PLC	± -		
		4 PLC	± -		
		ANGLES	± -		
MATERIAL	FINISH	WEIGHT		SIZE	CAGE CODE
				A1	00779
				DRAWING NO	213788
				RESTRICTED TO	
				CUSTOMER DRAWING	
				SCALE	2:1
				SHEET	1 of 1
				REV	F