

REVISIONS				
P	LTR	DESCRIPTION	DATE	DWN APD
A		FIRST RELEASED	13JUL2021	J.J N.S

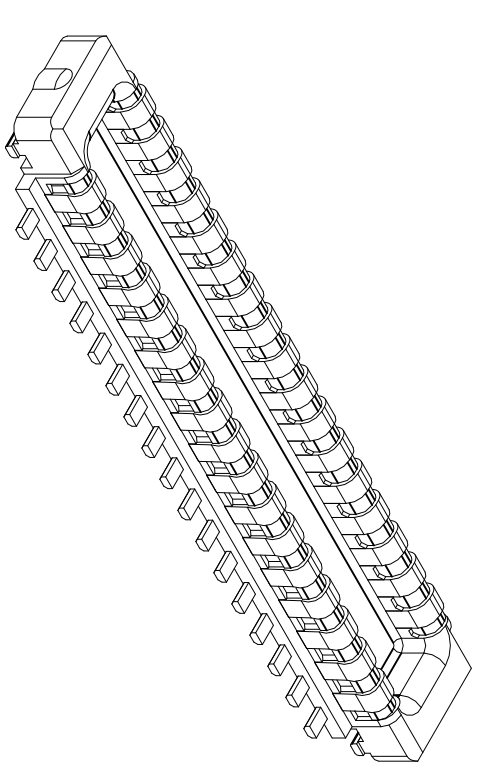

THIS DRAWING IS A CONTROLLED DOCUMENT.		DWN 17JUN2021		NAME	
DIMENSIONS: mm		CHK Jones J 17JUN2021		P.O.4 HO.8 BOARD TO BOARD	
TOLERANCES UNLESS OTHERWISE SPECIFIED:		APD Niki S 17JUN2021		CONN. PLUG.	
0 PLG	±	PRODUCT SPEC		SIZE A2	
1 PLG	± 0.3	APPLICATION SPEC		QAE CODE 00779	
2 PLG	± 0.2	WEIGHT 0		DRAWING NO C-2396002	
3 PLG	± 0.15	CUSTOMER DRAWING		SCALE 1:1	
4 PLG	±			SHEET 1 of 3	
ANGLES	± 3			REV A	
FINISH	-			RESTRICTED TO	
MATERIAL	-				

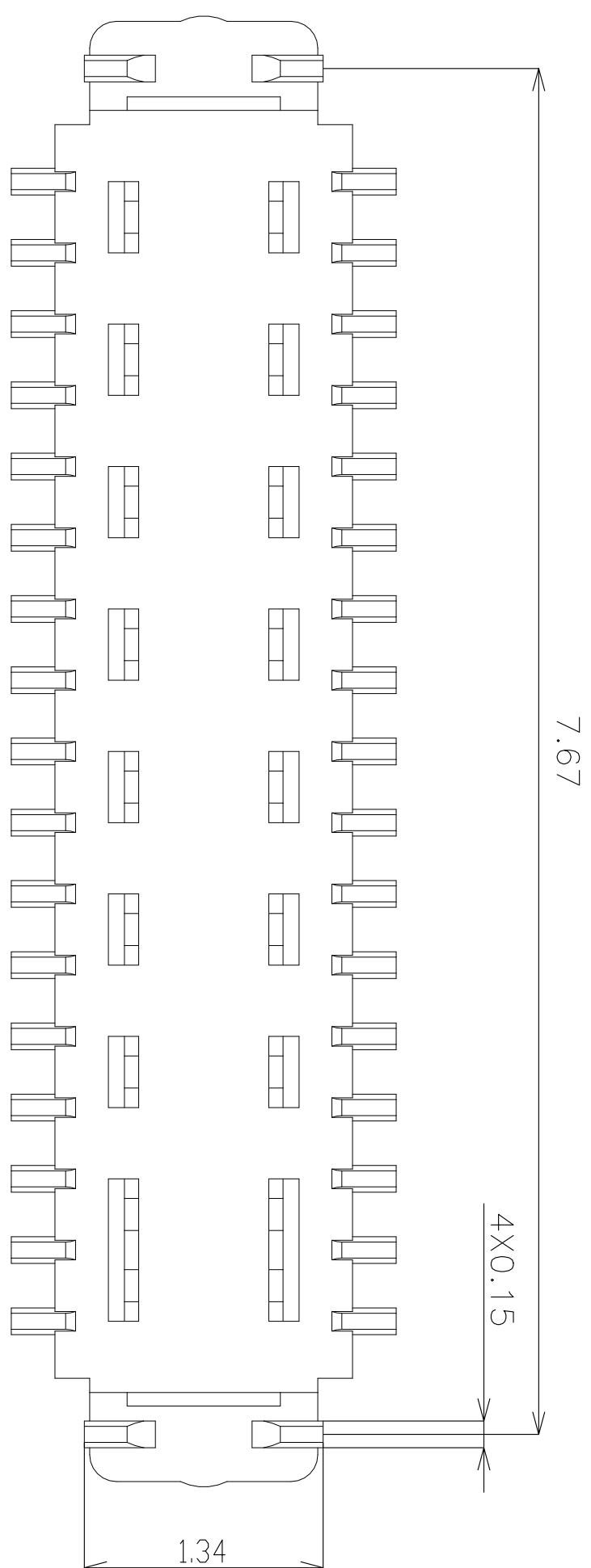
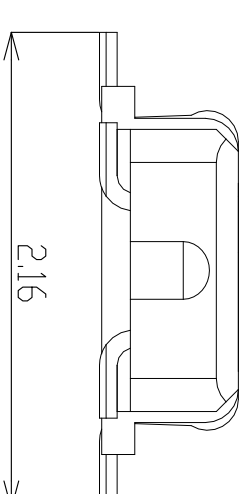
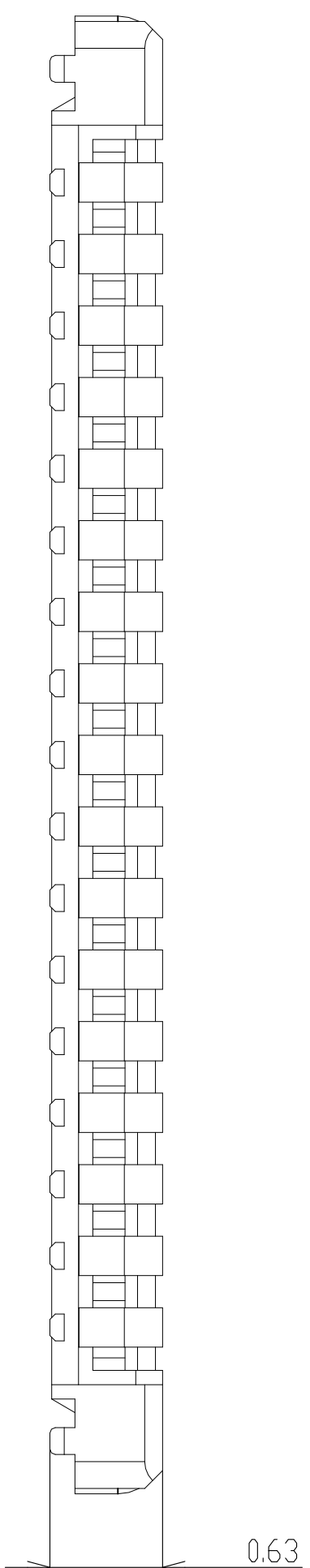
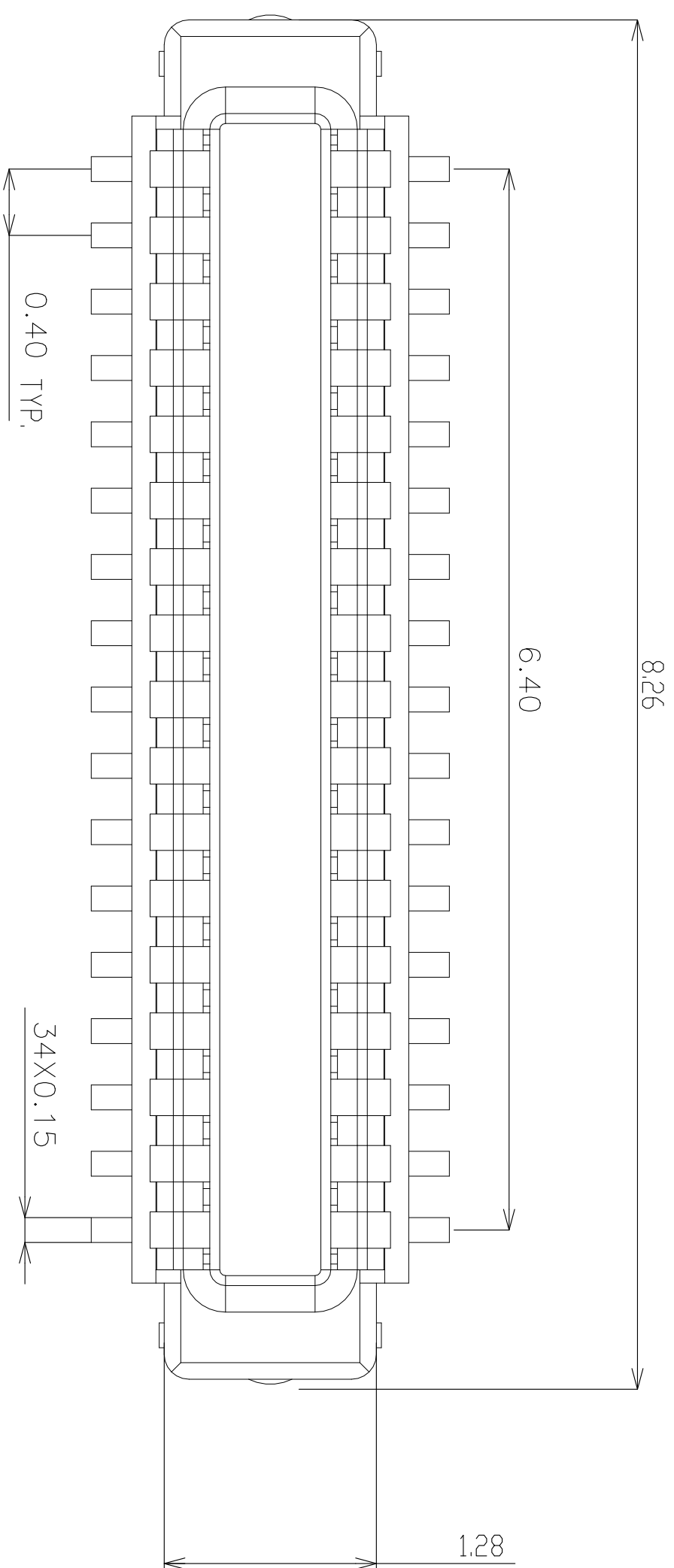

3-2396002-4  
PART NUMBER

2396002

REVISIONS					
P	LTR	DESCRIPTION	DATE	DWN	APPD
-	-	SEE SHEET 1	-	-	-

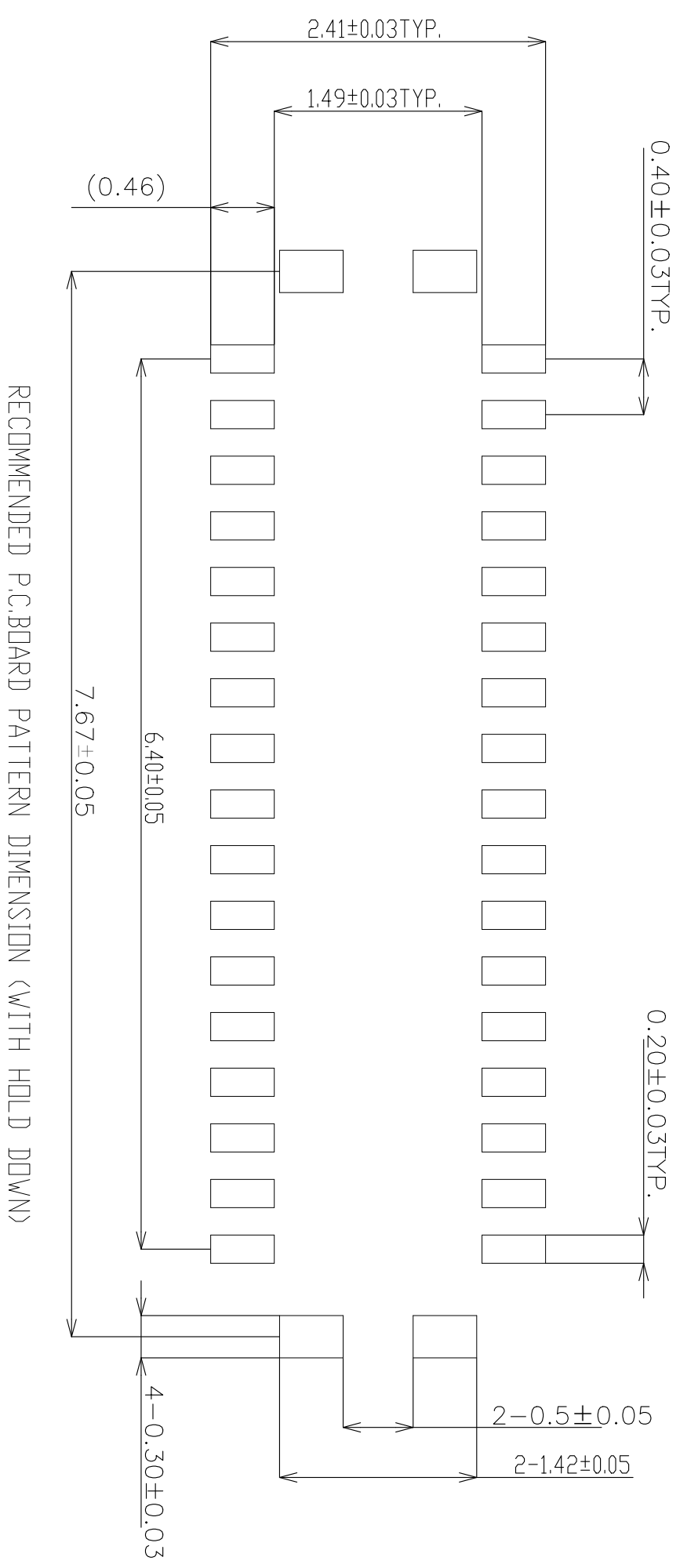

RECOMMENDED P.C. BOARD PATTERN DIMENSION (WITH HOLD DOWN)

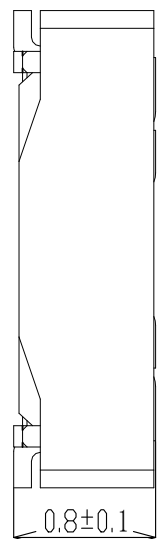

- NOTES:
- 1.MATERIAL:  
 1.1 HOUSING: LCP, UL 94 V-0, COLOR: BLACK,  
 1.2 CONTACT: COPPER ALLOY,  
 1.3 HOLD DOWN: COPPER ALLOY.
2. FINISH:  
 2.1 CONTACT:  
 GOLD FLASH ON CONTACT AND SOLDERING AREA,  
 NICKEL UNDER PLATING OVERALL,  
 2.2 HOLD DOWN:  
 GOLD FLASH PLATING OVER NICKEL UNDER PLATING.
- 3.REFLOW SOLDER CAPABLE TO 260 °C.
- 4.MATING PLUG PART NUMBER: 3-2396001-4.

THIS DRAWING IS A CONTROLLED DOCUMENT.					
DIMENSIONS:		TOLERANCES UNLESS OTHERWISE SPECIFIED			
mm		0 P.L.C.	± 0.3		
		1 P.L.C.	± 0.2		
		2 P.L.C.	± 0.15		
		3 P.L.C.	± 0.15		
		4 P.L.C.	± 0.3		
		ANGLES	± 3		
		FINISH	-		
MATERIAL					
DWN	17JUN2021	STE TE Connectivity Ltd.			
CHK	Jone J				
APPD	17JUN2021				
NAME	Niki S				
PRODUCT SPEC	Niki S				
APPLICATION SPEC					
WEIGHT					
CUSTOMER DRAWING					
SIZE	A2	CAGE CODE	DRAWING NO	RESTRICTED TO	
	00779	2396002		-	
SCALE	1:1	SHEET	2 of 3	REV A	

2396002

REVISIONS				
P	LTR	DESCRIPTION	DATE	DMN
-	-	SEE SHEET 1	-	-

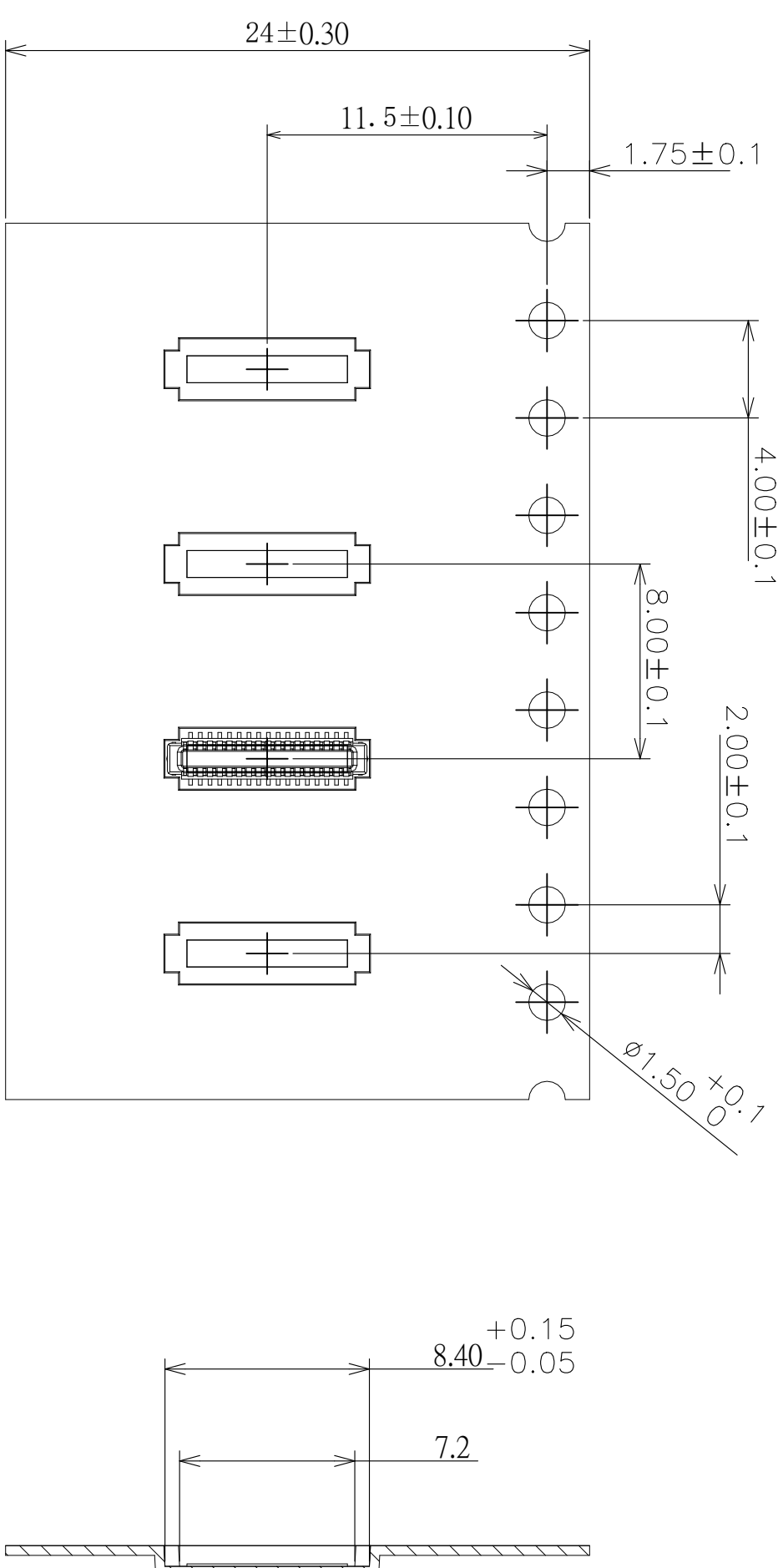

- NOTES :
- PACKAGING MATERIAL IN PLASTIC, RUBBER, INK, PIGMENT AND PAINT MUST MEET CONTROLLED SUBSTANCES SPEC PER 230-702.
  - \* CADMIUM AND CADMIUM COMPOUNDS NOT TO EXCEED: 5 PPM.
  - \* LEAD, CADMIUM, CHROM VI AND MERCURY NOT TO EXCEED: 100 PPM (COMBINED).
  - \* CARRIER TAPES, COVER TAPES, REELS AND TAPED COMPONENTS MUST MEET THE REQUIREMENTS DEFINED PER EIA-481-C.
1. MATERIAL :
- COVER TAPE : PET, COLOR: TRANSPARENT.
  - CARRIER TAPE : POLYSTYRENES,BLACK COLOR.
  - REEL :POLYSTYRENES,BLUE COLOR.
  - SHIPPING BOX: CORRUGATED FIBER
2. DIMENSION :
- REEL : SEE DRAWING
  - SHIPPING BOX : SEE DRAWING
3. QUANTITY : SEE TABLE
4. WEIGHT : SEE TABLE
5. PEELING RESISTANCE : 10gf~130gf
6. PEELING SPEED : 300mm/MINUTES

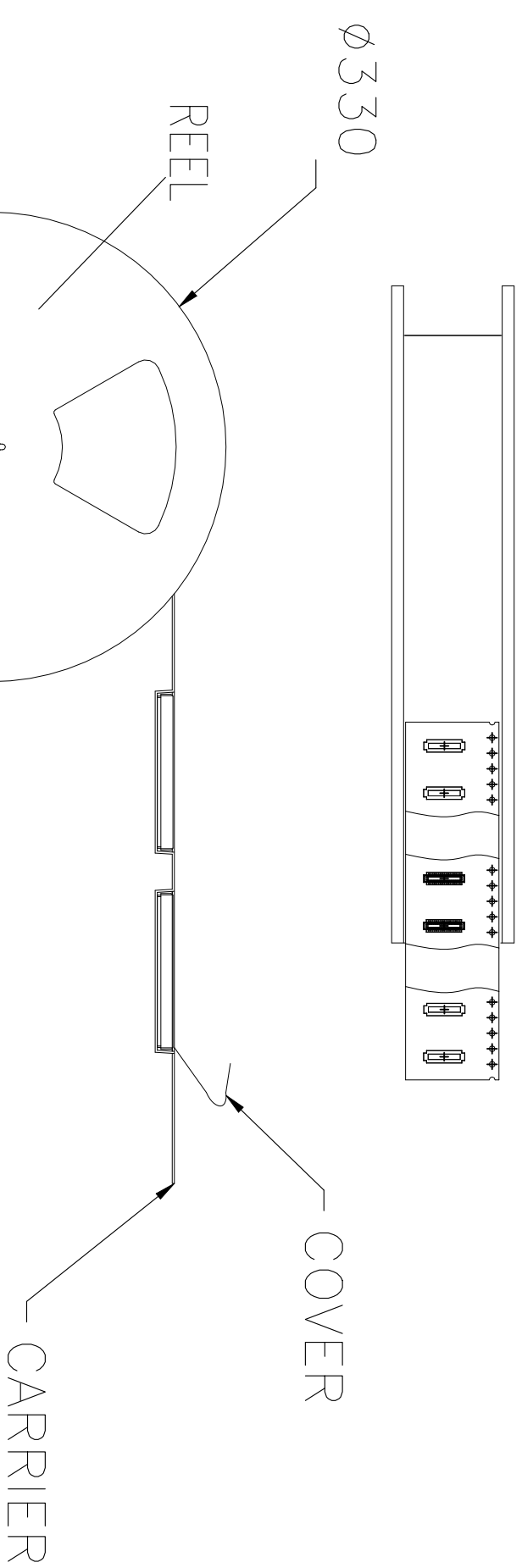
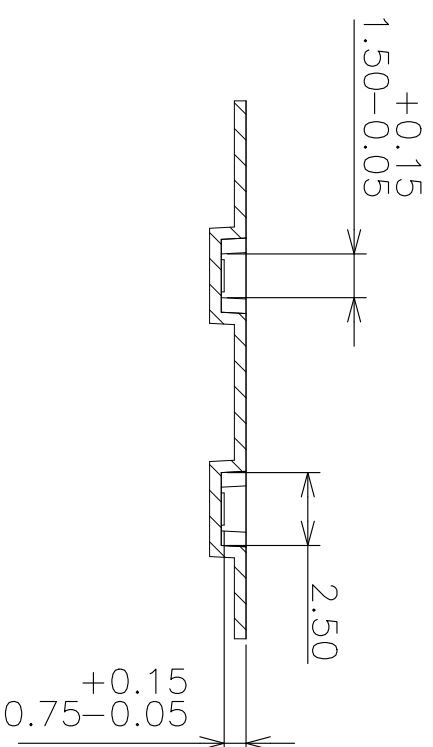
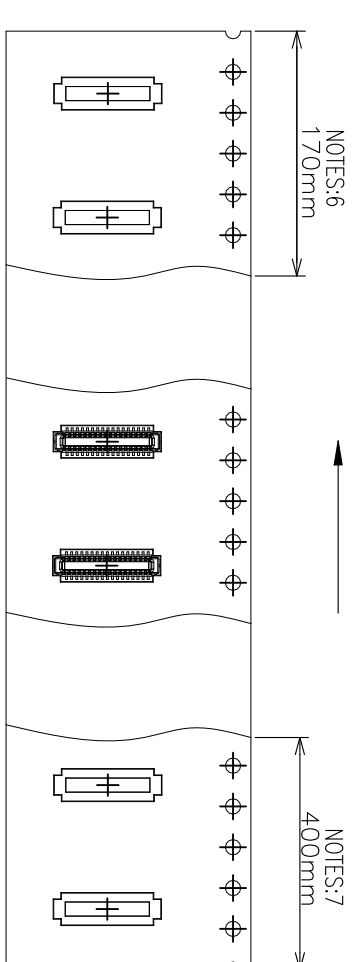

GROSS WEIGHT	NET WEIGHT	PCS/ REEL	REEL/ BOX	PCS/ BOX	PART NUMBER
5.502 KG	0.42 KG	5000	6	30000	3-2396002-4

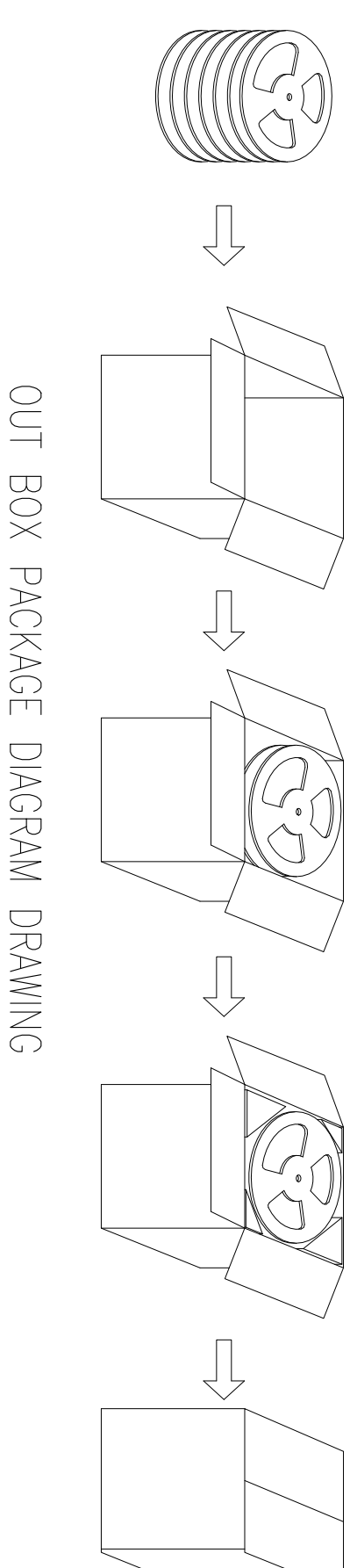

THIS DRAWING IS A CONTROLLED DOCUMENT.		DMN		17JUN2021	
		CHK		17JUN2021	
		APVD		17JUN2021	
DIMENSIONS:		TOLERANCES UNLESS OTHERWISE SPECIFIED:		NAME	
mm		0 PLC ± 0.3		P0.4 HO.8 BOARD TO BOARD	
		1 PLC ± 0.2		CONN. REC.	
		2 PLC ± 0.15			
		3 PLC ± 0.15			
		4 PLC ± 0.3			
MATERIAL		FINISH		APPLICATION SPEC	
				WEIGHT	
				CUSTOMER DRAWING	
				SIZE	
				CASE CODE	
				DRAWING NO	
				SCALE	
				SHEET	
				REV	

**STE** TE Connectivity Ltd.

P0.4 HO.8 BOARD TO BOARD  
CONN. REC.

A2 00779 © 2396002