

THIS DRAWING IS UNPUBLISHED. RELEASED FOR PUBLICATION  
 © COPYRIGHT - By - TE CONNECTIVITY ALL RIGHTS RESERVED.

| LOC | DIST | REVISIONS   |   |           |      |     |
|-----|------|-------------|---|-----------|------|-----|
| P   | LTR  | DESCRIPTION | DATE  | DWN       | APVD |     |
| HB  | -    | G           | REMOVED THE RIB ON THE BASE TO CASE ECO-15-011310 | 29Feb2016 | YS.H | CHL |

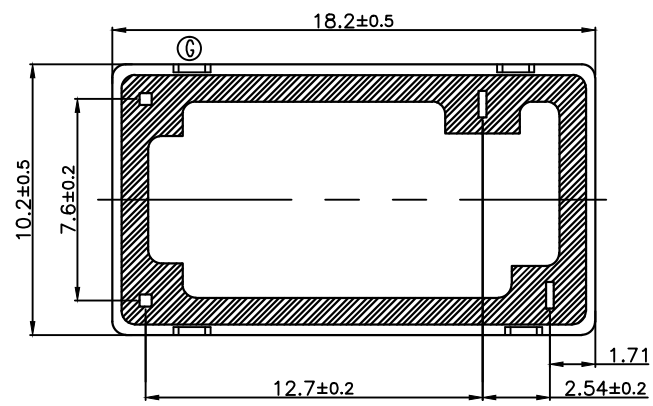
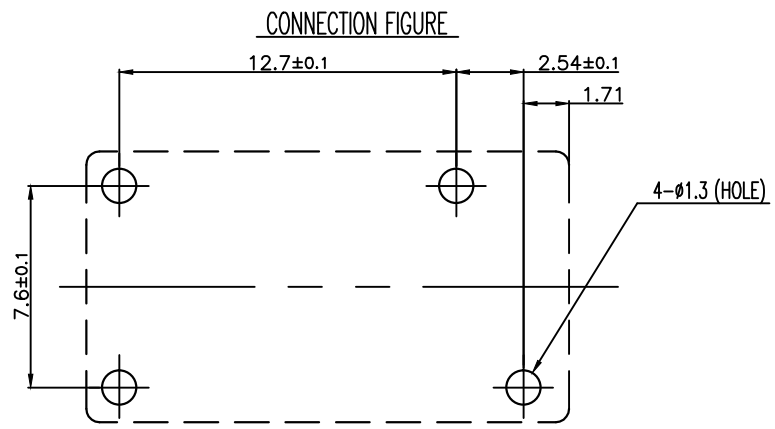
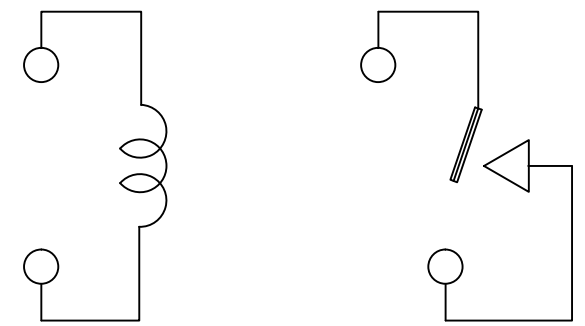
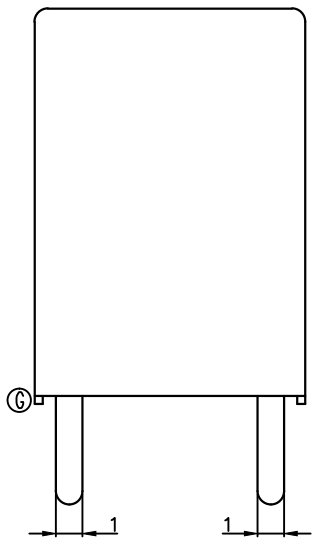
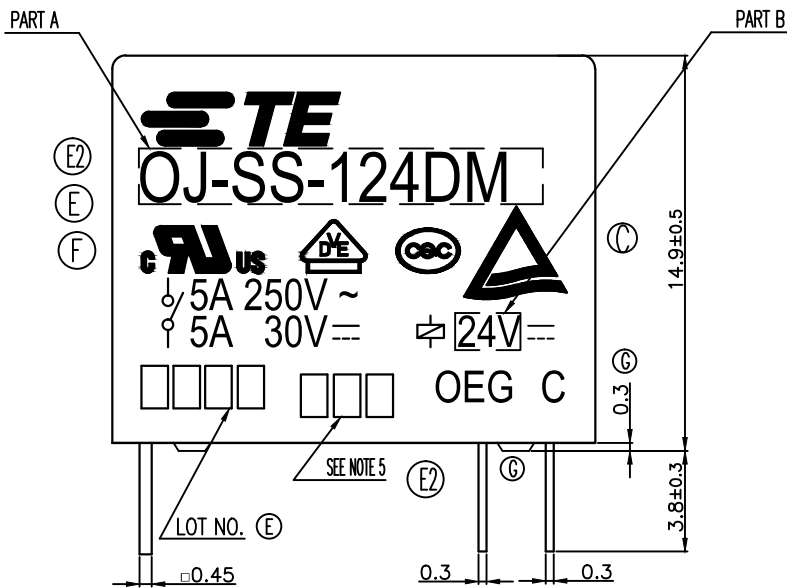
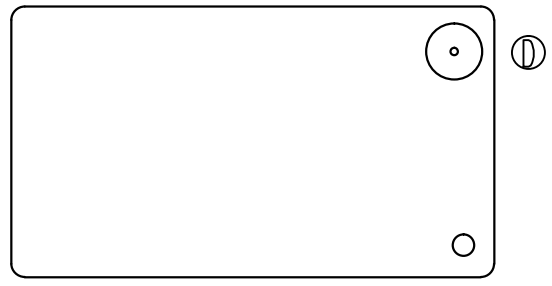

| Diagram dimension | Tolerance |
|-------------------|-----------|
| 0.99mm max.       | ±0.1mm    |
| 1 - 2.99mm        | ±0.2mm    |
| 3mm min.          | ±0.3mm    |

FIGURE FOR PRINTED CIRCUIT BOARD PROCESSING (BOTTOM VIEW)

|   |        |                  |           |     |   |           |            |               |
|---|--------|------------------|-----------|-----|---|-----------|------------|---------------|
| THIS DRAWING IS A CONTROLLED DOCUMENT.                                      |        | DWN              | H.Sasaki  | -   | TE Connectivity<br><b>OJ-SS-DM CUSTOMER DRAWING</b> |           |            |               |
| DIMENSIONS: mm  |        | CHK              | Y.Oikakwa | -   |   |           |            |               |
| TOLERANCES UNLESS OTHERWISE SPECIFIED:                                      |        | APVD             | A.Nagai   | -   |   |           |            |               |
| 0 PLC ± -<br>1 PLC ± -<br>2 PLC ± -<br>3 PLC ± -<br>4 PLC ± -<br>ANGLES ± - |        | PRODUCT SPEC     | -         | -   |   |           |            |               |
| MATERIAL  | FINISH | APPLICATION SPEC | -         | -   | SIZE  | CAGE CODE | DRAWING NO | RESTRICTED TO |
| -   | -      | WEIGHT           | -         | -   | A3  | 00779     | 1461076    | -             |
| CUSTOMER DRAWING  |        |                  | SCALE     | 5:1 | SHEET   | 1 OF 2    | REV        | G             |

THIS DRAWING IS UNPUBLISHED. RELEASED FOR PUBLICATION - , - .  
 © COPYRIGHT - By - TE CONNECTIVITY ALL RIGHTS RESERVED.

|     |      |           |     |             |      |     |      |
|-----|------|-----------|-----|-------------|------|-----|------|
| LOC | DIST | REVISIONS |     |             |      |     |      |
| HB  | -    | P         | LTR | DESCRIPTION | DATE | DWN | APVD |
|     |      | -         |     | SEE SHEET 1 | -    | -   | -    |

|             |             |              |        |             |      |
|-------------|-------------|--------------|--------|-------------|------|
| 1461076-3   | OJ-SS-118DM | 107-79010    | 18VDC  | OJ-SS-118DM | h    |
| 4-1419144-6 | OJ-SS-148DM | 107-79010    | 48VDC  | OJ-SS-148DM | g    |
| 2-1419129-9 | OJ-SS-124DM | 107-79010    | 24VDC  | OJ-SS-124DM | f    |
| 1-1419129-8 | OJ-SS-112DM | 107-79010    | 12VDC  | OJ-SS-112DM | e    |
| 1-1419129-5 | OJ-SS-109DM | 107-79010    | 9VDC   | OJ-SS-109DM | d    |
| 1461076-2   | OJ-SS-106DM | 107-79010    | 6VDC   | OJ-SS-106DM | c    |
| 3-1419144-7 | OJ-SS-105DM | 107-79010    | 5VDC   | OJ-SS-105DM | b    |
| 1461076-1   | OJ-SS-103DM | 107-79010    | 3VDC   | OJ-SS-103DM | a    |
| PART NO     | TYPE NAME   | PACKAGE SPEC | PART B | PART A      | TYPE |

RELAY TYPE

ⒺⒸ NOTE:

1. LOT NO. SYSTEM AS FOLLOWS:

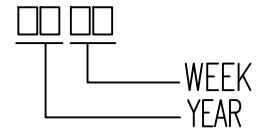

ⒺⒶ 2. TERMINAL DIMENSION IS BEFORE SOLDER DIP;

ⒺⒶ 3. FOR THE TIN-PLATING OF THE PINS:  
 +0.1mm FOR WIDTH, THICKNESS AND DIAMETER.  
 +0.5mm FOR LENGTH.

ⒺⒶ 4. USED WELDED CONTACT & LASER MARKING.

ⒺⒶ 6. ADD LOT NO. SYSTEM AS FOLLOWING;

ⒺⒶ I, DIGITS FOR DAY OF THE WEEK  
 I II III

- 1...MONDAY IN THIS WEEK;
- 2...TUESDAY IN THIS WEEK;
- .....
- 7...SUNDAY IN THIS WEEK

II, DIGITS FOR SHIFT OF THE DAY  
 1...DAY SHIFT IN THIS DAY;  
 2...NIGHT SHIFT IN THIS DAY;

III, ONE CHARACTER DISTINGUISH THE LINE IDENTITY, SUCH AS: A,B,....Z

|                  |            |             |                      |      |
|------------------|------------|-------------|----------------------|------|
|                  |            | EPOXY RESIN | SEAL (BASE & BOBBIN) | 15   |
|                  |            | JUEW        | MAGNETIC WIRE        | 14   |
| 94V-0            |            | P.B.T       | CASE                 | 13   |
| 94V-0            |            | P.B.T       | BASE                 | 12   |
| 94V-0            |            | P.B.T       | BOBBIN               | 11   |
|                  | SOLDER DIP | C.P WIRE    | COIL TERMINAL        | 10   |
| 94V-0            |            | P.P.S       | CARD                 | 9    |
|                  |            | Ag ALLOY    | MOVABLE CONTACT      | 8    |
|                  |            | Ag          | NO.CONTACT           | 7    |
|                  |            | STEEL       | HINGE SPRING         | 6    |
|                  | SOLDER DIP | PBP         | NO.TERMINAL          | 5    |
|                  | SOLDER DIP | PBS         | MOVABLE SPRING       | 4    |
|                  | NIP        | STEEL       | CORE                 | 3    |
|                  | NIP        | STEEL       | ARMATURE             | 2    |
|                  | NIP        | STEEL       | YOKE                 | 1    |
| INCOMBUSTIBILITY | TREATMENT  | MATERIAL    | DESCRIPTION          | ITEM |

|  |        |        |           |                  |           |            |               |
|--|--------|--------|-----------|------------------|-----------|------------|---------------|
| THIS DRAWING IS A CONTROLLED DOCUMENT. |        | DWN    | H.Sasaki  | -                |           |            |               |
| DIMENSIONS: mm                         |        | CHK    | Y.Oikakwa | -                |           |            |               |
| TOLERANCES UNLESS OTHERWISE SPECIFIED: |        | APVD   | A.Nagai   | -                |           |            |               |
|  | 0 PLC  | ±      | -         | NAME             |           |            |               |
|  | 1 PLC  | ±      | -         | -                |           |            |               |
|  | 2 PLC  | ±      | -         | PRODUCT SPEC     |           |            |               |
|  | 3 PLC  | ±      | -         | -                |           |            |               |
|  | 4 PLC  | ±      | -         | APPLICATION SPEC |           |            |               |
| MATERIAL                               | FINISH | WEIGHT | -         | SIZE             | CAGE CODE | DRAWING NO | RESTRICTED TO |
| -                                      | -      | -      | -         | A3               | 00779     | Ⓒ= 1461076 | -             |
| CUSTOMER DRAWING                       |        |        |           | SCALE            | 5:1       | SHEET      | 2 OF 2        |
|  |        |        |           | REV              | G         |            |               |



OJ-SS-DM CUSTOMER DRAWING