

PART NUMBER	REV	FIRST USED	POWER UNIT	FEED TYPE	DESCRIPTION
1852577-1	A	122500-1	LEADMAKER	AIR FEED	CUTS CARRIER
1852577-2	A	565435-5	BENCH MODEL K	AIR FEED	CUTS CARRIER
1852577-3	A	354500-1	BENCH MODEL G	AIR FEED	CUTS CARRIER
7-1852577-7	A	-	-	-	SPARE PARTS

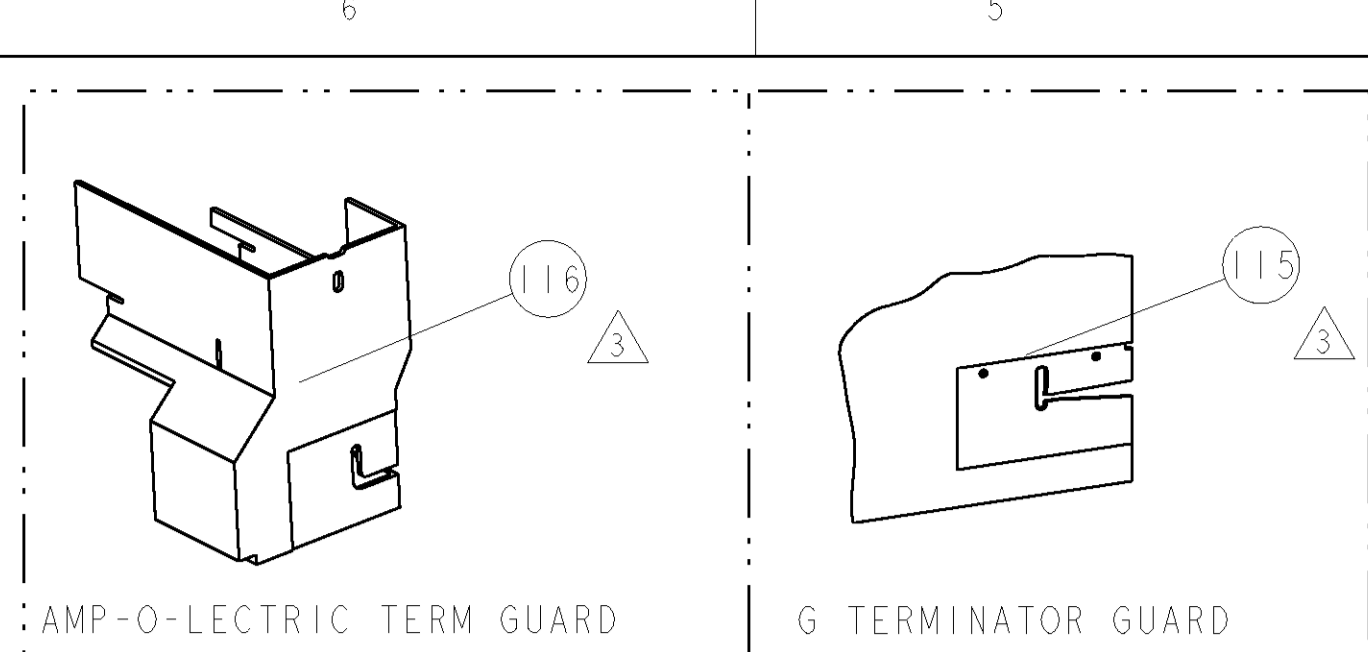

TERMINAL NAME: MEDIUM RING TERMINAL			
TE PN	MANUF PN	ARK-LES TERM - TE CRIMP SPECS	
1949539-1	56586-2		
		PAD LTR	CRIMP HEIGHT
-	-	A	2.67±0.05mm (.105±.002)
-	-	B	2.51±0.05mm (.099±.002)
-	-	C	-
-	-	D	-
		CRIMP	SIZE
-	-	WIRE	3.56mm (.140)
-	-	INSUL	-
		FEED	APPLICATOR INSTRUCTIONS
4.90-5.28mm	NONE	1.18mm	408-8040
			SET UP GAGE
			458637-1

- 1 RECOMMENDED SPARE PARTS
- 2 GREASE LIGHTLY
- 3 GUARD MUST BE IN PLACE WHEN OPERATING APPLICATOR IN A BENCH MACHINE
- 4 INSTALL ITEMS 101, 102 AND 119 ON SIDE OF STRIPPER ON APPL HOUSING USING ITEM 21

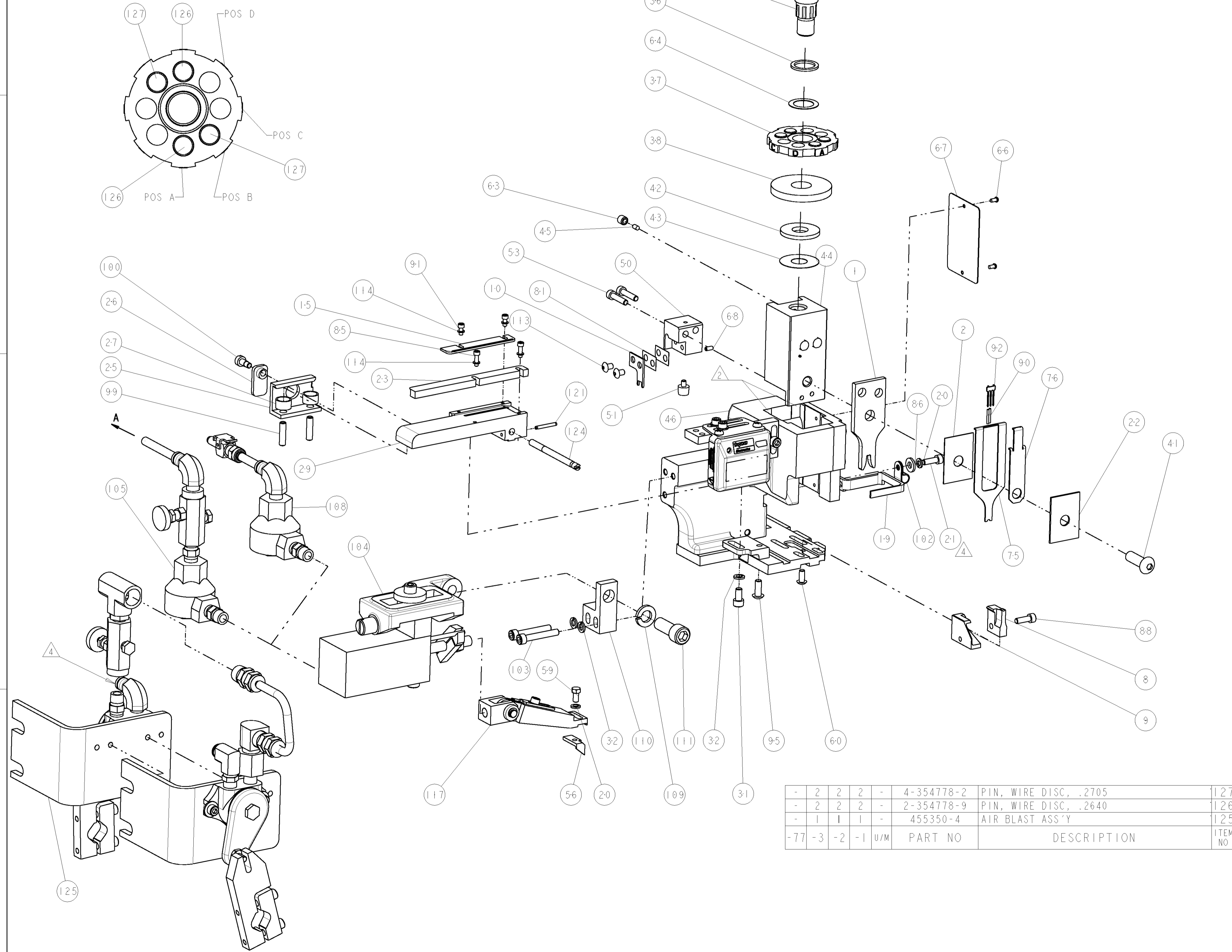

-77	-3	-2	-1	U/M	PART NO	DESCRIPTION	ITEM NO
-	-	-	-	-	4-354778-2	PIN, WIRE DISC, .2705	127
-	-	-	-	-	2-354778-9	PIN, WIRE DISC, .2640	126
-	-	-	-	-	455350-4	AIR BLAST ASS'Y	125

LOC		DIST		REVISIONS			
A	66	F	LTR	DESCRIPTION	DATE	DWN	APPR
		A		PRODUCT RELEASE	11DEC2007	CMR	TE

4	-	1	1	1	-	690432-3	ADJUSTMENT SCREW	124
4	-	1	1	1	-	4-21028-0	PIN, SLOTTED SPRING .094 X .750	121
4	-	18	REF	VAR	IN	27319-4	TUBING 1/4" O.D.	119
	-	-	REF	-	-	692655-6	AIR FEED VALVE ASSEMBLY	118
	-	1	1	1	-	461062-1	FEED FINGER ASSEMBLY	117
3	-	-	REF	-	-	455749-1	GUARD WINDOW	116
3	-	REF	-	-	-	679532-1	INSERT, GUARD	115
	-	4	4	4	-	21024-2	WASHER, SPRG LOCK, REG NO 4	114
	-	2	2	2	-	2-21002-0	SCR, BTN SKT HD CAP 8-32 X .250	113
	-	1	1	1	-	3-21001-5	SCR, SKT HD CAP 3/8-16 X 1.000	111
	-	1	1	1	-	459610-1	MOUNT, FEED BRACKET	110
	-	1	1	1	-	21024-8	WASHER, SPRG LOCK, REG 3/8	109
	-	1	-	1	-	692655-7	AIR FEED VALVE ASSEMBLY	108
	-	-	1	-	-	24024-2	VALVE, SHUT OFF	106
	-	-	1	-	-	692655-5	AIR FEED VALVE ASSEMBLY	105
	-	1	1	1	-	461065-1	ASSEMBLY, AIR FEED	104
	-	2	2	2	-	4-21000-0	SCR, SKT HD CAP 10-32 X 1.250	103
	-	1	1	1	-	986220-3	CLAMP, CABLE, BLACK	102
	-	1	1	1	-	23238-1	INSERT, COUPLING	101
	-	1	1	1	-	22353-8	SCR, SHLD, SLOT HD, 3/16 DIA	100
	-	2	2	2	-	5-21006-6	SCR, SET, CUP POINT 10-32 X .750	99
	-	1	1	1	-	2-21002-7	SCR, BTN SKT HD CAP 10-32 X .500	95
	-	1	1	1	-	1424350-1	HOLDER, PIN, WIRED	92
	-	2	2	2	-	1-21000-3	SCR, SKT HD CAP 4-40 X .250	91
	-	2	2	2	-	2-23147-2	SPRING, COMPRESSION	90
	-	1	1	1	-	2-21000-7	SCR, SKT HD CAP 8-32 X .500	88
	-	1	1	1	-	21055-7	WASHER, FLAT, REG NO 10	86
	-	2	2	2	-	1-21000-4	SCR, SKT HD CAP 4-40 X .375	85
	-	2	2	2	-	4-240641-9	SPACER	81
	-	1	1	1	-	1490524-2	DEPRESSOR, SPACER	76
	-	1	1	1	-	1490525-1	DEPRESSOR, WIRE	75
	-	1	1	1	-	4088040	SF APPL INST 408-8040	72
	-	1	1	1	-	217238-1	GENERAL INSTRUCTION PKG	71
	-	1	1	1	-	2-21008-2	SCR, SET, SELF LOCKING 1/4-20 X .250	68
	-	1	1	1	-	461264-1	PLATE, IDENTIFICATION	67
	-	2	2	2	-	21017-2	SCREW, DRIVE	66
	-	1	1	1	-	986950-1	WASHER, FLAT PRECISION	64
	-	1	1	1	-	21009-2	SCR, SET, SELF LOCKING 1/4-20 X .250	63
	-	1	1	1	-	22733-8	SCR, BHSC, SELF-LOCKING, 8-32 X .375	60
	-	1	1	1	-	2-22603-0	SCR, HEX HD CAP 8-32 X .312	59
	-	1	1	1	-	3-694433-9	FEED PAWL	56
	-	2	2	2	-	2-21000-9	SCR, SKT HD CAP 8-32 X .750	53
	-	1	1	1	-	811242-1	BUMPER, HOLD DOWN	51
	-	1	1	1	-	1583893-6	HOLDER, SLUG BLADE	50
	-	1	1	1	-	1633399-1	APPL., BASIC AIR FEED SUB ASSY	46
	-	1	1	1	-	690191-1	PLUG, NYLON	45
	-	1	1	1	-	455673-6	RAM, SIDE FEED	44
	-	1	1	1	-	690125-1	SHIM SUB-ASSY	43
	-	1	1	1	-	690124-1	WASHER, RAM (.115)	42
	-	1	1	1	-	7-21002-9	SCR, BTN SKT HD CAP 5/16-24 X 1.00	41
	-	1	1	1	-	690223-1	SPACER, INS.	38
	-	1	1	1	-	354777-1	WIRE DISC, ASSEMBLY	37
	-	1	1	1	-	22480-5	SPRING, COMPRESSION	36
	-	1	1	1	-	690212-1	POST, RAM	35
	-	3	3	3	-	21024-5	WASHER, SPRG LOCK, REG NO 10	32
	-	1	1	1	-	3-21000-4	SCR, SKT HD CAP 10-32 X .375	31
	-	1	1	1	-	3-844048-6	PLATE, REAR STRIP GUIDE	29
	-	2	2	2	-	1-22284-0	SPRING, COMPRESSION	27
	-	1	1	1	-	240793-1	LEVER, DRAG RELEASE	26
	-	1	1	1	-	240792-1	DRAG, TERMINAL	25
	-	1	1	1	-	1-189124-8	GUIDE, FRONT STRIP	23
	-	1	1	1	-	1-455888-0	SPACER, CRIMPER	22
	-	1	1	1	-	2-21000-7	SCR, SKT HD CAP 8-32 X .500	21
	-	2	2	2	-	21024-4	WASHER, SPRG LOCK, REG NO 8	20
	-	1	1	1	-	1-456468-1	STRIPPER, SPECIAL	19
	-	1	1	1	-	1-690438-5	FRONT STRIP GUIDE	15
	-	1	1	1	-	1-1583859-2	BLADE, SLUG	10
	-	1	1	1	-	1-1633124-5	PLATE, REAR SHEAR	9
	-	1	1	1	-	1424383-3	ANVIL, SPECIAL CENTER CARRIER NO INS	8
	-	1	1	1	-	455888-4	SPACER, CRIMPER	2
	-	1	1	1	-	9-1673600-1	CRIMPER, WIRE	1

DIMENSIONS: INCHES 		TOLERANCES UNLESS OTHERWISE SPECIFIED: 0 PLC ±.01 1 PLC ±.01 2 PLC ±.01 3 PLC ±.001 4 PLC ±.001 ANGLES ±.0001		DWN: C. REICHELE CHK: T. ELBIN APVD: W. DEMMING DATE: 09NOV2007 NAME: SIDE FEED HDM APPLICATOR PRODUCT SPEC: - APPLICATION SPEC: - WEIGHT: - CUSTOMER DRAWING: -		Tyco Electronics Harrisburg, PA 17105-3608 SCALE: 3:5 SHEET: 1 OF 1 REV: A	
---------------------------	--	---	--	--	--	--	--

CUSTOMER VIEWABLE ASSEMBLY