

THIS DRAWING IS UNPUBLISHED. RELEASED FOR PUBLICATION  
 © COPYRIGHT - By - TE CONNECTIVITY ALL RIGHTS RESERVED.

LOC	DIST	REVISIONS					
CM	0	P	LTR	DESCRIPTION	DATE	DWN	APVD
		U		REVISED PER ECR-20-000822	27MAY2020	PC	SW

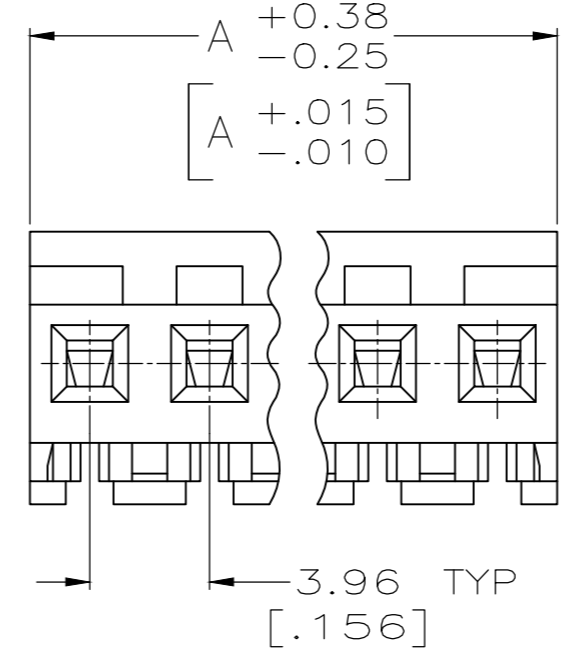
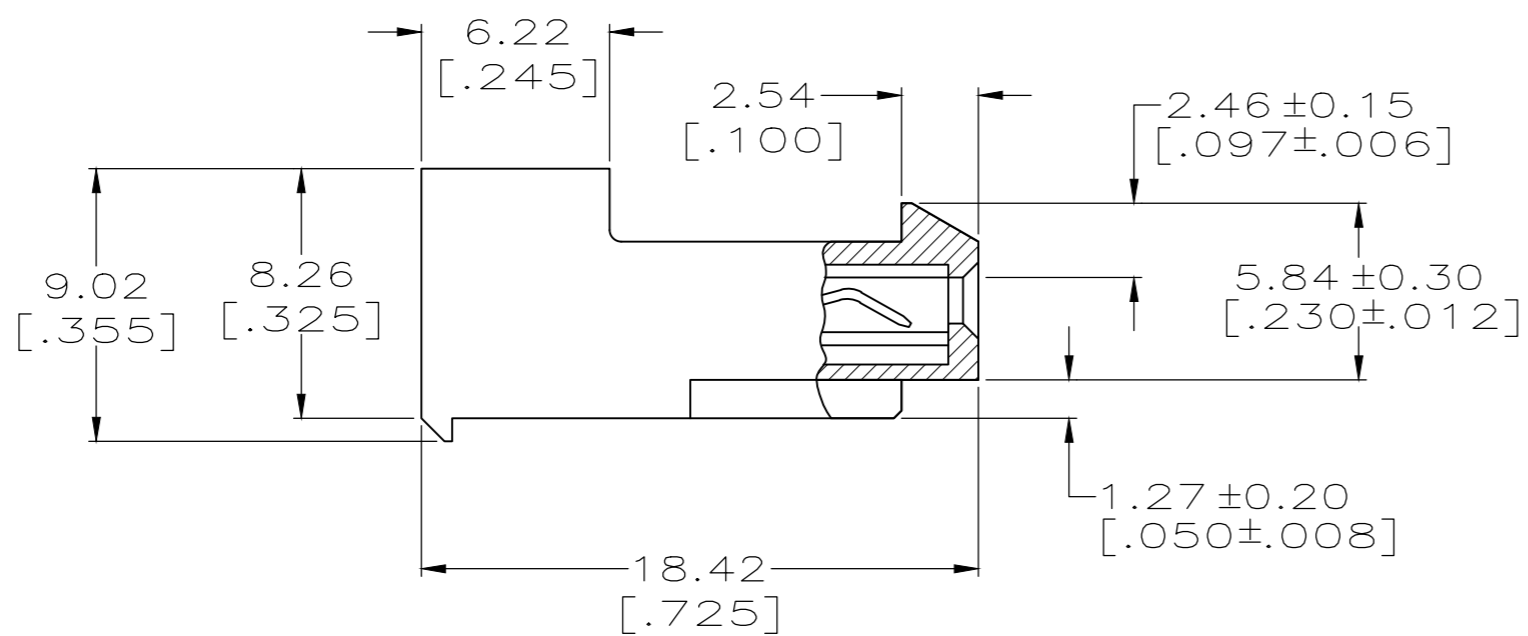
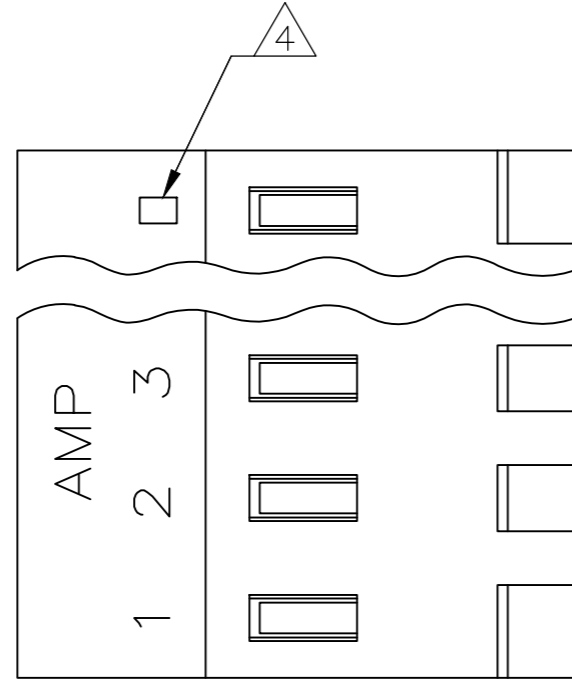

CONTACT FINISH	DIM A	NO. OF CIRCUITS	PART NO.
TIN	95.10 [3.744]	24	5-641150-4
TIN	91.14 [3.588]	23	5-641150-3
TIN	87.17 [3.432]	22	5-641150-2
TIN	83.21 [3.276]	21	5-641150-1
TIN	79.25 [3.120]	20	5-641150-0
TIN	75.29 [2.964]	19	4-641150-9
TIN	71.32 [2.808]	18	4-641150-8
TIN	67.36 [2.652]	17	4-641150-7
TIN	63.40 [2.496]	16	4-641150-6
TIN	59.44 [2.340]	15	4-641150-5
TIN	55.47 [2.184]	14	4-641150-4
TIN	51.51 [2.028]	13	4-641150-3
TIN	47.55 [1.872]	12	4-641150-2
TIN	43.59 [1.716]	11	4-641150-1
TIN	39.62 [1.560]	10	4-641150-0
TIN	35.66 [1.404]	9	3-641150-9
TIN	31.70 [1.248]	8	3-641150-8
TIN	27.74 [1.092]	7	3-641150-7
TIN	23.77 [.936]	6	3-641150-6
TIN	19.81 [.780]	5	3-641150-5
TIN	15.85 [.624]	4	3-641150-4
TIN	11.89 [.468]	3	3-641150-3
TIN	7.92 [.312]	2	3-641150-2
<del>SUPERSEDED</del>	<del>95.10 [3.744]</del>	<del>24</del>	<del>2-641150-4</del>
<del>SUPERSEDED</del>	<del>91.14 [3.588]</del>	<del>23</del>	<del>2-641150-3</del>
<del>SUPERSEDED</del>	<del>87.17 [3.432]</del>	<del>22</del>	<del>2-641150-2</del>
<del>SUPERSEDED</del>	<del>83.21 [3.276]</del>	<del>21</del>	<del>2-641150-1</del>
<del>SUPERSEDED</del>	<del>79.25 [3.120]</del>	<del>20</del>	<del>2-641150-0</del>
<del>SUPERSEDED</del>	<del>75.29 [2.964]</del>	<del>19</del>	<del>1-641150-9</del>
<del>SUPERSEDED</del>	<del>71.32 [2.808]</del>	<del>18</del>	<del>1-641150-8</del>
<del>SUPERSEDED</del>	<del>67.36 [2.652]</del>	<del>17</del>	<del>1-641150-7</del>
<del>SUPERSEDED</del>	<del>63.40 [2.496]</del>	<del>16</del>	<del>1-641150-6</del>
<del>SUPERSEDED</del>	<del>59.44 [2.340]</del>	<del>15</del>	<del>1-641150-5</del>
<del>SUPERSEDED</del>	<del>55.47 [2.184]</del>	<del>14</del>	<del>1-641150-4</del>
<del>SUPERSEDED</del>	<del>51.51 [2.028]</del>	<del>13</del>	<del>1-641150-3</del>
<del>SUPERSEDED</del>	<del>47.55 [1.872]</del>	<del>12</del>	<del>1-641150-2</del>
<del>SUPERSEDED</del>	<del>43.59 [1.716]</del>	<del>11</del>	<del>1-641150-1</del>
<del>OBSOLETE</del>	<del>39.62 [1.560]</del>	<del>10</del>	<del>1-641150-0</del>
<del>SUPERSEDED</del>	<del>35.66 [1.404]</del>	<del>9</del>	<del>641150-9</del>
<del>SUPERSEDED</del>	<del>31.70 [1.248]</del>	<del>8</del>	<del>641150-8</del>
<del>SUPERSEDED</del>	<del>27.74 [1.092]</del>	<del>7</del>	<del>641150-7</del>
<del>OBSOLETE</del>	<del>23.77 [.936]</del>	<del>6</del>	<del>641150-6</del>
<del>OBSOLETE</del>	<del>19.81 [.780]</del>	<del>5</del>	<del>641150-5</del>
<del>OBSOLETE</del>	<del>15.85 [.624]</del>	<del>4</del>	<del>641150-4</del>
<del>OBSOLETE</del>	<del>11.89 [.468]</del>	<del>3</del>	<del>641150-3</del>
<del>OBSOLETE</del>	<del>7.92 [.312]</del>	<del>2</del>	<del>641150-2</del>

1 MATERIAL:  
 CONNECTOR - NYLON UL94V-2 (RED).  
 CONTACTS - 0.30[.012] THICK COPPER ALLOY.  
 PLATING - 0.00038[.000015] GOLD THK OR 0.00008[.000003] MIN THK GOLD FLASH OVER 0.00030[.000012] THK PALLADIUM NICKEL, PER TE CONNECTIVITY'S DISCRETION, IN CONTACT AREA. 0.00203[.000080] MIN THICKNESS MATTE TIN IN SLOT AREA FOR 641150-2 THRU 2-641150-4 OR MATTE WHISKER MITIGATED TIN IN SLOT AREA FOR 3-641150-2 THRU 5-641150-4 OVER NICKEL UNDERPLATE.

- 2 CONTACTS ACCEPT 22 AWG WIRE WITH 2.41[.095] MAX INSULATION DIAMETER.
- 3 CONTACTS MUST ACCEPT 1.14±0.03[.045±.001] SQUARE POST AND REMAIN LOCKED IN POSITION.
- 4 IDENTIFICATION NUMBER FOR LAST CIRCUIT MAY NOT APPEAR ON ALL ASSEMBLIES.
- 5 DIMENSIONS IN BRACKETS ARE IN INCHES.
- 6 HOUSING FEATURES ARE: CLOSED END WITH LOCKING RAMP.
- 7 NOTE DELETED.
- 8 NOTE DELETED.
- 9 OBSOLETE PARTS: OBSOLETE CIS STREAMLINING PER D.RENAUD/D.SINISI.

SUPERSEDED	TIN-LEAD	95.10 [3.744]	24	2-641150-4
		91.14 [3.588]	23	2-641150-3
		87.17 [3.432]	22	2-641150-2
		83.21 [3.276]	21	2-641150-1
		79.25 [3.120]	20	2-641150-0
		75.29 [2.964]	19	1-641150-9
		71.32 [2.808]	18	1-641150-8
		67.36 [2.652]	17	1-641150-7
		63.40 [2.496]	16	1-641150-6
		59.44 [2.340]	15	1-641150-5
55.47 [2.184]	14	1-641150-4		
51.51 [2.028]	13	1-641150-3		
47.55 [1.872]	12	1-641150-2		
43.59 [1.716]	11	1-641150-1		
OBSOLETE	TIN	39.62 [1.560]	10	1-641150-0
SUPERSEDED	TIN-LEAD	35.66 [1.404]	9	641150-9
SUPERSEDED	TIN-LEAD	31.70 [1.248]	8	641150-8
SUPERSEDED	TIN-LEAD	27.74 [1.092]	7	641150-7
OBSOLETE	TIN	23.77 [.936]	6	641150-6
OBSOLETE	TIN	19.81 [.780]	5	641150-5
OBSOLETE	TIN	15.85 [.624]	4	641150-4
OBSOLETE	TIN	11.89 [.468]	3	641150-3
OBSOLETE	TIN	7.92 [.312]	2	641150-2

THIS DRAWING IS A CONTROLLED DOCUMENT. DWN B. LEWIS 2-12-91  
 CHK R. SWING 2-12-91  
 APVD -  
 PRODUCT SPEC 108-1051  
 APPLICATION SPEC 114-1020  
 MATERIAL 1 FINISH -  
 WEIGHT -  
 CUSTOMER DRAWING

TE Connectivity  
 MTA-156 CONNECTOR ASSEMBLY, 22 AWG, STANDARD

SIZE A2 CAGE CODE 00779 DRAWING NO. C-641150 RESTRICTED TO -  
 SCALE 4:1 SHEET 1 OF 1 REV U