

APPROVED: \_\_\_\_\_  
 DATE: \_\_\_\_\_ TITLE: \_\_\_\_\_

Rev	AWO #	Description	Date	Appr
-		RELEASED	11/9/20	
A		UPDATE DRAWING	5/12/21	JJ/RC
B		ADDED SPEC.	8/31/21	WX/RC
C		UPDATE SPEC.	5/27/22	WX/MC

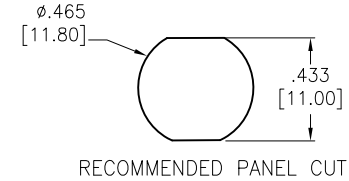
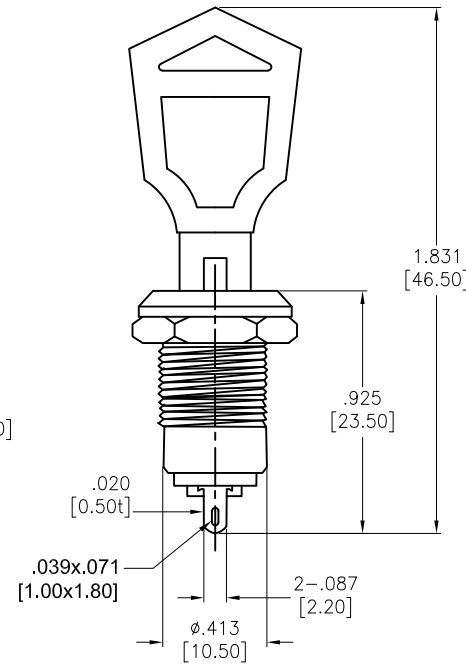
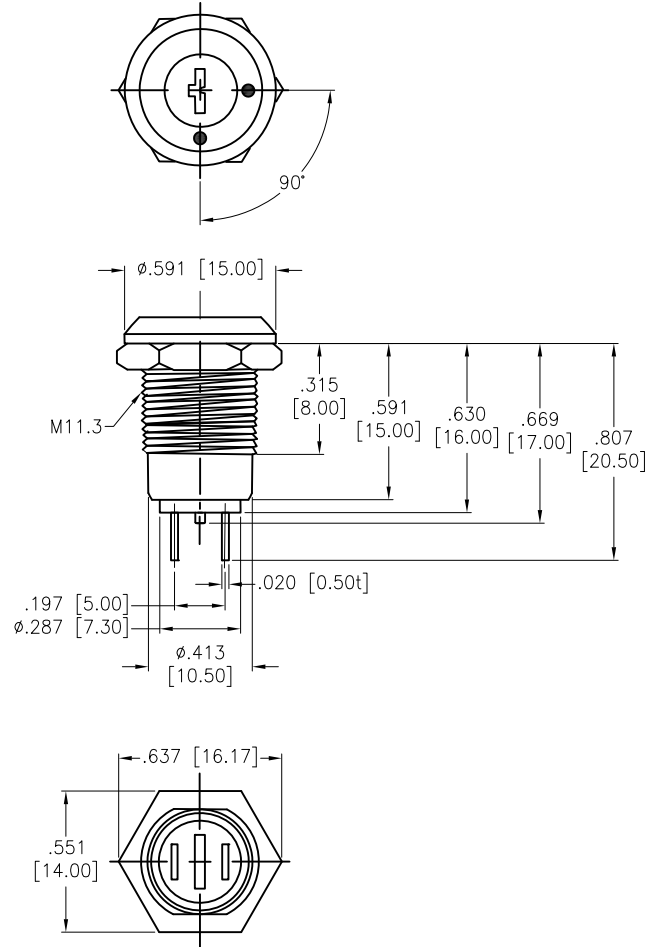

FUNCTION
SPST, ON-OFF

ADAM-P/N	SPEC.
SW-R-K1-A	Key pulled on both positions. Note: this would be our standard
SW-R-K1-B	Key pulled on 1 position

**SPECIFICATIONS:**  
 Material:  
 Body: Steel, Polished Chrome, Silver plated  
 Electrical:  
 The rated load: 125 VAC, 1A  
 250 VAC, 0.5A  
 Contact resistance: 100 mΩ max  
 Insulation resistance: 100 mΩ min (500VDC)  
 Dielectric withstanding voltage: 500 VAC for 1 minute  
 Mechanical life: 5000 times max  
 Temperature Rating:  
 -25°C to +85°C  
 Environmental:  
 Lead free, RoHS compliant



UNLESS OTHERWISE SPECIFIED ALL DIMENSIONS ARE INCHES [MM]. TOLERANCES: EXCEPT AS NOTED			
INCHES		HOLES	
.x	±.10	øX	±.10
.xx	±.020	ø.xx	±.015
.xxx	±.015	ø.xxx	±.010
DRAWN	OW	11/9/20	
CHECKED	AC	11/9/20	
APPROVED			
THIS DRAWING CONTAINS INFORMATION THAT IS PROPRIETARY AND SHOULD NOT BE USED WITHOUT PRIOR WRITTEN PERMISSION FROM ADAM TECH			

**ADAM TECH** 909 Rahway Avenue,  
 Union, NJ 07083  
 Phone: 908-687-5000  
 Fax: 908-687-5710

TITLE	SWITCH, KEY LOCK, SPST, ON-OFF PANEL MOUNT, SOLDER TERMINAL	
SIZE	PART NO.	REV.
X	SW-R-K1-X	C
REF:	S00206C	SCALE: NTS SHEET 1 OF 1