

REVISIONS				
P	LTN	DESCRIPTION	DATE	APVD
B		REVISED PER ECR-20-100642	19SEP2022	M, G, D, Z

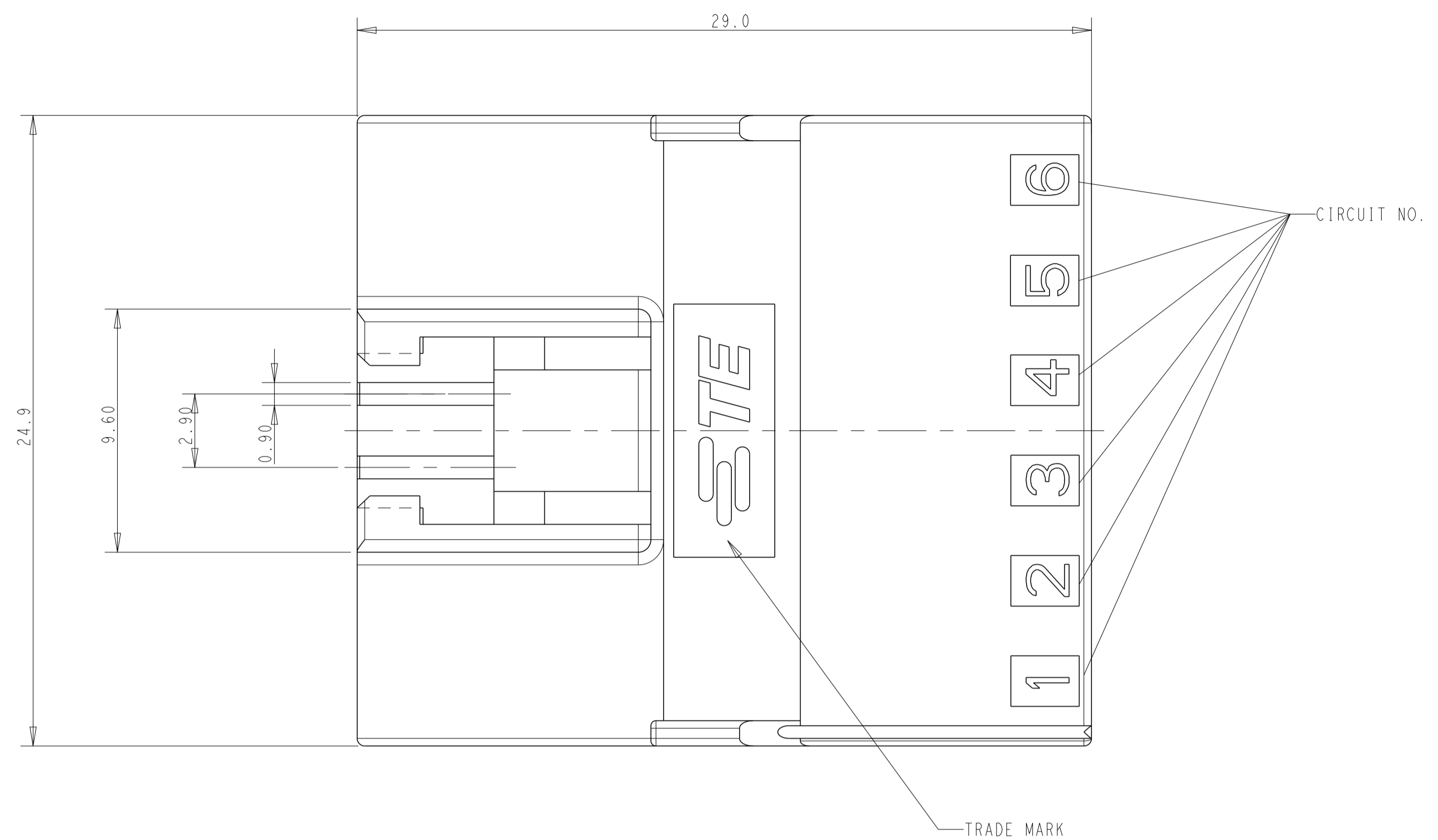

- NOTES:
- APPLICABLE CONTACT P/N:  
 TAB CONTACT: 175150- (20-16 AWG)  
 175149- (26-22 AWG)
  - MATING CONN. P/N:  
 PLUG HSG: 176280-  
 REC CONTACT: 175152- (20-16AWG)  
 175151- (20-22AWG)
  - INSTRUCTION SHEET: IS-503J.

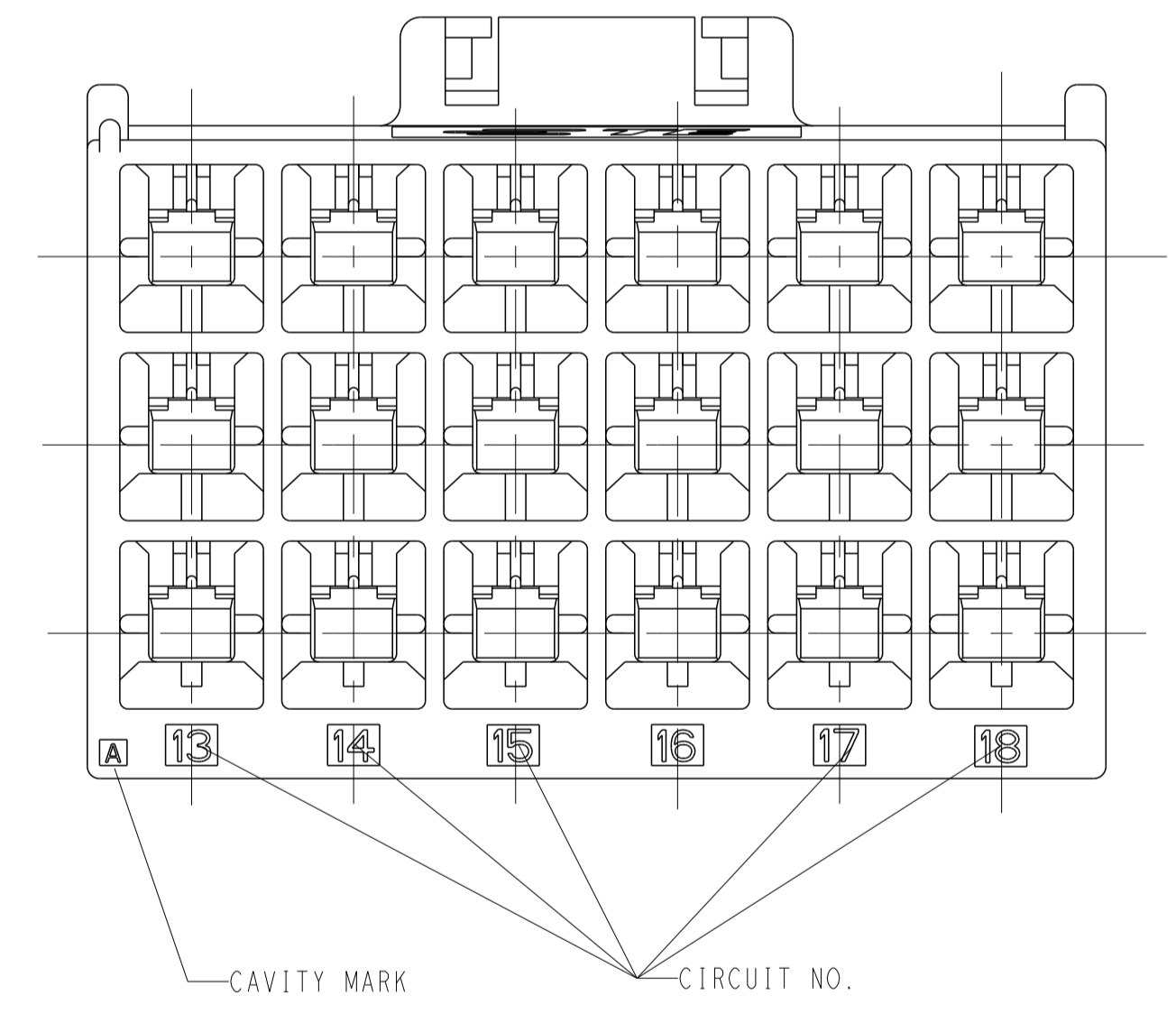
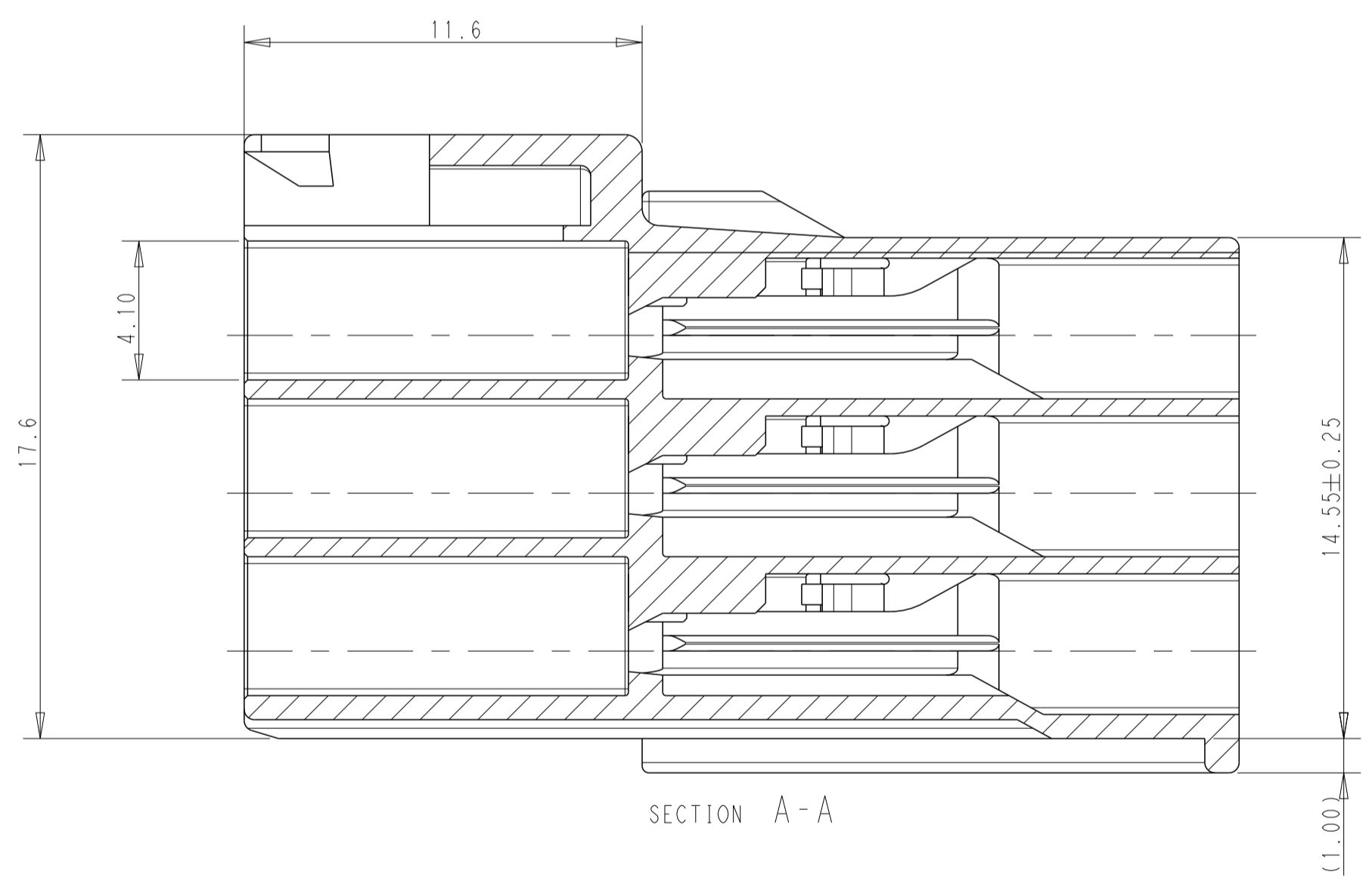
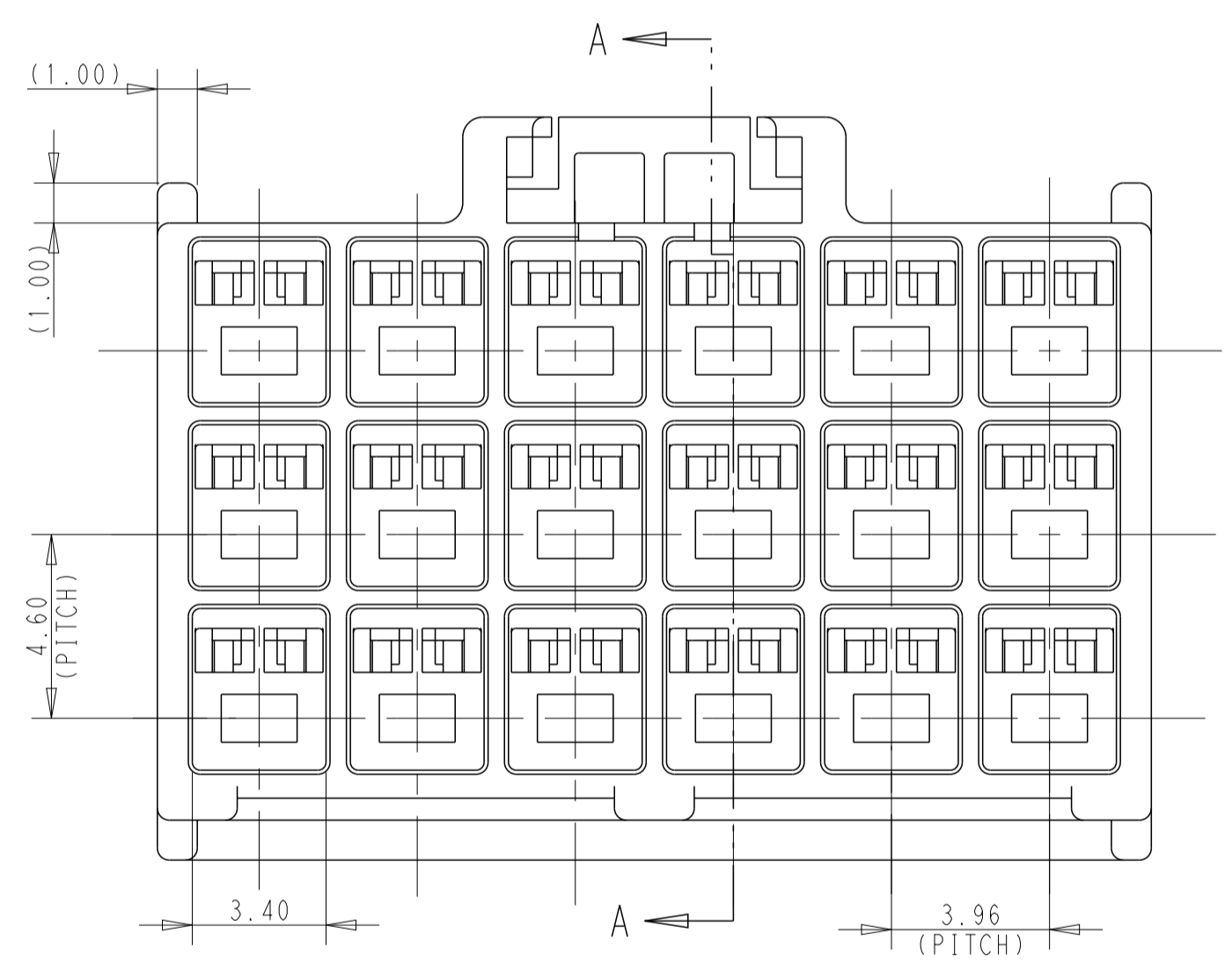

POS.	COLOR	PART NUMBER
18	BLACK	176291-9
DEVELOPMENT	18	BLUE
DISCONTINUED	18	YELLOW
DISCONTINUED	18	RED
18	NATURAL	176291-1

THIS DRAWING IS A CONTROLLED DOCUMENT.

DIMENSIONS:	TOLERANCES UNLESS OTHERWISE SPECIFIED:	DWN M. SHINDO 23NOV89	CHK M. YOSHIDA 28NOV89	APVD N. ONOUE 28NOV89
mm	0 PLC ±0.25	NAME AMP UNIVERSAL POWER CONN 3.96 PITCH CAP HOUSING 18 POS (TPL ROW)		
	1 PLC ±0.2	SIZE CAGE CODE DRAWING NO RESTRICTED TO		
	2 PLC ±0.2	A 00779 C=176291		
	3 PLC ±0.2	SCALE 6:1 SHEET 1 OF 1 REV B		
	4 PLC ±0.2	CUSTOMER DRAWING		
	ANGLES ±°			
	FINISH			
MATERIAL 6/6 NYLON (UL94 V-0)				