

Attenuators

BNC Type

DC - 4 GHz Performance

Frequency: DC - 4.0 GHz and DC - 2.0 units available

Attenuation Values: 1 - 40 dB as noted

Attenuation Accuracy:

1 - 6 dB	± 0.3 dB
7 - 10 dB	± 0.5 dB
11 - 20 dB	± 0.75 dB
21 - 40 dB	± 1.0 dB
41-60 dB	± 1.5 dB

Impedance: 50 Ohms

VSWR: 1.25 max

Power: 2 Watts average @ +25 °C derated linearly to 0.5 Watts @ +125 °C U.O.S.

Peak Power: 200 Watts for 2Watt units and 100 Watts Peak for 5 & 10 Watt

Operating Temperature Range: -54C to +125C

Finish: Nickel Plated Brass and Black Anodized Aluminum



DC - 4.0 GHz		313 Series	Model Number
Male / Female	Female / Female		Male / Male
ATT-0313-XX-BNC-10	ATT-313F-XX-BNC-10		ATT-313M-XX-BNC-10
Attenuation Value = XX, Select 1 - 60 dB in 1 dB increments			

DC - 2.0 GHz		314 Series	Model Number
Male/Female	Female/Female		Male/Male
ATT-0314-XX-BNC-10	ATT-314F-XX-BNC-10		ATT-314M-XX-BNC-10
Attenuation Value = XX, Select 1 - 60 dB in 1 dB increments			

DC - 4.0 GHz		581 Series	Model Number
Male/Female	Female/Female		Male/Male
ATT-0581-XX-BNC-07	ATT-581F-XX-BNC-07		ATT-581M-XX-BNC-07
Attenuation Value = XX, Select 1 - 60 dB in 1 dB increments			
5 Watts			

DC - 4.0 GHz		582 Series	Model Number
Male/Female	Female/Female		Male/Male
ATT-0582-XX-BNC-07	ATT-582F-XX-BNC-07		ATT-582M-XX-BNC-07
Attenuation Value = XX, Select 1 - 60 dB in 1 dB increments			
10 Watts			

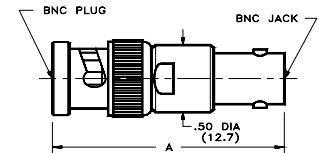

Attenuation Value	Length A
1 - 20 dB	1.36
21 - 60 dB	1.65

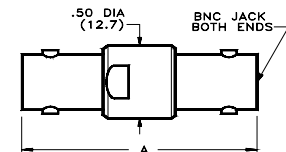

Attenuation Value	Length A
1 - 20 dB	1.43
21 - 60 dB	1.72

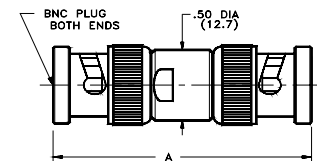

Attenuation Value	Length A
1 - 20 dB	1.55
21 - 60 dB	1.84

