

DIMENSIONING AND TOLERANCING PER ASME Y14.5M (USD STANDARDS). THIS DRAWING IS A CONTROLLED DOCUMENT.

PART NUMBER	REV	FIRST USED
1385299-1	E	854400-1
1385299-2	E	565435-5
1385299-3	E	354500-1

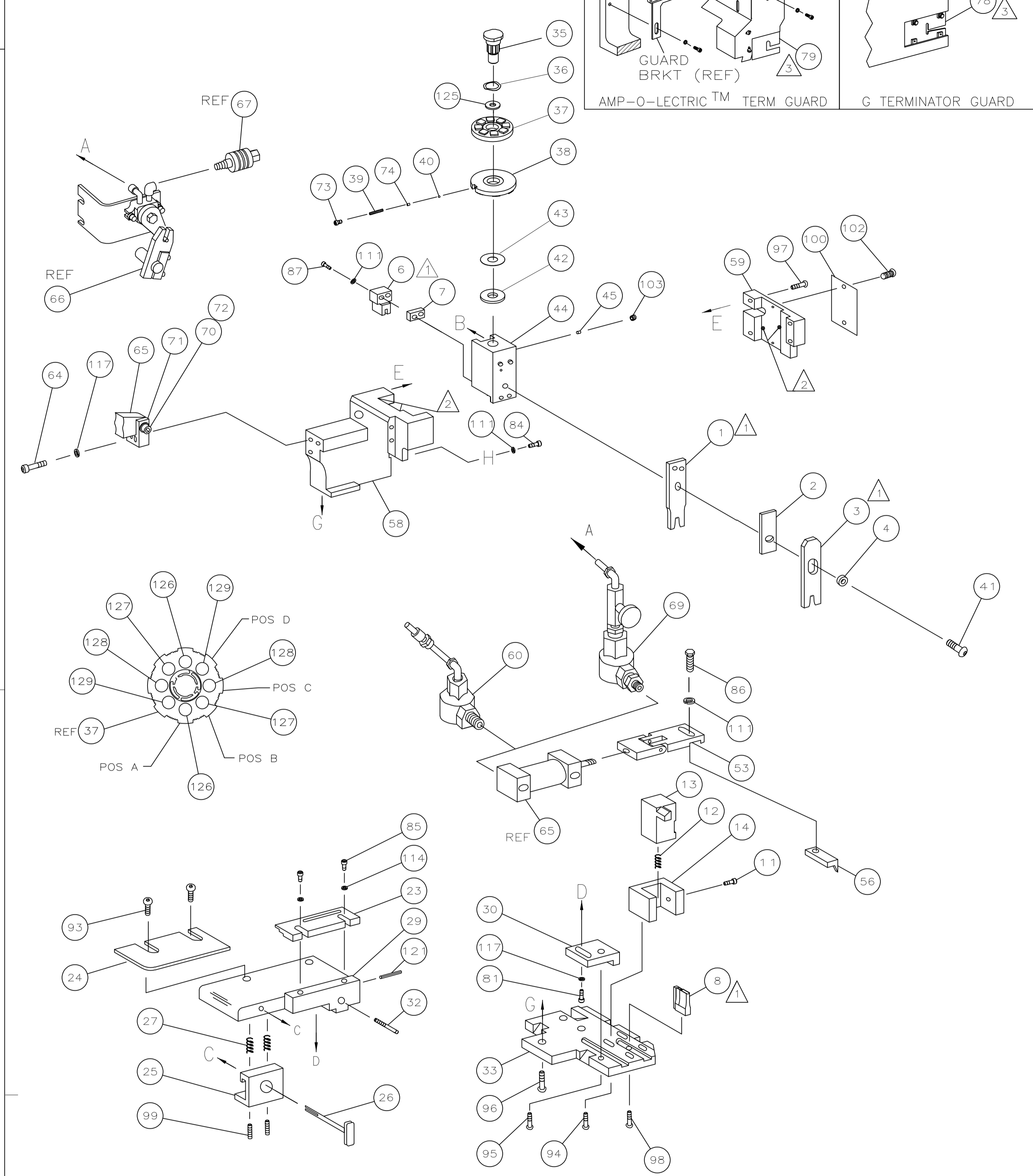

- 1 RECOMMENDED SPARE PARTS.
- 2 GREASE LIGHTLY.
- 3 GUARD MUST BE IN PLACE WHEN OPERATING APPLICATOR IN A BENCH MACHINE.
- 4 SEE DRAWING FOR COMPONENTS

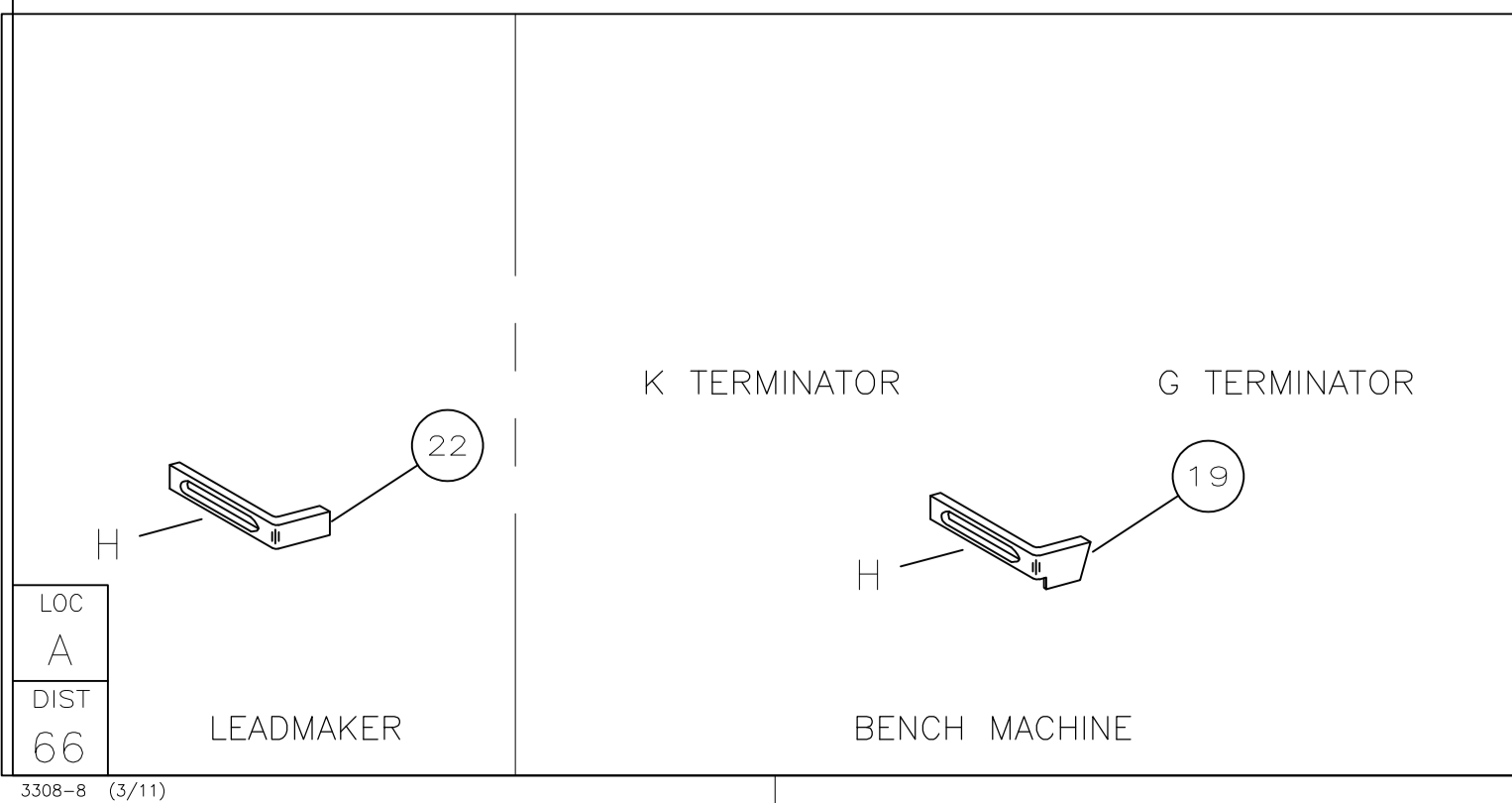

AMP PN		MFR PN		MOLEX TERMINAL		CUSTOMER CRIMP SPECS	
AMP PN	MFR PN	PAD LTR	CRIMP HEIGHT	WIRE SIZE			
286984-1	08-58-0110	A	.044 ±.001 [1.12 ±0.03mm]	18			
286984-2	08-58-0187	B	.0415 ±.0015 [1.045±0.025mm]	20			
286984-3	08-50-0187	C	.039 ±.001 [0.99 ±0.03mm]	22			
286984-4	08-52-0112	D	.037 ±.001 [0.94 ±0.03mm]	24			
		CRIMP SIZE	TYPE	RANGE			
		WIRE .076 [1.93mm]	F	18-24			
		INSUL .100 [2.54mm]	0	Ø.110 MAX			
WIRE STRIP LENGTH	TERM APPL SPEC	FEED	APPL INSTRUCTION	SET UP GAGE	LAYOUT		
.109-.125	NONE	.280	408-8040	458637-1	L2562		

QTY REQD PER ASSY	REF	QTY REQD PER ASSY	REF	PART NO	DESCRIPTION	ITEM NO
2	2	2	-	5-354779-4	PIN, WIRE DISC (.3260)D	129
2	2	2	-	5-354779-0	PIN, WIRE DISC (.3240)C	128
2	2	2	-	4-354779-5	PIN, WIRE DISC (.3215)B	127
2	2	2	-	4-354779-0	PIN, WIRE DISC (.3190)A	126
1	1	1	-	986950-1	WASHER, FLAT PRECISION	125
						124
						123
						122
1	1	1	-	4-21028-0	PIN,SLT SPR(Ø.093x.75)ST GDE PL	121
						120
						119
						118
2	2	2	-	21024-5	WASHER, LOCK(#10)ADJ BLOCK	117
						116
						115
2	2	2	-	21024-2	WASHER,LOCK(#4)FRONT STP GUIDE	114
						113
						112
4	4	4	-	21024-4	WASHER,LOCK(#8)STRIPPER	111
						110
						109
						108
						107
						106
						105
						104
1	1	1	-	21009-2	SCR,SKT SET(1/4-20x.25 LW)RAM	103
2	2	2	-	21017-2	SCR,DRIVE(#2x.19)ID PLATE	102
						101
1	1	1	-	461264-1	PLATE, IDENTIFICATION	100
2	2	2	-	5-21006-6	SCR,SET(10-32x.75)DRAG	99
1	1	1	-	22733-8	SCR,BHC(8-32x.38 LW)ANVIL	98
4	4	4	-	2-21002-9	SCR,BHC(10-32x.75)CAP	97
3	3	3	-	2-22733-8	SCR,BHC(10-32x.62)HOUSING	96
1	1	1	-	2-21002-7	SCR,BHC(10-32x.50)ADJ BLOCK	95
2	2	2	-	2-21002-2	SCR,BHC(8-32x.50)SHEAR	94
2	2	2	-	2-21002-1	SCR,BHC(8-32x.38)R STRIP GUIDE	93
						92
						91
						90
						89
						88
2	2	2	-	2-21000-9	SCR,SHC(8-32x.75)DEP-HOLD	87
1	1	1	-	2-22603-0	SCR,HEX HD(8-32x.31)FEED FINGER	86
2	2	2	-	1-21000-4	SCR,SHC(4-40x.38)F ST GUIDE	85
1	1	1	-	2-21000-7	SCR,SHC(8-32x.50)STRIPPER	84
						83
						82
1	1	1	-	3-21000-4	SCR,SHC(10-32x.38)SG ADJ BL	81
						80
						79
						78
						77
						76
						75
1	1	1	-	690603-1	SPRING, ASSIST	74
1	1	1	-	23030-1	SCR,SHC(6-32x.25 SL)INS DISC	73
1	1	1	-	3-21001-5	SCR,BHC(3/8x1.00)FEED_MT	72
1	1	1	-	459610-1	MOUNT, FEED BRACKET	71
-3	-2	-1	U/M	PART NO	DESCRIPTION	ITEM NO
						70
						69
						68
						67
						66
						65
						64
						63
						62
						61
						60
						59
						58
						57
						56
						55
						54
						53
						52
						51
						50
						49
						48
						47
						46
						45
						44
						43
						42
						41
						40
						39
						38
						37
						36
						35
						34
						33
						32
						31
						30
						29
						28
2	2	2	-	22281-8	SPRING, DRAG	27
1	1	1	-	690546-1	LEVER, DRAG RELEASE	26
1	1	1	-	224404-1	DRAG, TERMINAL	25
1	1	1	-	217817-1	GUIDE, STRIP (REAR)	24
1	1	1	-	217816-2	GUIDE, STRIP (FRONT)	23
-	-	-	1	1-690472-4	STRIPPER	22
						21
						20
1	1	-	-	2-1338987-4	STRIPPER	19
						18
						17
						16
						15
1	1	1	-	217819-2	HOLDER, TERMINAL SUPPORT	14
1	1	1	-	318574-5	SUPPORT, FLOATING	13
1	1	1	-	4-22280-2	SPRING, SHEAR	12
1	1	1	-	690461-1	STOP, SHEAR	11
						10
						9
1	1	1	-	904766-4	ANVIL	8
1	1	1	-	6-240641-6	SPACER, SHEAR BLADE	7
1	1	1	-	217820-5	BLADE, SHEAR	6
						5
1	1	1	-	238009-4	SPACER, BLOCK CRIMPER	4
1	1	1	-	9-456135-6	CRIMPER, INSULATION	3
1	1	1	-	455888-3	SPACER, CRIMPER	2
1	1	1	-	7-568176-8	CRIMPER, WIRE	1
-3	-2	-1	U/M	PART NO	DESCRIPTION	ITEM NO

QTY REQD PER ASSY		REF		QTY REQD PER ASSY		REF		PARTS LIST	
1	1	1	-	21024-8	WASHER,LOCK(3/8)FEED BRKT	70			
-	1	-	-	692655-5	AIR FEED VALVE ASSY	69			
						68			
						67			
						66			
						65			
						64			
						63			
						62			
						61			
						60			
						59			
						58			
						57			
						56			
						55			
						54			
						53			
						52			
						51			
						50			
						49			
						48			
						47			
						46			
						45			
						44			
						43			
						42			
						41			
						40			
						39			
						38			
						37			
						36			
						35			
						34			
						33			
						32			
						31			
						30			
						29			
						28			
2	2	2	-	22281-8	SPRING, DRAG	27			
1	1	1	-	690546-1	LEVER, DRAG RELEASE	26			
1	1	1	-	224404-1	DRAG, TERMINAL	25			
1	1	1	-	217817-1	GUIDE, STRIP (REAR)	24			
1	1	1	-	217816-2	GUIDE, STRIP (FRONT)	23			
-	-	-	1	1-690472-4	STRIPPER	22			
						21			
						20			
1	1	-	-	2-1338987-4	STRIPPER	19			
						18			
						1			