

## Base strip - IPC 16/ 5-GU-10,16 - 1969881

Please be informed that the data shown in this PDF Document is generated from our Online Catalog. Please find the complete data in the user's documentation. Our General Terms of Use for Downloads are valid (<http://phoenixcontact.com/download>)

Header, Nominal current: 76 A, Rated voltage (III/2): 1000 V, Number of positions: 5, Pitch: 10.16 mm, Color: green, Contact surface: Silver, Assembly: Soldering, Plug direction parallel to the PCB: connector part rotated by 180° with respect to the plug axis.



### Product Features

- Inverted IPC 16 headers for implementing a touch-proof PCB output or a PCB/PCB connection (in combination with PC 6-16 base strips)
- PCB-SHIELD shroud (EMC connection)



### Key commercial data

|                                      |   |
|--------------------------------------|---|
| Packing unit                         | 1 pc  |
| Minimum order quantity               | 50 pc   |
| GTIN                                 | <br>4 017918 948634 |
| Weight per Piece (excluding packing) | 19.38 GRM   |
| Custom tariff number                 | 85366990  |
| Country of origin                    | Poland  |

### Technical data

#### Dimensions

|                |           |
|----------------|-----------|
| Length         | 32.1 mm   |
| Pitch          | 10.16 mm  |
| Dimension a    | 40.64 mm  |
| Pin dimensions | 0,8 x 1,2 |
| Pin spacing    | 10.16 mm  |
| Hole diameter  | 1.7 mm    |

#### General

|                   |              |
|-------------------|--------------|
| Range of articles | IPC 16/...GU |
|-------------------|--------------|

## Base strip - IPC 16/ 5-GU-10,16 - 1969881

### Technical data

#### General

|   |        |
|---|--------|
| Insulating material group               | I      |
| Rated surge voltage (III/3)             | 8 kV   |
| Rated surge voltage (III/2)             | 8 kV   |
| Rated surge voltage (II/2)              | 8 kV   |
| Rated voltage (III/3)                   | 1000 V |
| Rated voltage (III/2)                   | 1000 V |
| Rated voltage (II/2)                    | 1000 V |
| Nominal current I <sub>N</sub>          | 76 A   |
| Maximum load current                    | 76 A   |
| Insulating material                     | PA     |
| Inflammability class according to UL 94 | V0     |
| Color                                   | green  |
| Number of positions                     | 5      |

### Classifications

#### eCl@ss

|            |          |
|------------|----------|
| eCl@ss 4.0 | 272607xx |
| eCl@ss 4.1 | 27260701 |
| eCl@ss 5.0 | 27260701 |
| eCl@ss 5.1 | 27260701 |
| eCl@ss 6.0 | 27260704 |
| eCl@ss 7.0 | 27440402 |
| eCl@ss 8.0 | 27440402 |

#### ETIM

|          |          |
|----------|----------|
| ETIM 3.0 | EC001121 |
| ETIM 4.0 | EC002637 |
| ETIM 5.0 | EC002637 |

#### UNSPSC

|               |          |
|---------------|----------|
| UNSPSC 6.01   | 30211810 |
| UNSPSC 7.0901 | 39121409 |
| UNSPSC 11     | 39121409 |
| UNSPSC 12.01  | 39121409 |
| UNSPSC 13.2   | 39121409 |

# Base strip - IPC 16/ 5-GU-10,16 - 1969881

## Approvals

### Approvals

---

#### Approvals

UL Recognized / SEV / cUL Recognized / CCA / GOST / GOST / cULus Recognized

---

#### Ex Approvals

---

#### Approvals submitted

---

### Approval details

|  |       |       |       |
|--|-------|-------|-------|
| UL Recognized  |       |       |       |
|  | B     | C     | D     |
| Nominal current IN   | 66 A  | 66 A  | 5 A   |
| Nominal voltage UN   | 300 V | 300 V | 600 V |

|                    |        |
|--------------------|--------|
| SEV                |        |
|                    |        |
| Nominal current IN | 76 A   |
| Nominal voltage UN | 1000 V |

|  |       |       |       |
|--|-------|-------|-------|
| cUL Recognized  |       |       |       |
|  | B     | C     | D     |
| Nominal current IN   | 66 A  | 66 A  | 5 A   |
| Nominal voltage UN   | 300 V | 300 V | 600 V |

|                    |        |
|--------------------|--------|
| CCA                |        |
|                    |        |
| Nominal current IN | 76 A   |
| Nominal voltage UN | 1000 V |

# Base strip - IPC 16/ 5-GU-10,16 - 1969881

## Approvals

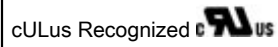

## Drawings

Drilling diagram

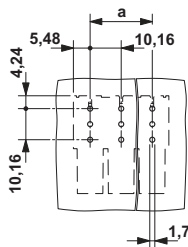

The illustration shows the 3-pos. version

Dimensioned drawing

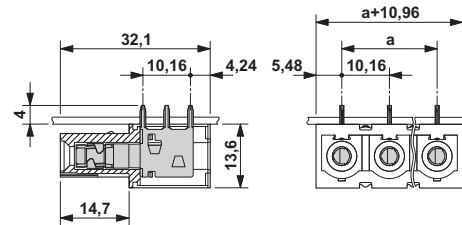

The illustration shows the 3-pos. version