

RECOMMENDED  
CABLE STRIPPING DIM'S

REV.	DATE	ECR NO.	DESCRIPTION
NC	08/17/06	XXXXXX	INITIAL RELEASE
A	02/10/14	2694	CORRECT DESCRIPTION FROM JACK TO PLUG, UPDATE DRAWING FORMAT

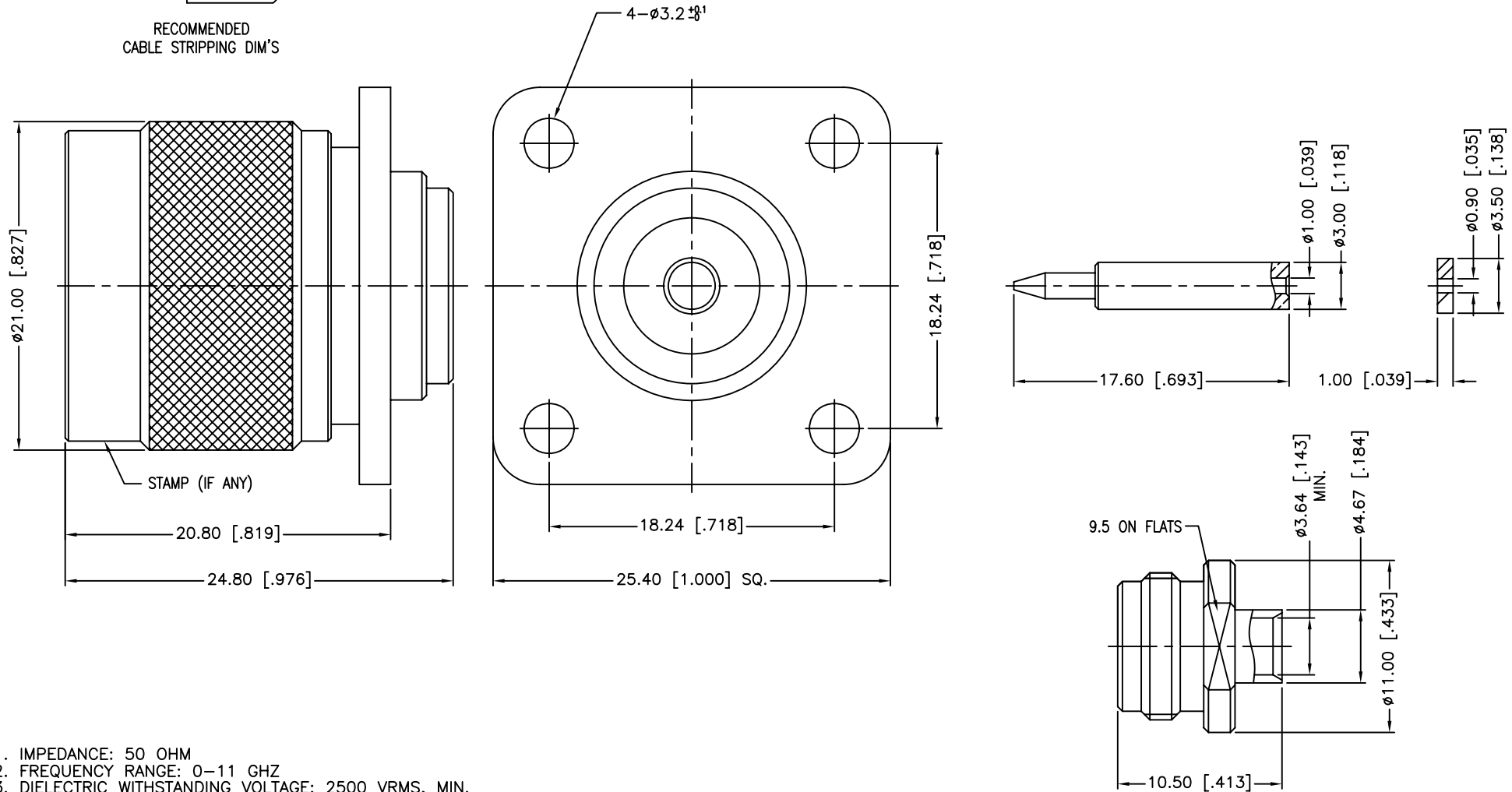

1. IMPEDANCE: 50 OHM
2. FREQUENCY RANGE: 0-11 GHZ
3. DIELECTRIC WITHSTANDING VOLTAGE: 2500 VRMS, MIN.
4. DURABILITY: 500 CYCLES MIN.
5. TEMPERATURE RANGE: -65°C TO +165°C
6. CRIMPED CONTACT PIN  
HEX. CRIMP SIZE .100" OR SOLDER

QTY	DESCRIPTION	MATERIAL	FINISH
1	BODY WITH PANEL	BRASS	NEXCOTE
2	INSULATOR	PTFE	NATURAL
3	INNER BODY	BRASS	NEXCOTE
4	GASKET	SILICONE RUBBER	RED
5	RETAINER RING	SUS 304	NATURAL
6	SHELL	BRASS	NEXCOTE
7	CONTACT PIN	BRASS	GOLD
8	INSULATOR	PTFE	NATURAL
9	SOLDER NUT	BRASS	GOLD

UNLESS OTHERWISE SPECIFIED DIMENSIONS ARE IN MILLIMETERS. DIMENSIONS IN [ ] ARE IN INCHES AND FOR CUSTOMER REFERENCE ONLY.  
UNLESS OTHERWISE SPECIFIED  
TOLERANCES FOR MILLIMETERS ARE:  
<0.5 ± 0.05mm  
0.5 - 6mm ± 0.10mm  
6 - 30mm ± 0.20mm  
30 - 120mm ± 0.30mm  
ANGLES ± 1°  
UNLESS OTHERWISE SPECIFIED  
TOLERANCES FOR INCHES ARE:  
<.020 ± 0.002"  
.020 - .236 = ± 0.004"  
.236 - 1.180 = ± 0.007"  
1.180 - 4.724 = ± 0.012"  
ANGLES ± 1°  
DO NOT SCALE DRAWING

APPROVALS	DATE
DRAWN M.ZHANG	02/10/14
CHECKED	
ISSUED	
SHEET 1 OF 1	
CAD FILE C:/CONNEX/172309.DWG	

<b>Amphenol Connex</b>			
PART DESCRIPTION <b>N PANEL DIRECT SOLDER PLUG (FOR .141" SEMI RIGID CABLE)</b>			
PART NO. <b>172309</b>			
DWG. NO.	172309.DWG	REV.	A
SIZE	A	SCALE	NA