

WITH MOUNTING CLIPS

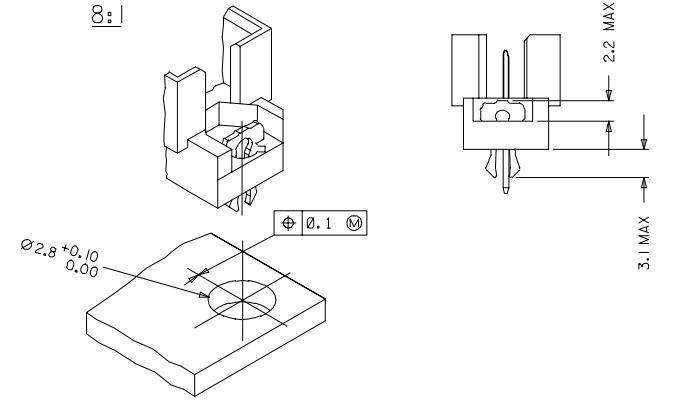

- NOTES:
- MATERIALS: THERMOPLASTIC POLYESTER, GLASS FILLED, UL94V-0 COLOUR: PEBBLE GREY RAL 7032
 TERMINAL - PHOSPHOR BRONZE
 MOUNTING CLIP: STEEL
 - FINISH: TERMINAL:-
 CONTACT AREA
 1. PERFORMANCE LEVEL 1: SELECTIVE GOLD (Au), THICKNESS = 1.1 MICROMETER
 OVER NICKEL, THICKNESS = 1.25 MICROMETER
 2. PERFORMANCE LEVEL 2: SELECTIVE GOLD (Au), THICKNESS = 0.6 MICROMETER
 OVER NICKEL, THICKNESS = 1.25 MICROMETER
 3. PERFORMANCE LEVEL 3: SELECTIVE GOLD (Au), THICKNESS = 0.3 MICROMETER
 OVER NICKEL, THICKNESS = 1.25 MICROMETER
 PRESS-IN AND WIRE WRAP AREA :
 SELECTIVE TIN, THICKNESS = 2.5 MICROMETER
 OVER NICKEL, THICKNESS = 1.25 MICROMETER OVERALL
 - MOUNTING CLIP:-
 TIN (Sn), THICKNESS = 5-10 MICROMETER,
 OVER NICKEL (Ni), THICKNESS = 2.5 MICROMETER
 - FOR NON MOUNTING CLIP OPTION, CONNECTOR TO BE SECURED WITH
 RIVETS: 2 TUBULAR RIVETS 2.5 x 0.3 ... DIN 7340
 SCREWS: 2 CHEESEHEAD SCREWS M2.5 x DIN 84 AND 2 HEXAGONAL NUTS M2.5 DIN 934
 - MATERIAL NUMBER, BATCH CODE, UL AND CSA MARKING
 TO BE PRINTED ON THE CONNECTOR
 - CUT FACE OF TIP WITHOUT PLATING PERMITTED
 - PRODUCT SPECIFICATION - PS-36515-001

RECOMMENDED PCB LAYOUT
 COMPONENT SIDE

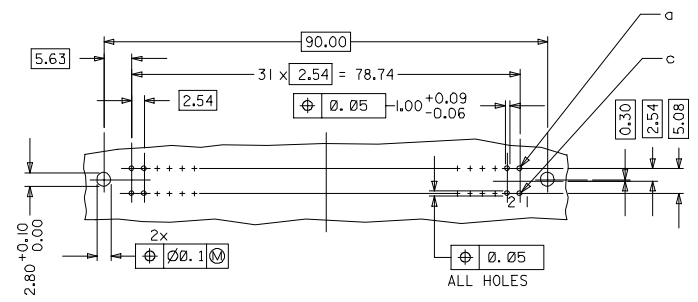

RoHS COMPLIANT

EC No: P007-0044 DRAWN BY: DRINGSATTI/MARAD 2006/10/10 CHECKED BY: CHIKKOSUDHIR 2006/10/11 APPROVED BY: APPR/SSUDHIR 2006/10/15	QUALITY SYMBOLS	GENERAL TOLERANCES (UNLESS SPECIFIED)	DIMENSION STYLE	SCALE	DESIGN UNITS	THIRD ANGLE PROJECTION
	▽=0 ▽=0	mm INCH 4 PLACES ± --- ± --- 3 PLACES ± 0.05 ± --- 2 PLACES ± 0.1 ± --- 1 PLACE ± 0.15 ± --- ANGULAR ± 2°	MM ONLY	2:1	METRIC	
C1	DRAFT WHERE APPLICABLE MUST REMAIN WITHIN DIMENSIONS	DRAWN BY: SS 1999/09/24 CHECKED BY: G J LOWE 1999/09/24 APPROVED BY: G J LOWE 1999/09/24	TITLE	ASSEMBLY, DIN 41612 PRESS-IN, WIRE WRAP MOLEX INCORPORATED		
	SIZE: A 1 THIS DRAWING CONTAINS INFORMATION THAT IS PROPRIETARY TO MOLEX INCORPORATED AND SHOULD NOT BE USED WITHOUT WRITTEN PERMISSION	MATERIAL NO. SD-36515-007 DOCUMENT NO. SD-36515-007	SHEET NO. 1 OF 2			

MATERIAL No.	MOLEX ENG No.	PERF LEVEL	PLATING	CONTACT SEQUENCE/ROW	DIM "L" MM	MOUNTING CLIP	FMLB
36515-0145	MM-B1460-R963	1	Au + Ni	1,2,3...32 a+c	13.25	NO	NO
36515-0146	MM-B1560-R963	2	Au + Ni	1,2,3...32 a+c	13.25	NO	NO
36515-0147	MM-B1660-R963	3	Au + Ni	1,2,3...32 a+c	13.25	NO	NO
36515-0151	MM-B1460-R913	1	Au + Ni	1,2,3...32 a+c	13.25	YES	NO
36515-0152	MM-B1560-R913	2	Au + Ni	1,2,3...32 a+c	13.25	YES	NO
36515-0153	MM-B1660-R913	3	Au + Ni	1,2,3...32 a+c	13.25	YES	NO
36515-0157	MM-B1460-R933	1	Au + Ni	1,2,3...32 a+c	13.25	NO	1,32a 1,32c
36515-0158	MM-B1560-R933	2	Au + Ni	1,2,3...32 a+c	13.25	NO	1,32a 1,32c
36515-0159	MM-B1660-R933	3	Au + Ni	1,2,3...32 a+c	13.25	NO	1,32a 1,32c
36515-0163	MM-B1460-R953	1	Au + Ni	1,2,3...32 a+c	13.25	YES	1,32a 1,32c
36515-0164	MM-B1560-R953	2	Au + Ni	1,2,3...32 a+c	13.25	YES	1,32a 1,32c
36515-0165	MM-B1660-R953	3	Au + Ni	1,2,3...32 a+c	13.25	YES	1,32a 1,32c

DETAILY DETAILX

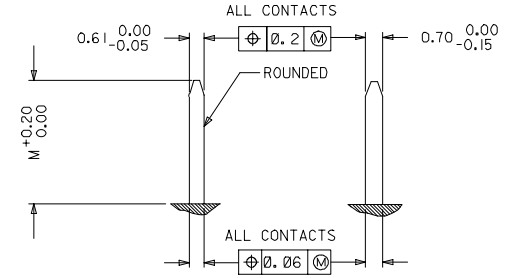

PRE MATING CONTACTS	5.4
NORMAL CONTACTS	4.8
	M

RoHS COMPLIANT

EC No: 2007/0044 DRAWING APPROVED 2006/10/10 CHECKED BY APPRESSOR 2006/10/11 APPROVED BY APPRESSOR 2006/10/15	QUALITY SYMBOLS 	GENERAL TOLERANCES (UNLESS SPECIFIED) <table border="1"> <tr> <th></th> <th>mm</th> <th>INCH</th> </tr> <tr> <td>4 PLACES</td> <td>± 0.15</td> <td>± 0.005</td> </tr> <tr> <td>3 PLACES</td> <td>± 0.05</td> <td>± 0.002</td> </tr> <tr> <td>2 PLACES</td> <td>± 0.1</td> <td>± 0.004</td> </tr> <tr> <td>1 PLACE</td> <td>± 0.15</td> <td>± 0.006</td> </tr> </table>		mm	INCH	4 PLACES	± 0.15	± 0.005	3 PLACES	± 0.05	± 0.002	2 PLACES	± 0.1	± 0.004	1 PLACE	± 0.15	± 0.006	DIMENSION STYLE MM ONLY	SCALE 2:1	DESIGN UNITS METRIC	THIRD ANGLE PROJECTION
		mm	INCH																		
4 PLACES	± 0.15	± 0.005																			
3 PLACES	± 0.05	± 0.002																			
2 PLACES	± 0.1	± 0.004																			
1 PLACE	± 0.15	± 0.006																			
DRAWN BY: SS CHECKED BY: GJLOWE APPROVED BY: GJLOWE DATE: 1999/09/24	TITLE ASSEMBLY, DIN 41612 PRESS-IN, WIRE WRAP MOLEX INCORPORATED	MATERIAL NO. SEE CHART	DOCUMENT NO. SD-36515-007	SHEET NO. 2 OF 2																	