

MODEL NUMBER  
ADT-2805-SF-BMF-02

- NOTES:
- 1.0 MATERIAL:
    - 1.1 HOUSING, NUT AND WASHER: STAINLESS STEEL PER ASTM-A582, TYPE 303.
    - 1.2 DIELECTRIC: PTFE FLUOROCARBON PER ASTM-D1710.
    - 1.3 CENTER CONTACT AND EXTENSION: BERYLLIUM COPPER ROD ALLOY C172, PER ASTM-B196.
  - 2.0 PLATING:
    - 2.1 HOUSING, NUT AND WASHER: PASSIVATED PER MIL-F-14072 AND SAE AMS QQ-P-35.
    - 2.2 CENTER CONTACT AND EXTENSION: GOLD PER MIL-PRF-39012.
  - 3.0 MECHANICAL:
    - 3.1 INTERFACE PER MIL-STD-348A.
    - 3.2 CENTER CONTACT CAPTURED IN ACCORDANCE WITH MIL-PRF-39012.
  - 4.0 ELECTRICAL:
    - 4.1 FREQUENCY RANGE: DC to 18 GHz
    - 4.2 MAX V.S.W.R.: 1.05 + .005f(GHz)
  - 5.0 DIMENSIONS IN BRACKETS ARE IN MILLIMETERS.

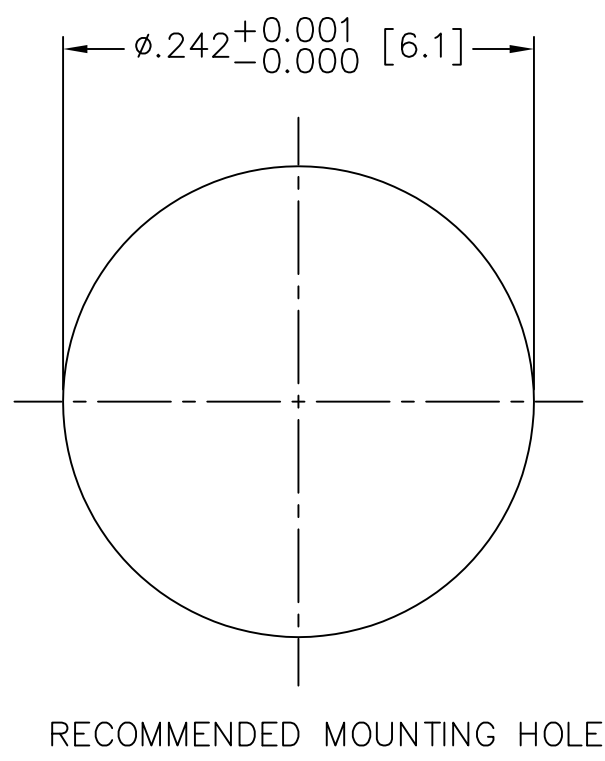
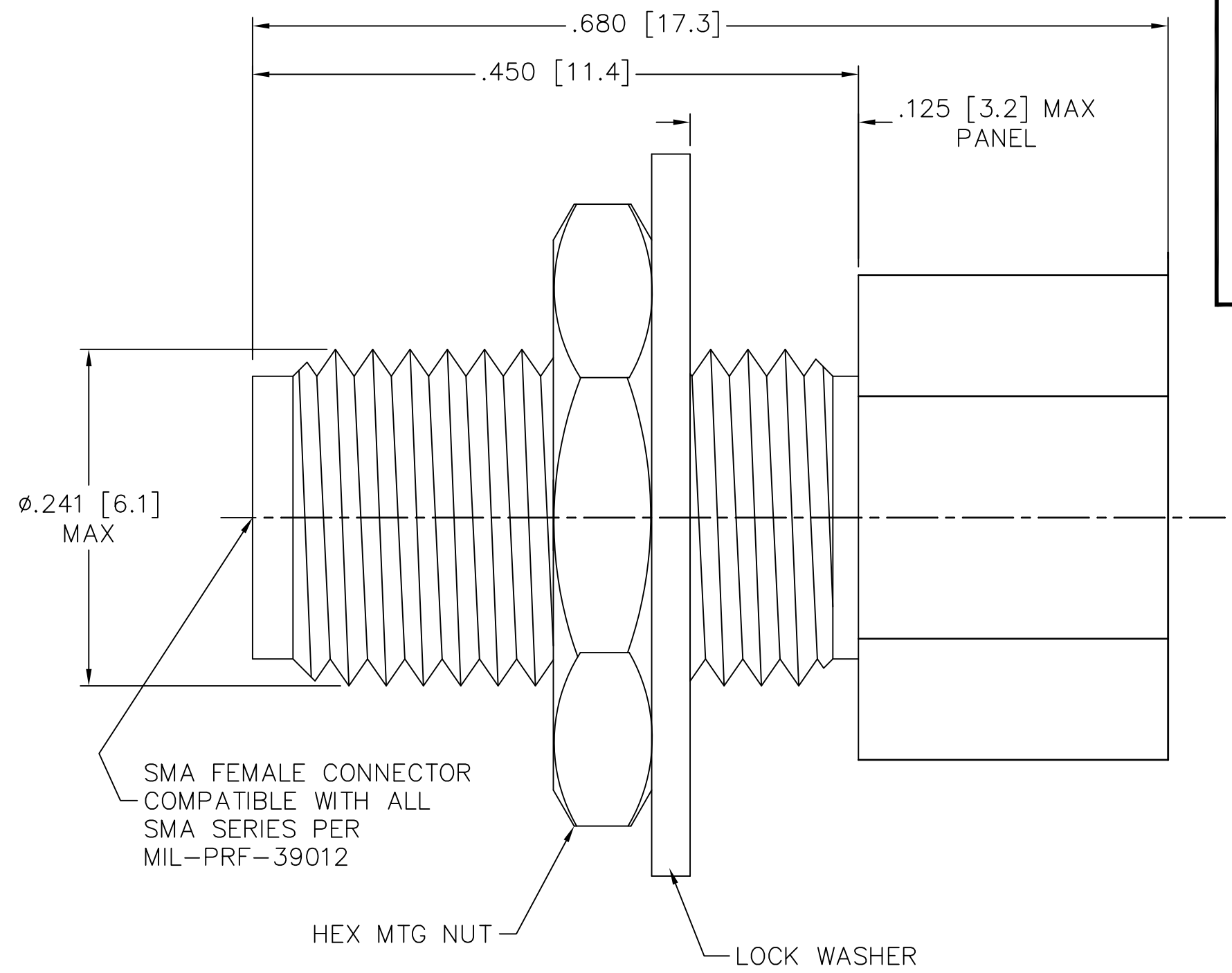

NOTICE: The information contained in this drawing is proprietary and must not be used without the permission of Emerson Network Power.  UNLESS OTHERWISE NOTED DIMENSIONS ARE IN INCHES AND TOLERANCES ARE: 3 PLACE DECIMALS ±.005 2 PLACE DECIMALS ±.02 FRACTIONS ±1/64 PARALLELITY: T.I.R. _____ FLATNESS: T.I.R. _____ CONCENTRICITY: T.I.R. _____ ANGLES AND PERPENDICULARITY: ±1°	CAGE CODE <b>34078</b>	<b>MIDWEST MICROWAVE</b>	
			TITLE SMA FEMALE TO BMA FEMALE OUTLINE DRAWING
DRAWN/DATE S.ORLOV 12/20/04	ENG./DATE G.HOUGHTON 12/22/04	DRAWING NUMBER ADT-2805-SF-BMF-02-01	REV. -
CHECKED/DATE	APPROVED/DATE G.HOUGHTON 12/22/04	SCALE: 10=1	SHEET 1 of 1

DATE	12/22/94
DESCRIPTION	RELEASED
REV.	-