

LOC		DIST		REVISIONS			
P	LTR	DESCRIPTION	DATE	DN	APVD		
C		REVISED PER ECO-12-022391	02JAN32013	CJV	SLB		

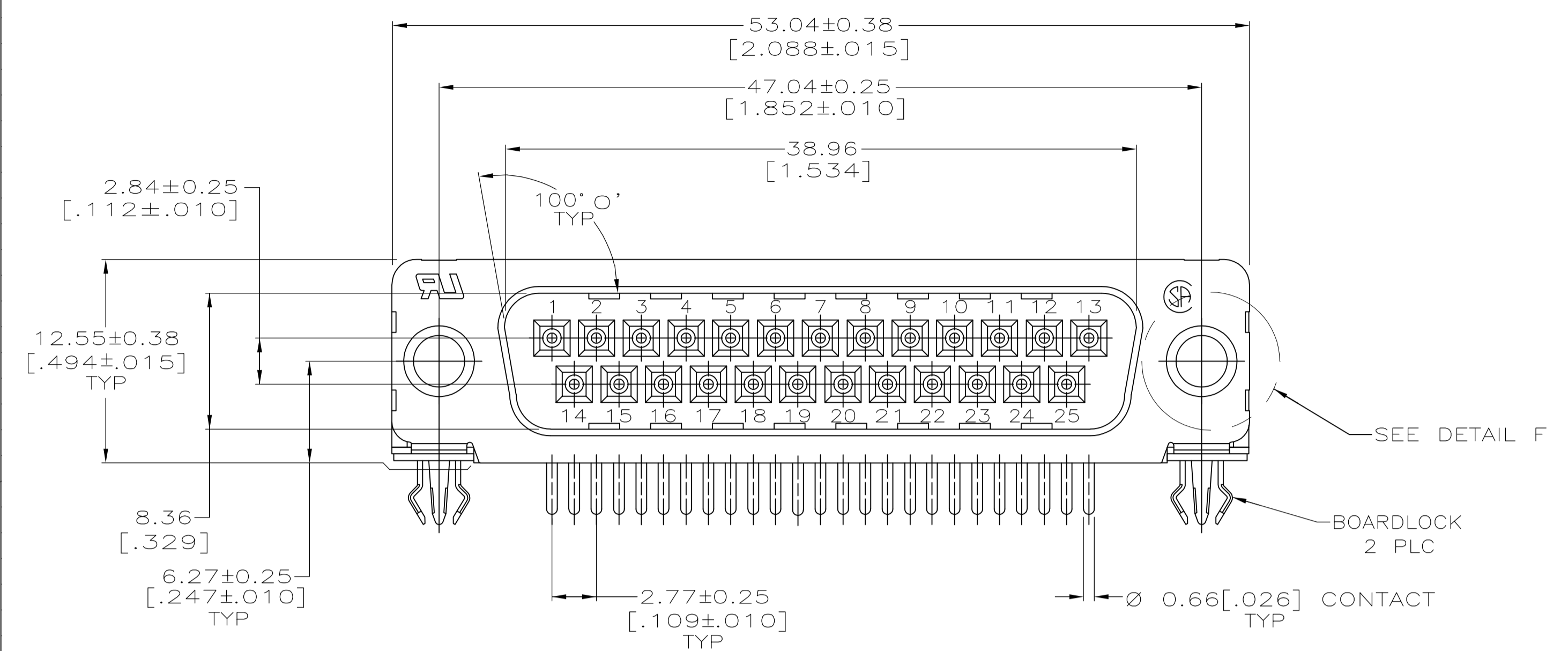

- 1 HOUSING: NYLON OR POLYESTER, FLAME RETARDANT, UL 94V-0 RATED, GLASS FILLED, BLACK.
CONTACTS: BRASS
SHELL: CARBON STEEL
EYELETS: BRASS.
BOARDLOCKS: COPPER ALLOY
SCREWLOCKS & INSERTS: ZINC
- 2 SHELL: 2.54μm[.000100] MIN TIN OVER 1.27μm[.000050] MIN COPPER.
EYELETS: 2.54μm[.000100] MIN TIN OVER COPPER FLASH.
BOARDLOCKS: 3.81μm[.000150] MIN TIN OVER 1.27μm[.000050] MIN NICKEL.
CONTACTS: 0.76μm[.000030] MIN GOLD PLATE ON THE MATING SURFACES,
2.54μm[.000100] MIN TIN PLATE ON THE SOLDER END,
1.27μm[.000050] MIN NICKEL UNDERPLATE ON THE ENTIRE CONTACT
-OR-
GOLD FLASH OVER PALLADIUM-NICKEL PLATE, 0.76μm[.000030] MIN TOTAL ON THE MATING SURFACES, 2.54μm[.000100] MIN TIN PLATE ON THE SOLDER END, 1.27μm[.000050] MIN NICKEL UNDERPLATE ON THE ENTIRE CONTACT.
SCREWLOCKS & INSERTS: CLEAR CHROMATE.

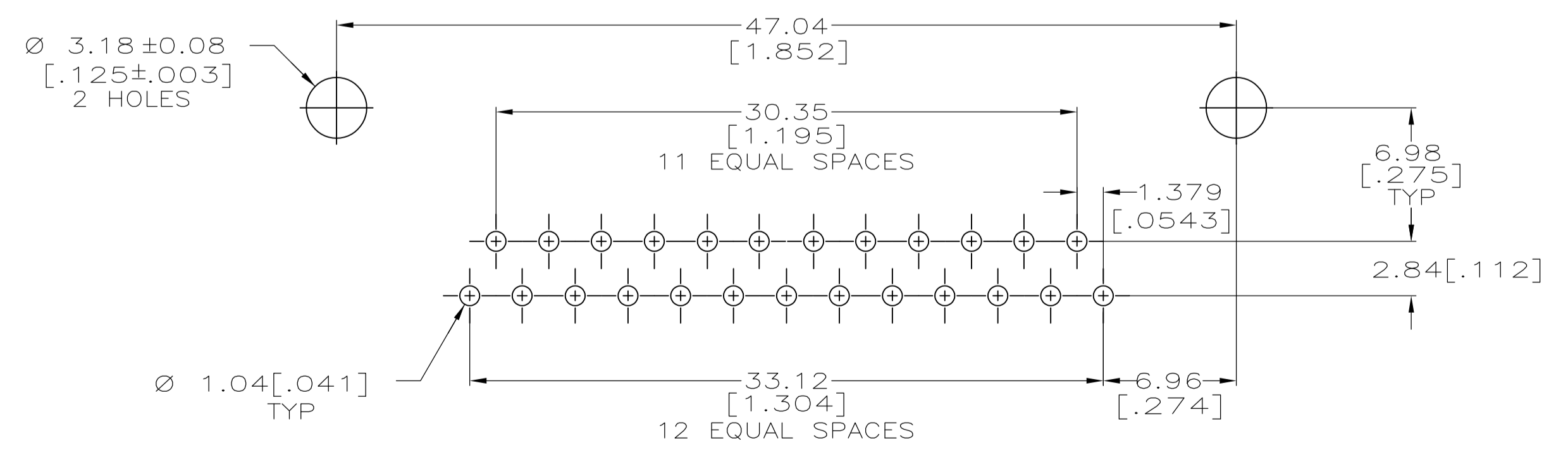
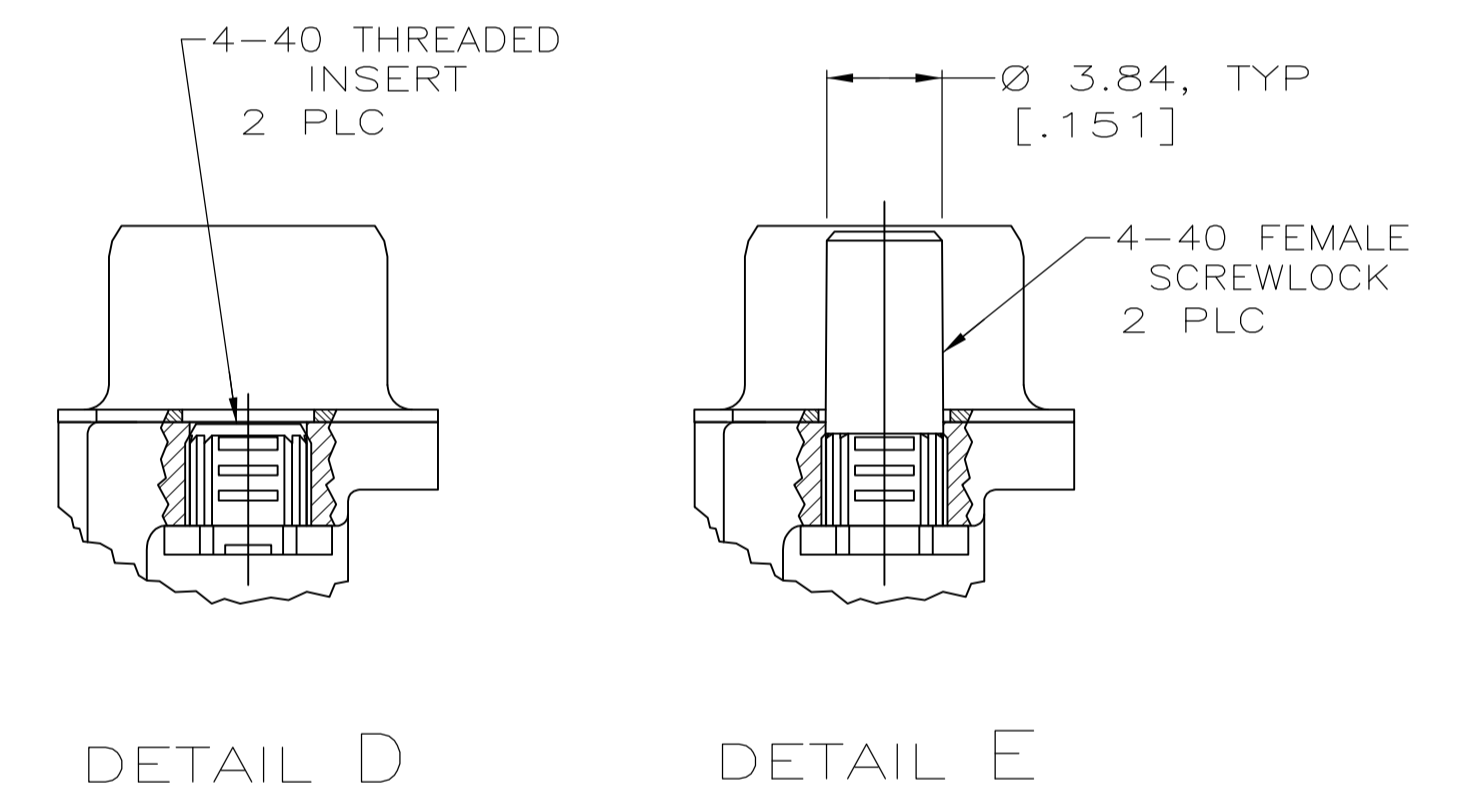
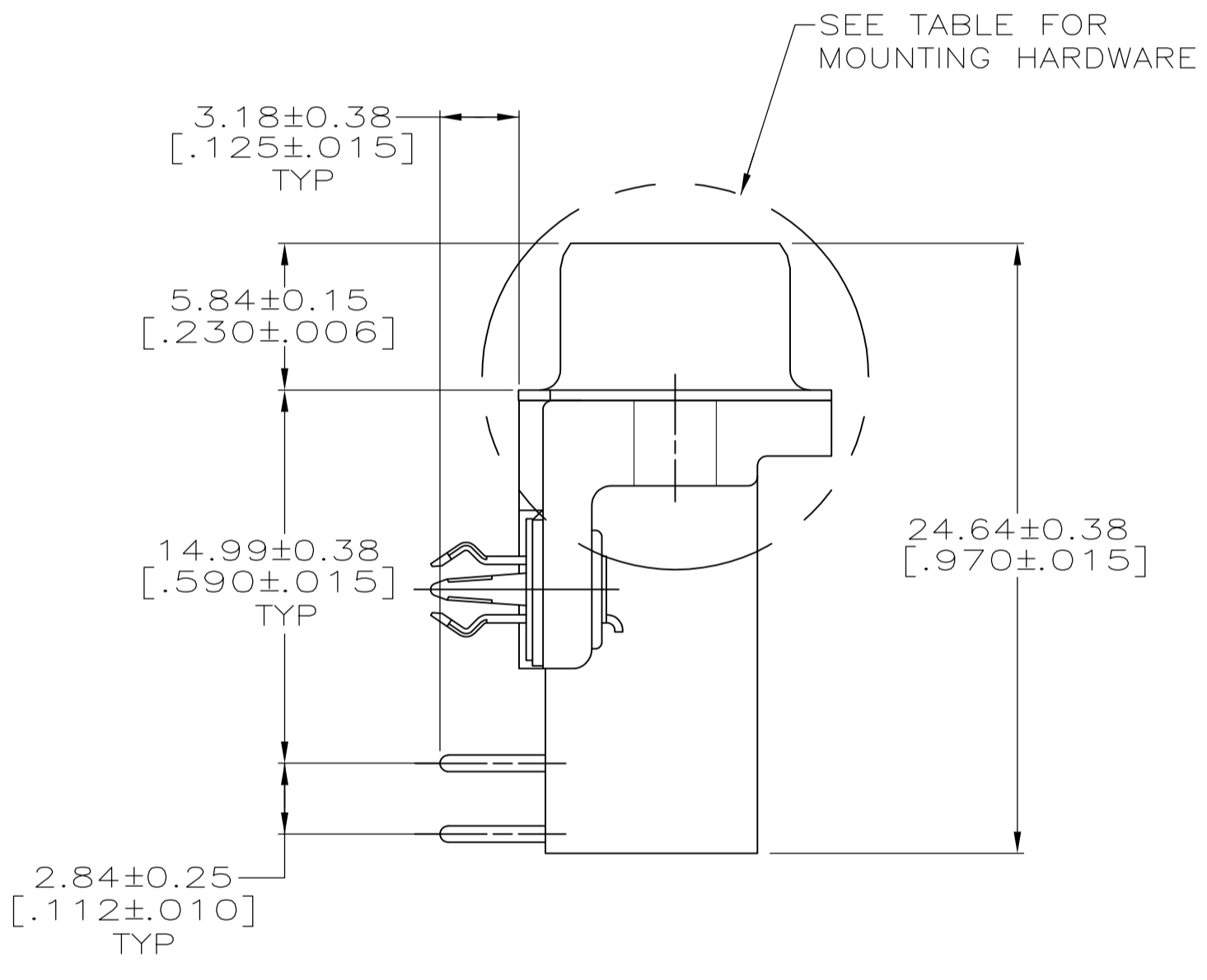
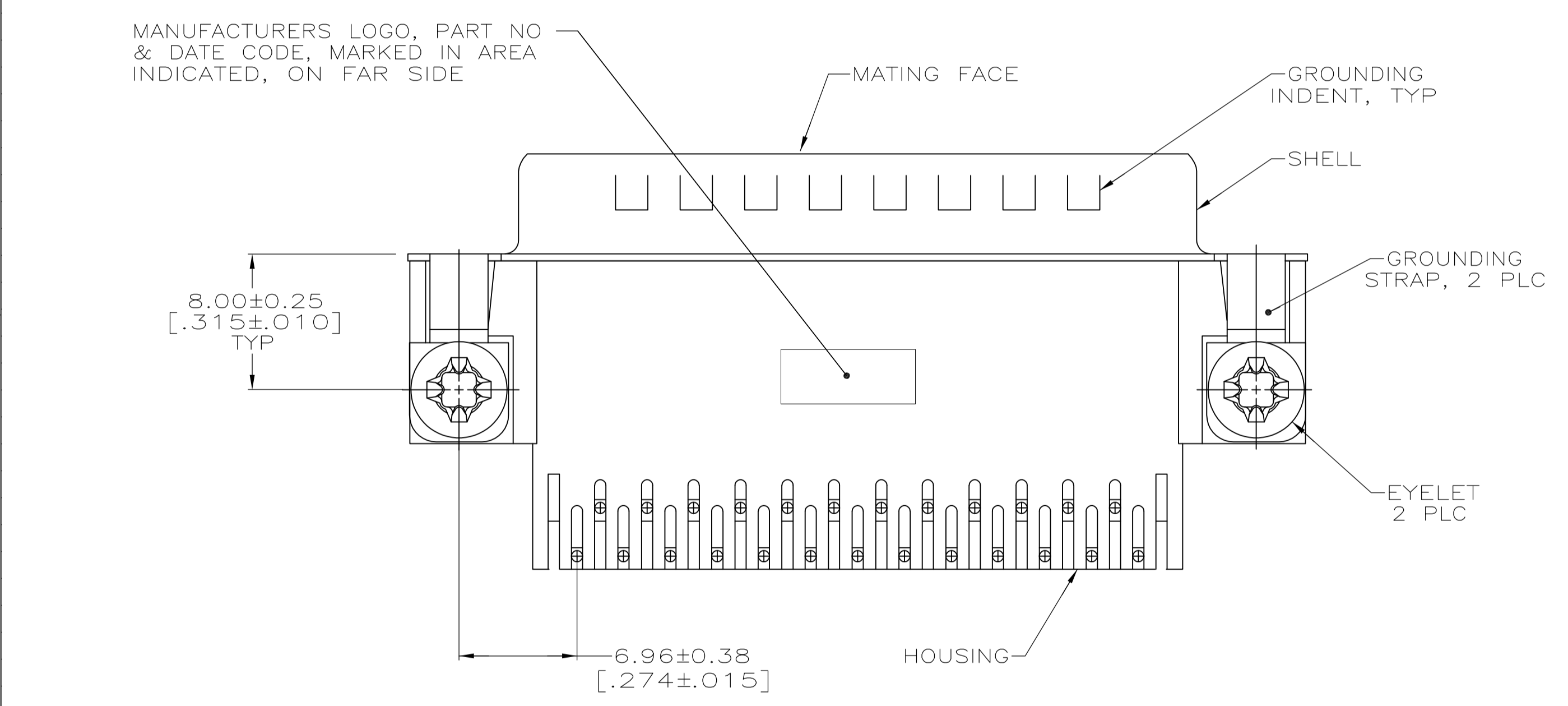

RECOMMENDED P.C. BOARD MOUNTING DIMENSIONS
P.C. BOARD THICKNESS: 1.57[.062]

COPYRIGHT 2005
TYCO ELECTRONICS CORP
ALL RIGHTS RESERVED

SEE DETAIL E	5747834-6
SEE DETAIL D	5747834-4
MOUNTING HARDWARE	PART NUMBER

THIS DRAWING IS A CONTROLLED DOCUMENT. DIMENSIONING AND TOLERANCING PER ASME Y14.5M-2009		DIN G. ATTADIA - DOCKS 04-11-05		CJK S. BOLASH 04-11-05		APVD M. WALMSLEY 04-11-05		NAME	
DIMENSIONS: mm [INCHES]		TOLERANCES UNLESS OTHERWISE SPECIFIED:		PRODUCT SPEC		APPLICATION SPEC		RESTRICTED TO	
∅		0 PLC ± -		108-40025		114-40010		SIZE	
∅		1 PLC ± -		108-40025		114-40010		CASE CODE	
∅		2 PLC ± -		108-40025		114-40010		DRAWING NO	
∅		3 PLC ± 0.13[.005]		108-40025		114-40010		DRAWING NO	
∅		4 PLC ± -		108-40025		114-40010		DRAWING NO	
∅		ANGLES ± α °		108-40025		114-40010		DRAWING NO	
MATERIAL		FINISH		WEIGHT		SCALE		SHEET	
1		2		A1 00779 C=5747834		4:1		1 OF 1	
CUSTOMER DRAWING		SCALE		SHEET		REV		C	



PLUG ASSEMBLY, SIZE 3, 25 POSITION, RIGHT ANGLE, FRONT METAL SHELL, .590 SERIES, BOARDLOCKS, AMPLIMITE HD-20