



# 680 MHz Ceramic Bandpass Filter

Part Number: AM680B1525



**ANATECH ELECTRONICS INC**  
RF & Microwave Filters & Products

## Electrical specifications

**Center Frequency:** 680 MHz  
**Bandwidth:** 44 MHz  
**Insertion Loss:** 3.0 dB max  
**Passband Ripple:** 0.4 dB max  
**Return Loss (BW):** 1.5 : 1 dB max  
**Input / Output Impedance:** 50 Ohms  
**Rejection:** 45dBc min at DC-500MHz  
**Rejection 2:** 33dBc min at 500-600MHz  
**Rejection 3:** 40dBc min at 800-900MHz  
**Rejection 4:** 55dBc min at 900-1100MHz  
**Rejection 5:** 30dBc min at 1100-1450MHz  
**Power Handling:** 2 W

## Mechanical

**Mounting Method:** SMT  
**Dimensions:** 26.4 x 14 x 4.65 mm

## Environmental

**Operating Temperature:** -20 C to 70 C  
**Storage Temperature:** -50 C to +90 C

**This product is RoHs compliant.**

## Outline Drawing:

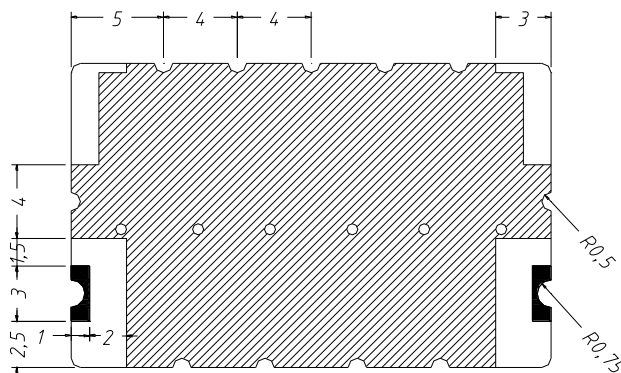
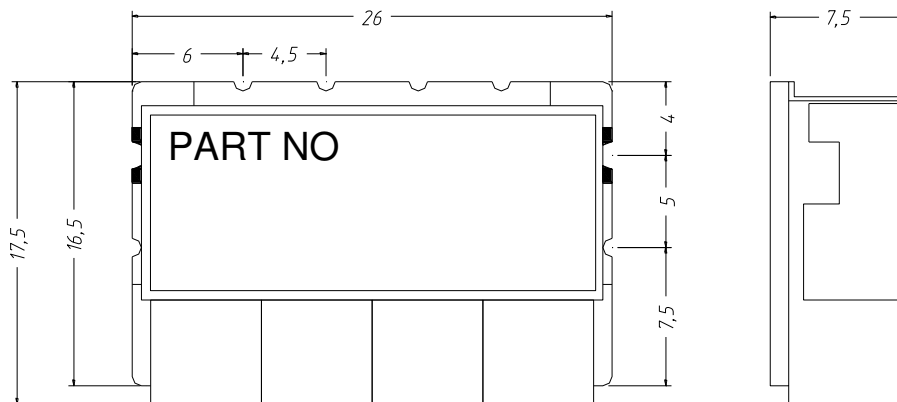

■ IN/OUT PORT

▨ GROUND

TOLERANCE : +/- 0.2

UNIT : mm