

CIRCUIT SIZE	"A"	"B"	C
06	$\frac{.630}{16.00}$	$\frac{.236}{6.00}$	$\frac{.590}{15.00}$
08	$\frac{.748}{19.00}$	$\frac{.354}{9.00}$	$\frac{.709}{18.00}$
10	$\frac{.866}{22.00}$	$\frac{.472}{12.00}$	$\frac{.827}{21.00}$
18	$\frac{1.338}{34.00}$	$\frac{.945}{24.00}$	$\frac{1.299}{33.00}$
24	$\frac{1.693}{43.00}$	$\frac{1.299}{33.00}$	$\frac{1.653}{42.00}$

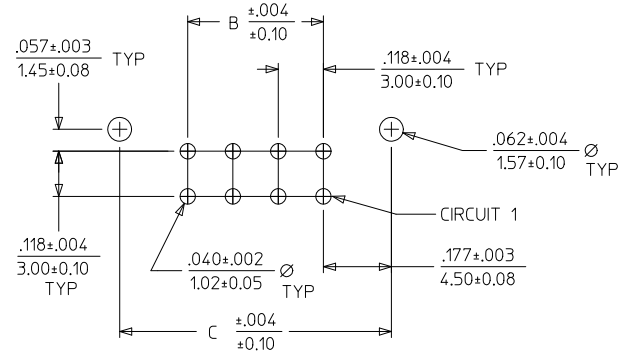
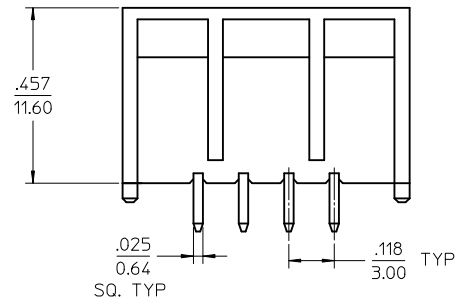
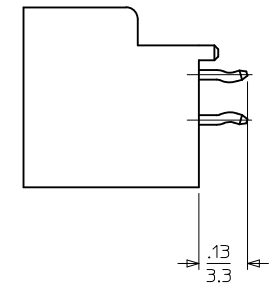
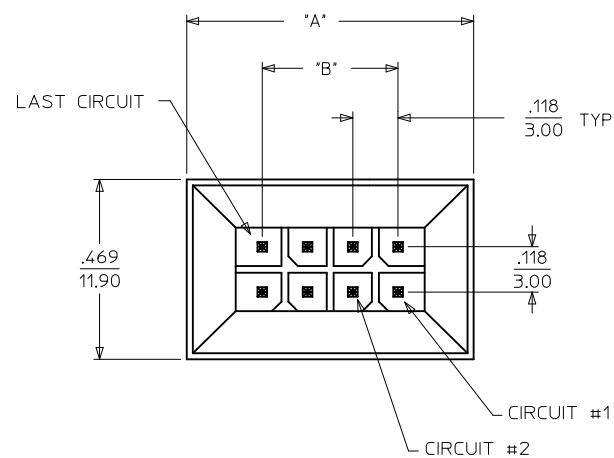

PCB LAYOUT: COMPONENT SIDE
RECOMMENDED PCB THICKNESS .062/1.57

NOTES :

- MATERIALS -
HOUSING : NYLON , GLASS-FILLED, UL94V-0 COLOR - BLACK
TERMINAL : BRASS ALLOY
- FINISH:
A = .000015/(0.00038) MIN. SELECT GOLD IN CONTACT AREA;
.000100/(0.00254) MIN. SELECT TIN ON SOLDER TAILS;
BOTH OVER .000050/(0.00127) MIN. NICKEL.
B = .000030/(0.00076) MIN. SELECT GOLD IN CONTACT AREA;
.000100/(0.00254) MIN. SELECT TIN ON SOLDER TAILS;
BOTH OVER .000050/(0.00127) MIN. NICKEL.
- PRODUCT SPECIFICATION : PS-44300-001
- PACKAGING SPECIFICATION : PK-44432-001
- THIS ASSEMBLY MATES WITH MOLEX BMI PANEL MOUNT RECEPTACLE (SEE DRAWING SD-44133-001) & FEMALE CRIMP TERMINAL (SEE DRAWING SD-43030-****)
- THE PRIMARY SHIPPING CARTON WILL BE LABELED, "COMPLIANT TO RoHS DIRECTIVE 2002/95/EC AND ELV ANNEX II OF DIRECTIVE 2000/53/EC", AND ASSEMBLIES WILL BE COMPLIANT TO THE RoHS AND ELV (LEAD-FREE) DIRECTIVES.
- THIS PART CONFORMS TO CLASS B REQUIREMENTS OF COSMETIC SPECIFICATION PS-45499-002.

CORRECT HOUSING EC NO: UCP2011-2322 DRWINMSTROH 2011/02/04 CHKD:SSOUSEK 2011/02/07 APPR:FSMITH 2011/07/11	QUALITY SYMBOLS ▽=0 ▽=0 ▽=0	GENERAL TOLERANCES (UNLESS SPECIFIED)		DIMENSION STYLE IN/MM	SCALE 4:1	DESIGN UNITS METRIC	THIRD ANGLE PROJECTION	
		mm	INCH	DRAWN BY RHOLTS	DATE 2004/07/21	TITLE MICRO FIT (3.0) DUAL ROW VERTICAL BMI HEADER ASSY, LEADFREE		
		4 PLACES ± --- ± ---	3 PLACES ± --- ± .010	CHECKED BY LSCHMIDT	DATE 2004/07/21	APPROVED BY FSMITH		
MATERIAL NO.		ANGULAR ±1/2°		DATE 2004/07/21		MOLEX INCORPORATED		
DRAFT WHERE APPLICABLE MUST REMAIN WITHIN DIMENSIONS		SEE CHART		DOCUMENT NO. SD-44432-002		SHEET NO. 1 OF 2		
THIS DRAWING CONTAINS INFORMATION THAT IS PROPRIETARY TO MOLEX INCORPORATED AND SHOULD NOT BE USED WITHOUT WRITTEN PERMISSION								

MATERIAL NUMBER	NUMBER OF POSITIONS	PLATING OPTION
44432-0652	06	A
44432-0653	06	B
44432-0853	08	B
44432-1052	10	A
44432-1853	18	B
44432-2453	24	B

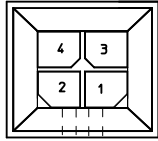

4 CIRCUIT

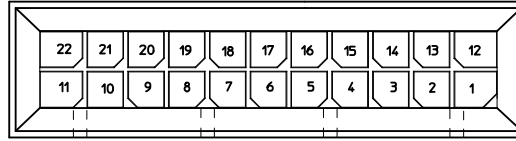

22 CIRCUIT

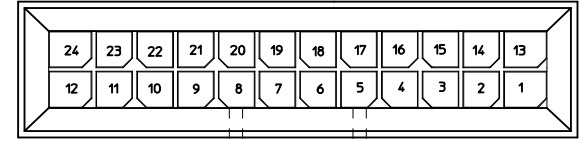

24 CIRCUIT

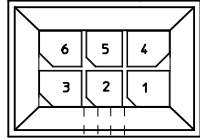

6 CIRCUIT

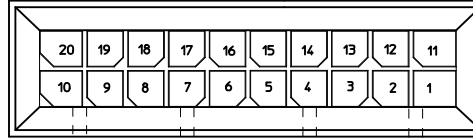

20 CIRCUIT

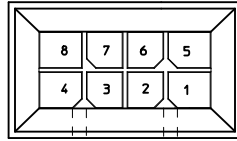

8 CIRCUIT

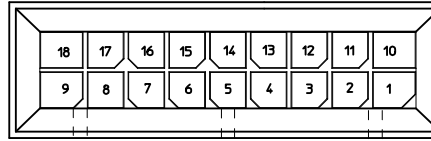

18 CIRCUIT

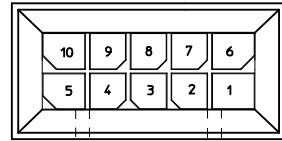

10 CIRCUIT

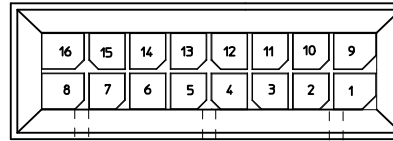

16 CIRCUIT

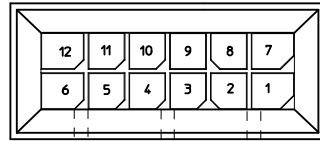

12 CIRCUIT

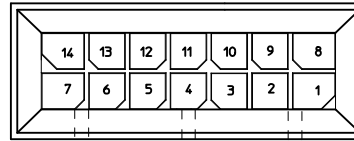

14 CIRCUIT

POLARIZATION LAYOUT
4-24 CIRCUITS

REDRAWN IN AMT EC NO: UCP2011-2322 DRW:MMSTROH 2011/02/04 CHKD:SSOUSEK 2011/02/07 APPR:FSMITH 2011/07/11	QUALITY SYMBOLS 	GENERAL TOLERANCES (UNLESS SPECIFIED)		DIMENSION STYLE IN/MM	SCALE 4:1	DESIGN UNITS METRIC	THIRD ANGLE PROJECTION		
		4 PLACES ± --- ± --- 3 PLACES ± --- ± .010 2 PLACES ± 0.25 ± .015 1 PLACE ± 0.38 ± ---	mm INCH	DRAWN BY RHOLTS	DATE 2004/07/21	TITLE MICRO FIT (3.0) DUAL ROW VERTICAL BMI HEADER ASSY, LEADFREE			
		ANGULAR ±1/2°		CHECKED BY LSCHMIDT	DATE 2004/07/21	MOLEX INCORPORATED			
		DRAFT WHERE APPLICABLE MUST REMAIN WITHIN DIMENSIONS		APPROVED BY FSMITH	DATE 2004/07/21	SEE CHART SEE CHART	DOCUMENT NO. SD-44432-002	SHEET NO. 2 OF 2	
A2	REV	SIZE 		THIS DRAWING CONTAINS INFORMATION THAT IS PROPRIETARY TO MOLEX INCORPORATED AND SHOULD NOT BE USED WITHOUT WRITTEN PERMISSION					