

THIS DRAWING IS UNPUBLISHED. RELEASED FOR PUBLICATION .19
 BY AMP INCORPORATED. ALL RIGHTS RESERVED.

| LOC | DIST | REVISIONS | | | |
|-----|------|-------------|----------------------|---------|---------------|
| P | LTR | DESCRIPTION | DATE | DWN | APVD |
| AD | 00 | G | REV PER 0621-0284-98 | REDRAWN | 25JAN99 BH 5B |

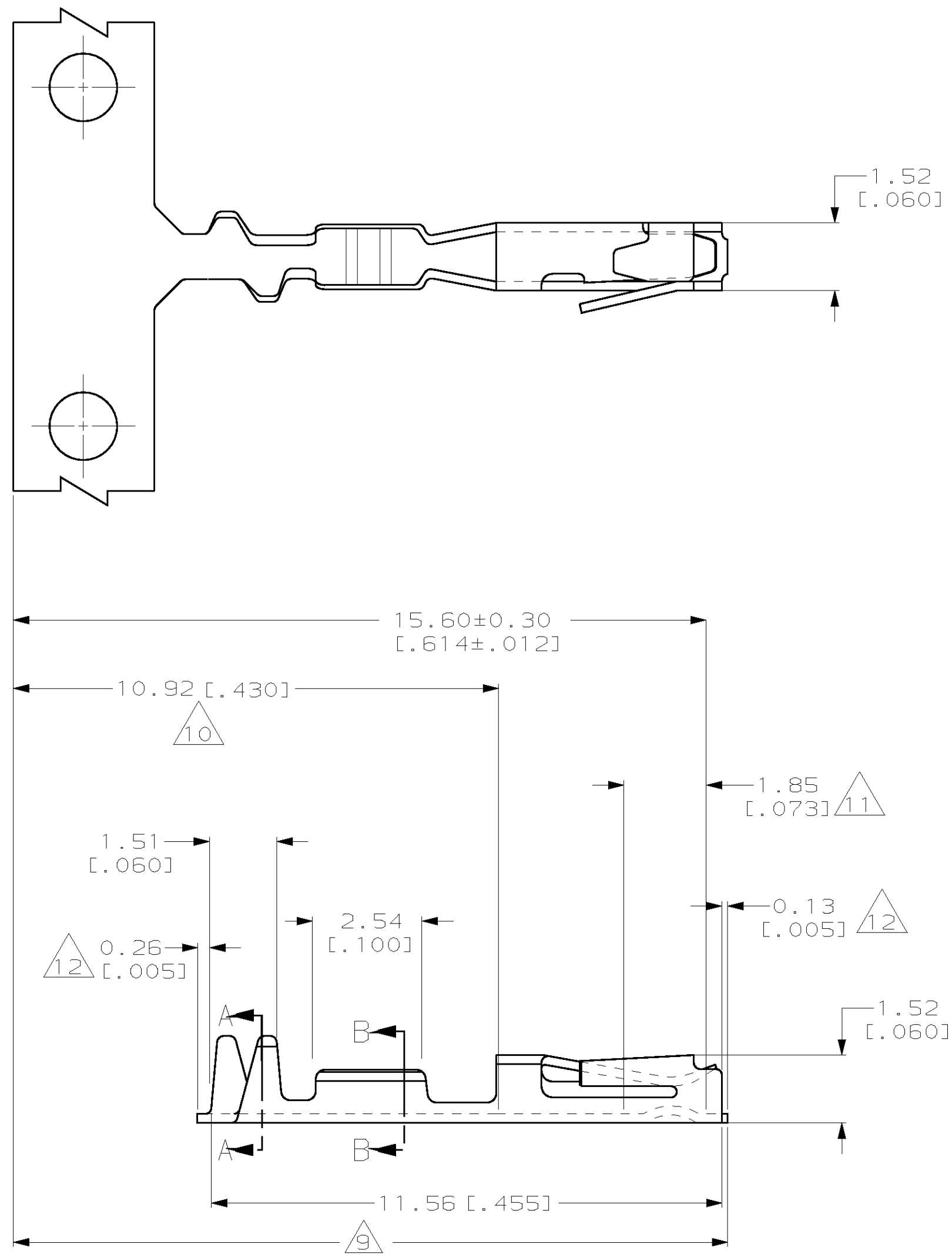

1. WIRE RANGE 28-32 AWG.
2. INSULATION RANGE 0.71-1.37 [.028-.054] DIA.
3. 0.00254 [.000100] MIN TIN-LEAD OVER 0.000762 [.000030] MIN NICKEL.
4. PREPLATED 0.00127 [.000050] MIN TIN-LEAD IN ZONES I & II, 0.000762 [.000030] MIN GOLD OVER 0.000762 [.000030] MIN NICKEL INLAY IN ZONE III.
5. PREPLATED 0.00127 [.000050] MIN TIN-LEAD IN ZONES I & II, 0.000381 [.000015] MIN GOLD OVER 0.000762 [.000030] MIN NICKEL INLAY IN ZONE III.
6. PREPLATED 0.00127 [.000050] MIN TIN-LEAD IN ZONES I & II, 0.00127 [.000050] MIN GOLD OVER 0.000762 [.000030] MIN NICKEL INLAY IN ZONE III.
7. PHOSPHOR BRONZE.
8. OBSOLETE.
9. ZONE I (OUTSIDE SURFACES).
10. ZONE II (INSIDE SURFACES).
11. ZONE III (INSIDE SURFACES).
12. MAXIMUM CUTOFF.

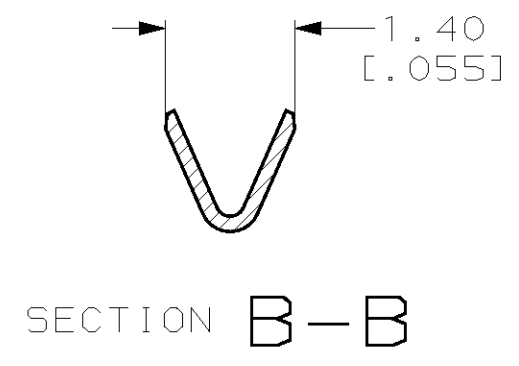
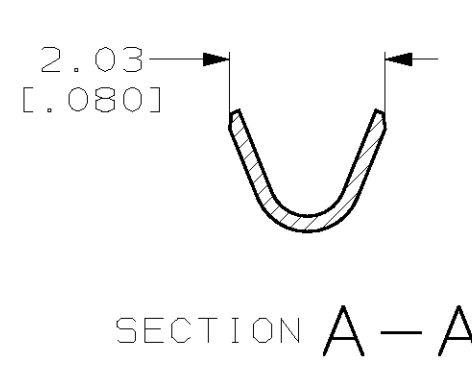

| | | | | |
|--------|---|---------------------|---------------|----------|
| 6 | 8 | 531225-9 | 8 | 531225-8 |
| 4 | 8 | 531225-7 | 8 | 531225-6 |
| 5 | 8 | 531225-5 | 8 | 531225-4 |
| 3 | 8 | 531225-3 | 8 | 531225-2 |
| FINISH | | LOOSE PIECE PART NO | STRIP PART NO | |

| | | | | |
|--|--|-------------------------------|---|----------------------|
| THIS DRAWING IS A CONTROLLED DOCUMENT. | | DWN B. HAYMAKER 25JAN99 | AMP Incorporated Harrisburg, PA 17105-3608 | |
| DIMENSIONS: MM(INCH) | | CHK S. BOLASH 25JAN99 | AMP | |
| TOLERANCES UNLESS OTHERWISE SPECIFIED: | | APVD S. BOLASH 25JAN99 | CONTACT, RECEPTACLE, HIGH PRESSURE MINI-TANDEM SPRING | |
| 0 PLC ±- | | PRODUCT SPEC 108-25031 | SIZE A2 | |
| 1 PLC ±- | | APPLICATION SPEC 114-25021 | CAGE CODE 00779 | DRAWING NO 531225 |
| 2 PLC ±- | | MATERIAL 7 | RESTRICTED TO | |
| 3 PLC ±0.13(.005) | | FINISH 3 4 5 6 | SCALE 4:1 | SHEET 1 OF 1 |
| 4 PLC ±- | | WEIGHT - | REV G | |
| ANGLES ±- | | CUSTOMER DRAWING | | |

531225

B

A