

Catalogue symbol:

- GF(Amps)

Technical data:

- Rated voltage: 550 V a.c. / 250 V d.c.
- Rated current: 710 to 800 A
- Breaking capacity: 80 kA a.c. / 40 kA d.c.
- Breaking range and utilisation category: gG
- Size: C3

Standards/Approvals:

- BS88-2
- IEC 60269-2
- Suitable for use in RoHS compliant applications

Packaging:

- MOQ 1

Table 1. Technical data

Part number	Rated voltage	Rated current (Amps)	Energy integrals I ² t (A ² S)		Watts loss	Dimensions (mm)										Product class	Weight
			Pre-arcing	Total at 415 V a.c.		A	B	C	D	E	F	G	H	J			
GF710	550 V a.c. 250 V d.c.	710	3500	8100	53	210	185	80.5	10.5	15.5	25.4	134.5	83	9.5	gG	2.6Kg	
GF800	550 V a.c. 250 V d.c.	800	5000	11,500	64	210	185	80.5	10.5	15.5	25.4	134.5	83	9.5	gG	2.6Kg	

Outline drawing

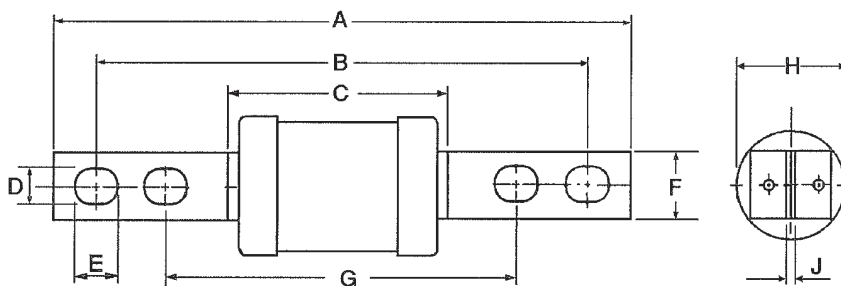

Time current curve

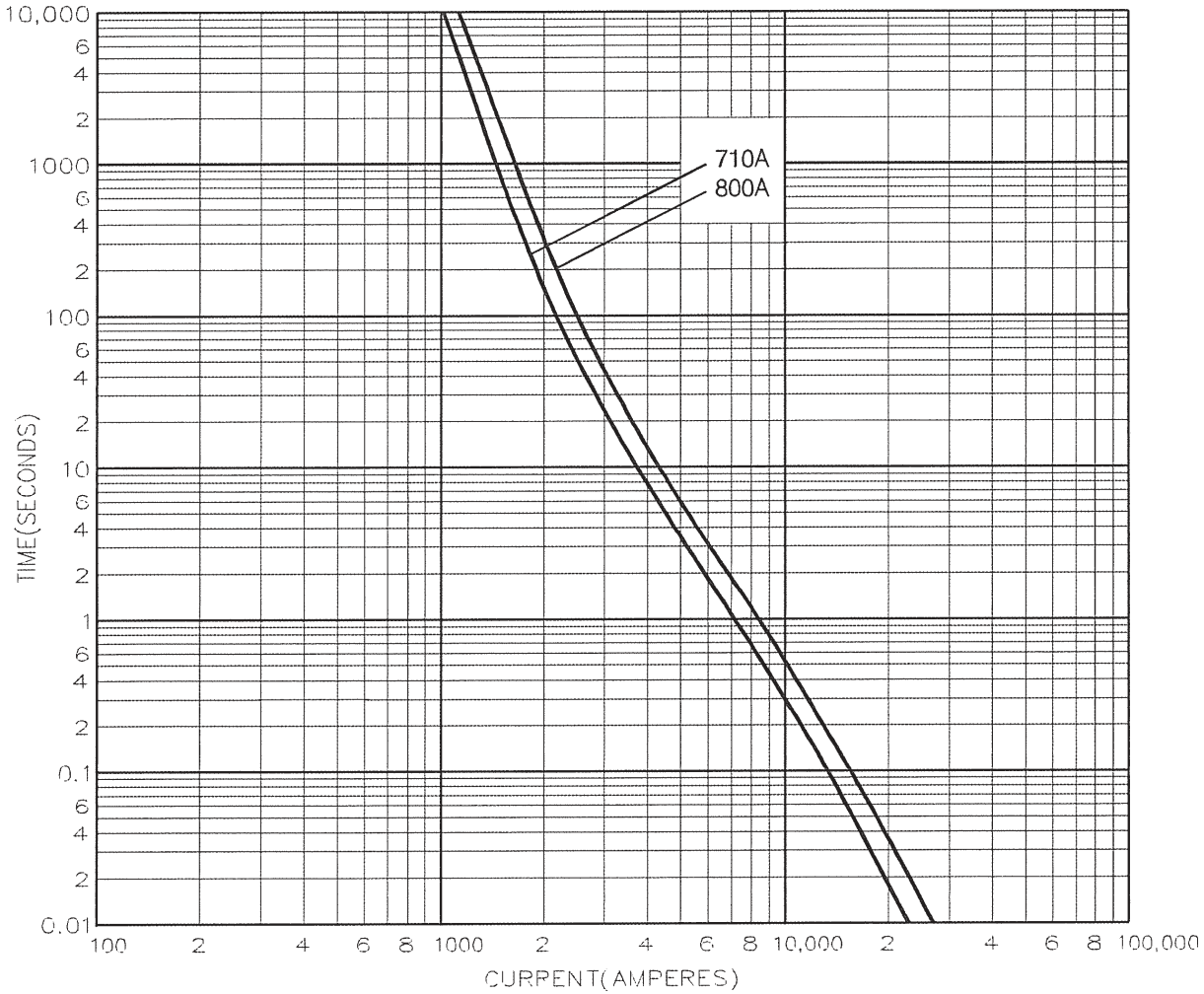

Changes to the products, to the information contained in this document, and to prices are reserved; so are errors and omissions. Only order confirmations and technical documentation by Eaton is binding. Photos and pictures also do not warrant a specific layout or functionality. Their use in whatever form is subject to prior approval by Eaton. The same applies to Trademarks (especially Eaton, Moeller, and Cutler-Hammer). The Terms and Conditions of Eaton apply, as referenced on Eaton Internet pages and Eaton order confirmations.

Eaton
 EMEA Headquarters
 Route de la Longeraie 7
 1110 Morges, Switzerland

Eaton Electrical Products Limited
 Melton Road
 Burton-on-the-Wolds
 Leicestershire, LE12 5TH
 United Kingdom

© 2017 Eaton
 All Rights Reserved
 PDF Only
 Publication No. 4103
 October 2017

Eaton is a registered trademark.

All other trademarks are property of their respective owners.