

Rev	AWO #	Description	Date	Appr
-		RELEASED	9/27/21	

APPROVED: _____

DATE: _____ TITLE: _____

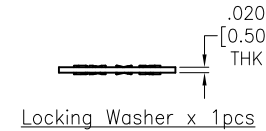
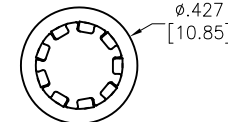
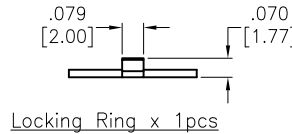
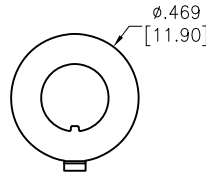
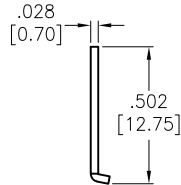
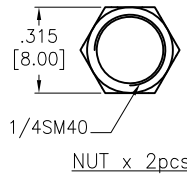
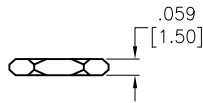
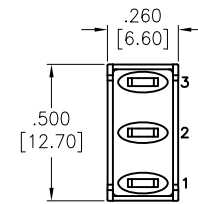
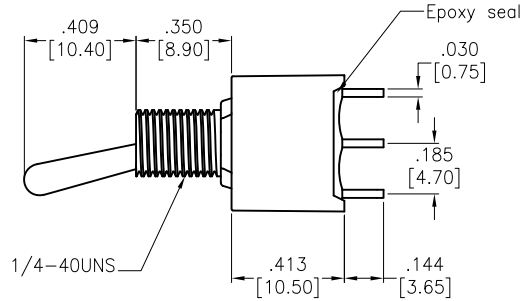
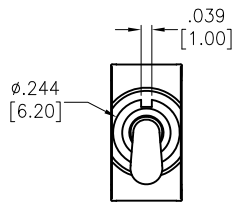
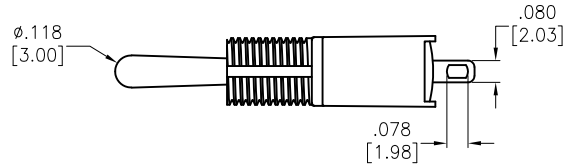

SW-T2-2B-A-T1-X-03
 S=Contact Silver Plated
 G=Contact Gold Plated

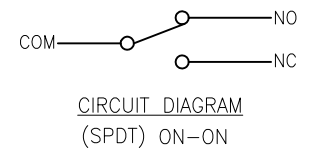

SPECIFICATIONS:

Material:
 Movable contact: Copper Alloy, Silver plated
 Terminals: Silver plated with outer layer in Gold plating
 Electrical:
 Rating: 5 Amps with resistive load @ 125VAC or 28VDC
 2 Amps with resistive load @ 250VAC
 Contact resistance: 10 mohms max initial
 Insulation resistance: 1000 Mohms min
 Dielectric withstanding voltage: 1500V RMS @ sea level
 Electrical life: 50,000 make and break cycles at full load
 Temperature Rating:
 Operating temperature: -30°C to +85°C
 Environmental:
 IP Class: IP67
 Lead free, RoHS compliant



UNLESS OTHERWISE SPECIFIED ALL DIMENSIONS ARE INCHES [MM]. TOLERANCES: EXCEPT AS NOTED			909 Rahway Avenue, Union, NJ 07083 Phone: 908-687-5000 Fax: 908-687-5710																												
<table border="1"> <tr> <th colspan="2">INCHES</th> <th colspan="2">HOLES</th> </tr> <tr> <td>.X</td> <td>± .10</td> <td>ØX</td> <td>± .10</td> </tr> <tr> <td>.XX</td> <td>± .020</td> <td>ØXX</td> <td>± .015</td> </tr> <tr> <td>.XXX</td> <td>± .015</td> <td>ØXXX</td> <td>± .010</td> </tr> </table>			INCHES		HOLES		.X	± .10	ØX	± .10	.XX	± .020	ØXX	± .015	.XXX	± .015	ØXXX	± .010	<table border="1"> <tr> <td>TITLE</td> <td colspan="3">MINIATURE TOGGLE SWITCH, SPDT, ON-ON, SOLDER TYPE</td> </tr> <tr> <td>SIZE</td> <td>PART NO.</td> <td>REV.</td> <td></td> </tr> <tr> <td>X</td> <td>SW-T2-2B-A-T1-X-03</td> <td>-</td> <td></td> </tr> </table>		TITLE	MINIATURE TOGGLE SWITCH, SPDT, ON-ON, SOLDER TYPE			SIZE	PART NO.	REV.		X	SW-T2-2B-A-T1-X-03	-
INCHES		HOLES																													
.X	± .10	ØX	± .10																												
.XX	± .020	ØXX	± .015																												
.XXX	± .015	ØXXX	± .010																												
TITLE	MINIATURE TOGGLE SWITCH, SPDT, ON-ON, SOLDER TYPE																														
SIZE	PART NO.	REV.																													
X	SW-T2-2B-A-T1-X-03	-																													
DRAWN	JJ	9/27/21	REF:	S00198T																											
CHECKED	RC	9/27/21	SCALE:	NTS																											
APPROVED			SHEET	1 OF 1																											