

REV.	DATE	DESCRIPTION
NC	08/01/02	INITIAL RELEASE

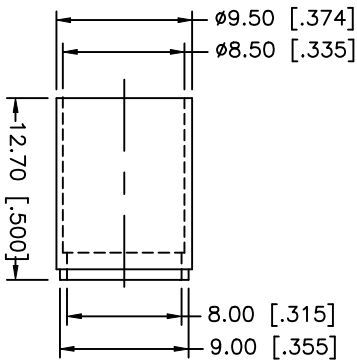
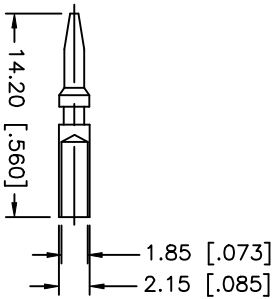
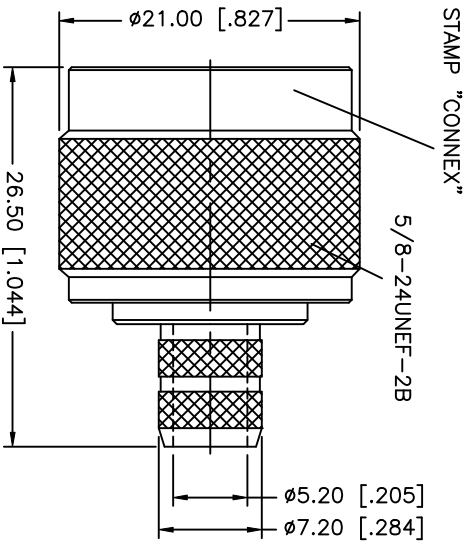
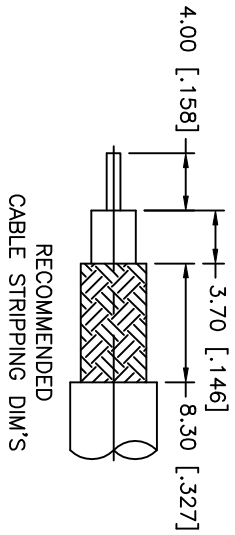

CRIMP NOTES:

1. CRIMPED FERRULE
HEX CRIMP SIZE .324"
2. CRIMPED CONTACT PIN
HEX CRIMP SIZE .068"

DESCRIPTION	MATERIAL	FINISH
8		
7		
6		
5		
4	BRASS	NICKEL
3	BRASS	GOLD
2	TEFLON	NATURAL
1	BRASS	NICKEL

UNLESS OTHERWISE SPECIFIED DIMENSIONS ARE IN MILLIMETERS ARE IN INCHES FOR CUSTOMER REFERENCE ONLY

UNLESS OTHERWISE SPECIFIED TOLERANCES FOR INCHES ARE:
 .XXX = ± 0.005"
 .XX = ± 0.010"
 .X = ± 0.020"

DO NOT SCALE DRAWING

APPROVALS	DATE
DRAWN G.R.S.	08/01/02
CHECKED	
ISSUED	

Amphenol - Connex
CONNECTOR CORPORATION

N CRIMP PLUG
FOR LMR 300 CABLE

SIZE: A
SCALE: NA

FORM NO.: 99001
PART NO.: 172304
DWG. NO.: 172304.DWG

SHEET 1 OF 1

REV. NC