

LOC	DIST	ZONE	LTR	REVISIONS	DESCRIPTION	DATE	APPD
G	14			B	REVISED PER 0720-0230-93	2/25/94	DAW

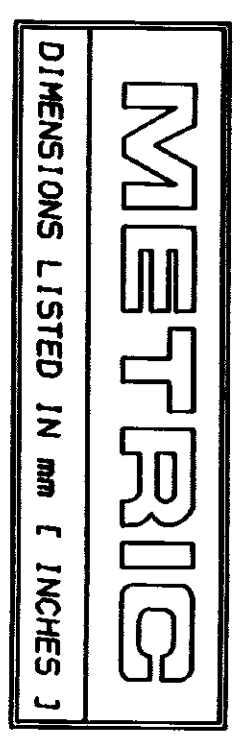

AMP WIRE RANGE	IL E13288 Listed
16-14 AWG STRANDED	16-14 AWG STRANDED
LR2189 Certified	MILITARY P/N AND CLASS
NOT CERTIFIED	NOT APPLICABLE

△ STAMP AMP 16-14* APPROX AS SHOWN

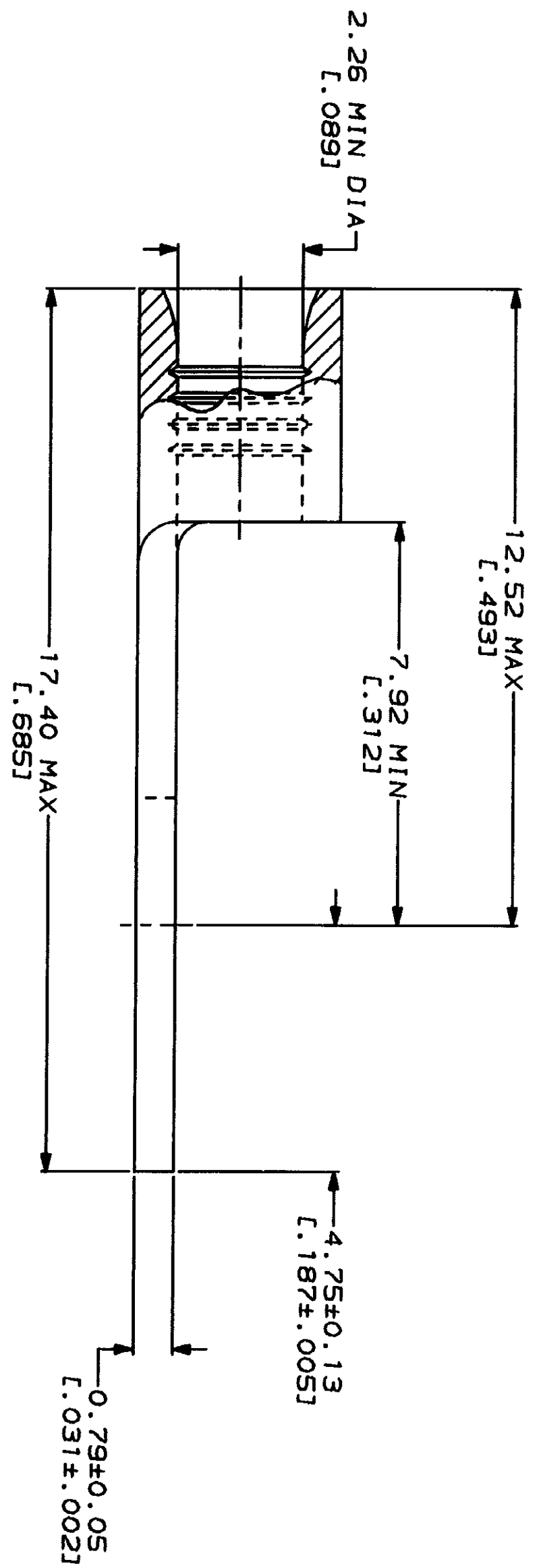
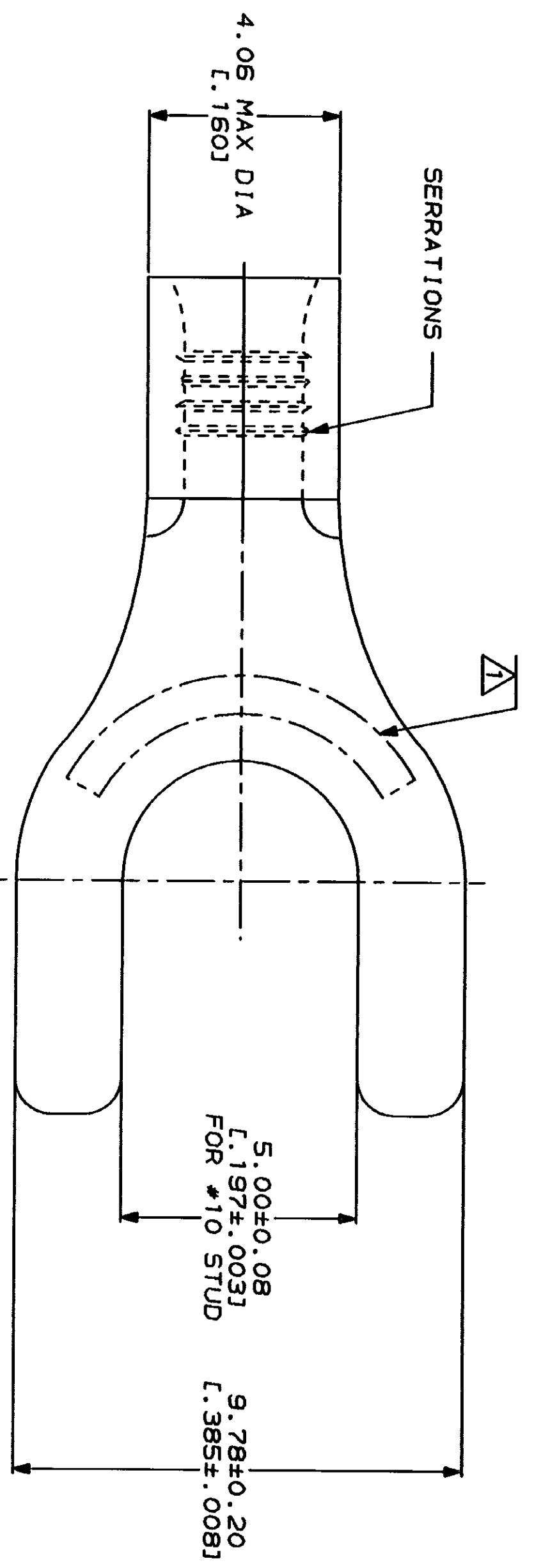

AMP INCORPORATED
 CUSTOMER SERVICE SYSTEMS

FOR ADDITIONAL PRODUCT INFORMATION OR COPIES OF DRAWINGS AND TECHNICAL DOCUMENTS
 1-800-522-6752
 PRODUCT INFORMATION CENTER

FOR APPLICATION TOOLING INFORMATION
 1-800-722-1111
 TOOLING ASSISTANCE CENTER

FOR ORDER ENTRY
 1-800-526-5142

MAX RECOMMENDED OPERATING TEMPERATURE: 170°C MAX

VOLTAGE RATING: NOT APPLICABLE

WIRE CROSS SECTIONAL AREA RANGE: 1.04-2.62mm² (2,050-5,180) CIR MILS STRANDED

DO NOT SCALE PRINT. UNLESS SPECIFIED DIMENSIONS IN INCHES—TOLERANCES ON: 1. PLC DEC ± .005 ANGLES ± .5° MATERIAL COPPER PER ASTM B-152 ANNEALED

FINISH TIN PLATE 0.00254 [L.000100] MIN THK PER MIL-T-10727

DR 2-17-93 TA BRINKMAN	NAME	AMP Incorporated Harrisburg, PA 17105-3508
CHK 2-17-93 DA PATTERSON	SIZE	00779
APPD 2-17-93 DE MILLER	CAGE CODE	31706
APPD 2-17-93 JL HECKLEY	DRAWING NO	31706
PRODUCT SPEC	SCALE	10:1
APPLICATION SPEC	SHEET	1 OF 1
WEIGHT		

CUSTOMER DRAWING