

MATERIALS AND FINISHES:

BODY: ZINC/BRASS  
PLATED NICKEL

CENTER CONTACT: BRASS  
PLATED GOLD

OUTER CASING: PLASTIC  
KEYING: SEE TABLE  
COLOR: SEE TABLE

INSULATOR: TEFLON

RETENTION SPECIFICATION:  
THE FAKRA CONNECTOR WILL WITHSTAND  
A LONGITUDINAL FORCE OF 110 N(24.75 LBS)

FAKRA  
CONNECTOR  
KEYING  
CODE D

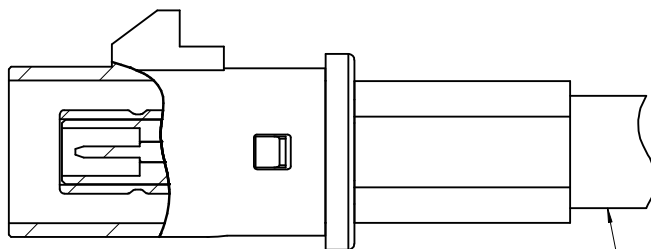

RG58 CABLE

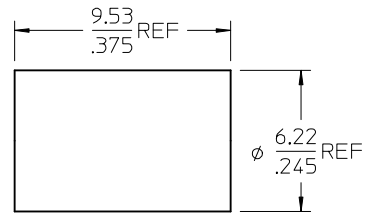
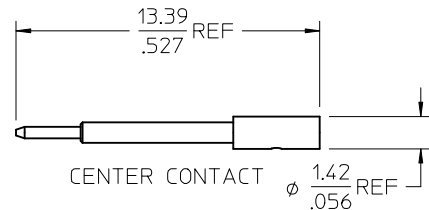
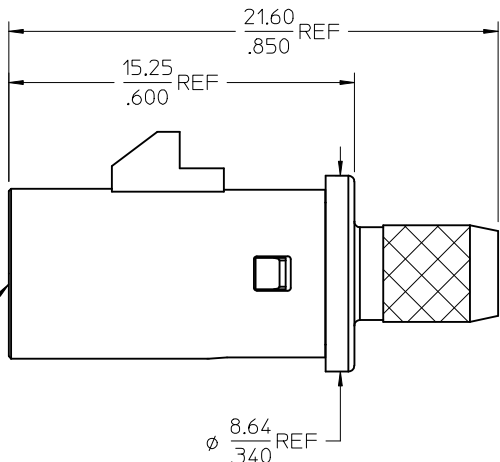
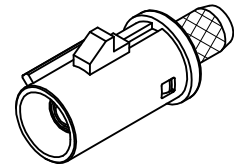

CRIMP TUBE

AS-89678-750	ASSEMBLY INSTRUCTIONS
MIL-STD-348A, FIG. 311.1	INTERFACE
SPECIFICATION	DESCRIPTION

CHG: REDREW IN SD  
CHANGED ALL DIMS  
FROM IN/MM TO MM/IN  
ADDED P/N  
73404-0581 THRU  
-0583  
ADDED RIGHT VIEW  
TO SHEET 1  
ADDED SHEET 2  
AND 3

EC NO: URF2007-0200  
DRAWN BY: DRWIN/ELAHERTY 2006/11/10  
CHKD: SSHAH 2006/11/10  
APPR: WIENER 2006/11/10

QUALITY SYMBOLS  
  
 DESCRIPTION  
 REV

GENERAL TOLERANCES (UNLESS SPECIFIED)

	mm	INCH
4 PLACES	± .005	± .0005
3 PLACES	± .003	± .0003
2 PLACES	± .002	± .0002
1 PLACE	± .001	± .0001

ANGULAR ± 2 °

DRAFT WHERE APPLICABLE  
MUST REMAIN  
WITHIN DIMENSIONS

DIMENSION STYLE  
MM/IN

DRAWN BY: SSS DATE: 2001/07/20  
 CHECKED BY: TEF DATE: 2001/07/20  
 APPROVED BY: GMH DATE: 2001/07/20

MATERIAL NO.  
**SEE SHEET 3**

SIZE  
C

SCALE: METRIC

DESIGN UNITS: METRIC

THIRD ANGLE PROJECTION

TITLE: SMB JACK, STR, RG58, FAKRA, 50 OHMS SMB-JC

MOLEX INCORPORATED

DOCUMENT NO. SD-73404-057

SHEET NO. 1 OF 3

THIS DRAWING CONTAINS INFORMATION THAT IS PROPRIETARY TO MOLEX INCORPORATED AND SHOULD NOT BE USED WITHOUT WRITTEN PERMISSION

13 12 11 10 9 8 7 6 5 4 3 2 1

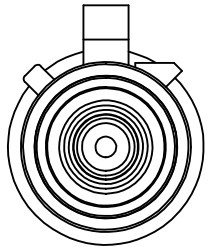

CODE - A

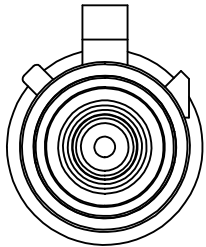

CODE - B

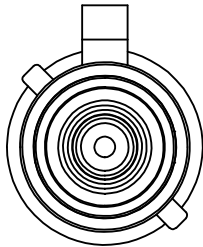

CODE - C

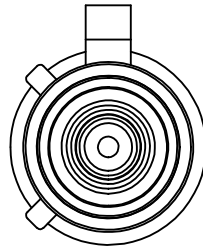

CODE - D

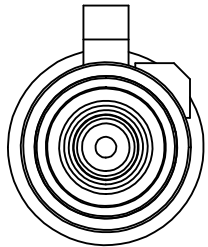

CODE - E

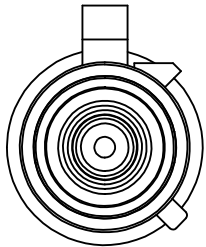

CODE - F

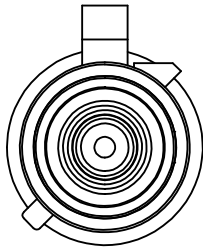

CODE - G

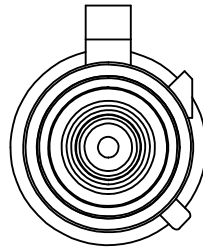

CODE - H

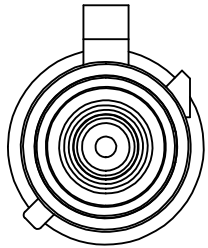

CODE - I

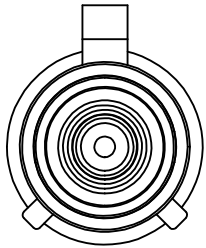

CODE - K

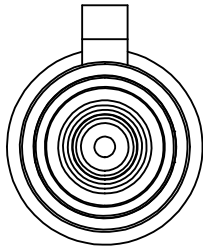

CODE - Z

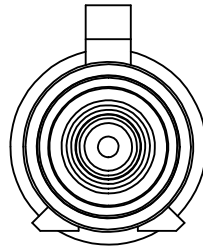

CODE - L

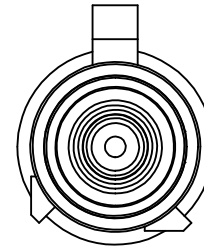

CODE - M

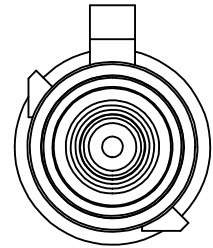

CODE - N

CHG: SEE SHEET 1	QUALITY SYMBOLS
EC NO: URF2007-0200	▽=0
DRWN:FLAHERTY 2006/11/10	▽=0
CHKD:SSHAH 2006/11/10	
APPR:JWIENER 2006/11/10	
REV	DESCRIPTION
A2	

GENERAL TOLERANCES (UNLESS SPECIFIED)	
	mm INCH
4 PLACES	± --- ± ---
3 PLACES	± --- ± ---
2 PLACES	± --- ± ---
1 PLACE	± --- ± ---
ANGULAR ± 2 °	
DRAFT WHERE APPLICABLE MUST REMAIN WITHIN DIMENSIONS	

DIMENSION STYLE	
MM/IN	
DRAWN BY	DATE
SSS	2001/07/20
CHECKED BY	DATE
TEF	2001/07/20
APPROVED BY	DATE
GMH	2001/07/20
MATERIAL NO.	
SEE SHEET 3	
SIZE	
C	

SCALE	DESIGN UNITS	THIRD ANGLE PROJECTION
	METRIC	
TITLE		
SMB JACK, STR, RG58, FAKRA, 50 OHMS SMB-JC		
MOLEX INCORPORATED		
DOCUMENT NO.	SHEET NO.	
SD-73404-057	2 OF 3	
THIS DRAWING CONTAINS INFORMATION THAT IS PROPRIETARY TO MOLEX INCORPORATED AND SHOULD NOT BE USED WITHOUT WRITTEN PERMISSION		

N	PASTEL GREEN	73404-0583
M	PASTEL ORANGE	73404-0582
L	CARMINE RED	73404-0581
Z	WATER BLUE	73404-0580
K	CURRY YELLOW	73404-0579
I	BEIGE	73404-0578
H	VIOLET	73404-0577
G	GRAY	73404-0576
F	BROWN	73404-0575
E	GREEN	73404-0574
D	BORDEAUXVIOLET	73404-0573
C	BLUE	73404-0572
B	CREAM WHITE	73404-0571
A	BLACK	73404-0570
KEYING CODE	COLOR	PART NO.

CHG: SEE SHEET 1 EC NO: URF2007-0200 DRWN: TELAHERTY 2006/11/10 CHKD: SSHAH 2006/11/10 APPR: JWIENER 2006/11/10	QUALITY SYMBOLS =0 =0	GENERAL TOLERANCES (UNLESS SPECIFIED)		DIMENSION STYLE MM/IN		SCALE	DESIGN UNITS METRIC	THIRD ANGLE PROJECTION	
		4 PLACES ± --- ± ---	DRAWN BY SSS	DATE 2001/07/20	TITLE SMB JACK, STR, RG58, FAKRA, 50 OHMS SMB-JC				
		3 PLACES ± --- ± ---	CHECKED BY TEF	DATE 2001/07/20	APPROVED BY GMH				
		2 PLACES ± --- ± ---	DATE 2001/07/20		MATERIAL NO. SEE TABLE				
1 PLACE ± --- ± ---	ANGULAR ± 2 °		DOCUMENT NO. SD-73404-057		SHEET NO. 3 OF 3				
DRAFT WHERE APPLICABLE MUST REMAIN WITHIN DIMENSIONS		SIZE 		THIS DRAWING CONTAINS INFORMATION THAT IS PROPRIETARY TO MOLEX INCORPORATED AND SHOULD NOT BE USED WITHOUT WRITTEN PERMISSION					