

4

3

2

1

© - TE Connectivity. All Rights Reserved.

REVISIONS				
P	LTR	DESCRIPTION	DATE	DWN APVD
	J	REVISED PER ECR-23-163311	09MAR2023	BB DSC

<b>AMP</b> WIRE RANGE	 Listed FILE E13288
12-10 AWG SOLID OR STRANDED	12 AWG STRANDED

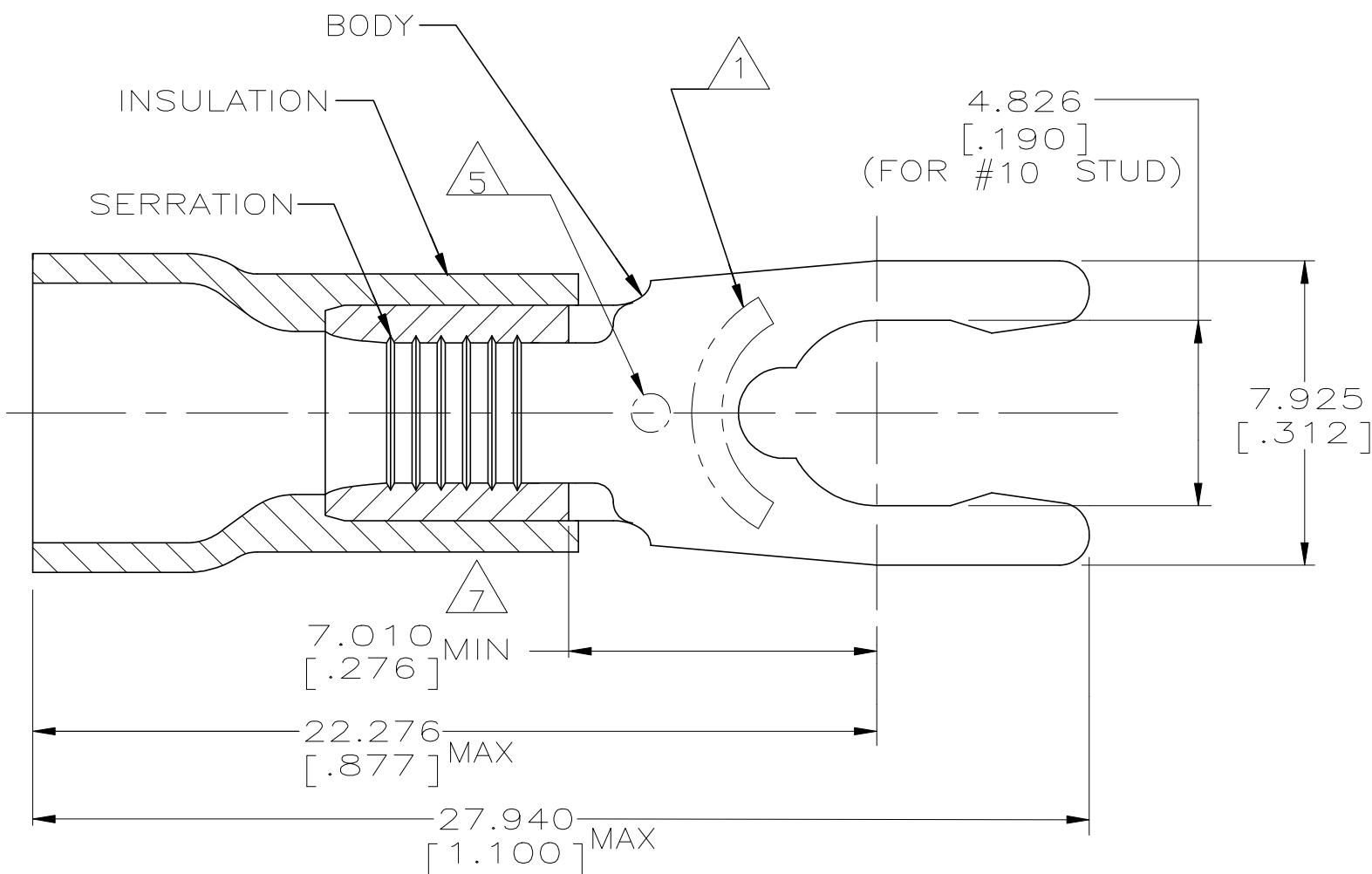

- ① STAMP 10S AMP 12-10\* APPROX AS SHOWN
- 2. WIRE INSULATION DIAMETER  $\phi 3.810 [.150]$  TO  $\phi 6.350 [.250]$
- 3. BODY MATERIAL THK:  $1.016 \pm 0.051 [.040 \pm .002]$
- ④ MATERIAL: BODY - BRASS PER ASTM B36  
INSULATION - PVC
- ⑤ DIMPLE STAMP MARK OPTIONAL
- ⑥ FINISH:  
BODY - TIN PLATE  $0.00254 [.000100]$   
MIN EXT THK PER ASTM B545  
INSULATION COLOR - YELLOW
- ⑦ APPLIES FROM EDGE OF METAL WIRE BARREL TO CENTER OF STUD HOLE

2500	ON TAPE, REEL	53248-2
500	LOOSE PIECE	53248-1
QTY	PACKAGE TYPE	PART NO

**AMP INCORPORATED**  
**CUSTOMER SERVICE SYSTEMS**

FOR ADDITIONAL PRODUCT INFORMATION OR COPIES OF DRAWINGS AND TECHNICAL DOCUMENTS  
PRODUCT INFORMATION CENTER  
1-800-522-6752

FOR APPLICATION TOOLING INFORMATION  
TOOLING ASSISTANCE CENTER  
1-800-722-1111

FOR ORDER ENTRY  
1-800-526-5142

MAX RECOMMENDED OPERATING TEMPERATURE:  
105°C [221°F]

VOLTAGE RATING:  
600V MAX  
(1000V FIXTURE OR SIGN)

CIRCULAR MIL AREA:  
 $2.62-6.64 \text{mm}^2 [5,180-13,100]$   
SOLID OR STRANDED

THIS DRAWING IS A CONTROLLED DOCUMENT.

DIMENSIONS: mm [INCHES]

TOLERANCES UNLESS OTHERWISE SPECIFIED:

0 PLC	± -
1 PLC	± -
2 PLC	± -
3 PLC	± 0.127 [.005]
4 PLC	± -
ANGLES	± -

MATERIAL ④ FINISH ⑥

DWN L OLMEDA 26JUN95  
CHK M ELLIS 26JUN95  
APVD G NGO 26JUN95

NAME: **TE Connectivity**

PRODUCT SPEC: **UL 486A-B**

APPLICATION SPEC: **114-2161**

WEIGHT: -

SIZE: A3 CAGE CODE: 00779 DRAWING NO: C=53248 RESTRICTED TO: -

CUSTOMER DRAWING SCALE: 6:1 SHEET: 1 OF 1 REV: J