

DWG. NO. SD 87531-0001
 CAD FILE S875310.DGN

DO NOT SCALE DRAWING

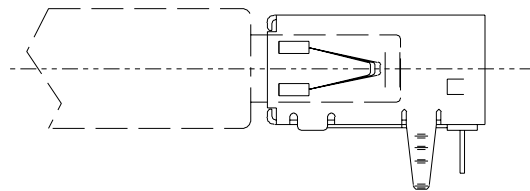

NOTES
 1. MATERIAL
 CONTACTS - PHOSPHOR BRONZE
 SHELL - COPPER ALLOY OR EQUIVALENT
 HOUSING - HIGH TEMP THERMOPLASTIC, NYLON
 94V-0, COLOUR: WHITE
 2. PLATING
 CONTACTS -
 GOLD FLASH OVER 0.76 μ m MIN PALLADIUM NICKEL
 IN MATING AREA, 2.50 μ m MIN TIN-LEAD ON
 SOLDER TAILS ALL OVER 1.27 μ m MIN NICKEL
 SHELL -
 2.50 μ m MIN TIN-LEAD OVER 1.25 μ m MIN NICKEL
 3. FOR PCB THICKNESS OF 1.60mm.
 APPROXIMATE AREA FOR PICK & PLACE NOZZLE

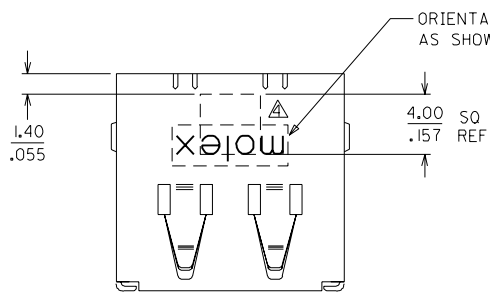
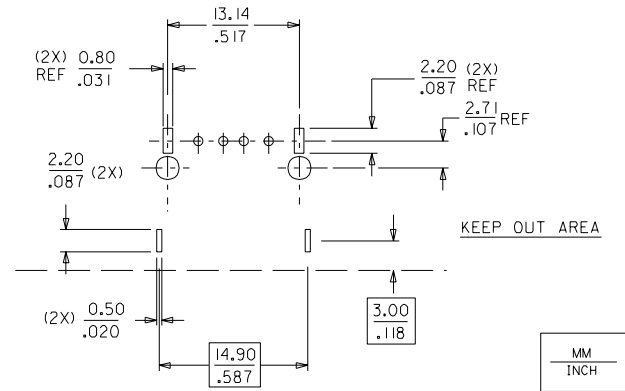
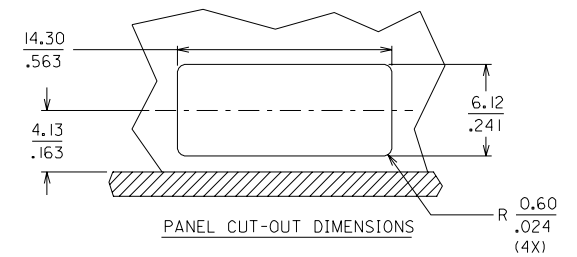
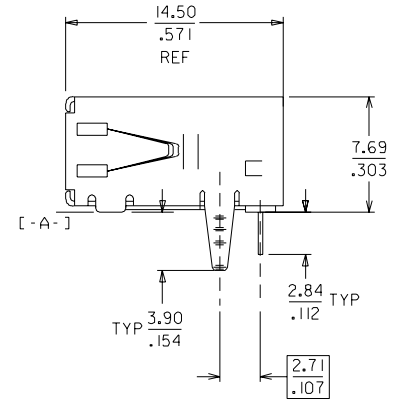
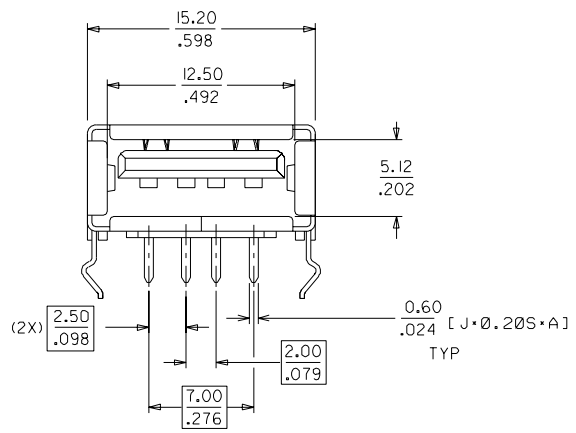

RECOMMENDED PCB LAYOUT

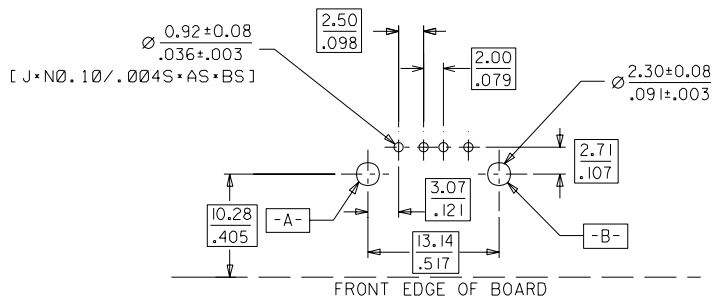

A5	ADD LOGO PER ECN S99-0224	-	LINE	981217	MATERIAL :	SEE NOTES ABOVE
A4	REVISED PER ECN S1998-0113	-	LINE	970916		
A3	UPDATE DRAWING	S70266	LINE	961216		FINISH :
A2	REMOVE PLATING OPTIONS	S70194	LINE	961016		
A1	CHG. SHELL PLTG. THICKNESS	S60573	LINE	960612		GENERAL TOLERANCES \pm 0.20/.008 DWG. NO.: SD 87531-0001 TITLE : UNIVERSAL SERIAL BUS SINGLE RIGHT ANGLE RECEPT.,
A	ADD PLATING OPTIONS	S60506	LINE	960424		
3	ADD PICK & PLACE AREA	S60433	POP	960313		
2	ADD KEEP OUT AREA	S60370	POP	960123		
1	PROPOSAL	S60302	POP	951208		
LTR	REVISION RECORD	ECN	DR	DATE	DRAWN BY ER POH 951208	CHK'D BY SK TOH 960109
REVISE ONLY ON CAD SYSTEM					APPR'D BY ROY 960109	SCALE 3 : 1

MOLEX SINGAPORE PTE LTD
 SHEET 1 OF 1