

THIS DRAWING IS UNPUBLISHED. RELEASED FOR PUBLICATION. ALL RIGHTS RESERVED.  
 © COPYRIGHT BY TYCO ELECTRONICS CORPORATION.

LOC	DIST	REVISIONS			
P	LTN	DESCRIPTION	DATE	DMN	APVD
BD	37	M	063B-0397-03	12MAY03	TK GS

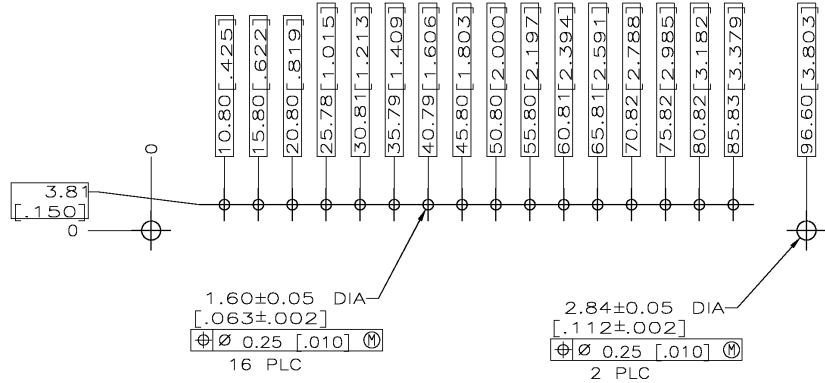

RECOMMENDED PC BOARD LAYOUT

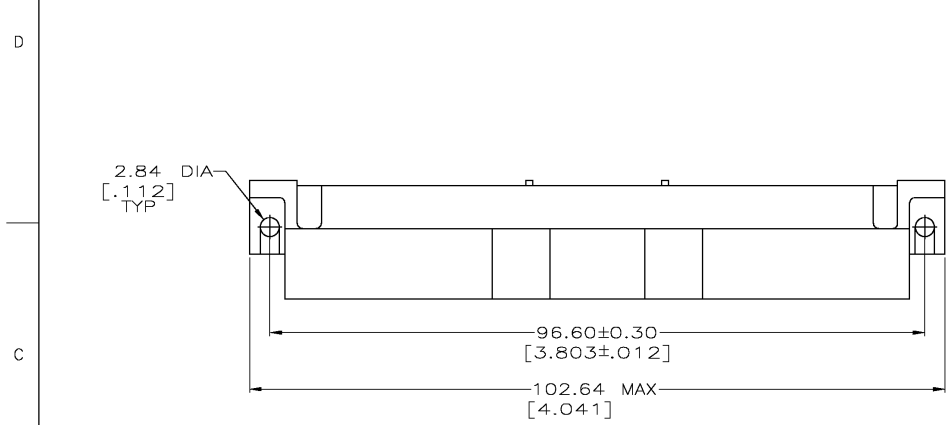
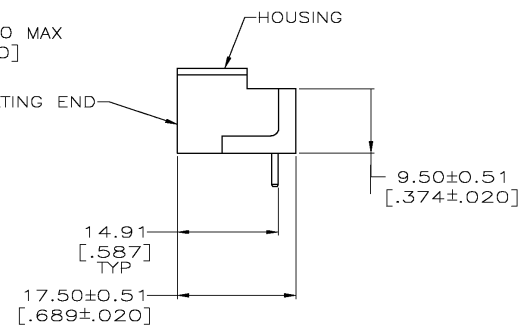
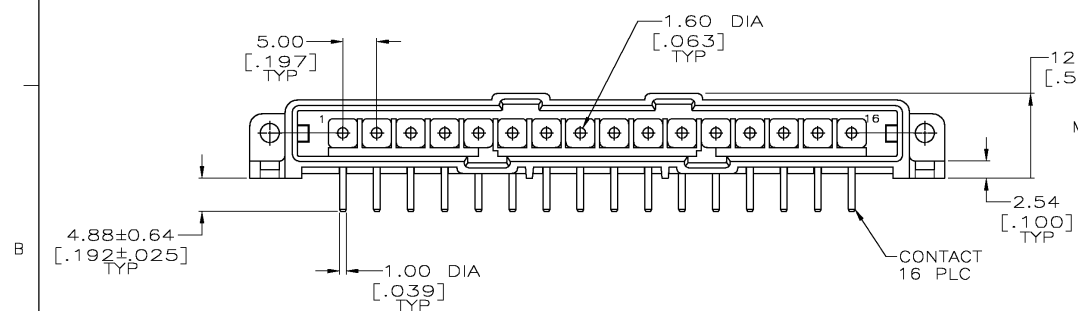

- △ NYLON, RED, VYDYNE M-345 FR.
- △ BRASS PER ASTM B36.
- △ 3.81µm [.000150] MIN TIN-LEAD OVER 2.54µm [.000100] MIN COPPER OR 1.27µm [.000050] MIN NICKEL.
- △ 0.76µm [.000030] MIN GOLD FOR A LENGTH OF 5.08 [.200] MIN FROM MATING END, 3.81µm [.000150] MIN TIN-LEAD FOR A LENGTH OF 13.08 [.515] MIN FROM OPPOSITE END, BOTH OVER 1.27µm [.000050] MIN NICKEL.
- △ 0.76µm [.000030] MIN GOLD FOR A LENGTH OF 5.08 [.200] MIN FROM MATING END, 3.81µm [.000150] MIN TIN FOR A LENGTH OF 13.08 [.515] MIN FROM OPPOSITE END, BOTH OVER 1.27µm [.000050] MIN NICKEL.
- △ .000150 MIN LEAD FREE TIN OVER .000100 MIN COPPER, OR .000050 MIN NICKEL.

OBSOLETE	6	207544-8
	5	207544-7
	-	207544-6
	4	207544-3
	3	207544-1
FINISH		PART NO

THIS DRAWING IS A CONTROLLED DOCUMENT.		DMN L SIPE 07/01/92	<b>Tyco Electronics</b> Tyco Electronics Corporation Harrisburg, Pa																	
DIMENSIONS: INCHES		DRW R STONE 7-8-92																		
TOLERANCES UNLESS OTHERWISE SPECIFIED:		APVD A TRAVIS 7-8-92	NAME A TRAVIS																	
<table border="0"> <tr><td>0 PLC</td><td>±</td><td>-</td></tr> <tr><td>1 PLC</td><td>±</td><td>-</td></tr> <tr><td>2 PLC</td><td>±</td><td>0.25 [010]</td></tr> <tr><td>3 PLC</td><td>±</td><td>-</td></tr> <tr><td>4 PLC</td><td>±</td><td>-</td></tr> <tr><td>ANGLES</td><td>±</td><td>-</td></tr> </table>		0 PLC		±	-	1 PLC	±	-	2 PLC	±	0.25 [010]	3 PLC	±	-	4 PLC	±	-	ANGLES	±	-
0 PLC	±	-																		
1 PLC	±	-																		
2 PLC	±	0.25 [010]																		
3 PLC	±	-																		
4 PLC	±	-																		
ANGLES	±	-																		
MATERIAL HOUSING: 1	FINISH CONTACTS: SEE TBL	WEIGHT -	SIZE A2																	
CUSTOMER DRAWING		SCALE 2:1	RESTRICTED TO -																	