

LOC		DIST		REVISIONS					
DW				P	LTR	DESCRIPTION	DATE	DWN	APVD
				F		OBSOLETE	08JAN16	H.X	W.H

NOTES:

- MATERIAL:
 HOUSING: LCP WITH 30% GF, UL94 V-0, NATURAL COLOR.
 ACTUATOR: LCP WITH 40% GF, UL94 V-0, BLACK COLOR.
 CONTACTS: PHOSPHOR BRONZE.
 PEGS: BRASS.
- FINISH:
 CONTACTS: 0.0762µm [3µ"] MIN. GOLD PLATED ON CONTACT AREA, GOLD FLASH ON SOLDER TAIL, WITH ENTIRE CONTACT UNDERPLATED 1.27µm [50µ"] MIN. NICKEL.
 PEGS: 2.54µm [100µ"] MIN. MATTE-TIN OVER 1.27µm [50µ"] MIN. NICKEL.
- REFLOW SOLDER CAPABLE TO 260°C PER TEC-109-201, CONDITION B.
- SUBSTANCE RESTRICTIONS FOR LOW HALOGEN (BY WEIGHT):
 - BROMINE (Br) ≤ 900 PPM (0.09%)
 - CHLORINE (Cl) ≤ 900 PPM (0.09%)
 - TOTAL CONCENTRATION OF CHLORINE (Cl) + BROMINE (Br) ≤ 1500 PPM (0.15%)

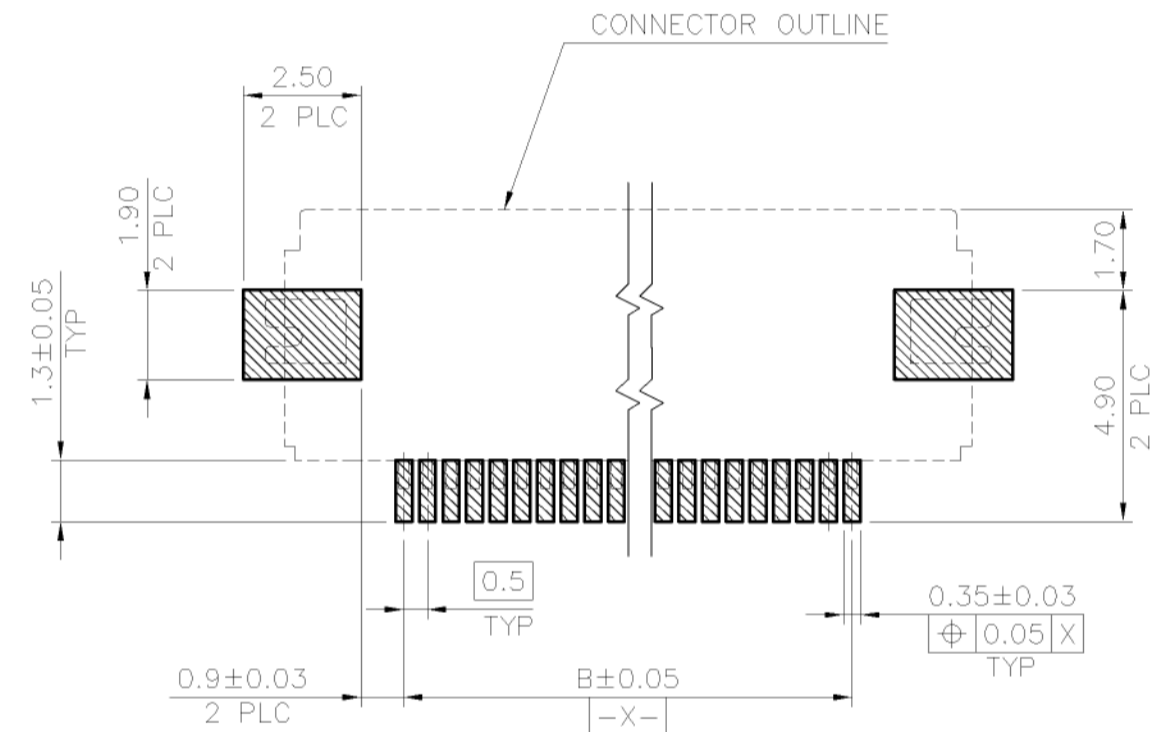
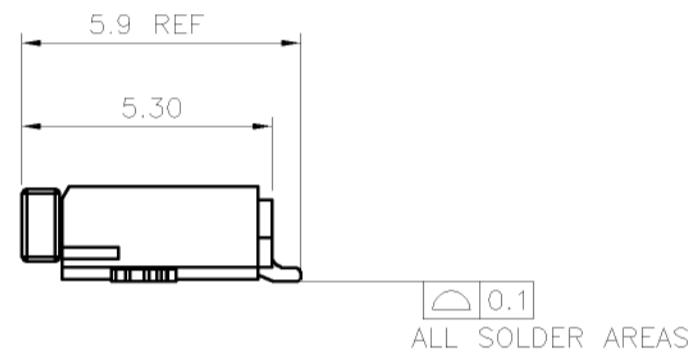
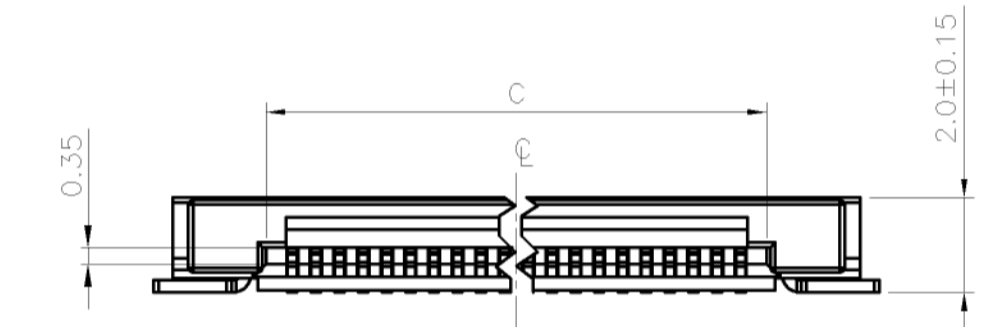
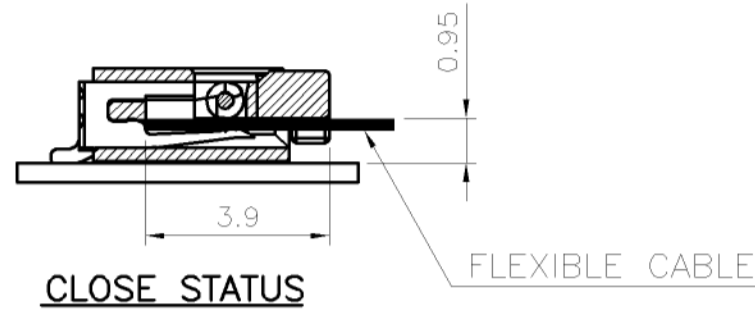
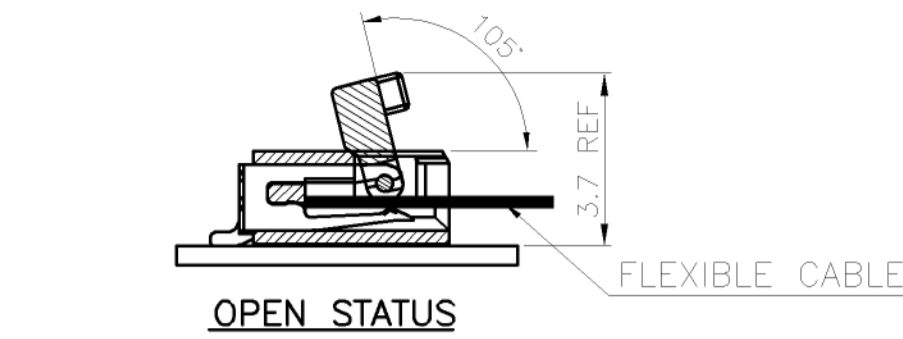
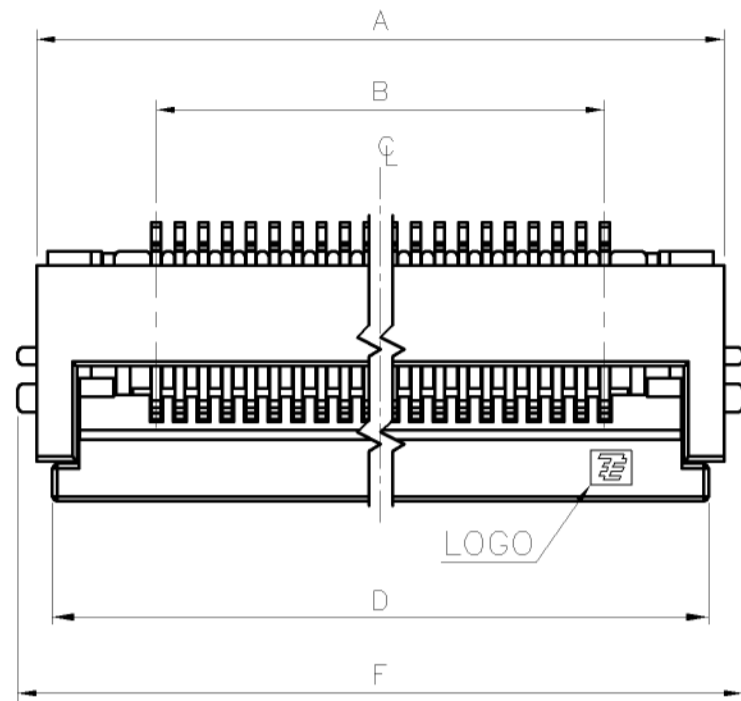

TOLERANCE: ±0.08
 RECOMMENDED P.C.B. LAYOUT
 (TOP VIEW)

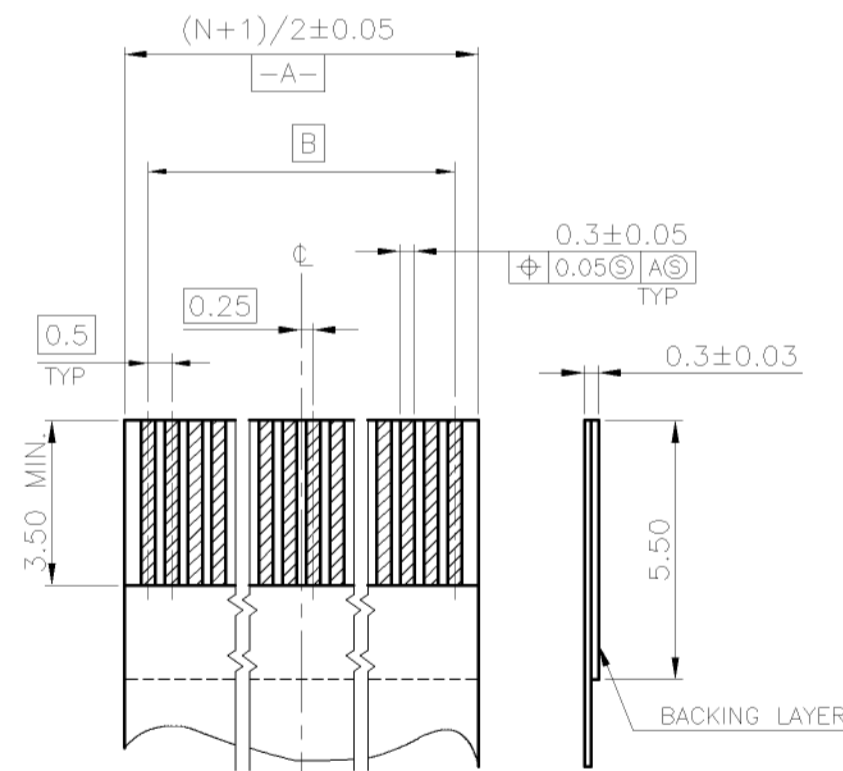
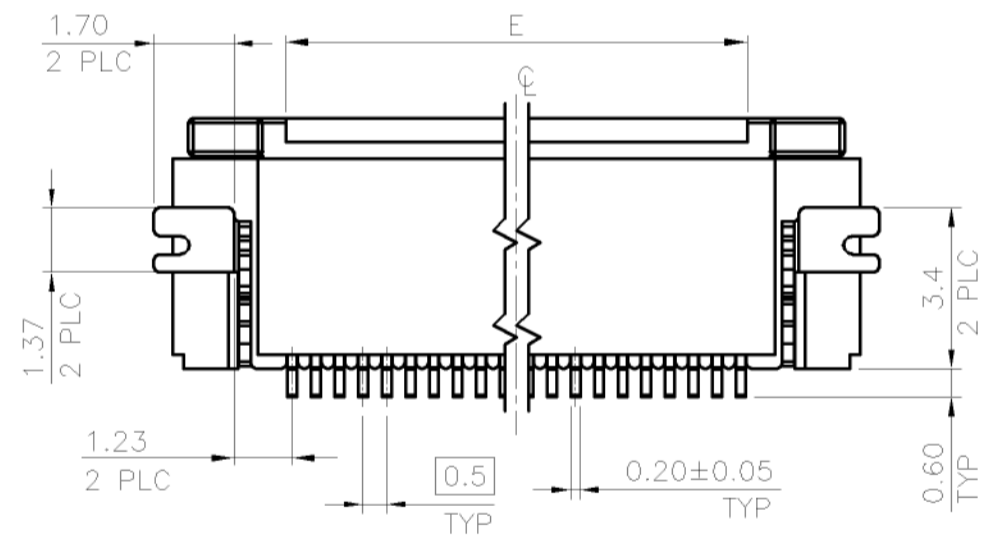

(N = NO. OF CONTACTS)
 RECOMMENDED FPC/FFC LAYOUT

OBSOLETE

20.37	14.78	18.91	15.60	14.50	19.57	30	3-2041070-0
18.37	12.78	16.91	13.60	12.50	17.57	26	2-2041070-6
15.37	9.78	13.91	10.60	9.50	14.57	20	2-2041070-0
14.37	8.78	12.91	9.60	8.50	13.57	18	1-2041070-8
13.37	7.78	11.91	8.60	7.50	12.57	16	1-2041070-6
11.37	5.78	9.91	6.60	5.50	10.57	12	1-2041070-2
10.37	4.78	8.91	5.60	4.50	9.57	10	1-2041070-0
9.37	3.78	7.91	4.60	3.50	8.57	8	2041070-8
8.37	2.78	6.91	3.60	2.50	7.57	6	2041070-6
7.37	1.78	5.91	2.60	1.50	6.57	4	2041070-4
F	E	D	C	B	A	NO. OF CONTACTS	PART NUMBER

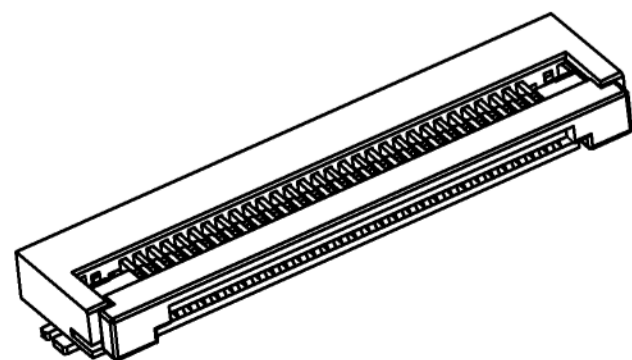
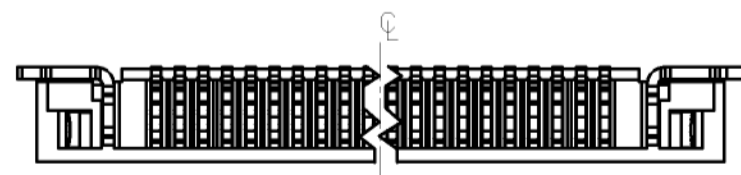

THIS DRAWING IS A CONTROLLED DOCUMENT.

DIMENSIONS: MM	TOLERANCES UNLESS OTHERWISE SPECIFIED:	DWN: A. WU 13JUN2008	APVD: W. KODAMA 13JUN2008	Tyco Electronics Corporation Taipi, Taiwan	
0 PLC ± -	1 PLC ± 0.3	CHK: S. CHIEN 13JUN2008	NAME: 108-57364	FPC CONNECTOR, 0.5 PITCH, 105° ZIF, BOTTOM CONTACT	
2 PLC ± 0.2	3 PLC ± -	APVD: W. KODAMA 13JUN2008	PRODUCT SPEC: 108-57364	SIZE: A2	CAGE CODE: 00779
4 PLC ± -	ANGLES ± 3°	MATERIAL: SEE NOTE	APPLICATION SPEC: -	DRAWING NO: C=2041070	RESTRICTED TO: -
FINISH: SEE NOTE	FINISH: SEE NOTE	WEIGHT: -	CUSTOMER DRAWING	SCALE: -	SHEET: 1 of 2

THIS DRAWING IS UNPUBLISHED. RELEASED FOR PUBLICATION
 © COPYRIGHT 2010 BY TYCO ELECTRONICS CORPORATION. ALL RIGHTS RESERVED.

LOC	DIST	REVISIONS			
P	LTR	DESCRIPTION	DATE	DWN	APVD
DW	-	SEE SHEET 1.			

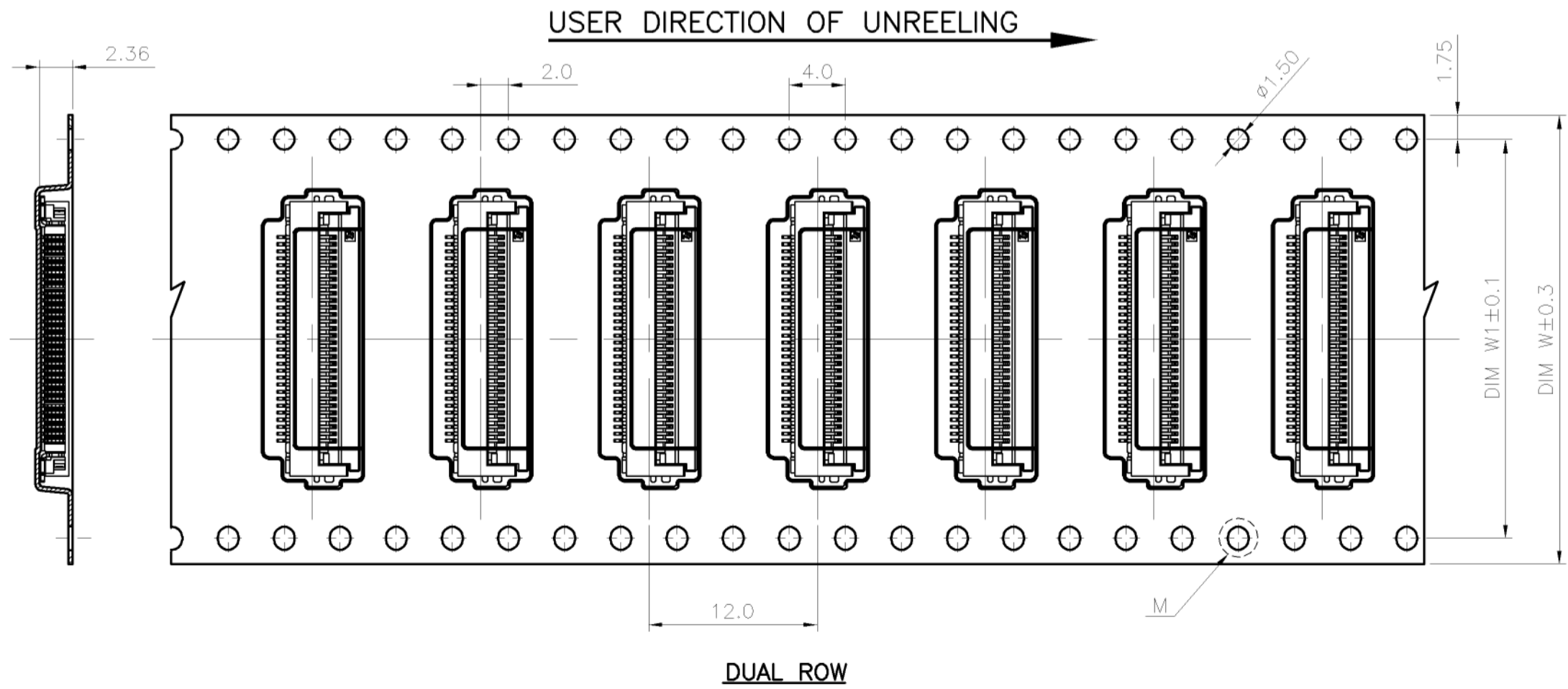
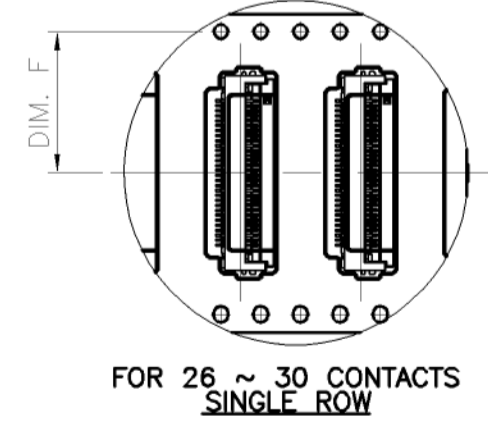
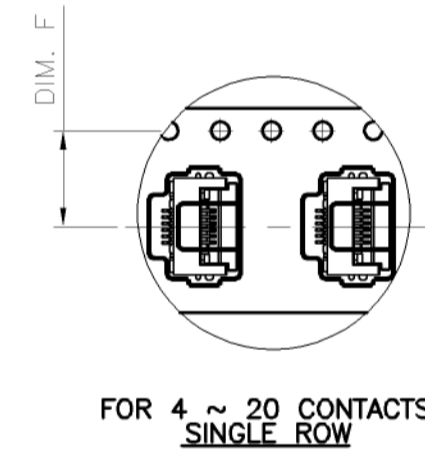
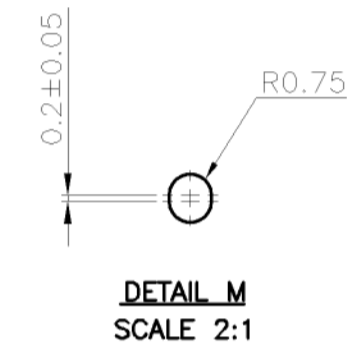
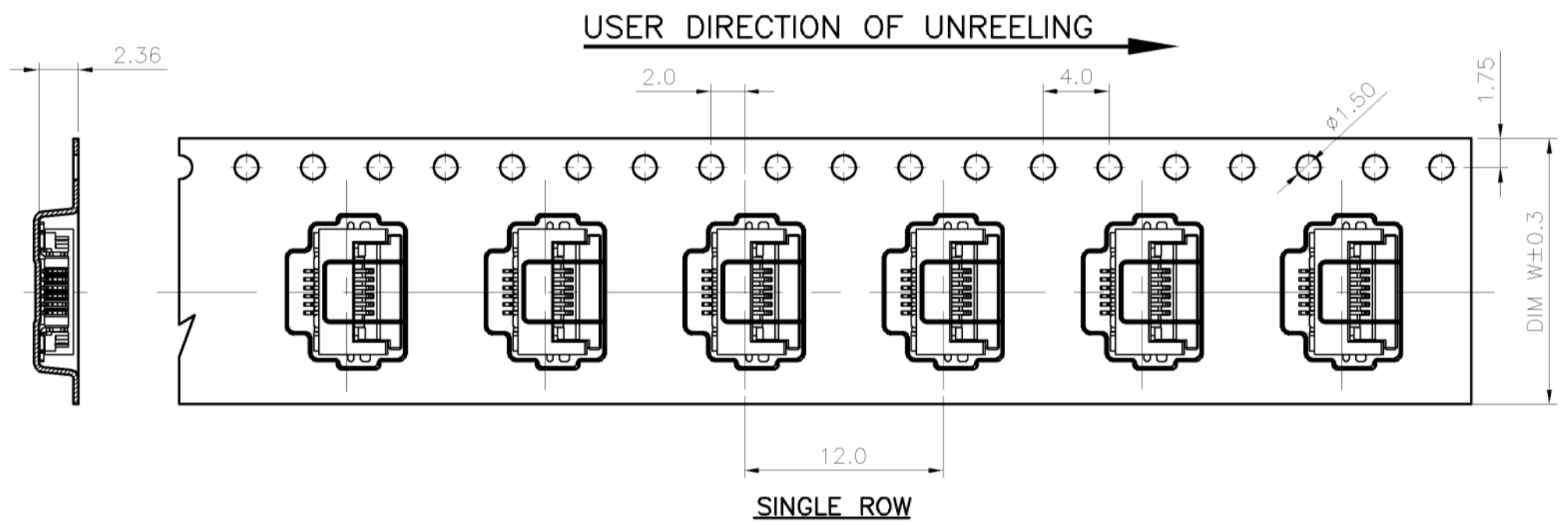
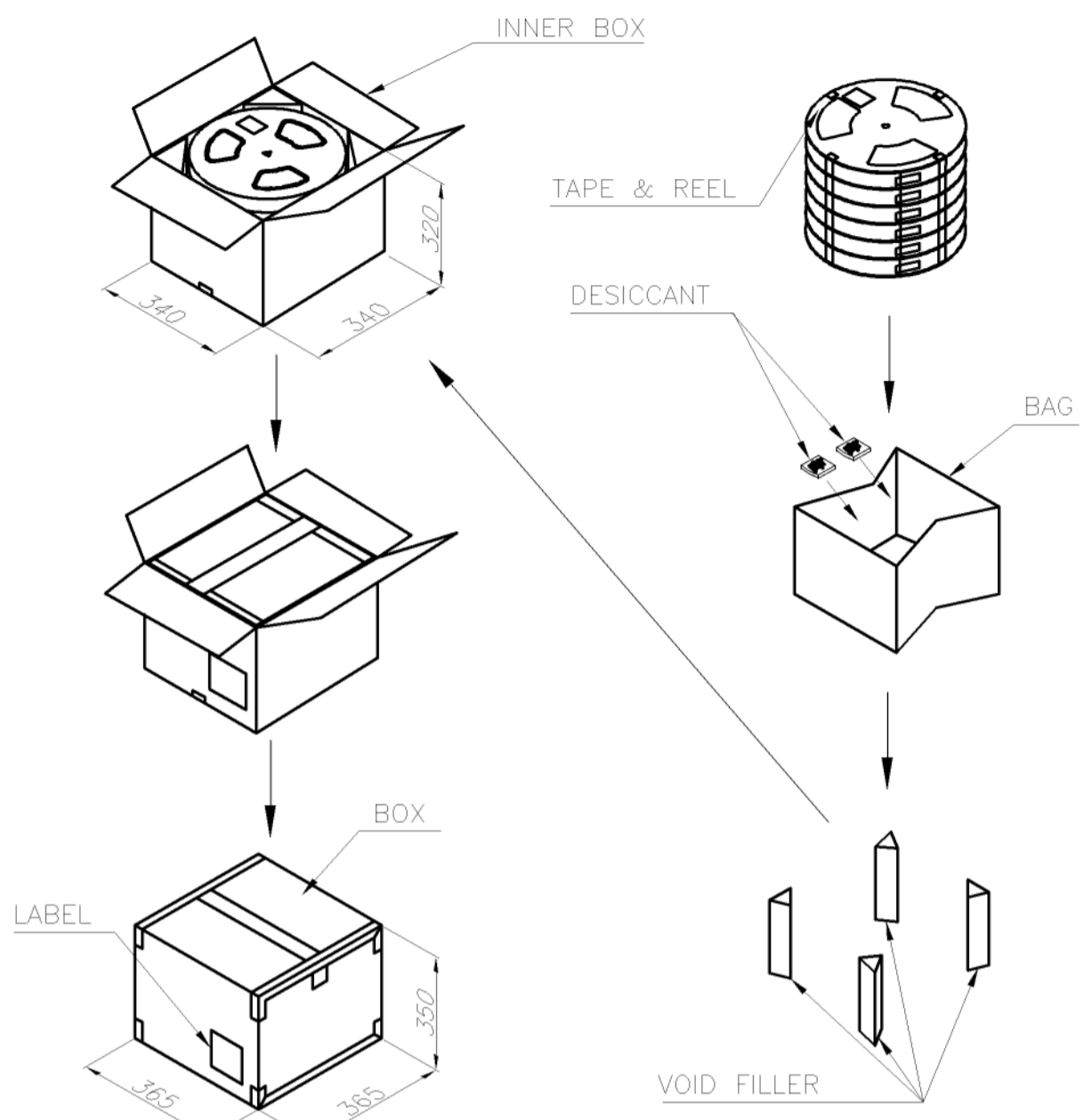
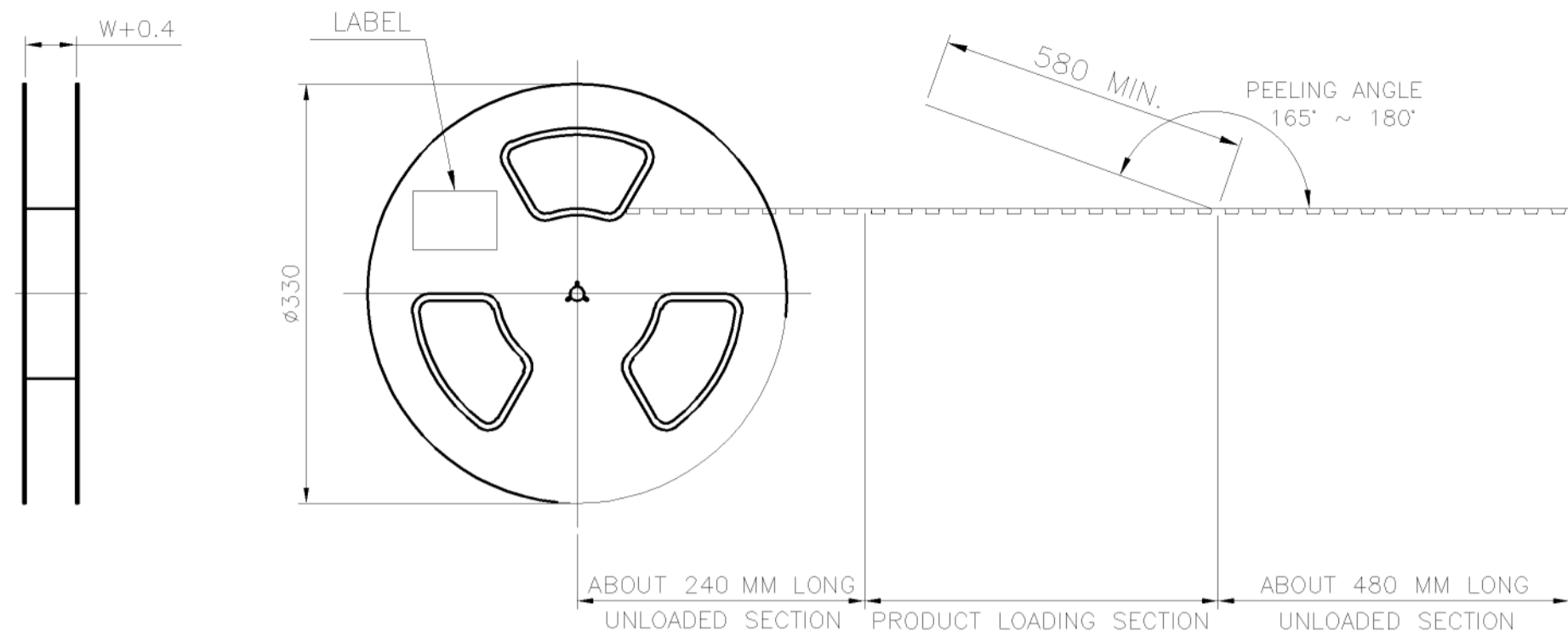

QUANTITY	PCS/TAPE	REELS/BOX	DIM W1	DIM F	DIM W	G/W(Kg)	N/W(Kg)	NO. OF CONTACTS
16000 PCS	2000	8	28.4	14.2	32	12.85	5.80	30
						11.75	5.14	26
						11.62	5.40	20
20000 PCS	2000	10	11.5	24	11.50	5.00	18	
					11.35	4.52	16	
					10.75	3.76	12	
26000 PCS	2000	13	7.50	16	10.45	3.50	10	
					10.35	3.49	8	
					10.25	3.48	6	
						10.18	3.05	4

THIS DRAWING IS A CONTROLLED DOCUMENT.

DWN	A. WU	13JUN2008	 Tyco Electronics Corporation Taipei, Taiwan
CHK	S. CHIEN	13JUN2008	
APVD	W. KODAMA	13JUN2008	
PRODUCT SPEC			
APPLICATION SPEC			NAME
WEIGHT			SIZE
CUSTOMER DRAWING			CAGE CODE
			DRAWING NO
			RESTRICTED TO

FPC CONNECTOR, 0.5 PITCH, 105° ZIF, BOTTOM CONTACT

SCALE: A2 00779 C=2041070 SHEET 2 OF 2 REV F