

10 9 8 7 6 5 4 3 2 1

PLATING OPTION	ASSEMBLY PART NO.	CKT SIZE	A	B	C	D	VOID PIN
TIN/LEAD	70246-3480	34	1.600/40.64	1.880/47.75	2.000/50.80	1.900/48.26	5
TIN	70246-3485	34	1.600/40.64	1.880/47.75	2.000/50.80	1.900/48.26	5

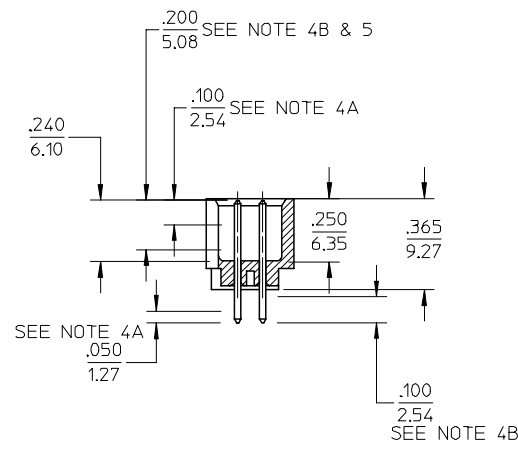

SECTION E-E

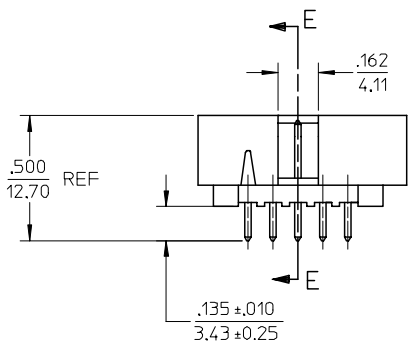
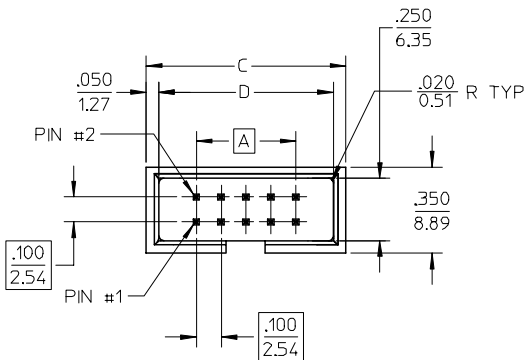
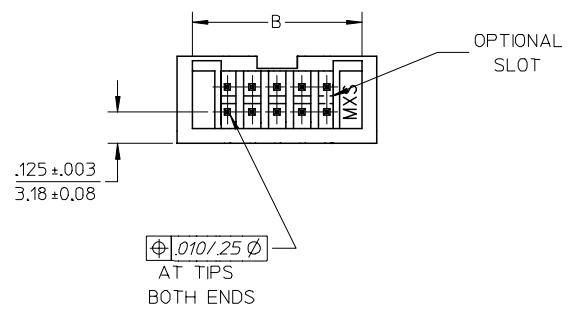

NOTES:

1. MATERIAL : PINS .025 SQUARE. WAFER 15% G.F. PBT
2. PIN PUSHOUT FORCE (9.072KG)/2LBS MIN.
3. PRODUCT SPEC: PS-70246 APPLIES.
4. WAFER TO BE FLAT WITHIN (0.03MM/CM) 0.003IN/IN
5. DIMENSIONS FOR PLATING LOCATION : A-MEASURE POINT FOR THICKNESS. B-MINIMUM COVERAGE
6. GOLD END OF PIN UNLESS OVERALL PLATED.
7. FINISH : (ALL WITH 50uIN MIN NICKEL UNDERPLATE OVERALL.) 15uIN MIN AU & 75uIN TIN OR TIN/LEAD IN SELECTED AREAS.

ADD ASSY P/N FOR LF EC NO: S2005-0480 DRAWN:SEE CHKD:PTLIM APPR:SKTOH	2004/12/15 2004/12/15 2004/12/17	DESCRIPTION REV	QUALITY SYMBOLS	GENERAL TOLERANCES (UNLESS SPECIFIED)	DIMENSION STYLE	SCALE	DESIGN UNITS	THIRD ANGLE PROJECTION															
			$\nabla = 0$ $\sphericalangle = 0$	<table border="1"> <tr> <th></th> <th>mm</th> <th>INCH</th> </tr> <tr> <td>4 PLACES</td> <td>± ---</td> <td>± ---</td> </tr> <tr> <td>3 PLACES</td> <td>± ---</td> <td>± .008</td> </tr> <tr> <td>2 PLACES</td> <td>± 0.20</td> <td>± ---</td> </tr> <tr> <td>1 PLACE</td> <td>± ---</td> <td>± ---</td> </tr> </table>		mm	INCH	4 PLACES	± ---	± ---	3 PLACES	± ---	± .008	2 PLACES	± 0.20	± ---	1 PLACE	± ---	± ---	IN/MM	NTS	METRIC	\odot \square
				mm	INCH																		
			4 PLACES	± ---	± ---																		
3 PLACES	± ---	± .008																					
2 PLACES	± 0.20	± ---																					
1 PLACE	± ---	± ---																					
	ANGULAR ± 3 °	DRAWN BY DATE	TITLE																				
	DRAFT WHERE APPLICABLE MUST REMAIN WITHIN DIMENSIONS	KCL ING 1992/12/07	C-GRID SHROUDED HEADER W/ VOID OPTION (SLOTTED W/O STANDOFFS)																				
		CHCKD:PTLIM 2004/12/15	MOLEX INCORPORATED																				
		APPR:SKTOH 2004/12/17	SD-70246-3480																				
			SEE TABLE																				
			THIS DRAWING CONTAINS INFORMATION THAT IS PROPRIETARY TO MOLEX INCORPORATED AND SHOULD NOT BE USED WITHOUT WRITTEN PERMISSION																				

9 8 7 6 5 4 3 2 1