

LC ADAPTER ASSY. P/N	COLOR	LC SLEEVE MATERIAL
86126-1300	BLUE	Zr
86126-1310*		
86126-0310	BEIGE	Ph. Bronze
86126-0320*		
86126-1350	GREEN	Zr
86126-1330	BEIGE	Zr
86126-1340	BLACK	Zr

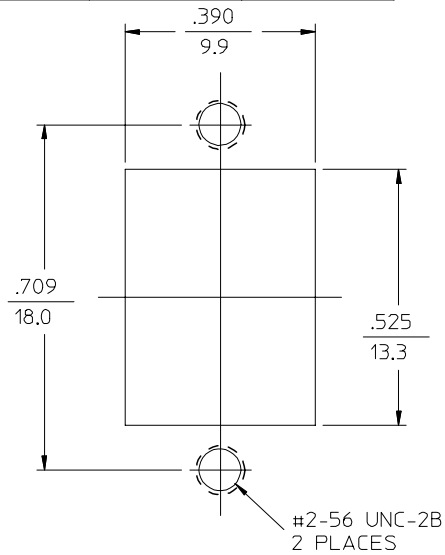

RECOMMENDED MOUNTING CUTOUT FOR $\frac{.063}{1.6}$ THICK PANEL

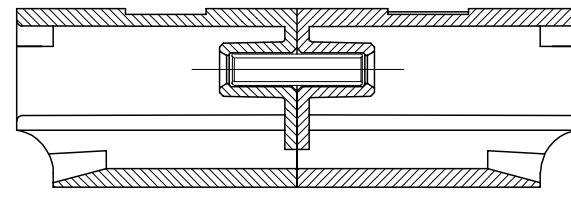
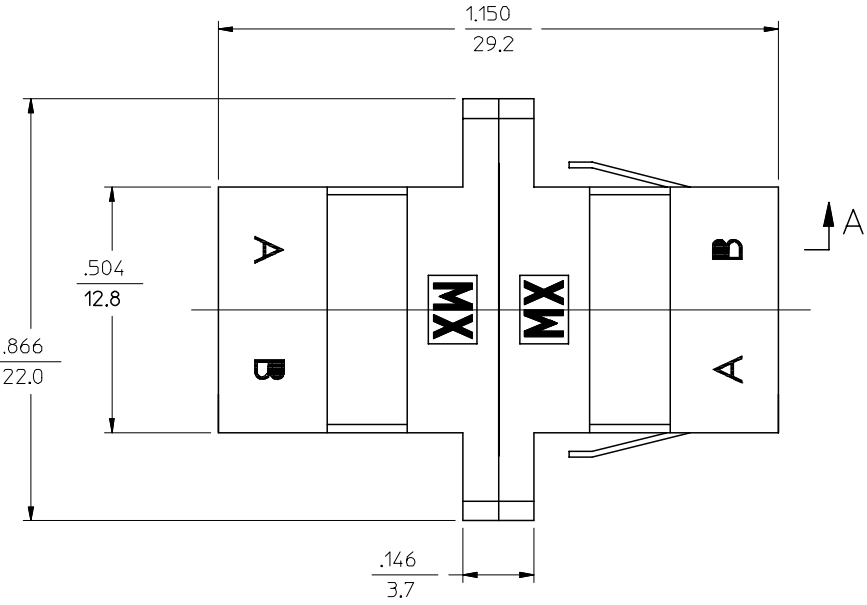
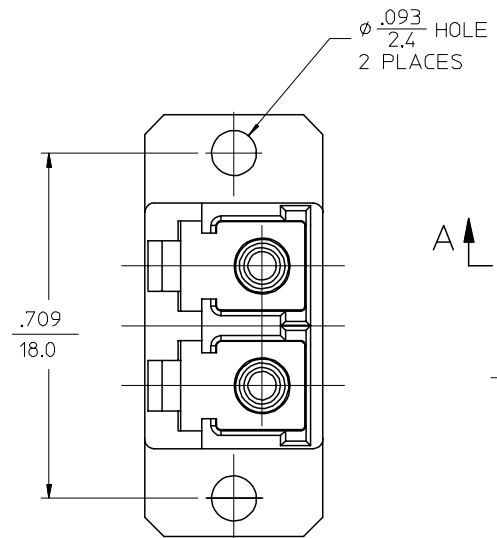

SECTION A-A

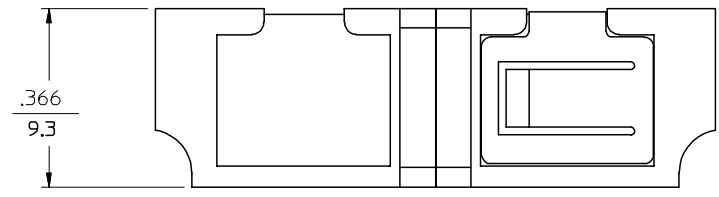

- NOTES:
- ALL DIMENSIONS ARE FOR REFERENCE ONLY.
 - ALL DIMENSIONS ARE GIVEN IN $\frac{\text{INCHES}}{\text{mm}}$.
 - ASSEMBLED DUST CAP NOT SHOWN.
 - P/N 86126-0320 AND P/N 86126-1310 ARE BULK PACKED.

ENTER DESCRIPTION	QUALITY SYMBOLS
EC NO: MF2005-0347	▽=0
DRWN: KATARZI 2004/12/07	▽=0
CHKD: 2004/12/07	
APPR: GUMIN 2004/12/07	
REV	DESCRIPTION

GENERAL TOLERANCES (UNLESS SPECIFIED)	
	INCH
4 PLACES	± .005
3 PLACES	± .004
2 PLACES	± .003
1 PLACE	± .002
ANGULAR ±1/2°	
DRAFT WHERE APPLICABLE MUST REMAIN WITHIN DIMENSIONS	

DIMENSION STYLE	
IN/MM	
DRAWN BY	DATE
BKIM	11/24/99
CHECKED BY	DATE
APPROVED BY	DATE
SMIGO	12/20/99
MATERIAL NO.	DOCUMENT NO.
SEE TABLE	86126-X3X0CD
SIZE	
B	

SCALE	DESIGN UNITS	THIRD ANGLE PROJECTION
4:1	INCH	
TITLE		
LC DUPLEX ADAPTER (STANDARD FLANGE/ SC FOOT PRINT)		
MATERIAL NO. DOCUMENT NO.		
SEE TABLE 86126-X3X0CD		
SHEET NO.		
1 OF 1		