

GSTP0220S thru GSTP0240S

Surface Mount Schottky Rectifier
 Reverse Voltage 20-40V Forward Current 2A

Features

- Low profile - typical height of 0.65 mm
- Moisture sensitivity: level 1, per J-STD-020
- Low forward voltage drop
- High temperature soldering guaranteed: 260°C/10 seconds



Package: iSGP
(SOD-323HS)



RoHS
COMPLIANT

Maximum Ratings (T_A = 25°C unless otherwise noted)

Parameter	Symbol	GSTP0220S	GSTP0230S	GSTP0240S	Unit
Maximum Repetitive Peak Reverse Voltage	V _{RRM}	20	30	40	V
Maximum RMS Voltage	V _{RMS}	14	21	28	V
Maximum DC Blocking Voltage	V _{DC}	20	30	40	V
Maximum Average Forward Rectified Current	I _{F(AV)}	2.0			A
Peak Forward Surge Current (8.3 ms single half sine-wave superimposed on rated load)	I _{FSM}	30			A
Operating Junction Temperature Range	T _J	- 55 to + 150			°C
Storage Temperature Range	T _{STG}	- 55 to + 150			°C

Electrical Characteristics (T_A = 25°C unless otherwise noted)

Parameter	Symbol	Test Conditions	Value	Unit
Maximum Instantaneous Forward Voltage	V _F	I _F =2A, T _A =125°C	0.60	V
Maximum DC Reverse Current at Rated DC Blocking Voltage	I _R	T _A =25°C	250	μA

GSTP0220S thru GSTP0240S

Surface Mount Schottky Rectifier
 Reverse Voltage 20-40V Forward Current 2A

Package Outline Dimensions

iSGP (SOD-323HS)

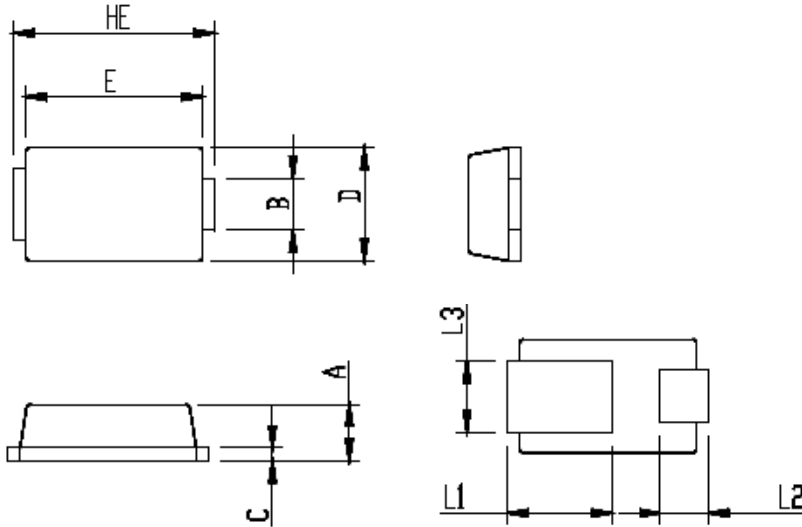

Package	Unit:mm	
	MIN	MAX
iSGP		
A	0.60	0.73
B	0.55	0.75
C	0.10	0.25
D	1.20	1.40
E	2.10	2.30
HE	2.30	2.70
L1	1.10	1.50
L2	0.40	0.75
L3	0.75	1.00

Suggested Pad Layout

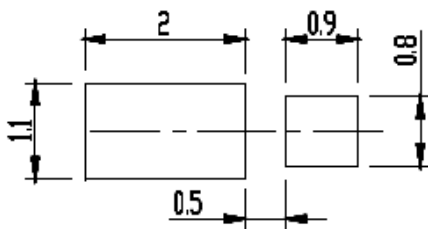

Packing Information

Packing Quantities:

15000 pcs/Reel, 18 Reels/Box, 8mm Tape, 13" Reel

Tape & Reel Specification

