

**NOTES:**

- ① MAT'L: COPPER (STOCK TKN.  $\frac{.031}{.79}$   $\pm .001$ )  
PLATING: ELECTRO-TIN (.0003 MIN.)
- ② BRAZED SEAM

**STUD SIZES: ( $\pm .005$ )**

02 = .094  
 04 = .119  
 06 = .146  
 08 = .173  
 10 = .198  
 14 = .265  
 56 = .328  
 38 = .390

"UL" LISTING \*E32244  
 "CSA" LISTING \*18689

ALL DIMENSIONS =  $\frac{\text{INCHES}}{\text{MM}}$

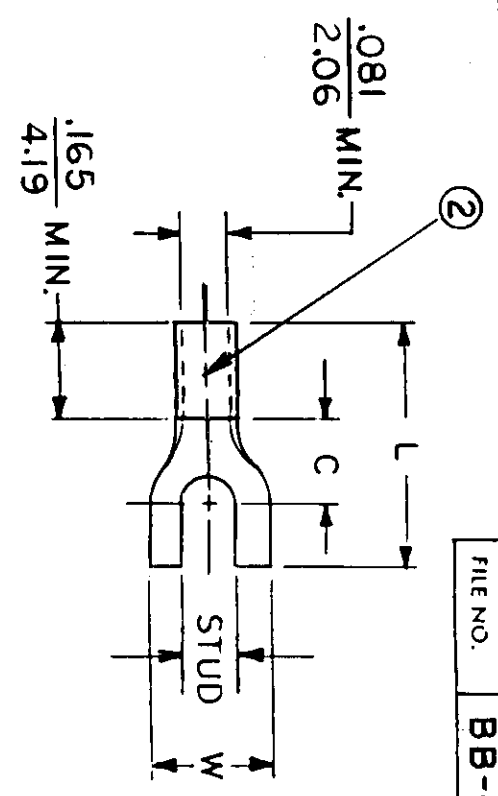

FILE NO. BB-CD-303-02

WIRE SIZE: 16 - 14 AWG  
 1.0 - 2.5 MM<sup>2</sup>

PART NUMBER	"W" ±.010	"C" MIN.	"L" MAX.	REFERENCE			TITLE:
				SCALE:	NTS	DATE	
BB-307-	$\frac{.245}{6.22}$	$\frac{.209}{5.31}$	$\frac{.565}{14.35}$	DRWN. BY: JJ	CHKD. BY: GT	11-27-84	SPADE TONGUE TERMINAL VERSAKRIMP 300-SERIES
BB-324-	$\frac{.295}{7.49}$	$\frac{.211}{5.36}$	$\frac{.564}{14.33}$	APPROD. BY:		12-4-84	
BB-327-	$\frac{.362}{9.19}$	$\frac{.269}{6.83}$	$\frac{.687}{17.45}$				
DIMENSIONAL TOLERANCES UNLESS OTHERWISE SPECIFIED				FRAC.	DEC.	ANG.	
				±	±	±	
				DWG. NO. A			CUSTOMER DWG.



MATERIAL NUMBER	ALTERNATE NUMBER	STUD SIZE	"S" ±.005/(0.13)	"W" ±.010/(0.25)	"C"	"L"	PACKAGING
191470040	BB-307-04	4	.119/(3.02)	.245/(6.22)	.209/(5.31)	.565/(14.35)	LOOSE PIECE
191470042	BB-307-06	6	.146/(3.71)	.245/(6.22)	.209/(5.31)	.565/(14.35)	
191470044	BB-324-04	4	.119/(3.02)	.295/(7.49)	.211/(5.36)	.564/(14.33)	
191470046	BB-324-06	6	.146/(3.71)	.295/(7.49)	.211/(5.36)	.564/(14.33)	
191470048	BB-324-08	8	.173/(4.39)	.295/(7.49)	.211/(5.36)	.564/(14.33)	
191470050	BB-327-06	6	.146/(3.71)	.362/(9.19)	.269/(6.83)	.687/(17.45)	
191470052	BB-327-08	8	.173/(4.39)	.388/(9.85)	.269/(6.83)	.687/(17.45)	
191470054	BB-327-10	10	.198/(5.03)	.388/(9.85)	.269/(6.83)	.687/(17.45)	
191470041	BB-307-04T	4	.119/(3.02)	.245/(6.22)	.209/(5.31)	.565/(14.35)	TAPE MOUNTED
191470043	BB-307-06T	6	.146/(3.71)	.245/(6.22)	.209/(5.31)	.565/(14.35)	
191470045	BB-324-04T	4	.119/(3.02)	.295/(7.49)	.211/(5.36)	.564/(14.33)	
191470047	BB-324-06T	6	.146/(3.71)	.295/(7.49)	.211/(5.36)	.564/(14.33)	
191470049	BB-324-08T	8	.173/(4.39)	.295/(7.49)	.211/(5.36)	.564/(14.33)	
191470051	BB-327-06T	6	.146/(3.71)	.362/(9.19)	.269/(6.83)	.687/(17.45)	
191470053	BB-327-08T	8	.173/(4.39)	.388/(9.85)	.269/(6.83)	.687/(17.45)	
191470055	BB-327-10T	10	.198/(5.03)	.388/(9.85)	.269/(6.83)	.687/(17.45)	

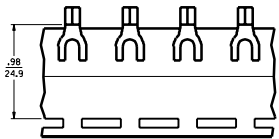

PARTS ON TAPE

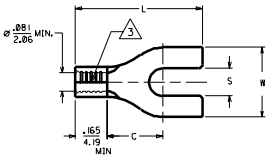

- NOTES:  
 1. MATERIAL: COPPER .031/(.79) THICK.  
 2. PLATING: ELECTRO-TIN.  
 3. BRAZED SEAM.  
 4. ALL DIMENSIONS IN INCHES/(MM).

CUSTOMER DRAWING

DIMENSIONS GIVEN METRIC INCH		<b>REVISE ONLY ON CAD SYSTEM</b>	
UNLESS OTHERWISE SPECIFIED TOLERANCES IN INCHES		TITLE	
1 PLACE ± .005	2 ---	SPADE TONGUE TERMINAL	
1 PLACE ± .01	2 0.13	16-14 AWG	
1 PLACE ± ---	2 0.25	VERSAKRIMP.300-SERIES	
DRAFT MADE APPLICABLE MUST REMAIN WITHIN DIMENSIONS		EPC INC. PINEBLISS PARK, FLA. 32061 U.S.A.	
PART NO. HEB	REV. RWD	DATE	1 99 / 11 / 12
APP'D. RWD	SCALE 4:1	<b>SEE TABLE</b> SD-19147-002	
FILE NAME 15112002		THIS DRAWING CONTAINS INFORMATION THAT IS PROPRIETARY TO EPC INC. AND SHOULD NOT BE USED WITHOUT WRITTEN PERMISSION.	
BY	DATE	REV.	TECH
		ET	B

VOIDS BB-CD-303-02	
ETC 999-0955	
1999/11/12 HEB	
LTR.	REVISIONS
A	