

RECOMMENDED LAND PATTERN DIMENSION OF PCB

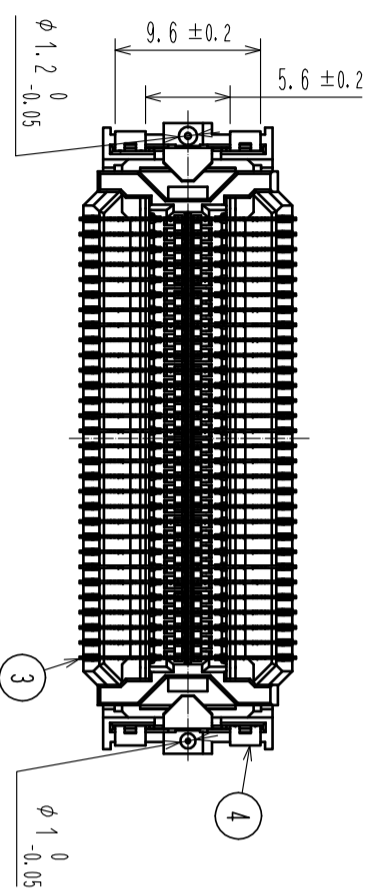
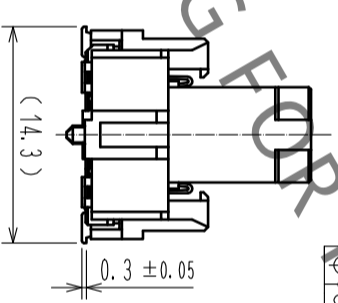
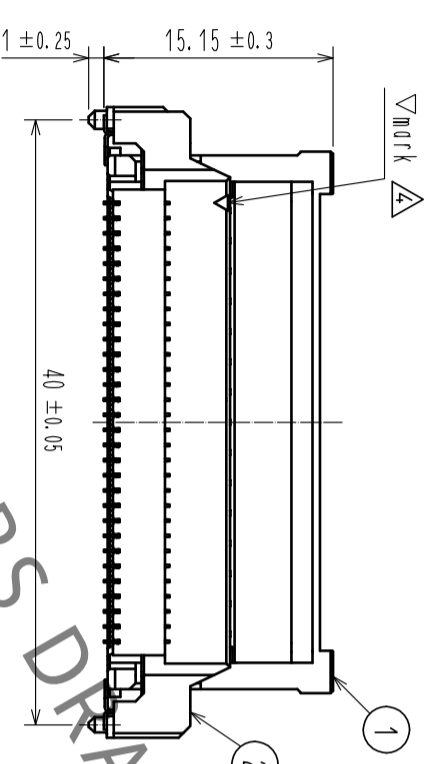
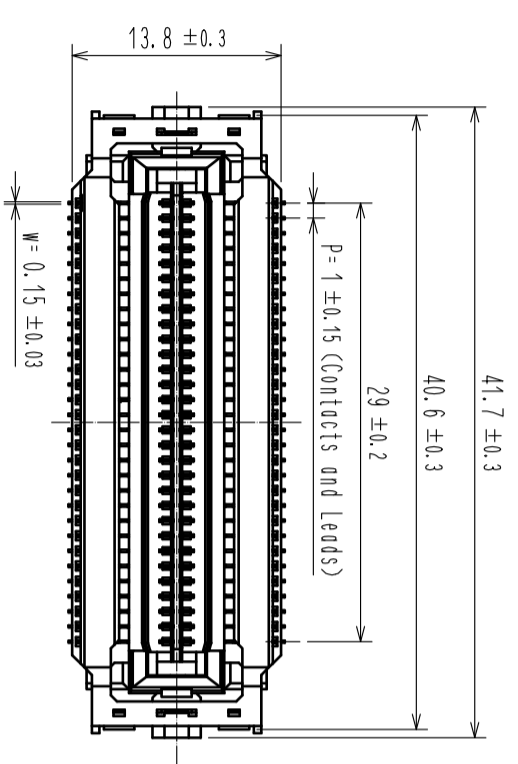
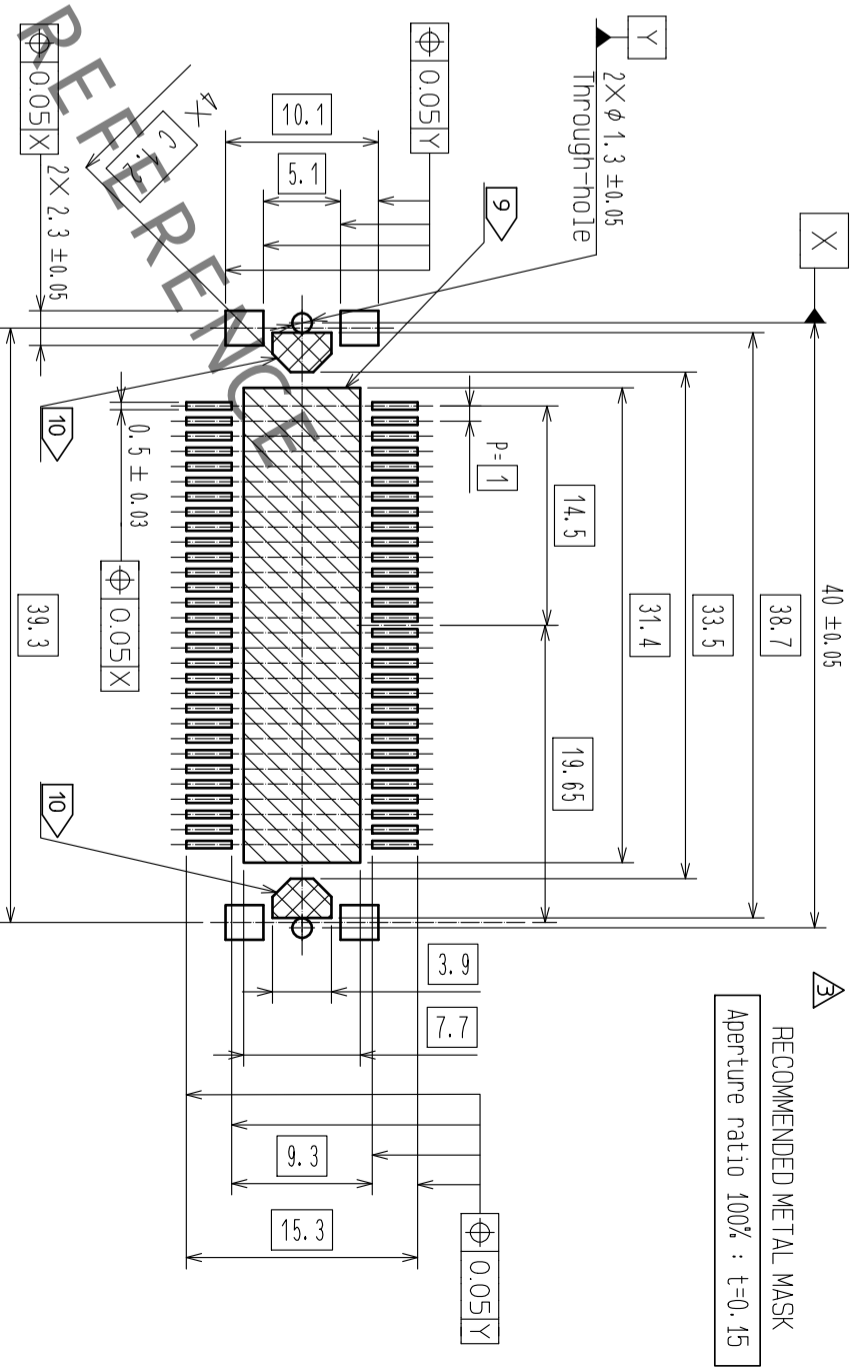

Note

- 1 Lead CO-Planarity is 0.1mm MAX.
- 2 Floating range of this connector is ±0.7mm MAX. The maximum cycle time of the floating operation is in accordance with the mating cycle of the connector.
- 3 Please use the connectors within the specified PCB distance.
- 4 Blemish and hit mark can be occurred through out the manufacturing process which doesn't affect quality level.
- 5 The dimensions in parentheses are for references.
- 6 This is packaged in embossed carrier tape. (200pcs/RL)
- 7 It shows the vacuum pickup area. Remove the pickup cap before mating connectors.
- 8 This connector has no polarity with the mating connector.
- 9 Arrangement of via-hole is prohibited in area.
- 10 Arrangement of pattern and via-hole are prohibited in area.

HRS DRAWING FOR REFERENCE

NO.	MATERIAL	FINISH	REMARKS	NO.	MATERIAL	FINISH	REMARKS
1, 2	POLYAMIDE	BLACK	UL94V-0	3	COPPER ALLOY	UNDER PLATING: NICKEL 1μm	
7	POLYAMIDE		(CAP FOR VACUUM PICKUP)				
6	POLYESTER		(EMBOSSED COVER TAPE)				
5	POLYSTYRENE		(EMBOSSED CARRIER TAPE)				
4	PHOSPHOR BRONZE		OVER PLATING: TIN-PLATING 1μm				
			UNDER PLATING: NICKEL 0.5μm				
			CONTACT AREA: GOLD 0.1μm				
			LEAD AREA: GOLD 0.03μm				

UNITS	SCALE	COUNT	DESCRIPTION OF REVISIONS	DESIGNED	CHECKED	DATE
mm	2 : 1	2	DIS-F-00006551	KI. YAMAZAKI	KN. SHIBUYA	20200831
APPROVED: HH. SHINDO		DRAWING NO.		DESIGNED: TK. ABE		DATE
CHECKED: KN. SHIBUYA		20190719		DRAWING NO.		EDC-387245-00-00
DESIGNED: TK. ABE		20190718		PART NO.		FX26-60P-1SV5
DRAWN: TK. ABE		20190718		CODE		CL576-1506-0-00



6 DRAWING FOR PACKING(2:1)

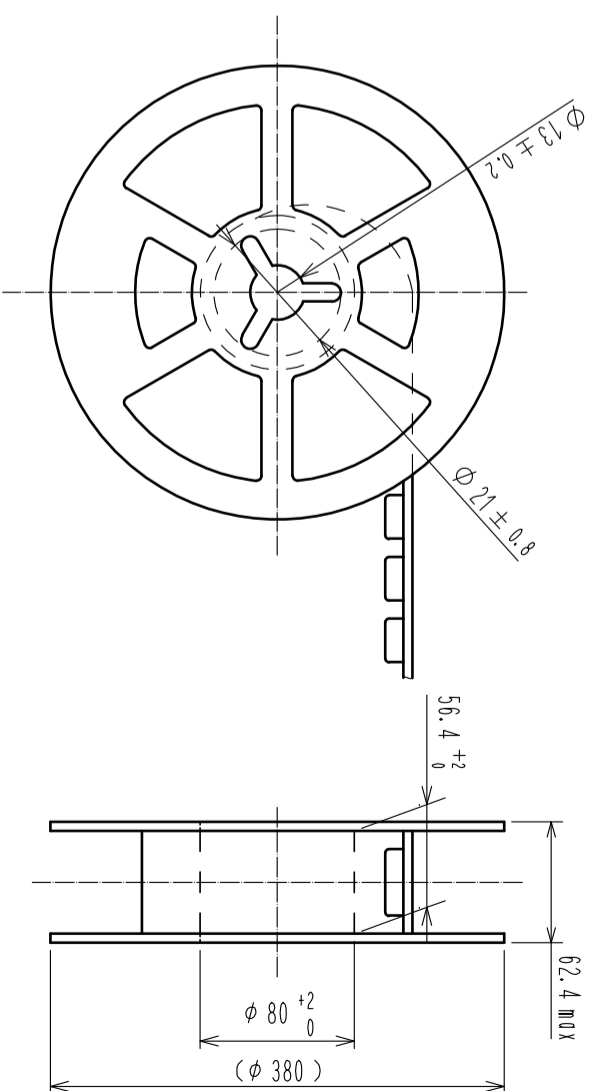
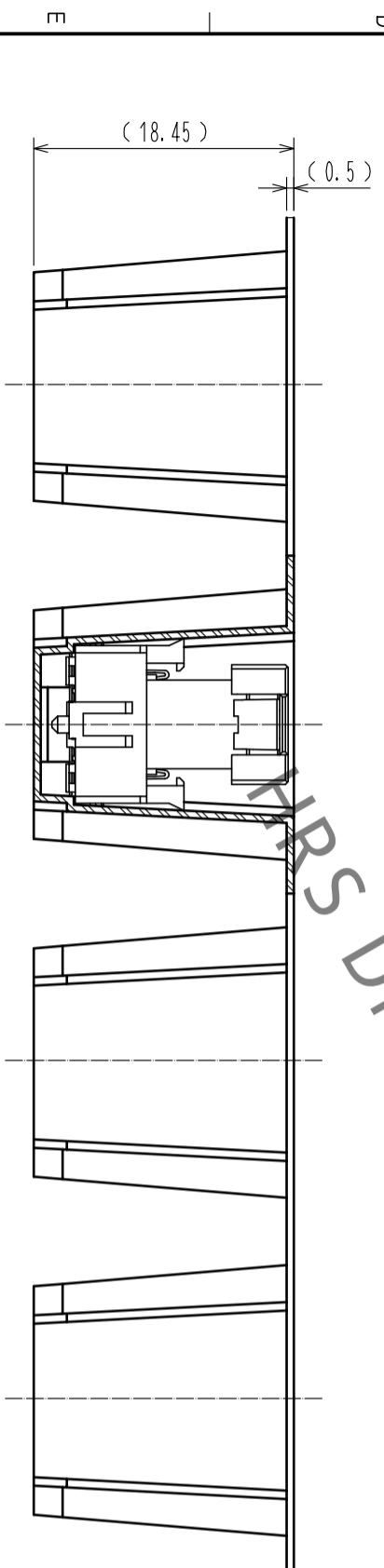
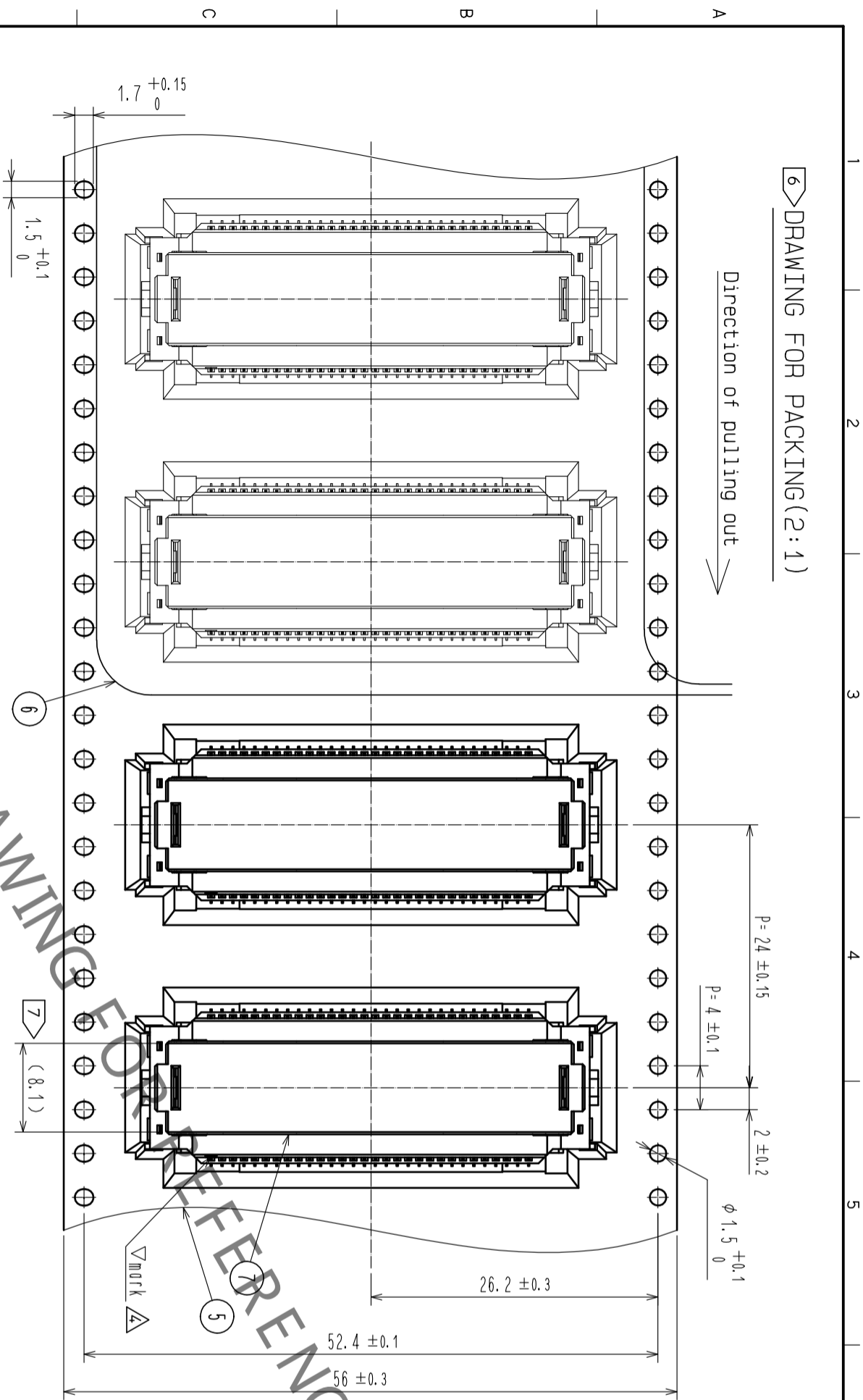

REEL DIMENSION(No scale)

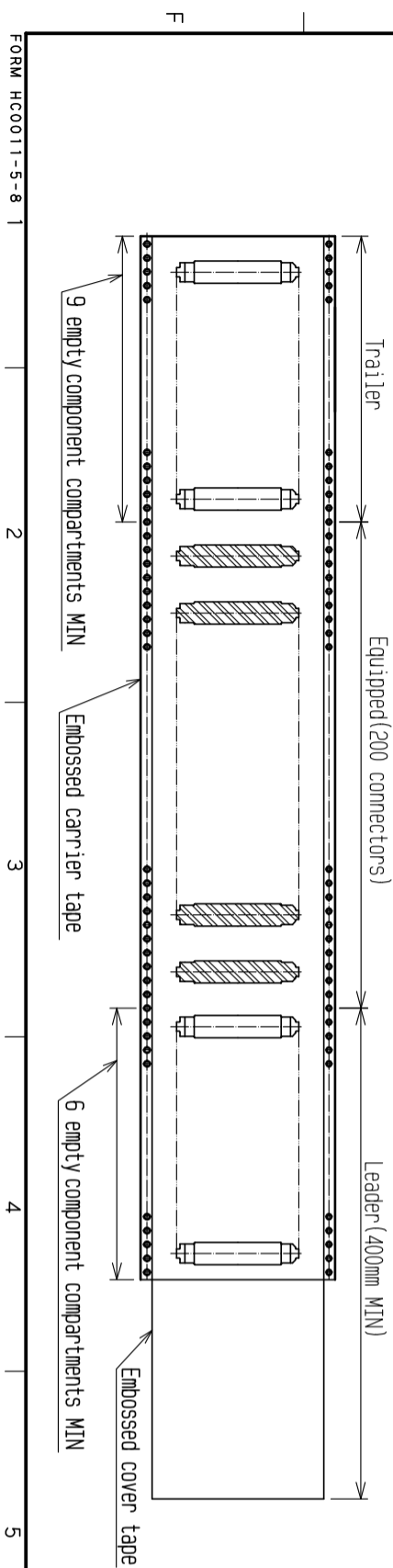

FORM HC0011-5-8 1 2 3 4 5 6 7 8

HR5	DRAWING NO.	EDC-387245-00-00
	PART NO.	FX26-60P-1SV5
	CODE	CL576-1506-0-00
	NO.	

4/2