

**THIS PRODUCT MANUFACTURED WITH LEAD-FREE PROCESSING**

**DESIGNED & DIMENSIONED IN MILLIMETERS [INCHES]**

DO NOT SCALE FROM THIS PRINT

TABLE 1			
ITEM	COMPONENT	-HN	-GN
1	FERRULE	SMA-FER-001-N	
2	CABLE BODY	NTPE-J-C-N-ST-BH1-CBDY	
3	INSULATOR	NTPE-INS-001	
4	SOCKET	NTPE-J-C-H-ST-BH1-SKT	NTPE-J-C-G-ST-BH1-SKT
5	SUB ASSEMBLY	SUB-NTPE-J-C-N-ST-BH1	
6	GASKET	NTPE-GKT-001	
7	LOCK WASHER	NTPE-LWAS-001-N	
8	HEX NUT	NTPE-NUT-001-N	

**NTPE-J-C-XX-ST-BH1-X**

**GENDER**  
-J: JACK

**TYPE**  
-C: CABLE

**PACKAGING**  
-BLANK: INDIVIDUALLY BAGGED  
-B: BULK PACKAGED (QTY=100 MAX)

**TERMINATION**  
-BH1: BULKHEAD  
(CCA-174 OR CCA-316)

**ORIENTATION**  
-ST: STRAIGHT

**PLATING SPECIFICATION**  
-HN: HEAVY GOLD/NICKEL  
30µ" CENTER CONTACT, NICKEL OTHER  
-GN: GOLD/NICKEL  
10µ" CENTER CONTACT, NICKEL OTHER

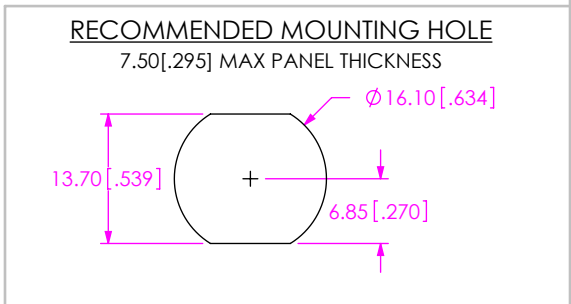
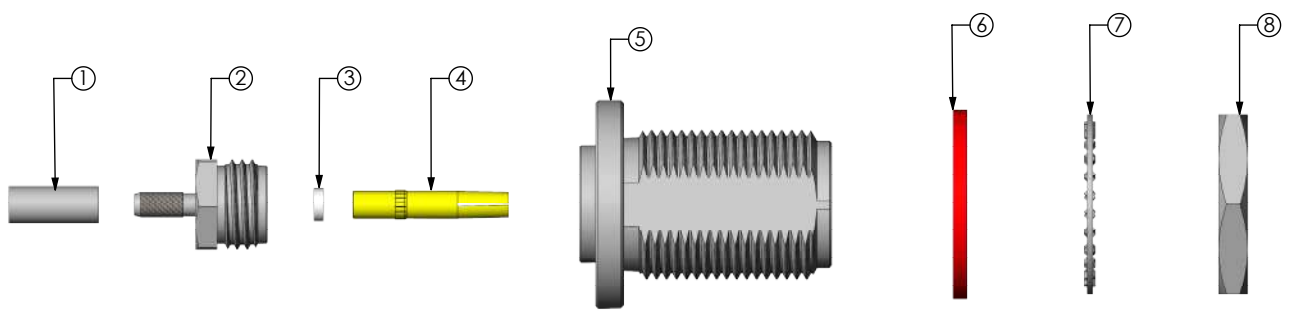

- NOTES:
- Ⓢ REPRESENTS A CRITICAL DIMENSION.
  - NOTE DELETED.
  - NOTE DELETED.
  - PRODUCT TO BE PACKAGED PER PRECISION RF SECTION OF PACKAGING MANUAL.
  - NOTE DELETED.
  - NOTE DELETED.
  - NOTE DELETED.

<p><b>UNLESS OTHERWISE SPECIFIED DIMENSIONS ARE IN MILLIMETERS [INCHES]</b></p> <p>TOLERANCES ARE:</p> <table border="0"> <tr> <td>DECIMALS</td> <td>ANGLES</td> </tr> <tr> <td>.X: ±0.3 [.01]</td> <td>2°</td> </tr> <tr> <td>.XX: ±0.13 [.005]</td> <td></td> </tr> <tr> <td>.XXX: ±0.051 [.0020]</td> <td></td> </tr> </table>	DECIMALS	ANGLES	.X: ±0.3 [.01]	2°	.XX: ±0.13 [.005]		.XXX: ±0.051 [.0020]		<p><b>PROPRIETARY NOTE</b></p> <p>THIS DOCUMENT CONTAINS INFORMATION CONFIDENTIAL AND PROPRIETARY TO SAMTEC, INC. AND SHALL NOT BE REPRODUCED OR TRANSFERRED TO OTHER DOCUMENTS OR DISCLOSED TO OTHERS OR USED FOR ANY PURPOSE OTHER THAN THAT WHICH IT WAS OBTAINED WITHOUT THE EXPRESSED WRITTEN CONSENT OF SAMTEC, INC.</p>	<p>520 PARK EAST BLVD., NEW ALBANY, IN 47150 PHONE: 812-944-6733 FAX: 812-948-5047 e-Mail info@SAMTEC.com code 55322</p>
	DECIMALS	ANGLES								
.X: ±0.3 [.01]	2°									
.XX: ±0.13 [.005]										
.XXX: ±0.051 [.0020]										
<p><b>MATERIAL:</b> DO NOT SCALE DRAWING SHEET SCALE: 1.25:1</p> <p>SHELLS, FERRULES, NUTS, WASHERS: BRASS CONTACT: COPPER ALLOY DIELECTRIC: PTFE GASKET: SILICONE</p>	<p>DESCRIPTION: N TYPE STRAIGHT BULKHEAD CABLE JACK, RG174 &amp; RG316 - 50 OHM</p> <p>DWG. NO. <b>NTPE-J-C-XX-ST-BH1-X</b></p>									
<p>BY: R MUSSER 09-09-2010</p>		<p>SHEET 1 OF 3</p>								

REVISION P

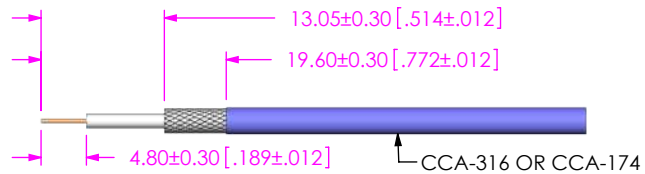

IN-PROCESS 1  
STRIP AND TIN INNER  
CONDUCTOR

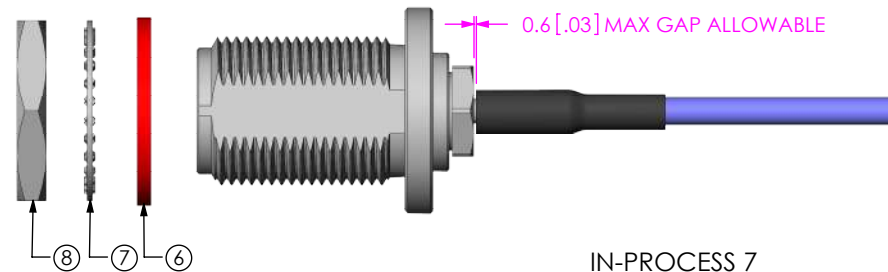

IN-PROCESS 7  
APPLY HEAT SHRINK  
TUBE & ADD GASKET

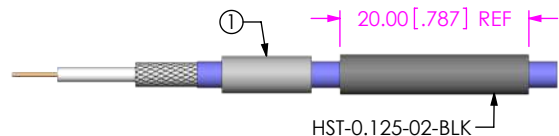

IN-PROCESS 2  
ADD HEAT SHRINK  
TUBE AND FERRULE

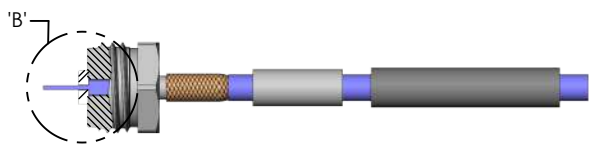

IN-PROCESS 3  
ADD CABLE BODY &  
INSULATOR

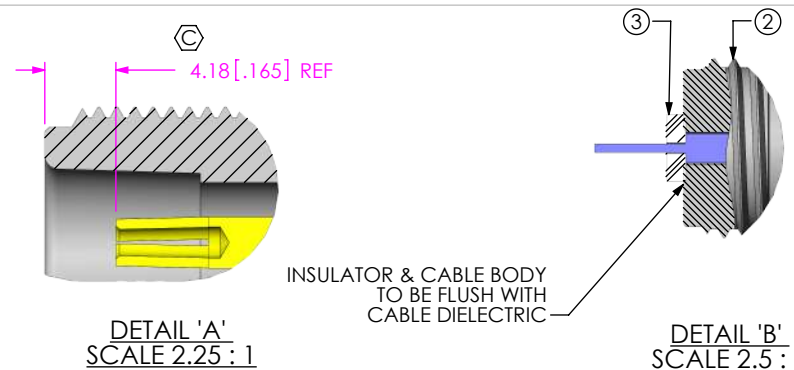

INSULATOR & CABLE BODY  
TO BE FLUSH WITH  
CABLE DIELECTRIC

DETAIL 'A'  
SCALE 2.25 : 1

DETAIL 'B'  
SCALE 2.5 : 1

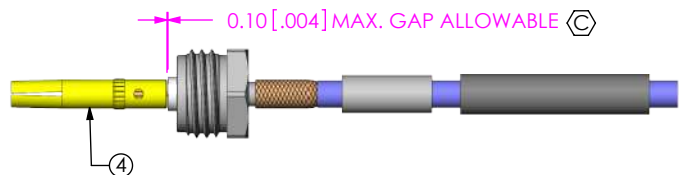

IN-PROCESS 4  
SOLDER SIGNAL  
SOCKET

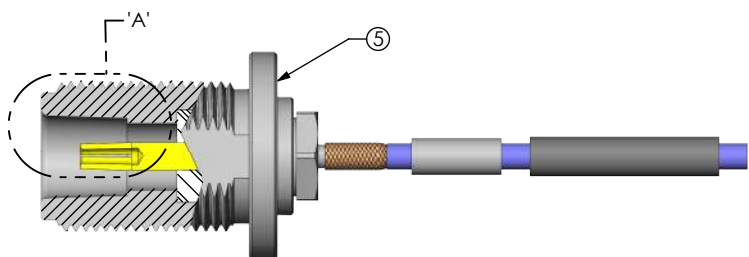

IN-PROCESS 5  
ADD SUB ASSEMBLY  
(TORQUE TO 30 INCH LBS)  
⊕

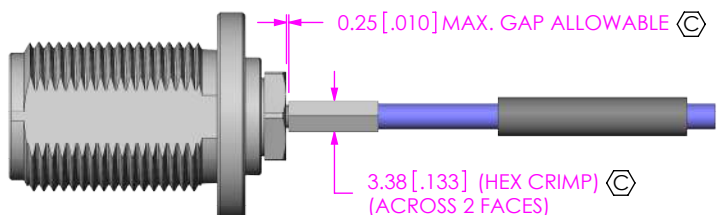

IN-PROCESS 6  
CRIMP FERRULE  
(USE RF CRIMP  
HAND TOOL #CAT-HT-126667-21  
OR EQUIVALENT)  
(USE .128" HEX DIE)  
⊕

c:\enterprise\vauf\DWG\MISC\MKTG\NTPE-J-C-XX-ST-BH1-X-MKT.SLDDRW

PROPRIETARY NOTE

THIS DOCUMENT CONTAINS INFORMATION  
CONFIDENTIAL AND PROPRIETARY TO  
SAMTEC, INC. AND SHALL NOT BE REPRODUCED  
OR TRANSFERRED TO OTHER DOCUMENTS OR  
DISCLOSED TO OTHERS OR USED FOR ANY  
PURPOSE OTHER THAN THAT WHICH IT WAS  
OBTAINED WITHOUT THE EXPRESSED WRITTEN  
CONSENT OF SAMTEC, INC.



520 PARK EAST BLVD, NEW ALBANY, IN 47150  
PHONE: 812-944-6733 FAX: 812-948-5047  
e-Mail info@SAMTEC.com code 55322

DO NOT SCALE DRAWING

SHEET SCALE: 1.25:1

DESCRIPTION:  
N TYPE STRAIGHT BULKHEAD CABLE JACK, RG174 & RG316 - 50 OHM

DWG. NO.  
NTPE-J-C-XX-ST-BH1-X

BY: R MUSSER 09-09-2010 SHEET 2 OF 3

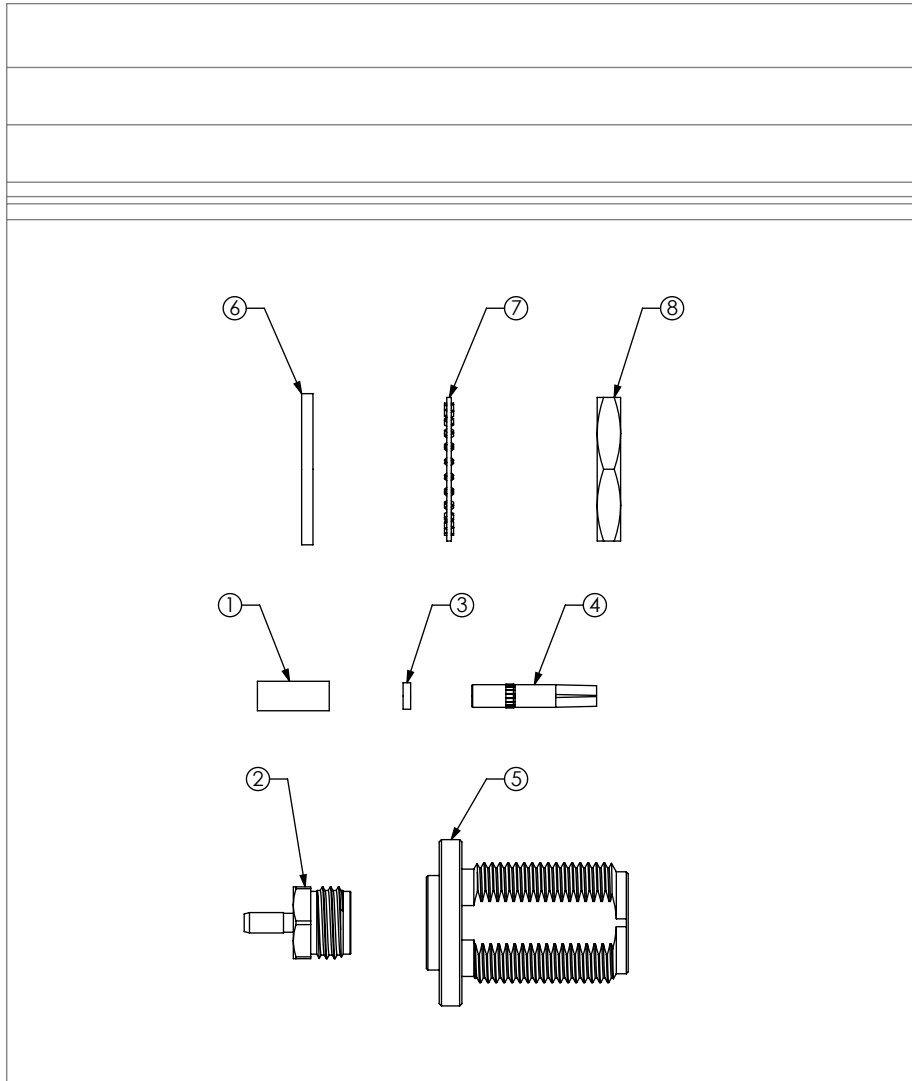

PACKAGING VIEW  
 NTPC-J-C-XX-ST-BH1 SHOWN

**PROPRIETARY NOTE**

THIS DOCUMENT CONTAINS INFORMATION CONFIDENTIAL AND PROPRIETARY TO SAMTEC, INC. AND SHALL NOT BE REPRODUCED OR TRANSFERRED TO OTHER DOCUMENTS OR DISCLOSED TO OTHERS OR USED FOR ANY PURPOSE OTHER THAN THAT WHICH IT WAS OBTAINED WITHOUT THE EXPRESSED WRITTEN CONSENT OF SAMTEC, INC.

DO NOT SCALE DRAWING

SHEET SCALE: 1:1



520 PARK EAST BLVD., NEW ALBANY, IN 47150  
 PHONE: 812-944-6733 FAX: 812-948-5047  
 e-Mail info@SAMTEC.com code 55322

DESCRIPTION:  
 N TYPE STRAIGHT BULKHEAD CABLE JACK, RG174 & RG316 - 50 OHM

DWG. NO.  
**NTPC-J-C-XX-ST-BH1-X**

BY: R MUSSER 09-09-2010 SHEET 3 OF 3