



ANATECH ELECTRONICS INC
RF & Microwave Filters & Products

262 MHz LC Band Pass Filter

Part Number: AE262B11643



Electrical Specifications

Center Frequency: 262 MHz
1dB Bandwidth: 21 MHz
Insertion Loss: 3.0 dB Max.
Return Loss: 14 dB Min.
Rejection: ≥ 50 dB @ 220 MHz
Power Handling: 1 W
Impedance: 50 Ohms

Mechanical

Connector Type: SMT
Dimensions: 1.6" X 0.5" x 0.34" .

Environmental

Operating Temperature: -55°C to +85°C
Storage Temperature: -57°C to +125°C
Shock: 10 G. 11ms
Vibration: 10 G. 5 to 200Hz

Outline Drawing:

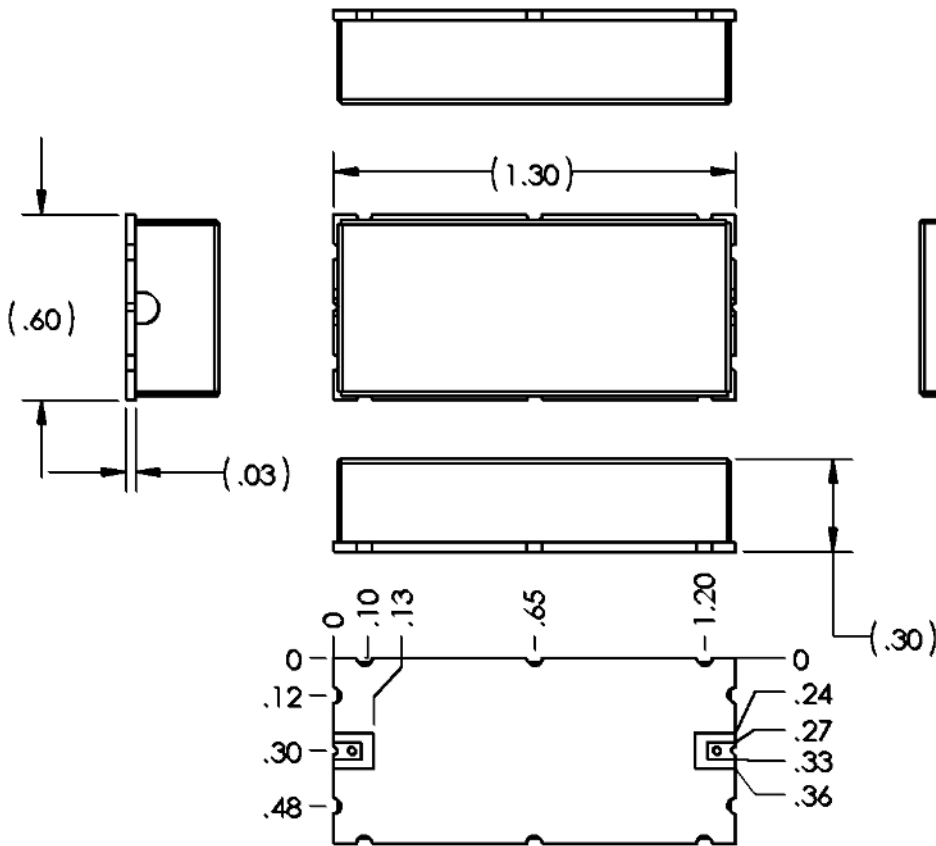

Tolerance: +/-0.01 inches [+/- 0.3mm]

Angles: +/- 1 Deg.

*Tolerance as shown unless otherwise specified in the datasheet electrical specification tables above.

*When max dimensions are called out the above tolerances do not apply as long as it is under the max call out.

70 Outwater Lane Phone: (973) 772-4242
 Garfield, NJ 07026 Fax : (973) 321-3941

Email: sales@anatechelectronics.com
 Web: www.anatechelectronics.com



Simulation Plot:

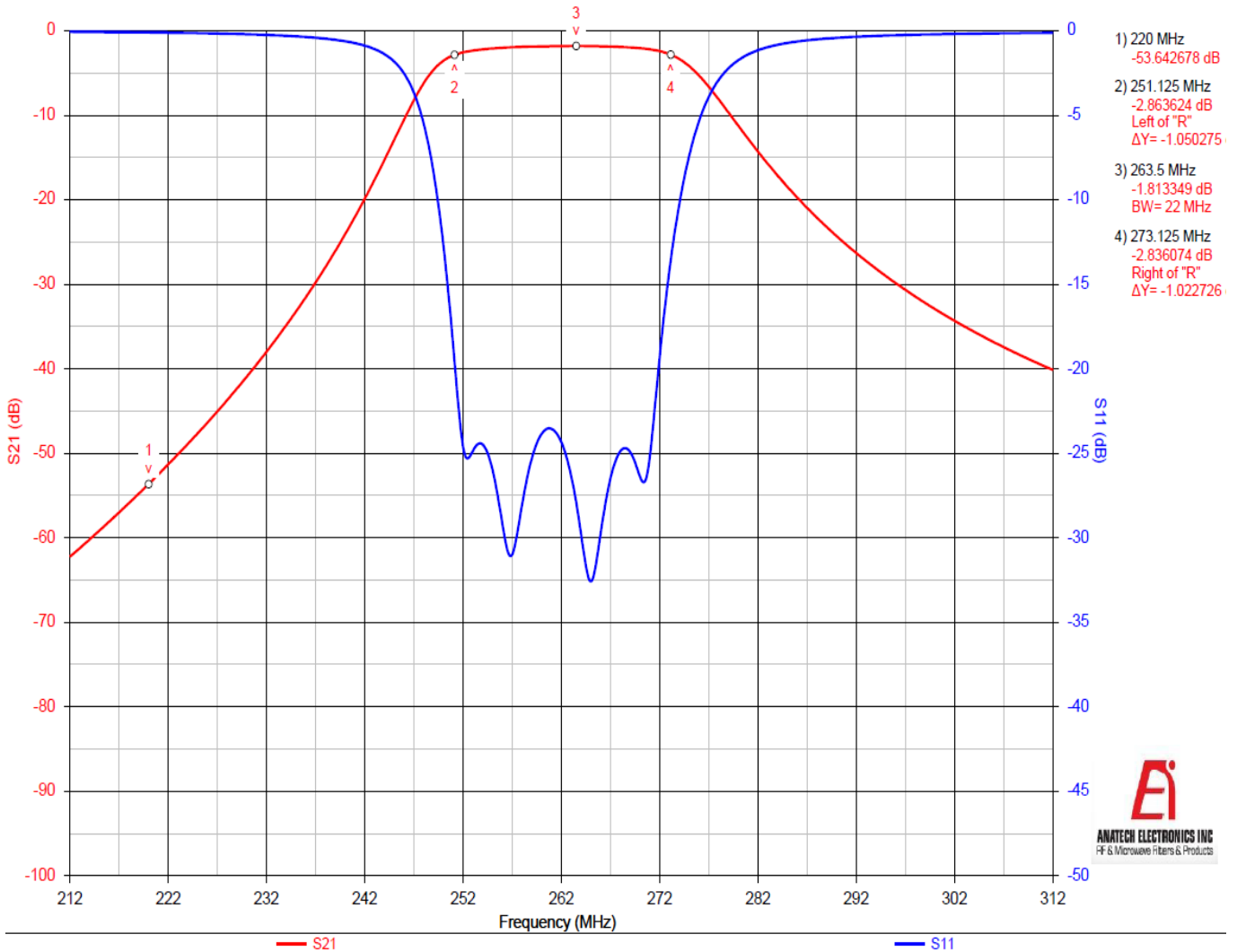

Note: This is a simulation Plot. Actual Response plot might differ once product is manufactured.