

Leiterplatten Optionen / PCB options

Leiterplattendicke 2 mm  
Layoutempfehlung siehe 225508

PCB thickness 2 mm  
For recommended dims see 225508

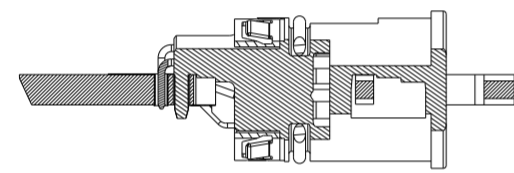
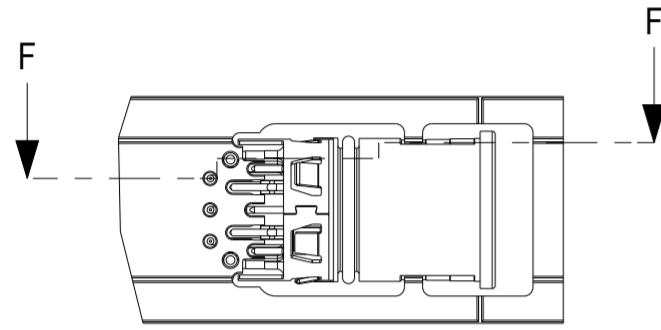
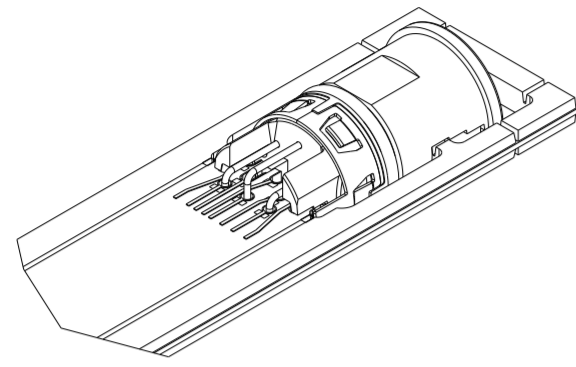

SCHNITT F-F  
SECTION F-F

Leiterplattendicke 1,6 mm  
Layoutempfehlung siehe 225508

PCB thickness 1,6 mm  
For recommended dims see 225508

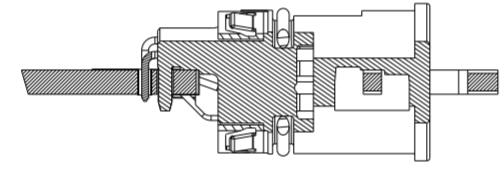
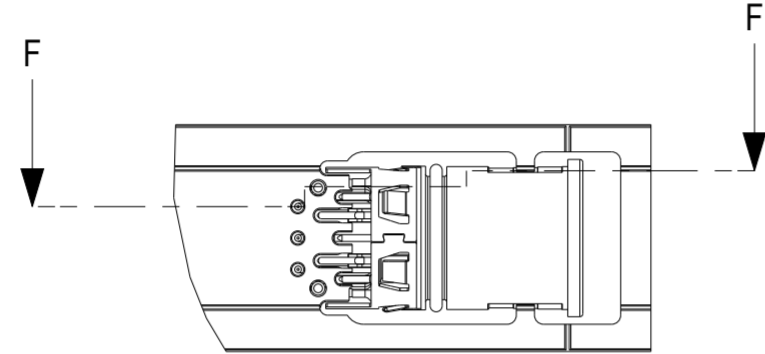
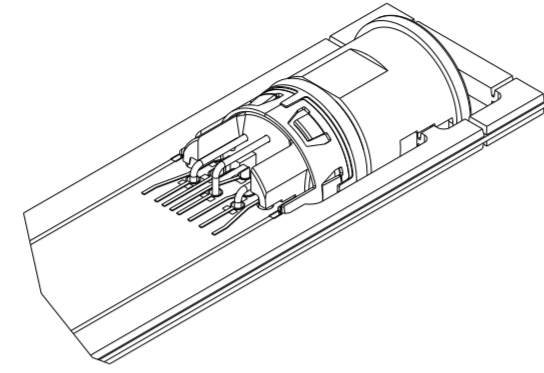

SCHNITT F-F  
SECTION F-F

Leiterplattendicke 1 mm  
Layoutempfehlung siehe 225508

PCB thickness 1 mm  
For recommended dims see 225508

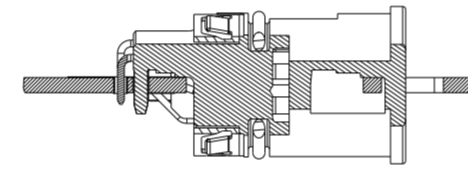
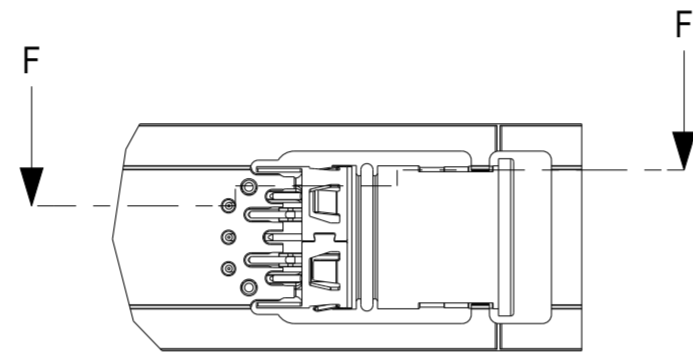
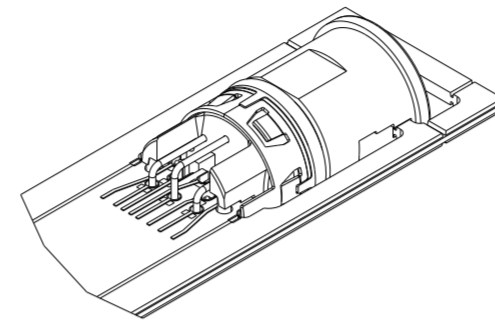

SCHNITT F-F  
SECTION F-F

Verpackung / Packaging tape and reel (T&R)

Abspulrichtung / Reel off direction

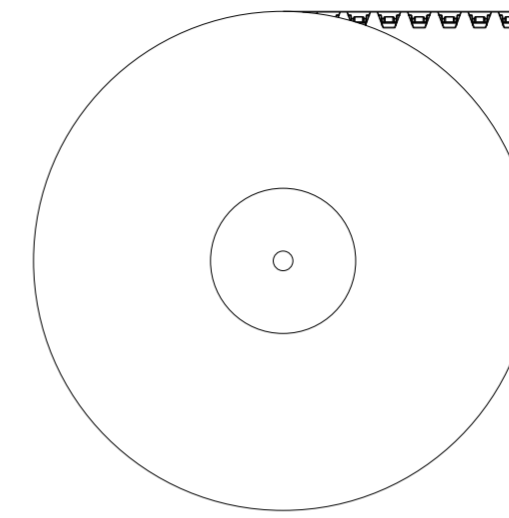

M 1:5  
SCALE 1:5

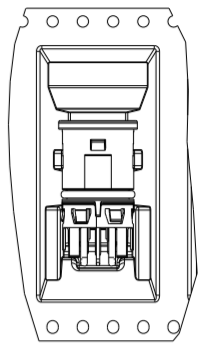

ANSICHT A  
M 1:1  
DETAIL A  
SCALE 1:1

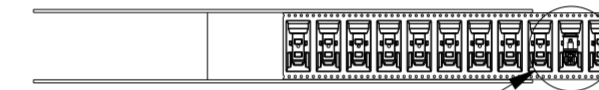

SIEHE ANSICHT A  
SEE DETAIL A

Anwendungsbeispiel / Application example

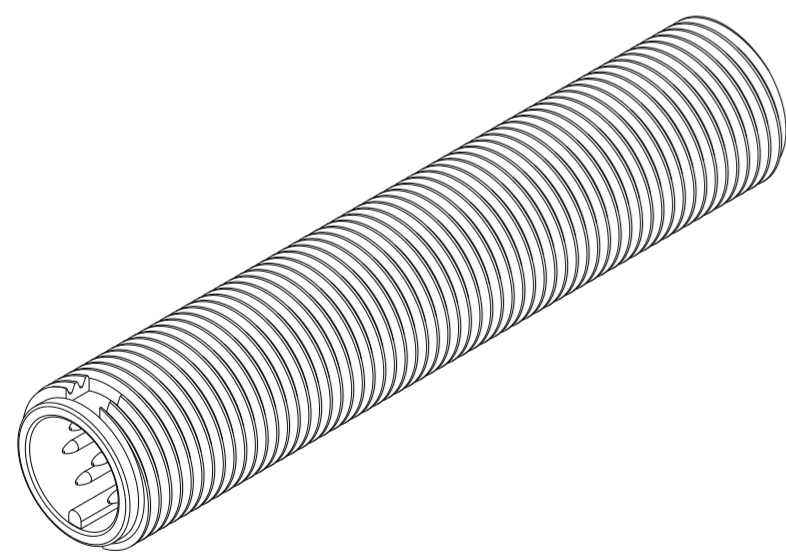

Version mit Verdrehsschutz  
Version with torque ribs

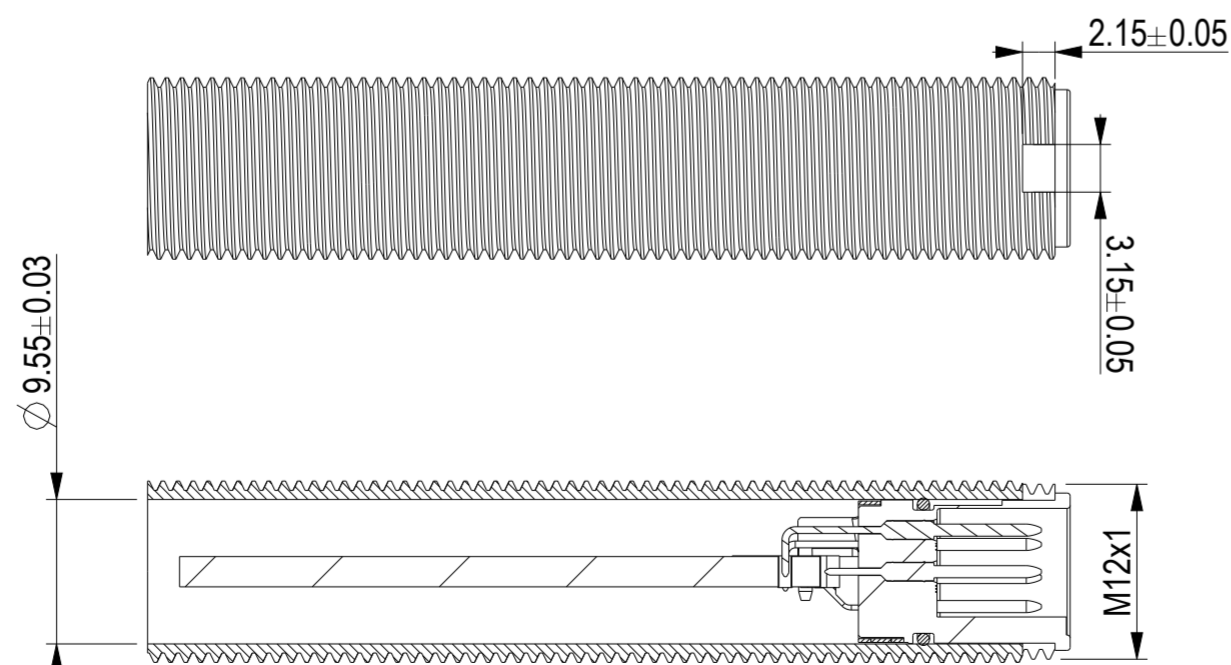

SCHNITT C-C  
M 2:1  
SECTION C-C  
SCALE 2:1

Handschriftliche Änderungen auf CAD Zeichnungen sind nicht zulässig!

Technische Daten siehe Document 225407  
Technical data see document 225407

225291	2	no	no	yes	8	1,2,3,4,5,6,7,8	T&R	
225292	2	no	yes	yes	8	1,2,3,4,5,6,7,8	T&R	
225521	2	yes	no	yes	8	1,2,3,4,5,6,7,8	T&R	
225522	2	yes	yes	yes	8	1,2,3,4,5,6,7,8	T&R	

Ident-Nr. Ident-No.	Zeichn. Blatt Drw. sheet	Verdrehsschutz Antitwist	Schirm Shield	O-ring O-ring	Polzahl No. pins	Kontakt Nr. Contact No.	Verpackung Packaging	Bemerkung Remarks
Information				Tolerances		Scale 2:1		
All rights reserved. Only for information. To ensure that this is the latest version of this drawing, please contact one of the ERNI companies before using.				Subject to modification without prior notice. Drawing will not be updated.		Designation alle Varianten / all versions		
A				ERNI www.ERNI.com		M12 90° M A THR Frontmontage M12 90° M A THR front mount		
Index				30.09.14		225293		
				Date		I (1 / 2) A2		
						Class M12		

Ident-Nr. <i>Ident-No.</i>	O-ring <i>O-ring</i>	Schirm <i>Shield</i>	Verdrehschutz <i>Antitwist option</i>	Verguss <i>Potting</i>
225291	yes	no	no	needed
225292	yes	yes	no	recommended
225521	yes	no	yes	not needed
225522	yes	yes	yes	not needed

Darstellung mit Schirm und O-Ring  
*Drawn with shield and O-ring*

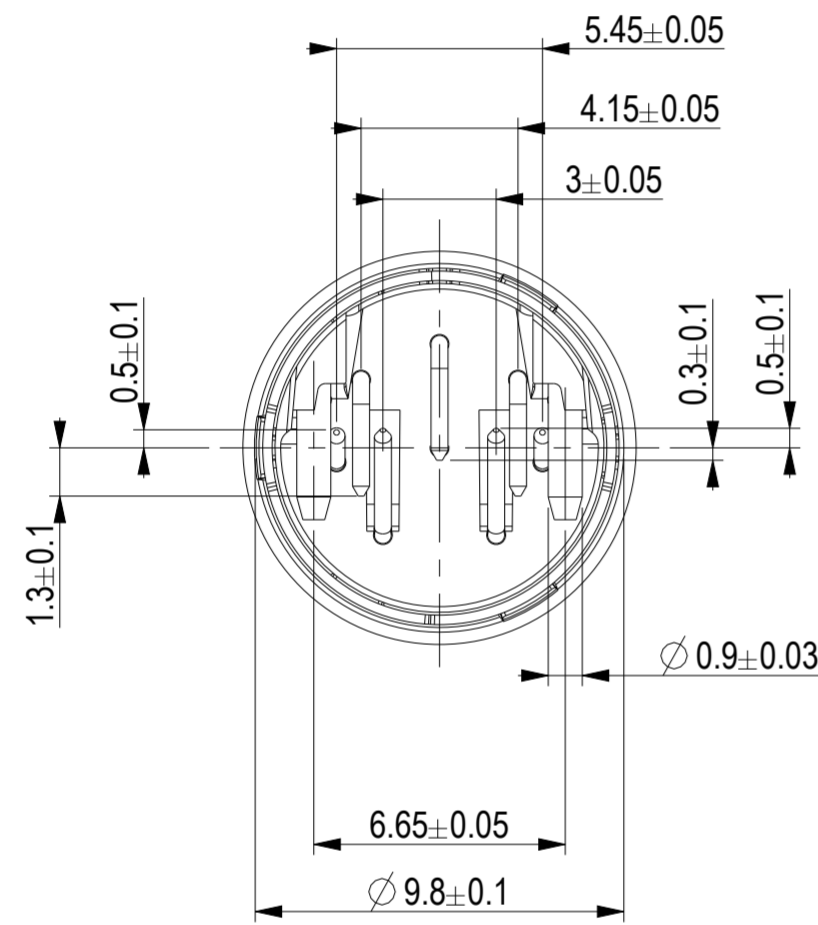
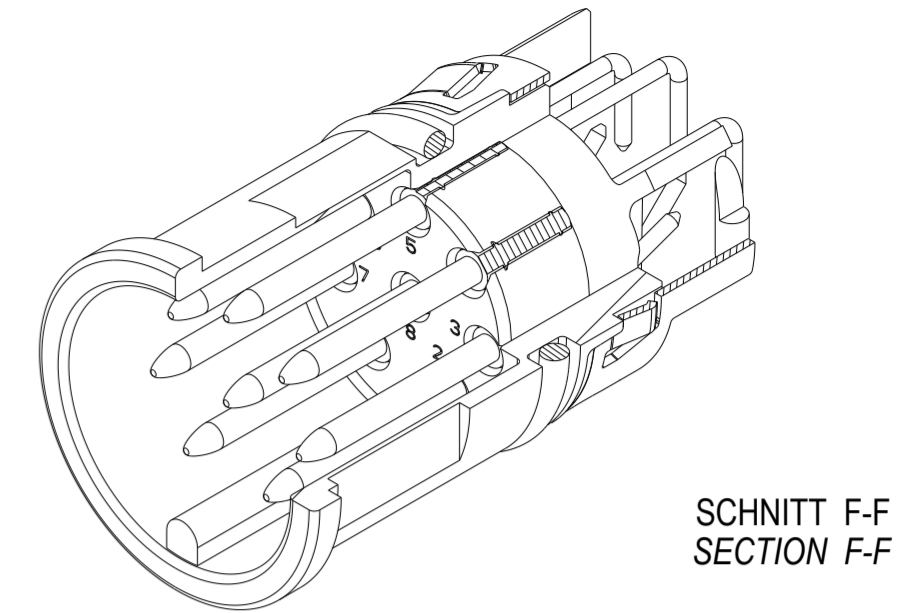
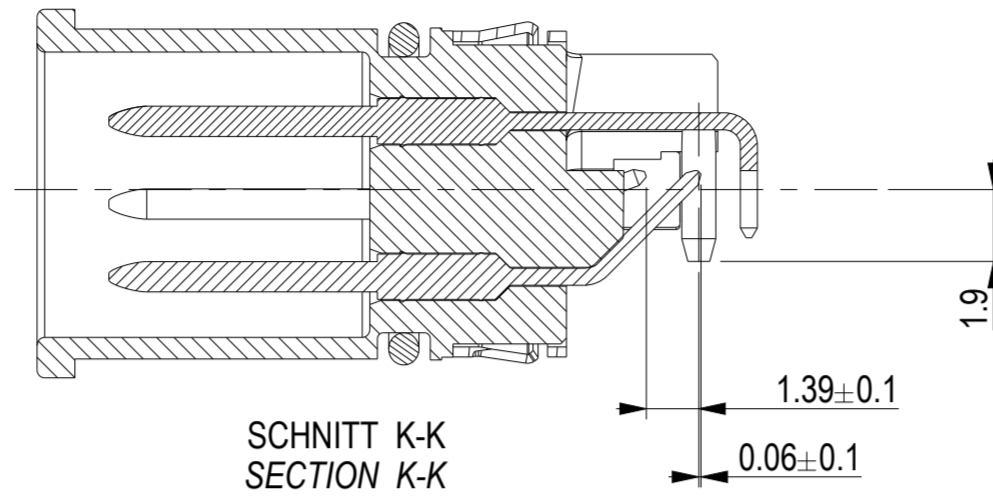

Gemessen über Schirmkontakte  
*Measured over shield contacts*

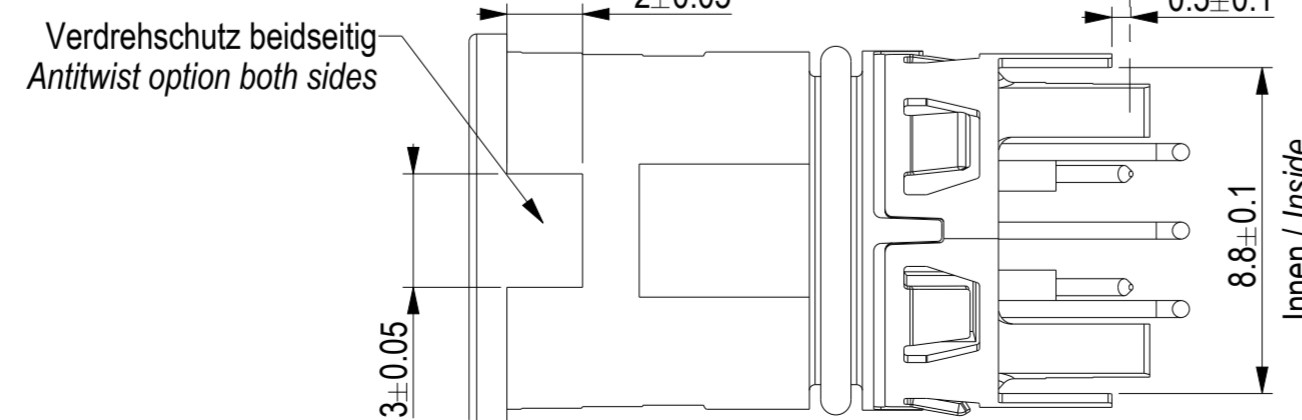
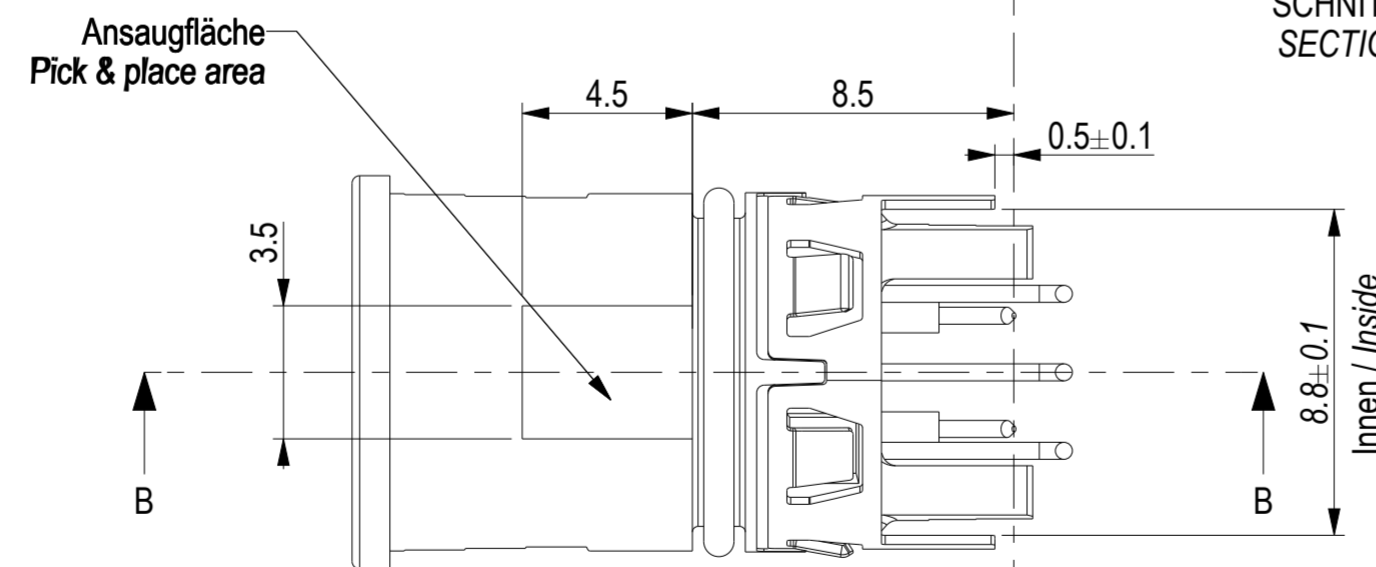
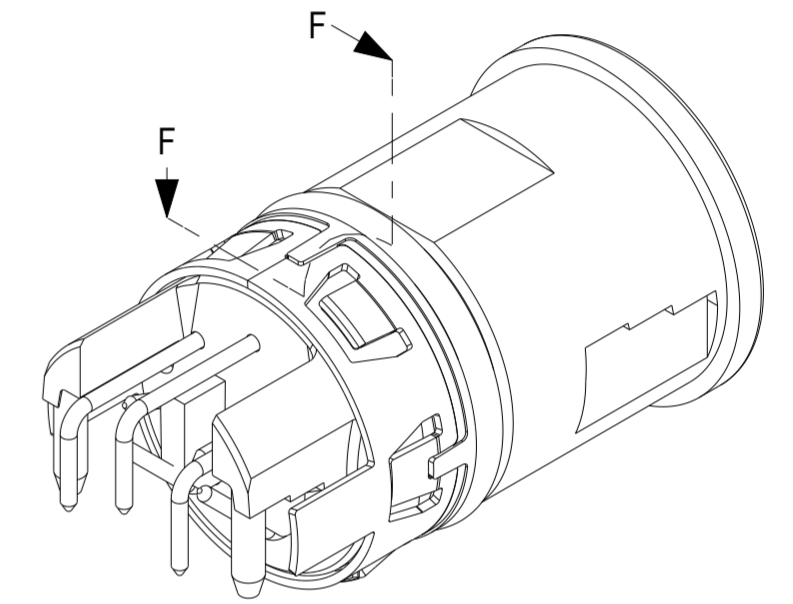
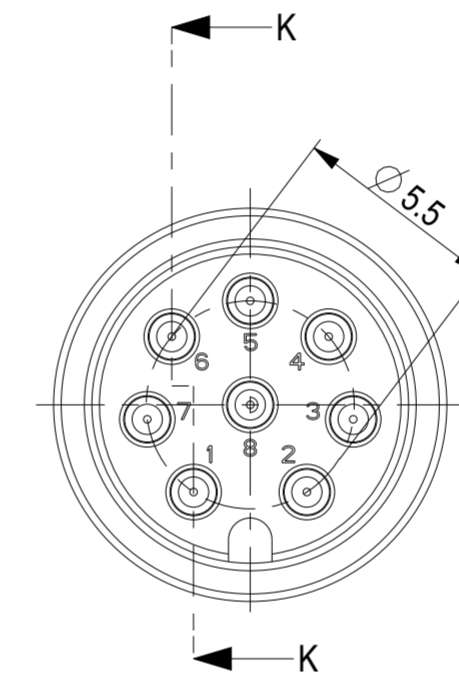
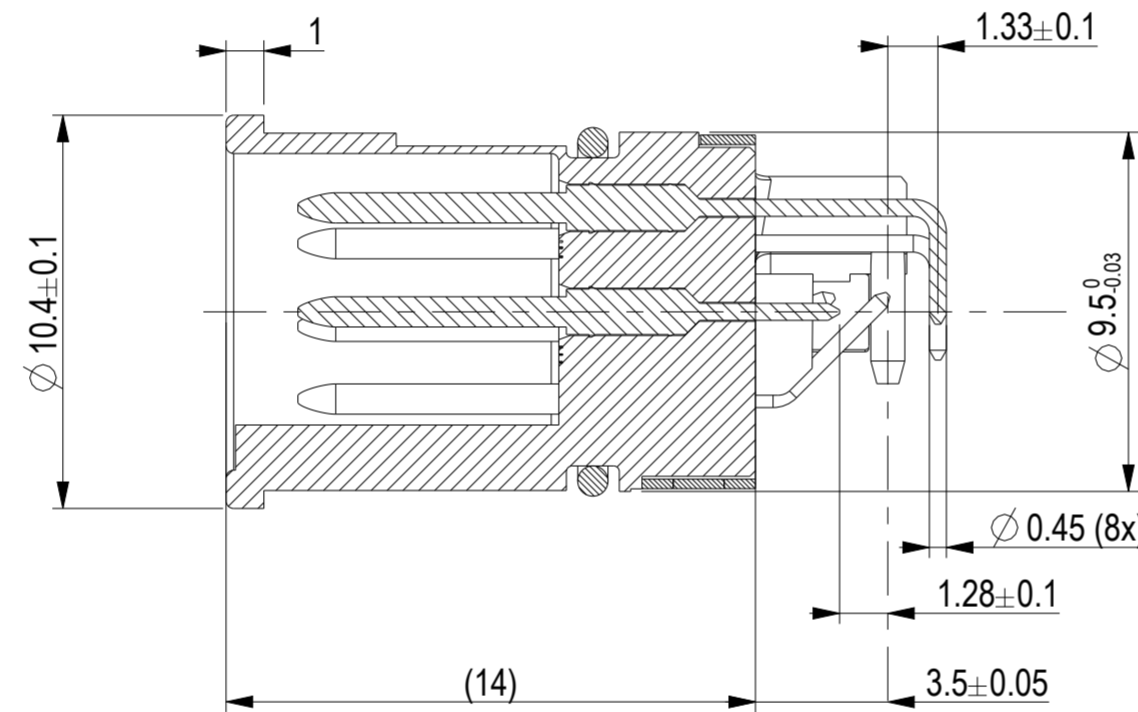

Steckgesicht nach IEC 61076-2-101  
*Mating face acc. IEC 61076-2-101*

Copyright by ERNI GmbH  
Proprietary notice pursuant to BSC 18016 to be observed.

Information		Tolerances	Scale	5:1
All rights reserved. Only for information. To ensure that this is the latest version of this drawing, please contact one of the ERNI companies before using.		 All Dimensions in mm	Designation	
			8 polige Version / 8 pin version	
		Subject to modification without prior notice. Drawing will not be updated.	<b>M12 90° M A THR Frontmontage</b> <b>M12 90° M A THR front mount</b>	
		 www.ERNI.com	225293	
			I (2 / 2) A2	
A	30.09.14	Class		M12
Index	Date			

Handschriftliche Änderungen auf CAD Zeichnungen sind nicht zulässig!