

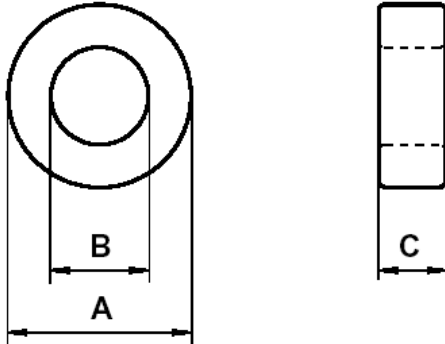

Specification for:  
**ZW41306TC**

110 Delta Drive  
 Pittsburgh, PA 15238  
 Phone: 412/696-1333  
 Fax: 412/696-0333  
 Email:magnetics@spang.com

**DIMENSIONS**



(mm)	Uncoated Nominal:	Coated Min:	Coated Max:
O.D. (A)	12.7	12.43	13.47
I.D. (B)	7.92	7.16	8.18
Ht. (C)	6.35	6.19	7.01

Eff. Parameters		
$A_e$ mm <sup>2</sup>	$l_e$ mm	$V_e$ mm <sup>3</sup>
14.9	31.2	465

**INDUCTANCE**

AL value (nH/T <sup>2</sup> )	Test conditions
5936 ± 30%	10 kHz, 0.5 mT (For N = 5, use 0.15 mA), 25°C

**ELECTRICAL LOSSES**

$\tan \delta / \mu_i$	Production lot limit Average	Test conditions	
$\leq 3.5 \cdot 10^{-6}$	$\leq 3 \cdot 10^{-6}$	10 kHz	0.5 mT, 25°C
$\leq 55 \cdot 10^{-6}$	$\leq 45 \cdot 10^{-6}$	100 kHz	

**COATING**

Epoxy rated for 200°C continuous operation.
Voltage breakdown rating 1,500 V Min Wire-to-Wire.

**NOTE**

Spec. Modifications	Previous	Revised
2005.12.16	Breakdown voltage > 1,000 V LF: General W material	Breakdown voltage > 1,500 V LF: Detail as indicated