

PRODUCT NUMBER	TAIL TYPE	TAIL LENGTH (DIM A)	PACKING
10133694-101LF	PIP	2.7	TRAY

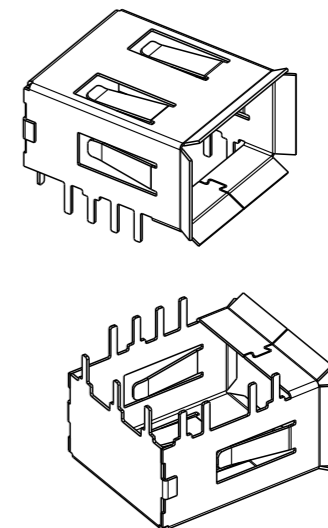

PRODUCT NUMBER	TAIL TYPE	PACKING
10133694-102LF	PRESSFIT	TRAY

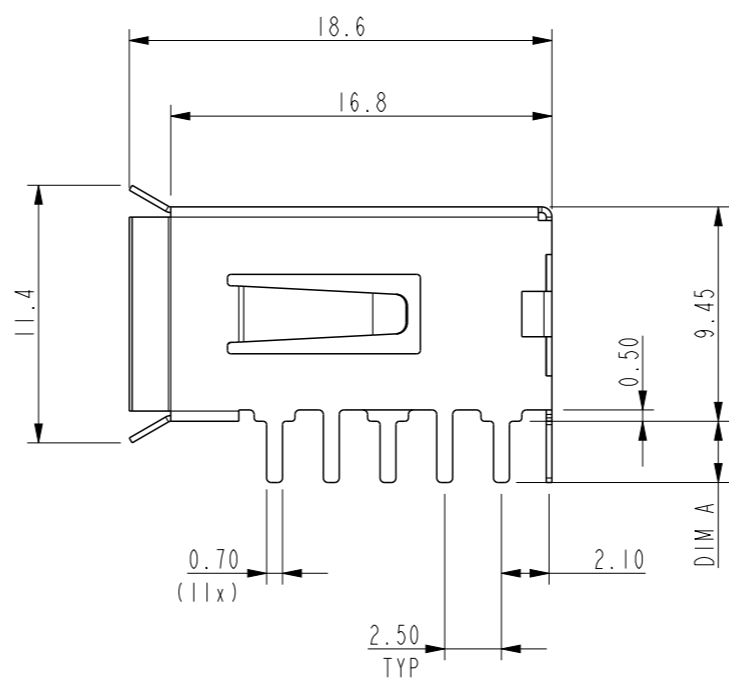
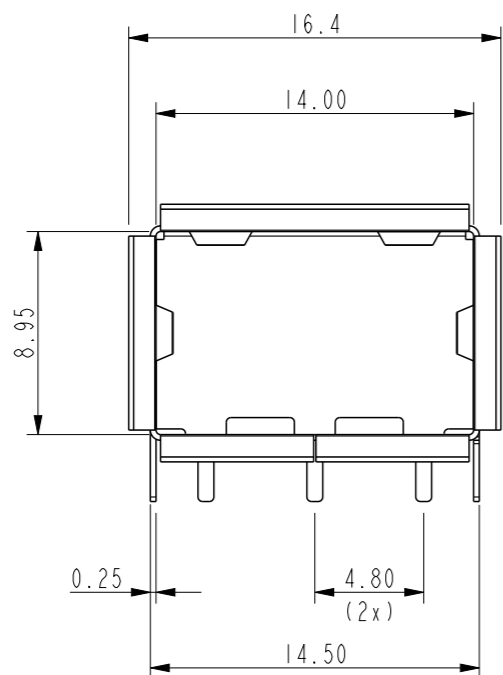
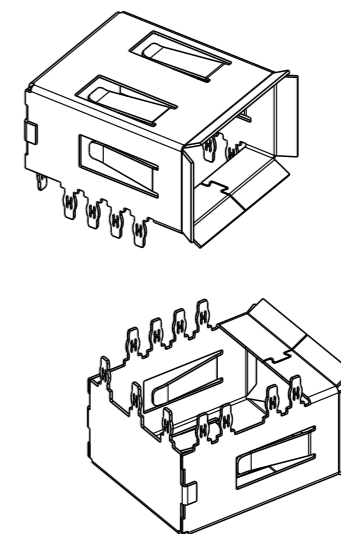
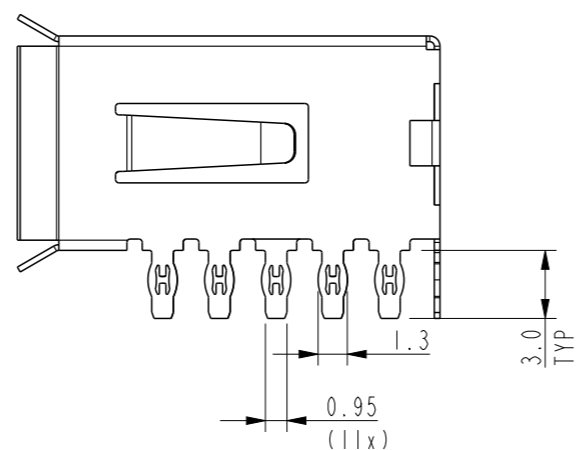
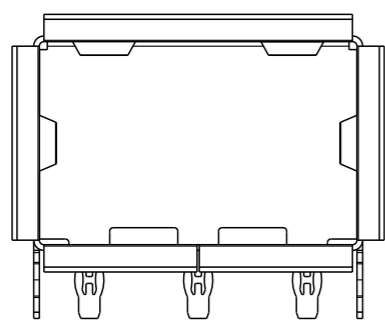

OTHER DIMENSIONS ARE SAME AS THAT OF 10133694-101LF

spec ref	dr	Jibin John	2016/11/10	projection	MM	size	A3	scale	3:1
tolerance std	eng	Aloisius, Stali	2021/12/20			ecn no	ELX-I-43281-1	rel level	Released
ISO 406 ISO 1101	chr	-	-						
surface	appr	Kuriakose, San	2022/03/17	<b>Amphenol FCI</b>		dwg no	10133694	rev	L
ISO 1302	linear	0.X	±0.3	<b>amphenol-icc.com</b>		cat. no.	-	Product - Customer Drw	
	angular	0°	±2°	SFP SHIELDING CAGE OCTIS SFP, 26MM PITCH		sheet 1 of 6			

**PACKAGING  
PACKAGING IN HOT FORMED TRAY**

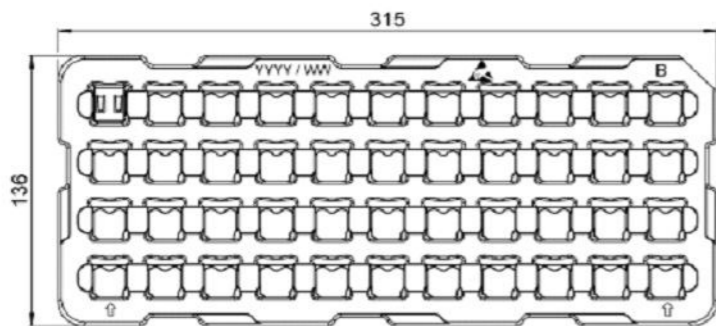
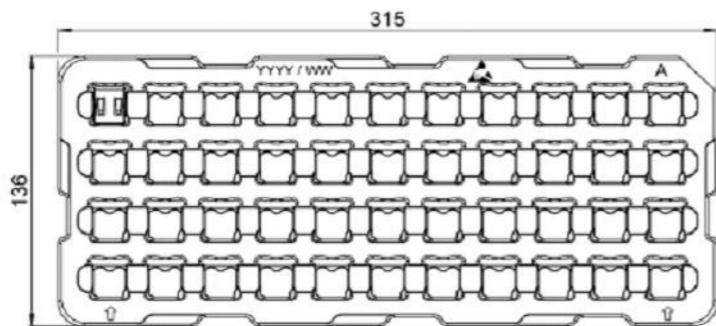

TRAY INFORMATION:  
 44 PCS BY TRAY  
 COLOR: TRAY A IN BLACK AND TRAY B IN TRANSLUCENT  
 YYYY: MANUFACTURING YEAR  
 WW: MANUFACTURING WEEK



ESD SYMBOL

NOTE: HANDLING ONLY WITH GLOVES

**PACKAGING:  
PACKAGING IN THE BOX**

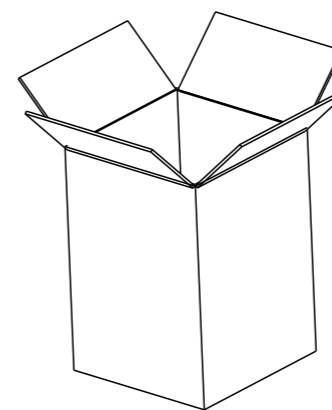
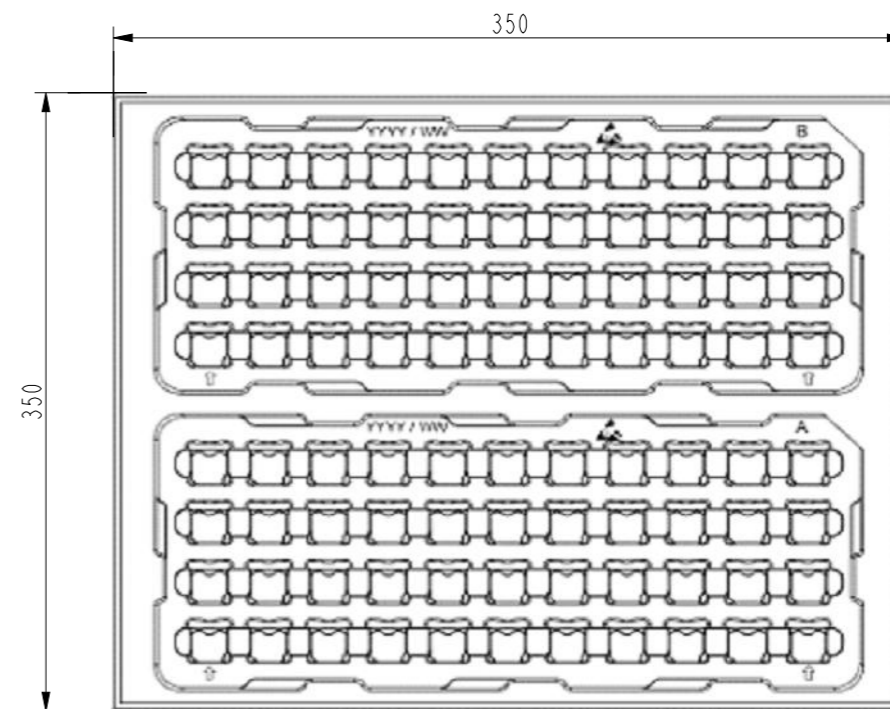

SHIPPABLE CARTON  
(DIMENSION: 350x350x350)

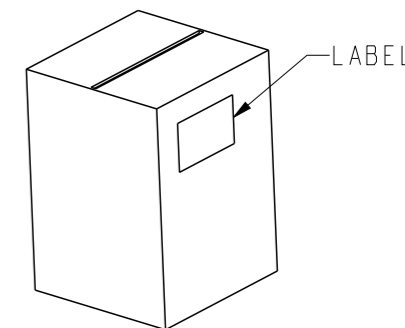

SEALED CARTON

PACKAGING INFORMATION:  
 1584 PCS BY BOX  
 X PITCH = 26.6 MM  
 Y PITCH = 26.6 MM  
 Z DIMENSION = 18 MM  
 TRAY A AND TRAY B STOCKED ALTERNATIVELY  
 HOT FORMED TRAYS FITTED IN A ESD BAG AND IN CARD BOARD BOX

spec ref		dr	Jibin John	2016/11/10	projection 	MM ←→	size	A3	scale	3:1
tolerance std		eng	Aloisius, Stali	2021/12/20			ecn no	ELX-I-43281-1		
ISO 406 ISO 1101		chr	-	-			rel level	Released		
TOLERANCES UNLESS OTHERWISE SPECIFIED		appr	Kuriakose, San	2022/03/17			product family	OCTIS		
surface	linear	0.X	±0.3	Amphenol FCi	title	SFP SHIELDING CAGE	dwg no	10133694	rev	L
		0.XX	±0.13							
		0.XXX	±0.05							
ISO 1302	angular	0°	±2°	amphenol-icc.com	cat. no.	-	Product - Customer Drw	sheet 2 of 6		

PRODUCT NUMBER	TAIL TYPE	PACKING
10133694-103LF	PIP	TAPE & REEL

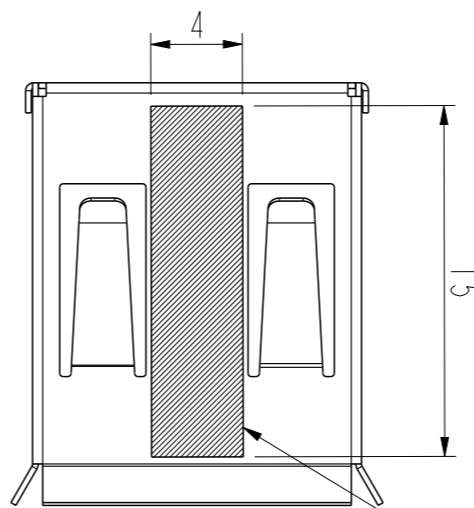

SUITABLE AREA FOR PICK & PLACE VACUUM NOZZLE

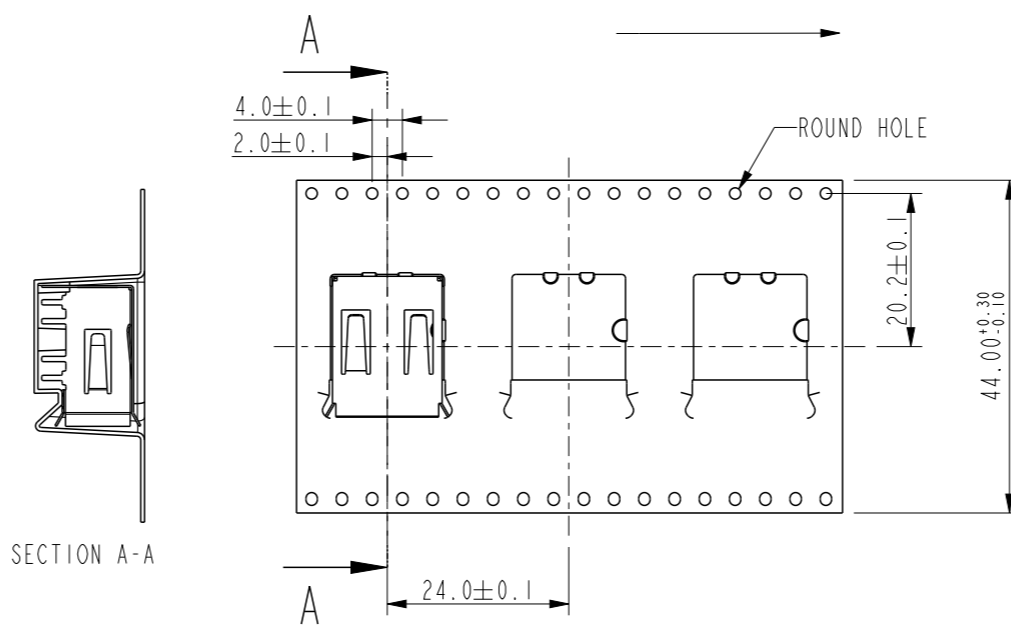
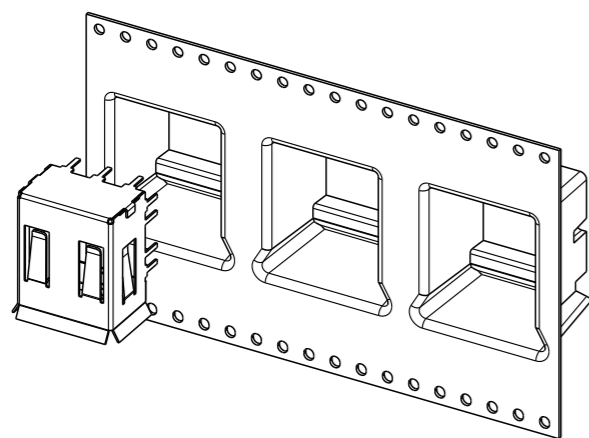
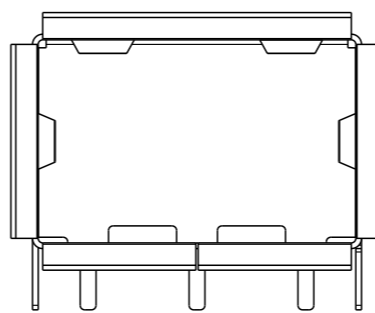
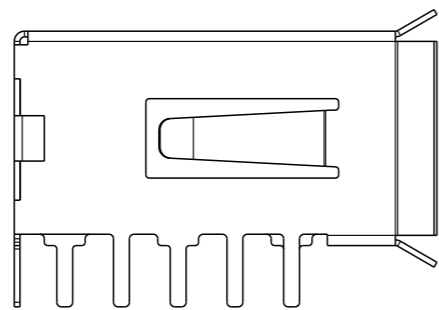

SECTION A-A

VIEW A

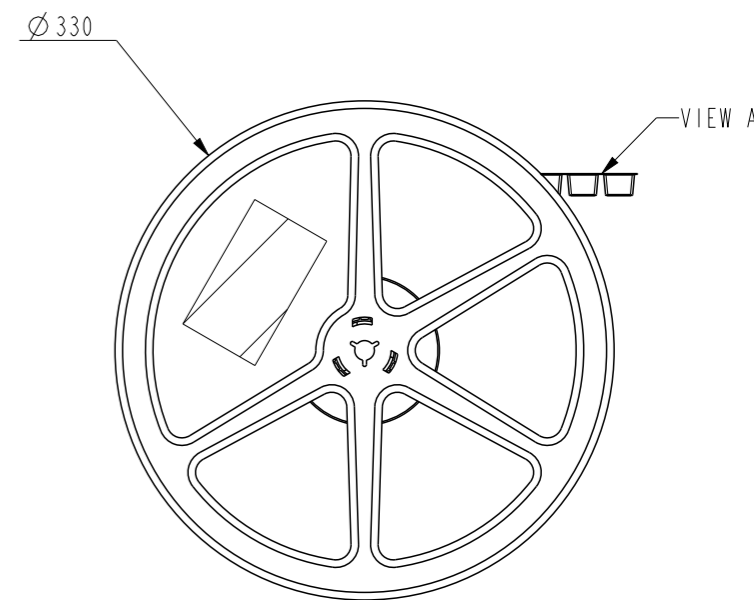

NOTES:

1. DIMENSIONS, MATERIAL, PLATING SAME AS PN: 10133694-101LF
2. REEL DIAMETER: Ø330
3. NUMBER OF COMPONENTS PER REEL: 120

spec ref	dr	Jibin John	2016/11/10	projection	MM	size	A3	scale	3:1
tolerance std	eng	Alosius, Stali	2021/12/20			ecn no	ELX-I-43281-1	rel level	Released
ISO 406 ISO 1101	chr	-	-						
surface	linear	0.X	±0.3	product family	OCTIS	dwg no	10133694	rev	L
		0.XX	±0.13						
ISO 1302	angular	0°	±2°	amphenol-icc.com	cat. no.	-	Product - Customer Drw	sheet 3 of 6	



SFP SHIELDING CAGE  
OCTIS SFP, 26MM PITCH

GENERAL CHARACTERISTICS

SFP Shielding Cage		10133694-101LF	10133694-102LF	10133694-103LF
Mechanical: Mating endurance (cycles) Vibration Weight (g)	IEC 61300-2-2 IEC 61300-2-1	100 - 1.678 g	100 - 1.705 g	100 - 1.678 g
Environmental: Operating temperature (°C) Storage temperature (°C) RoHS Flammability	IEC 61300-2-22 IEC 61300-2-22 - UL 94	-40 / +85 -40 / +85 Compliant V0	-40 / +85 -40 / +85 Compliant V0	-40 / +85 -40 / +85 Compliant V0
Press-fit characteristics: PCB thickness- Insertion force-		1.6 to 2 mm	1.6 to 2 mm 330N typical	1.6 to 2 mm
Installation: Handling precautions- Press-fit tool for 10133694-102LF		Take care sharp edges and Use gloves	Take care sharp edges and Use gloves Tool PN: 10161272-101LF recommended	Take care sharp edges and Use gloves
Others:		ESD approved	ESD approved	ESD approved
Material / Thickness		COPPER ALLOY / 0.25MM	COPPER ALLOY / 0.25MM	COPPER ALLOY / 0.25MM
Plating Spec		MIN 3µm MATTE TIN UPON MIN 2µm NICKEL	MIN 3µm MATTE TIN UPON MIN 2µm NICKEL	MIN 3µm MATTE TIN UPON MIN 2µm NICKEL
Operating temprature		-40/+105°C	-40/+105°C	-40/+105°C

spec ref	dr	Jibin John	2016/11/10	projection	MM	size	A3	scale	3:1
tolerance std	eng	Alosius, Stali	2021/12/20		← →	ecn no	ELX-I-43281-1	rel level	Released
ISO 406 ISO 1101	chr	-	-						
	appr	Kuriakose, San	2022/03/17	product family	OCTIS				
surface	linear	0.X	±0.3	<b>Amphenol FCI</b>	SFP SHIELDING CAGE	dwg no	10133694	rev	L
		0.XX	±0.13						
		0.XXX	±0.05						
ISO 1302	angular	0°	±2°	amphenol-icc.com	cat. no.	-	Product - Customer Drw	sheet 4 of 6	

FOOT/PRINT  
(GENERAL TOLERANCES FOR PCB +/- 0,1 MM)

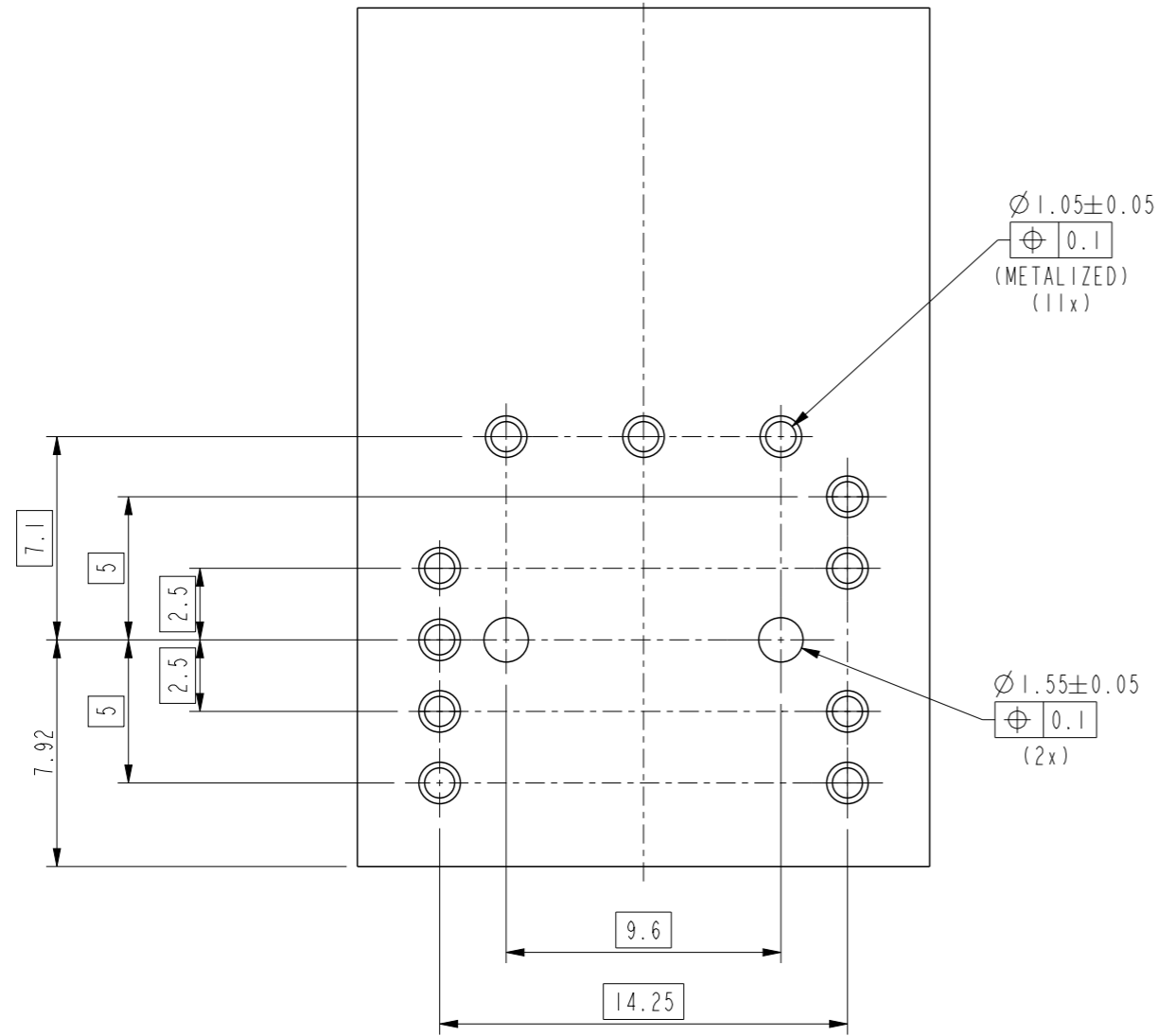

RECOMMENDED PCB LAYOUT  
(THICKNESS=1.60)

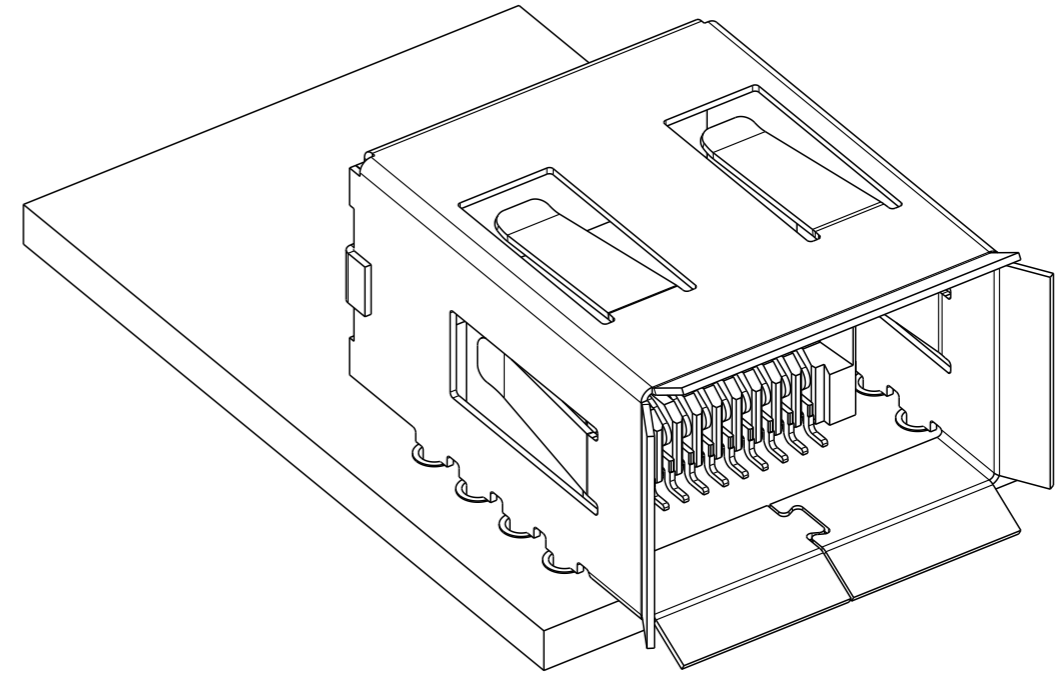

CAGE AND CONNECTOR MOUNTED ON THE PCB

Amphenol  
FCi

© 2020 Amphenol Corporation

spec ref		dr	Jibin John	2016/11/10	projection	MM	size	A3	scale	1:1	
tolerance std		eng	Aloisius, Stali	2021/12/20			ecn no		ELX-I-43281-1		
ISO 406 ISO 1101		chr	-	-			rel level		Released		
TOLERANCES UNLESS OTHERWISE SPECIFIED		appr	Kuriakose, San	2022/03/17	product family		OCTIS		rel level		
surface	linear	0.X	±0.3			SFP SHIELDING CAGE		dwg no	10133694		rev
		0.XX	±0.13			OCTIS SFP, 26MM PITCH			L		
		0.XXX	±0.05			Product - Customer Drw					
ISO 1302	angular	0°	±2°		amphenol-icc.com	cat. no.	-	sheet 5 of 6			

Creo File:ELX-WC-A3C.REV F.2020-12-21

# SOLDER PROCEDURE

1. DEPOSIT SOLDER PASTE (Sn Ag4 Cu0.5) ON SOLDER PADS/MOUNTING AREA BY SCREEN PRINTING APPLICATION. WE RECOMMEND A LOW RESIDUE FLUX. VERIFY THAT THE EDGES OF THE PADS ARE CLEAN.
2. PLACE THE COMPONENT ON THE MOUNTING AREA WITH A PICK & PLACE MACHINE. A VIDEO CAMERA IS RECOMMENDED FOR A GOOD POSITIONING OF THE COMPONENT. ADHESIVE AGENTS MUST NOT BE USED ON THE COMPONENT
3. THIS PROCESS OF SOLDERING HAS BEEN TESTED WITH A CONVECTION OVEN. BELOW PLEASE FIND THE TYPICAL SOLDERING PROFILE TO USE
4. OPTIONAL CLEANING OF PRINTED CIRCUIT BOARD.
5. CHECK SOLDER JOINTS AND POSITION OF THE COMPONENT BY VISUAL INSPECTION.

NOTE: WHEN SOLDERING THE RECEPTACLE, NO PLUG SHOULD BE MATED TO THE RECEPTACLE BEFORE COMPLETION OF THIS PROCEDURE.

# TEMPERATURE PROFILE

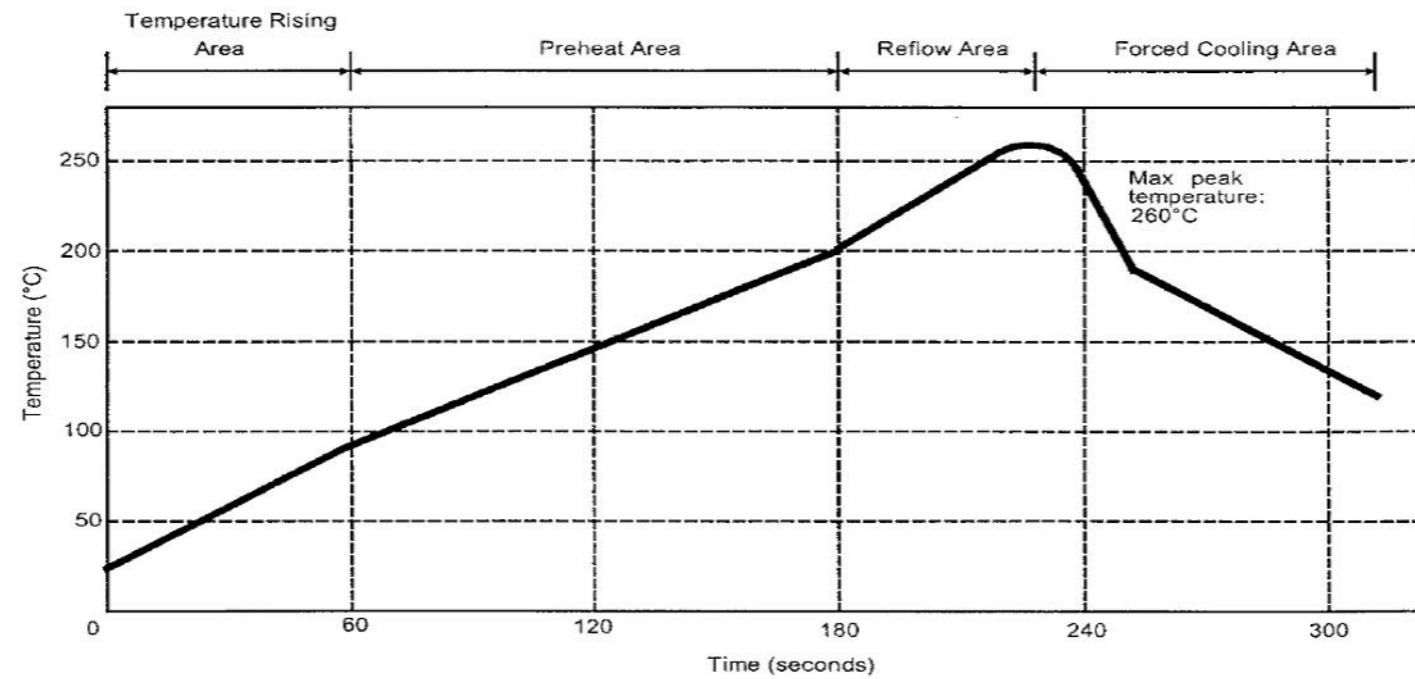

PARAMETER	VALUE	UNIT
TEMPRATURE RISING AREA	1 TO 4	°C/Sec
MAX PEAK TEMPRATURE	260	°C
MAX DWELL TIME @260°C	10	Sec
MIN DWELL TIME @235°C	20	Sec
MAX DWELL TIME @235°C	60	Sec
TEMPRATURE DROP IN COOLING AREA	-1 TO -4	°C/Sec
MAX DWELL TIME ABOVE 100°C	420	Sec

spec ref	dr	Jibin John	2016/11/10	projection	MM	size	A3	scale	1:1
tolerance std	eng	Alosius, Stali	2021/12/20			ecn no	ELX-I-43281-1	rel level	Released
ISO 406 ISO 1101	chr	-	-						
surface	appr	Kuriakose, San	2022/03/17			rel level	Released	dwg no	10133694
ISO 1302	linear	0.X	±0.3	SFP SHIELDING CAGE		rev	L	cat. no.	-
	angular	0°	±2°	OCTIS SFP, 26MM PITCH		Product - Customer Drw	sheet 6 of 6		