



Electrical specifications

Passband: 2200-2300MHz
Passband Insertion Loss: ≤ 0.8 dB
Passband Ripple: ≤ 0.4 dB
Passband Return Loss: ≥ 19 dB
Rejection: ≥ 95 dB@DC-2120MHz
Rejection 2: ≥ 95 dB@2400-4000MHz
Power Handling: 40W(CW)
Input / Output Impedance: 50 Ohms

Mechanical

Connector Type: N-Female/N-Female
Dimensions: 4.57 x 2.52 x 1.58 inches

Environmental

Operating Temperature: -20 to +55 deg. C
Storage temperature: -65 to +95 deg.C
Shock: 20 G's, 1/2 sine, 11ms
Vibration: 10 G's, 10-2000Hz
Relative Humidity: 0-95%
Environmentally Sealed: IP65

Outline Drawing:

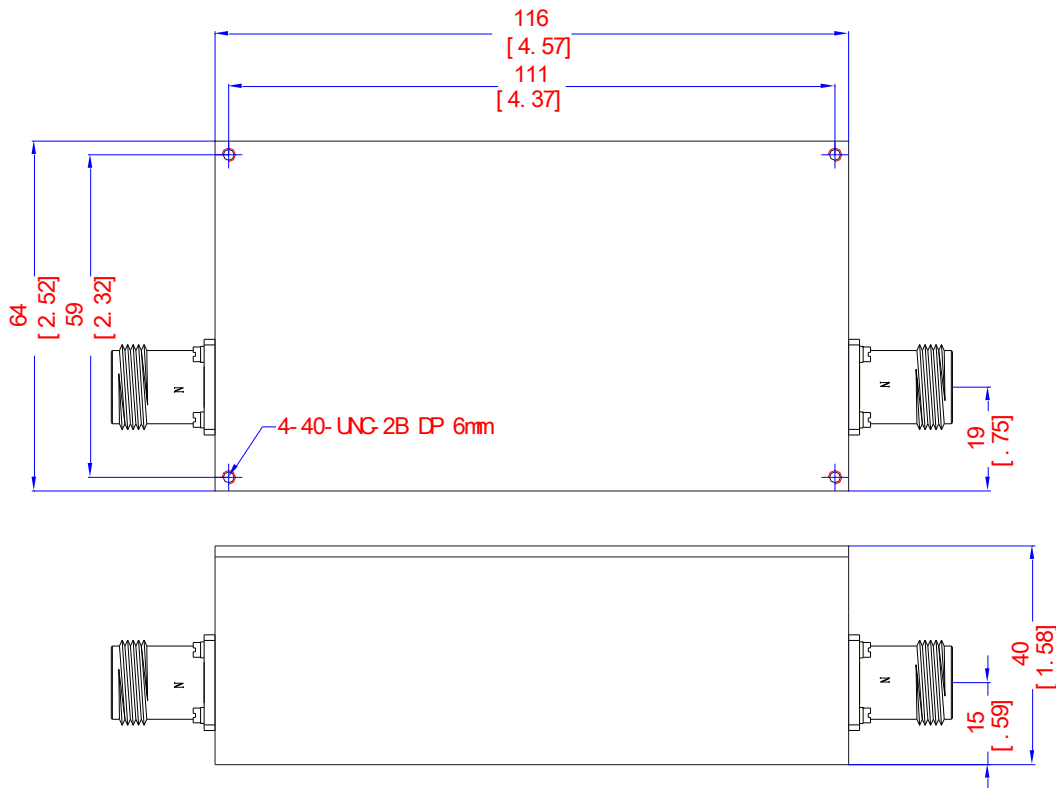



Response Plot:

