

THIS DRAWING IS UNPUBLISHED. RELEASED FOR PUBLICATION
 © COPYRIGHT - By - TE CONNECTIVITY ALL RIGHTS RESERVED.

LOC	DIST	REVISIONS			
P	LTR	DESCRIPTION	DATE	DWN	APVD
CM	0				
	K1	REVISED PER ECR-20-100206	13JUL2020	BDA	SW

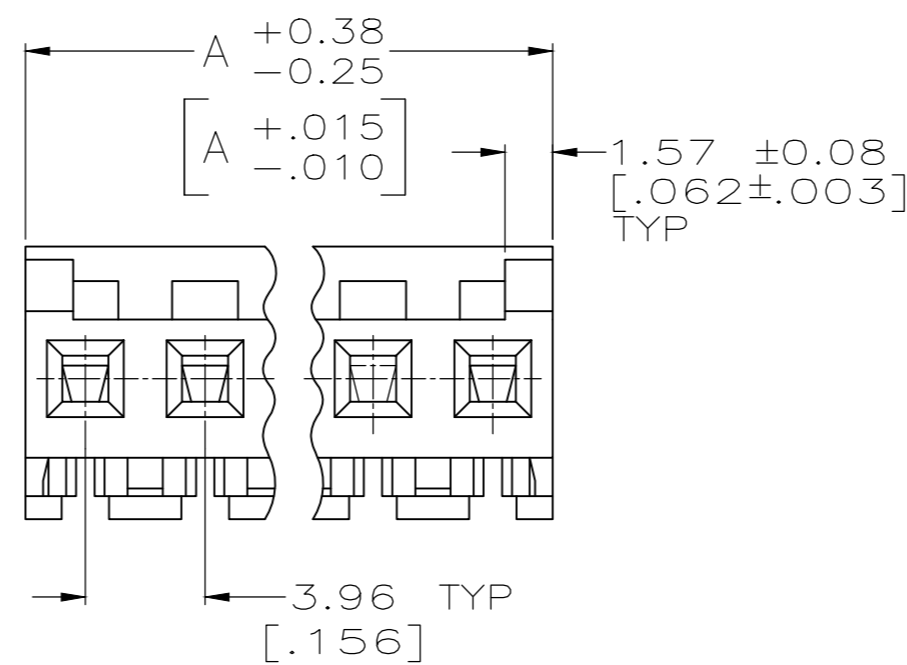
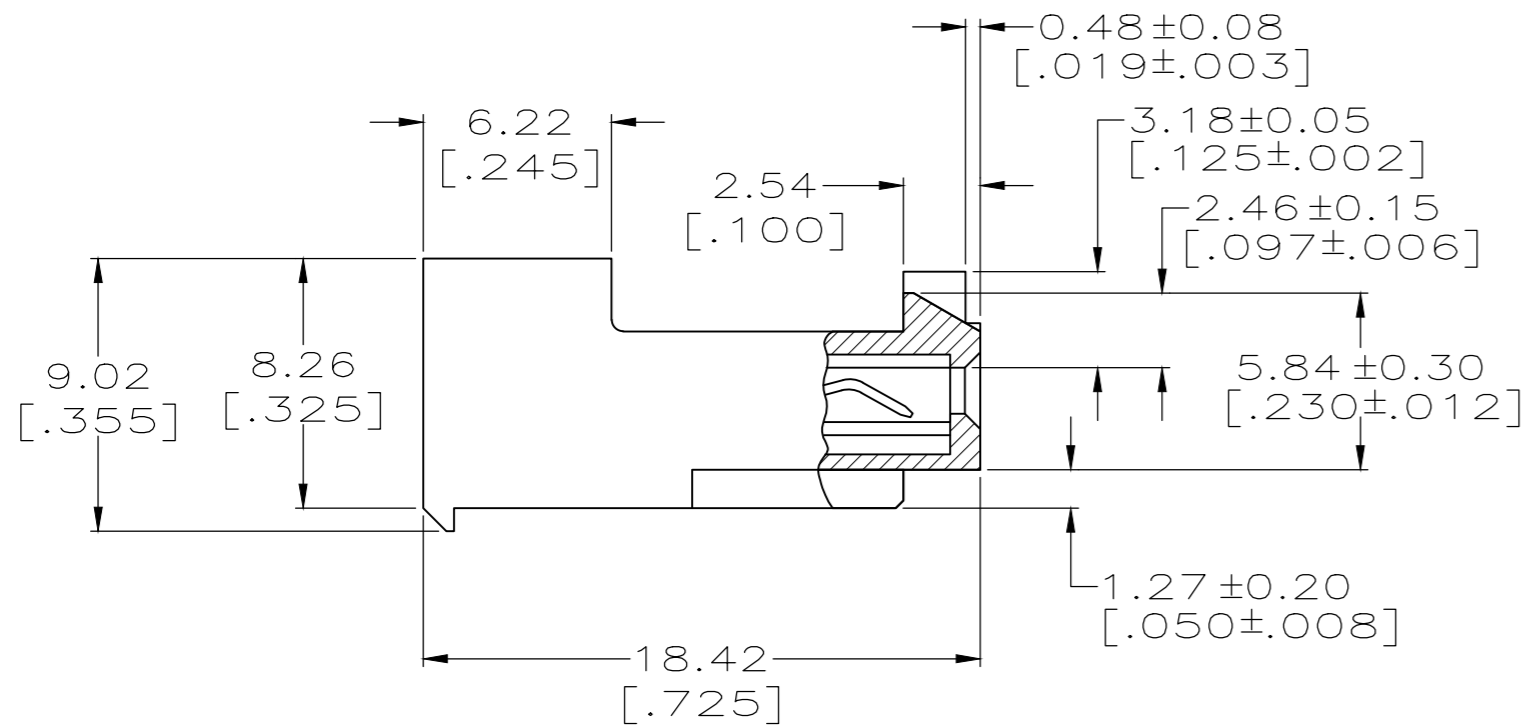
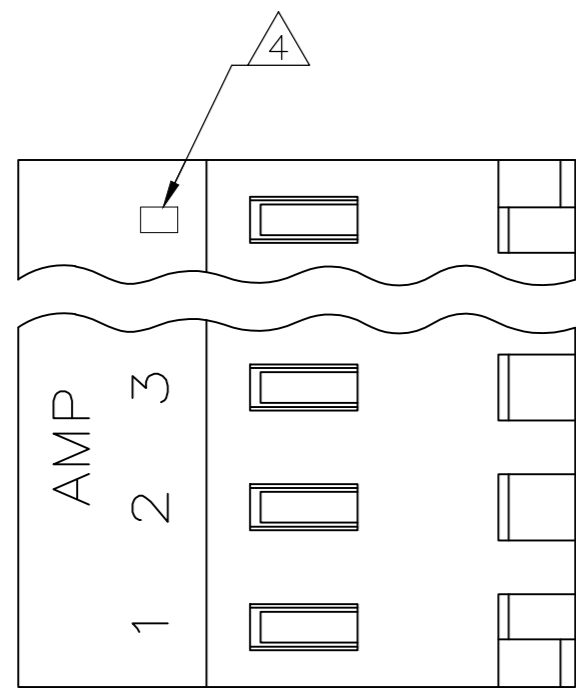

1 MATERIAL:
 CONNECTOR - NYLON UL94V-2 (ORANGE).
 CONTACTS - 0.30 [.012] THICK COPPER ALLOY.
 PLATING - 0.00038 [.000015] GOLD THK OR 0.00008 [.000003] MIN THK GOLD FLASH OVER 0.00030 [.000012] THK PALLADIUM NICKEL PER TE CONNECTIVITY'S DISCRETION. IN CONTACT AREA.
 0.00203 [.000080] MIN THICKNESS MATTE TIN IN SLOT AREA FOR 641148-2 THRU 2-641148-4 OR MATTE WHISKER MITIGATED TIN IN SLOT AREA FOR 3-641148-2 THRU 5-641148-4 OVER NICKEL UNDERPLATE.

2 CONTACTS ACCEPT 18 AWG WIRE WITH 2.41 [.095] MAX INSULATION DIAMETER.

3 CONTACTS MUST ACCEPT 1.14 ± 0.03 [.045 ± .001] SQUARE POST AND REMAIN LOCKED IN POSITION.

4 IDENTIFICATION NUMBER FOR LAST CIRCUIT MAY NOT APPEAR ON ALL ASSEMBLIES.

5 DIMENSIONS IN BRACKETS ARE IN INCHES.

6 HOUSING FEATURES ARE: CLOSED END WITH LOCKING RAMP AND POLARIZING TAB.

7 NOTE DELETED

8 NOTE DELETED.

9 OBSOLETE PARTS: OBSOLETE CIS STREAMLINING PER D.RENAUD/D.SINISI

CONTACT FINISH	DIM A	NO. OF CIRCUITS	PART NO.
TIN	47.55 [1.872]	12	4-644284-2
TIN	43.59 [1.716]	11	4-644284-1
TIN	39.62 [1.560]	10	4-644284-0
TIN	35.66 [1.404]	9	3-644284-9
TIN	31.70 [1.248]	8	3-644284-8
TIN	27.74 [1.092]	7	3-644284-7
TIN	23.77 [.936]	6	3-644284-6
TIN	19.81 [.780]	5	3-644284-5
TIN	15.85 [.624]	4	3-644284-4
TIN	11.89 [.468]	3	3-644284-3
TIN	7.92 [.312]	2	3-644284-2
OBSOLETE	47.55 [1.872]	12	1-644284-2
SUPERSEDED	43.59 [1.716]	11	1-644284-1
SUPERSEDED	39.62 [1.560]	10	1-644284-0
OBSOLETE	35.66 [1.404]	9	644284-9
SUPERSEDED	31.70 [1.248]	8	644284-8
SUPERSEDED	27.74 [1.092]	7	644284-7
OBSOLETE	23.77 [.936]	6	644284-6
OBSOLETE	19.81 [.780]	5	644284-5
SUPERSEDED	15.85 [.624]	4	644284-4
OBSOLETE	11.89 [.468]	3	644284-3
OBSOLETE	7.92 [.312]	2	644284-2

THIS DRAWING IS A CONTROLLED DOCUMENT.		DWN B. LEWIS 2-12-91	TE Connectivity	
DIMENSIONS: mm [INCHES]		CHK R. SWING 2-12-91	MTA 156 CONNECTOR ASSEMBLY, 18 AWG, STANDARD	
TOLERANCES UNLESS OTHERWISE SPECIFIED:		APVD -	NAME	
0 PLC ± -		PRODUCT SPEC 108-1051	SIZE	
1 PLC ± -		APPLICATION SPEC 114-1020	CAGE CODE 00779	DRAWING NO C=644284
2 PLC ± -		WEIGHT -	RESTRICTED TO -	
3 PLC ± 0.13 [.005]		CUSTOMER DRAWING	SCALE 4:1	SHEET 1 of 1
4 PLC ± -			REV K1	
ANGLES ± -				
FINISH				