

A. System Overview

Fanning Strip System

- Holds wires in a specific orientation
- No sharp edges to damage wire insulation
- Will accept wires up to 18 AWG
- Fanning strip can remain as part of completed harness

B1. Cable Ties

B2. Cable Accessories

B3. Stainless Steel Ties

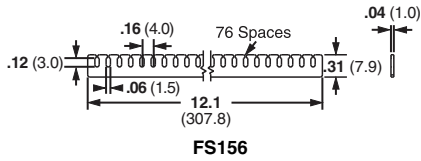

FS156

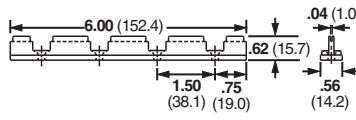

FSH40

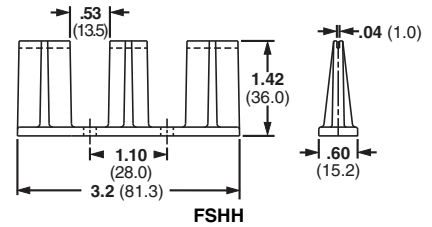

FSHH

C1. Wiring Duct



C2. Surface Raceway

| Part Number | Material | Color | Mounting Method | Std. Pkg. Qty. | Std. Ctn. Qty. |
|-------------|-----------|---------|---------------------|----------------|----------------|
| FS156-C | Nylon 6.6 | Natural | FSH Holder | 100 | 1000 |
| FSH40-X | ABS | Black | Four #8 (M4) Screws | 10 | 100 |
| FSHH-X | | | Two #8 (M4) Screws | 10 | 100 |

C3. Abrasion Protection

C4. Cable Management

Spring Wire Breakout System

- Harness board spring and spring holder holds wire ends secure while harness is being fabricated
- Wires simply pull out from spring when harness is removed
- Each SHH Spring Holder is supplied with one rigid wire piece to hold the spring laterally and two #8 (M4), 2" (50.8mm) hex head wood screws; purchase spring separately

D1. Terminals

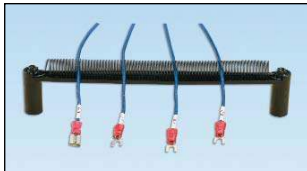

D2. Power Connectors

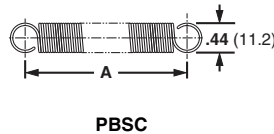

PBSC

D3. Grounding Connectors

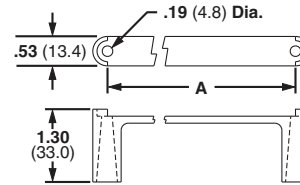

SHH

E1. Labeling Systems

E2. Labels

E3. Pre-Printed & Write-On Markers

E4. Permanent Identification

E5. Lockout/Tagout & Safety Solutions

F. Index

| Part Number | Hole Spacing A | | Material | Color | Mounting Method | Std. Pkg. Qty. | Std. Ctn. Qty. |
|-------------|----------------|-------|-----------|---------|--------------------|----------------|----------------|
| | In. | mm | | | | | |
| PBSC1-X | 1.00 | 25.4 | Steel | — | SHH1 Spring Holder | 10 | 100 |
| PBSC3-X | 3.00 | 76.2 | | — | Two #8 (M4) Screws | 10 | 100 |
| PBSC6-X | 6.00 | 152.4 | | — | SHH3 Spring Holder | 10 | 100 |
| PBSC12-X | 12.00 | 304.8 | | — | Two #8 (M4) Screws | 10 | 100 |
| SHH1-S8-X | 1.85 | 47.0 | Nylon 6.6 | Natural | Two #8 (M4) Screws | 10 | 100 |
| SHH3-S8-X | 6.80 | 172.7 | | | Two #8 (M4) Screws | 10 | 100 |