

Amphenol
FCi
© 2016 AFci

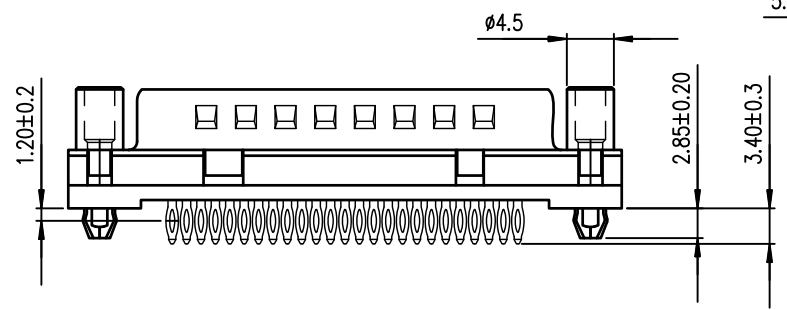

PC board drilling dimensions(after plating)
(thickness ≤ 3.20±0.30mm)

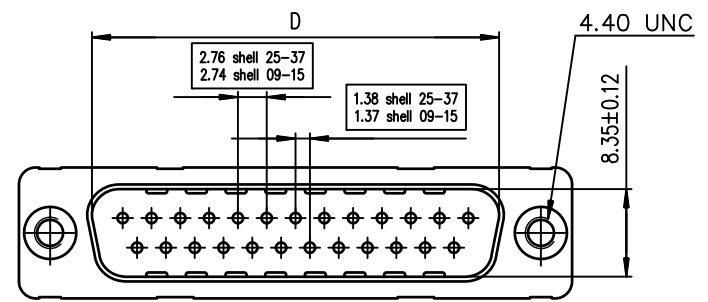
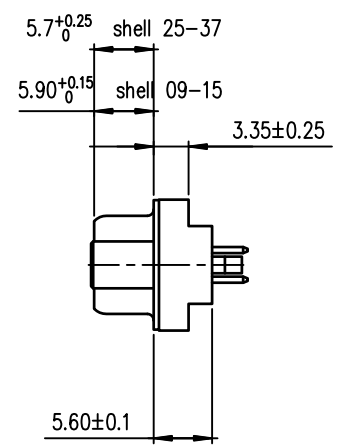
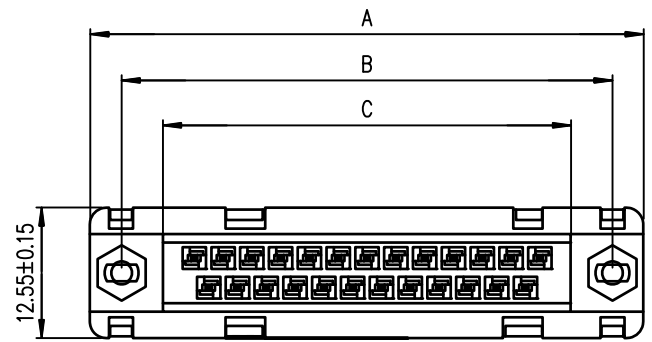
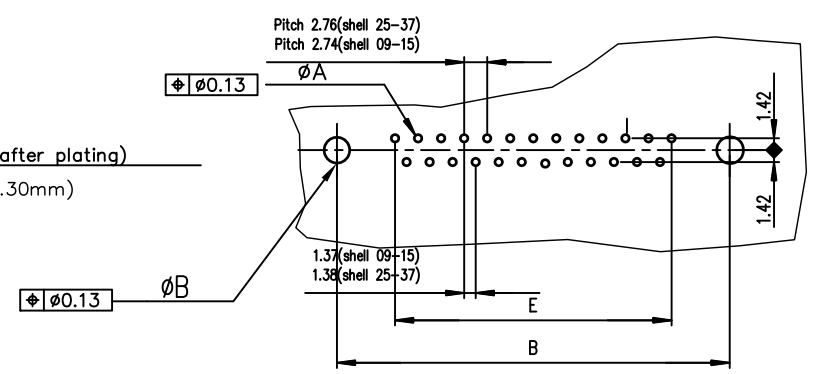

ROHS PART NUMBER

| SHELL | A±0.38 | B±0.12 | C±0.10 | D±0.25 | E±0.07 | PART NUMBER | PART NUMBER |
|-------|--------|--------|--------|--------|--------|----------------|----------------|
| 09 | 30.81 | 24.99 | 16.96 | 16.79 | 10.96 | D09P90C4GV00LF | D09P90C6GV00LF |
| 15 | 39.14 | 33.32 | 25.18 | 25.12 | 19.18 | D15P90C4GV00LF | D15P90C6GV00LF |
| 25 | 53.03 | 47.04 | 39.12 | 38.84 | 33.12 | D25P90C4GV00LF | D25P90C6GV00LF |
| 37 | 69.32 | 63.50 | 55.68 | 55.30 | 49.68 | D37P90C4GV00LF | D37P90C6GV00LF |
| | | | | | | gold flash | 0.76» gold |

GENERAL CHARACTERISTICS AND ROHS INFORMATIONS:
SEE DRAWING C01-8646-0001

| | | | | | | | | | |
|-------------|--|------------------|--|----------------------------|--|------------|--|----------------------------------|--|
| mat'l. code | | surface ISO 1302 | | tolerance ISO 406 ISO 1101 | | projection | | product family D-SUB | |
| ltr | | ecn no | | dr | | date | | title | |
| B | | - | | JAR | | 1996-07-24 | | MALE CONNECTOR DELTA LOW PROFILE | |
| C | | LS05-004 | | MPE | | 2005-02-08 | | STRAIGHT PRESS-FIT | |
| D | | LS06-0097 | | LGO | | 2006-07-29 | | scale 2:1 | |
| E | | LS06-0140 | | LGO | | 2006-09-16 | | dwg no sheet 1 of 1 size | |
| F | | 109-0288 | | NG | | 2009-11-24 | | Amphenol FCI C01-8646-0371 A3 | |
| G | | ELX-I-24020 | | AAB | | 2016-06-06 | | type Product Customer Drawing | |
| sheet index | | revision sheet | | G | | 1 | | | |