

9 8 7 6 5 4 3 2 1

E
D
C
B
A

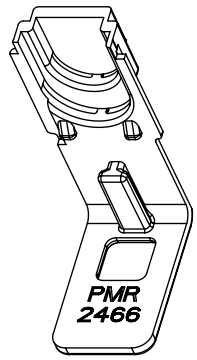
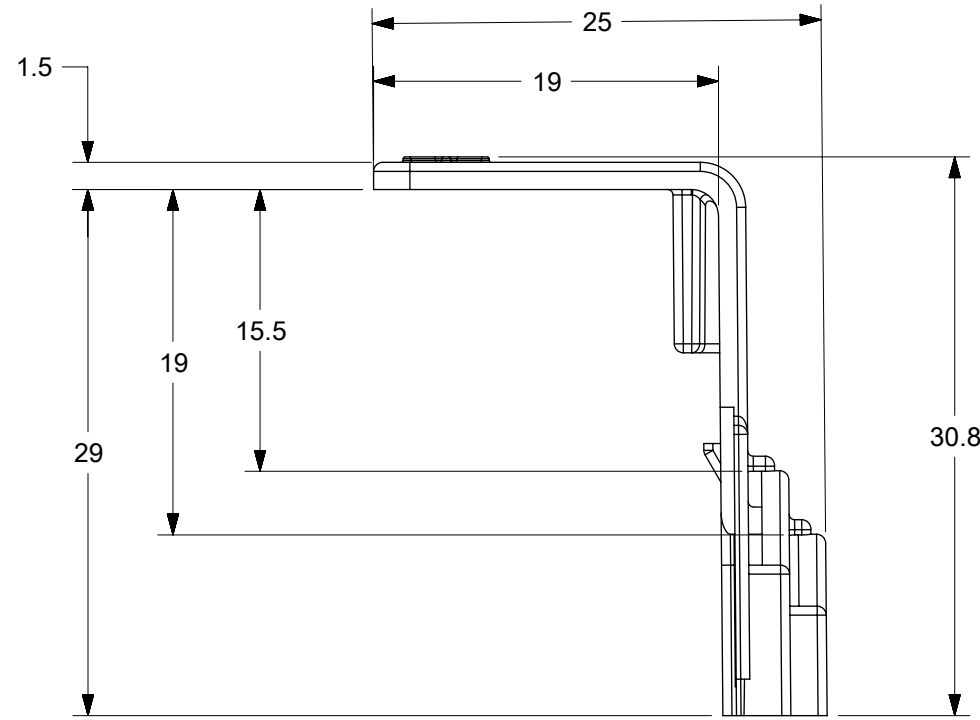
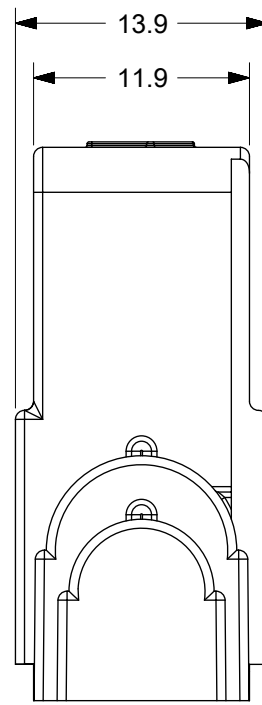
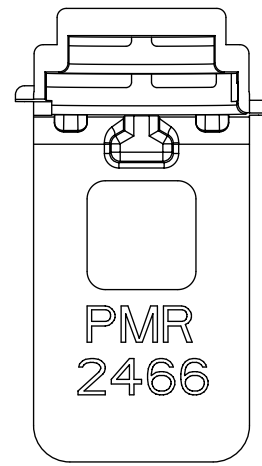

MATERIAL: POLYAMIDE

TOLERANCE	>0.5=3	>3=6	>6=30	>30=120	>120=400
ISO 2768-m	±0.1	±0.1	±0.2	±0.3	±0.5

THIS DRAWING CONTAINS INFORMATION THAT IS PROPRIETARY TO MOLEX ELECTRONIC TECHNOLOGIES, LLC AND SHOULD NOT BE USED WITHOUT WRITTEN PERMISSION

EC NO: 120665 DRWN: WLEUNG CHKD: DNGUYEN62 APPR: JFMURPHY	RELEASE 2017/08/14 2017/08/15 2017/08/18	GENERAL TOLERANCES (UNLESS SPECIFIED) ANGULAR TOL ± °	DIMENSION UNITS: mm SCALE: NTS			
	4 PLACES ± 3 PLACES ± 2 PLACES ± 1 PLACE ± 0 PLACES ±	DRWN BY: WLEUNG DATE: 2017/08/14	CHK'D BY: DNGUYEN62 DATE: 2017/08/15			
	DRAFT WHERE APPLICABLE MUST REMAIN WITHIN DIMENSIONS	APPR BY: JFMURPHY DATE: 2017/08/18	DRAWING SIZE: B THIRD ANGLE PROJECTION	PRODUCT CUSTOMER DRAWING		
	A	REV	B			
	RELEASE STATUS: P1 RELEASE DATE: 18.08.2017 19:46:39	TOLERANCE ISO 2768-m	>0.5=3 ±0.1 >3=6 ±0.1 >6=30 ±0.2 >30=120 ±0.3 >120=400 ±0.5	DOCUMENT NUMBER: 2016066947 DOC TYPE: PSD DOC PART: 000	SHEET NUMBER: 1 OF 1	SHEET NUMBER: 1 OF 1

RELEASE STATUS P1 RELEASE DATE 18.08.2017 19:46:39

9

8

7

6

5

4

3

2

1

FORMAT: master-lb-prod-B
 REVISION: C
 DATE: 2015/12/14