

MARKING IS LOCATED AS SHOWN

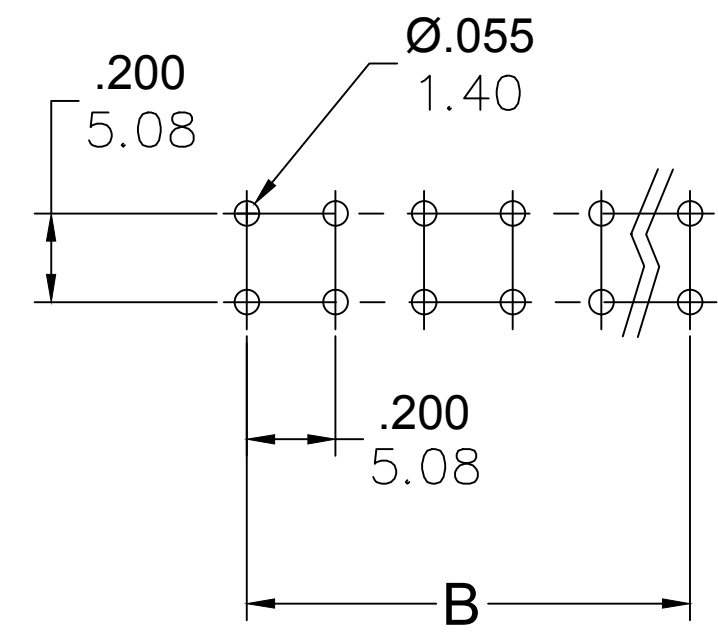

PCB LAYOUT

PART NUMBER DATA							
CIRCUITS	PART NUMBER	ENGINEERING NUMBER	COLOR	A IN mm		B IN mm	
2	397350002	M750S-25-2-02-3	GREEN	.48	12.2	.200	5.08
3	397350003	M750S-25-2-03-3	GREEN	.68	17.2	.400	10.16
4	397350004	M750S-25-2-04-3	GREEN	.88	22.3	.600	15.24
5	397350005	M750S-25-2-05-3	GREEN	1.08	27.4	.800	20.32
6	397350006	M750S-25-2-06-3	GREEN	1.28	32.5	1.000	25.40
7	397350007	M750S-25-2-07-3	GREEN	1.48	37.6	1.200	30.48
8	397350008	M750S-25-2-08-3	GREEN	1.68	42.6	1.400	35.56
9	397350009	M750S-25-2-09-3	GREEN	1.88	47.7	1.600	40.64
10	397350010	M750S-25-2-10-3	GREEN	2.08	52.8	1.800	45.72
11	397350011	M750S-25-2-11-3	GREEN	2.28	57.9	2.000	50.80
12	397350012	M750S-25-2-12-3	GREEN	2.48	63.0	2.200	55.88
13		M750S-25-2-13-3	GREEN	2.68	68.0	2.400	60.96
14		M750S-25-2-14-3	GREEN	2.88	73.1	2.600	66.04
15		M750S-25-2-15-3	GREEN	3.08	78.2	2.800	71.12
16		M750S-25-2-16-3	GREEN	3.28	83.3	3.000	76.20
17		M750S-25-2-17-3	GREEN	3.48	88.4	3.200	81.28
18		M750S-25-2-18-3	GREEN	3.68	93.4	3.400	86.36
19		M750S-25-2-19-3	GREEN	3.88	98.5	3.600	91.44
20		M750S-25-2-20-3	GREEN	4.08	103.6	3.800	96.52
21		M750S-25-2-21-3	GREEN	4.28	108.7	4.000	101.59
22		M750S-25-2-22-3	GREEN	4.48	113.8	4.200	106.67
23		M750S-25-2-23-3	GREEN	4.68	118.8	4.400	111.75
24		M750S-25-2-24-3	GREEN	4.88	123.9	4.600	116.83

REF. LAST 2 DIGITS OF PART NUMBER EQUAL CIRCUIT COUNT

ENGINEERING NUMBER LEGEND

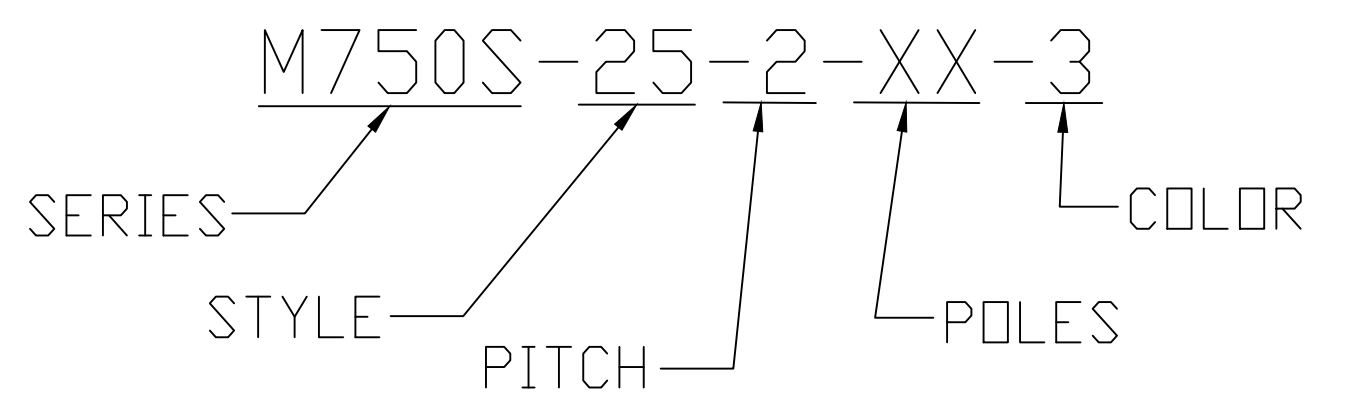

CONTACT FACTORY FOR OPTIONAL COLORS

TOLERANCES			
MM	TOL	INCH	TOL
0-6	±0.25	0-.24	±0.10
>6-30	±0.40	.24-1.18	±0.16
>30-120	±0.50	1.18-4.76	±0.20
>120	±0.80	>4.76	±0.31

SPECIFICATIONS:

- MATERIAL:
 - A. COVER: PA66 UL94 V-0
 - B. BODY: PA66, UL94 V-0
 - C. TERMINAL: BRASS TIN PLATED
- RATING: 250V, 12A
- DIELECTRIC VOLTAGE WITHSTAND: AC 2500V FOR 1 MINUTE
- INSULATION RESISTANCE: DC 500V, 500MΩ
- RATED IMPULSE VOLTAGE: 4000V, PLUS AND MINUS 5 TIMES EACH
- OPERATING TEMPERATURE: -40°C TO +105°C
- MAX SOLDERING TEMP: 260°C (500°F) FOR 5 SECONDS
- DIMS. SHOWN ARE FOR REFERENCE ONLY

REVISED DOC TOL EC NO.: ICG2017-0881 DRWN: ABENJAMI CH'KD: --- APPR: BRUPERT 4/6/17 2014/10/16 DESCRIPTION REV	QUALITY SYMBOL	GENERAL TOLERANCES (UNLESS SPECIFIED)	DIMENSION STYLE	SCALE	DESIGN UNITS	THIRD ANGLE PROJECTION
	▽=0	mm INCH	IN/MM	---	METRIC	
	▽C=0	4 PLACES ±--- ±---	DRAWN BY DATE	TITLE		
		3 PLACES ±--- ±---	RSTONE 2014/04/30	HEADER, VERTICAL MALE, 5.08MM		
	2 PLACES ±--- ±---	CHECKED BY DATE	---			
	1 PLACE ±--- ±---	G FARNSW	---			
	ANGULAR ±---°	APPROVED BY DATE	Molex MOLEX INCORPORATED			
	DRAFT WHERE APPLICABLE MUST REMAIN WITHIN DIMENSIONS	JFMURPHY 2014/10/16	MATERIAL NO. SEE CHART		DOCUMENT NO. SD-39735-001	SHEET NO. 1 OF 1
			THIS DRAWING CONTAINS INFORMATION THAT IS PROPRIETARY TO MOLEX INCORPORATED AND SHOULD NOT BE USED WITHOUT WRITTEN PERMISSION			